

WINWING SIM

WINWING 3M PDC

Model 3M. PDC 1.0

User Manual

V1.0 2025.07.11

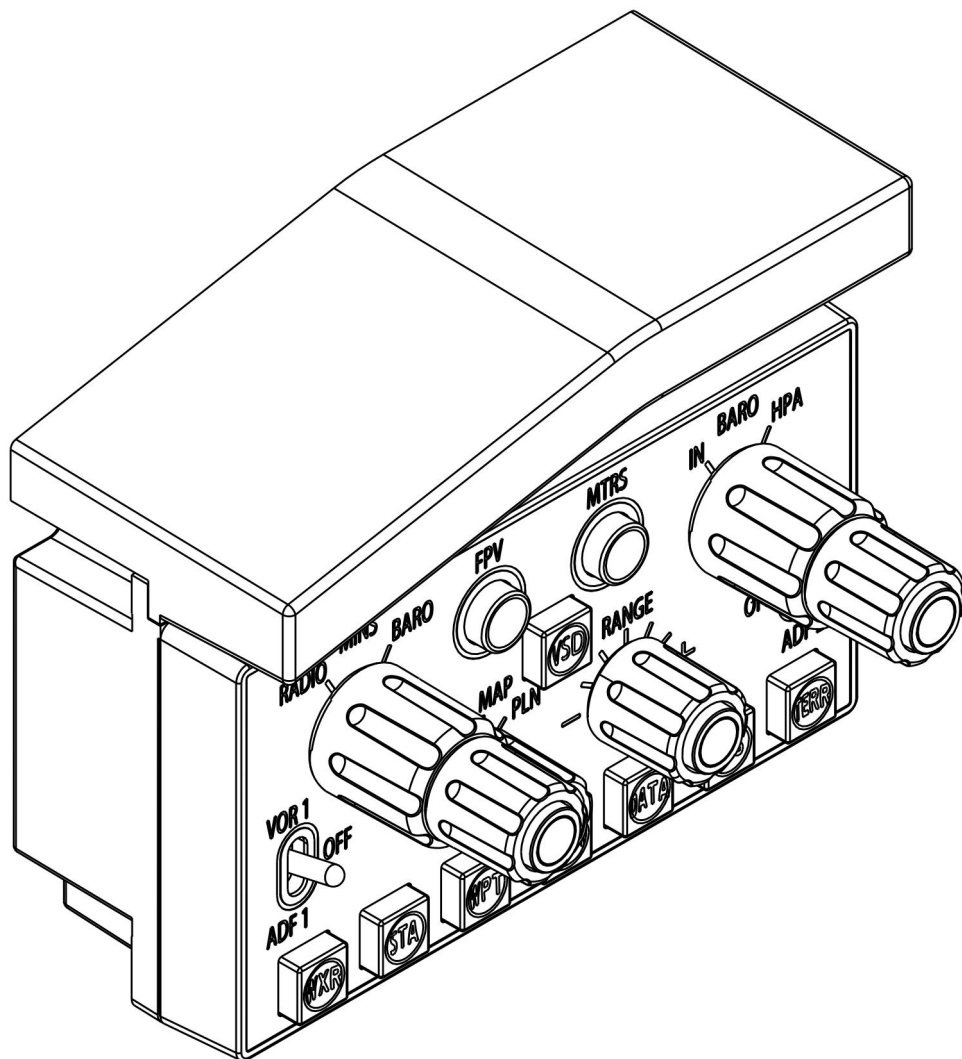

Packing List

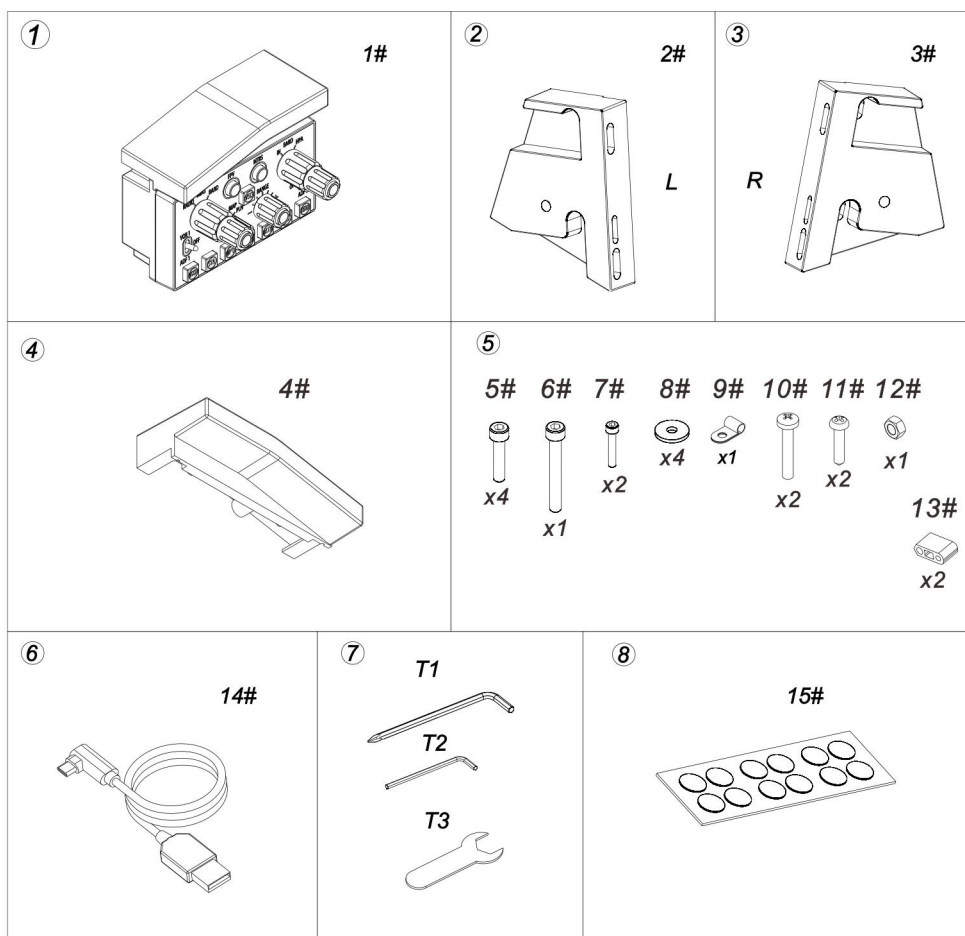

①. 3M. PDC 1.0 (1#)	1
②. Mounting Bracket 2-Left 3 (2#)	1
③. Mounting Bracket 2-Right 3 (3#)	1
④. Glare Shield-R (4#)	1
⑤. Accessories Kit (5#~13#)	1
5#: M5*22 Socket Cap Screw M5*22; 6#:M5*40 Socket Cap Screw M5*40;	
7#: M3*15 Socket Cap Screw M3*15; 8#:Flat Washer M5*10*1;	
9#: R-Shape Cable Clip UC-0.5 Black; 10#: Cross recessed pan head screws M4*26;	
11#: M2.6*10 Cross recessed pan head tapping screws M2.6*10;	
12#: Hexagon Nut M5;	
13#: Product Connection Accessory;	
⑥. Data Cable (14#)	1
⑦. Tool Kit (T1-T3)	1
⑧. Nano Double Sided Adhesive Dots (15#)	1

Catalog

1. Product Profile	3
1.1 Parts Diagram	3
1.2 Performance Specifications	4
1.3 Product Dimensions	7
1.4 Installation Dimensions	8
1.5 Installation Compatibility	8
2 First Use	9
2.1 Software Installation	9
2.2 Parts Installation	10
2.3 How to Use	11
3 Function	12
3.1 Mechanical and Special Features	12
3.2 Buttons	12
3.3 Data Interface	12
3.4 Adjustment Method	12
4 Installation Methods	13
4.1 Bracket Mounting Method	13
4.1.1 Desktop Mounting Method	13
4.2 Integrated Device Assembly Method	15
5 Maintenance and Care	23
5.1 Firmware Upgrade	23
5.2 Cleaning and Maintenance	23
5.3 FAQs and After-Sales Service	24
6 Safety Precautions	26

1. Product Profile

1.1 Parts Diagram

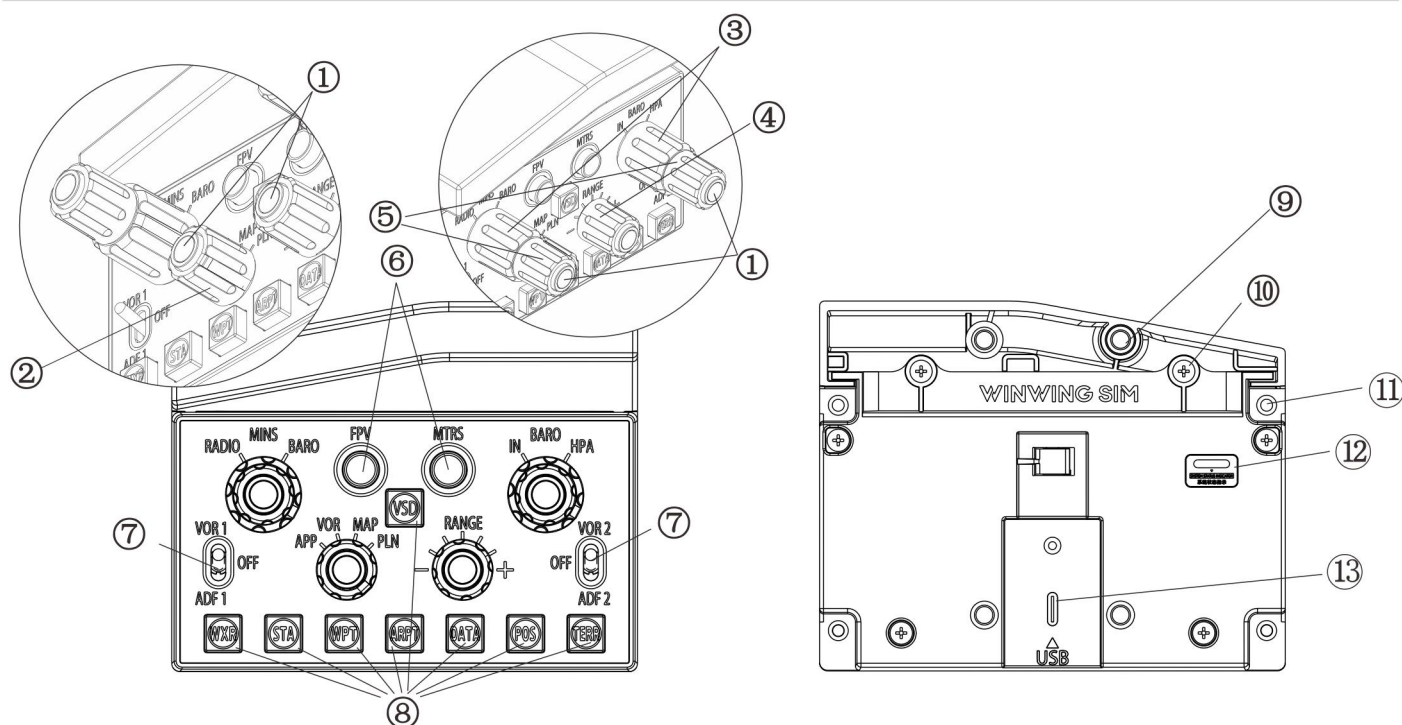

① Press Button

② 4-Position Band Selector

③ 2-Position Band Selector

④ Encoder

⑤ 2-Position 2-Sided Auto-Reset Selector

⑥ Silicone Press Button (Round)

⑦ Toggle Switch

⑧ Silicone Press Button (Square)

⑨ Bracket Mounting Hole

⑩ Glare Shield Mounting Hole

⑪ Connection Accessory Mounting Hole

⑫ Indicator Light

⑬ USB Data Port (5V Voltage)

1.2 Performance Specifications

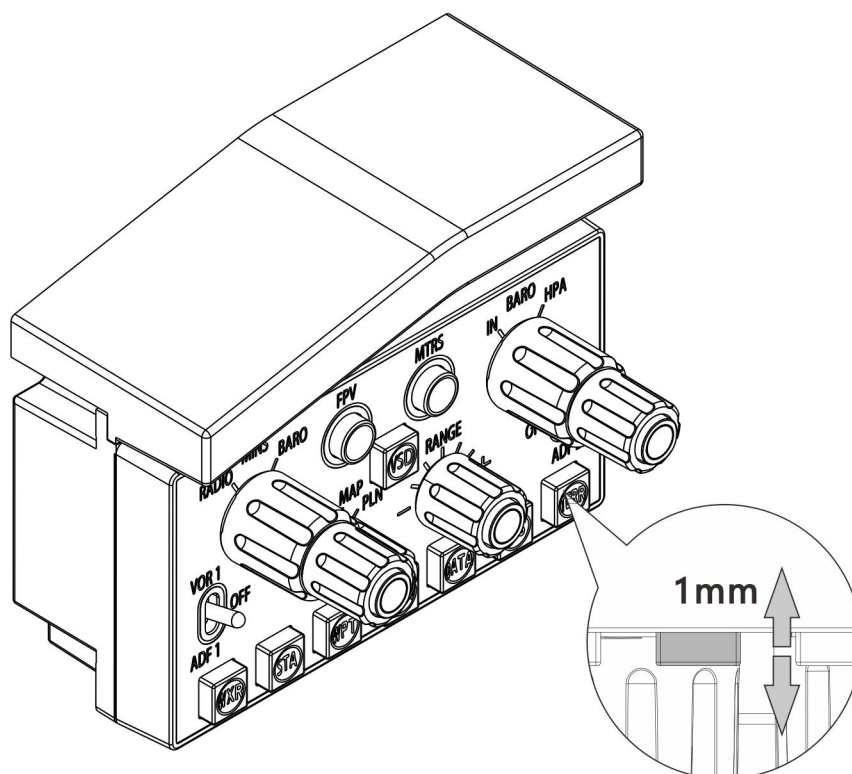

1.2.1 Ten silicone press buttons, with 1mm press travel.

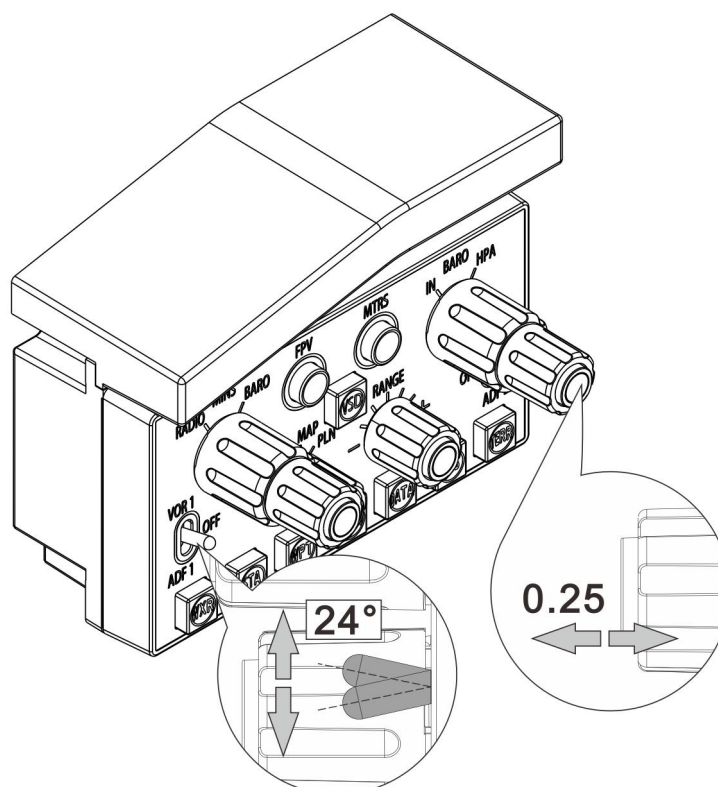

1.2.2 Four press buttons, with 0.25mm press travel.

1.2.3 Two 3-position toggle switches, with 24° travel range.

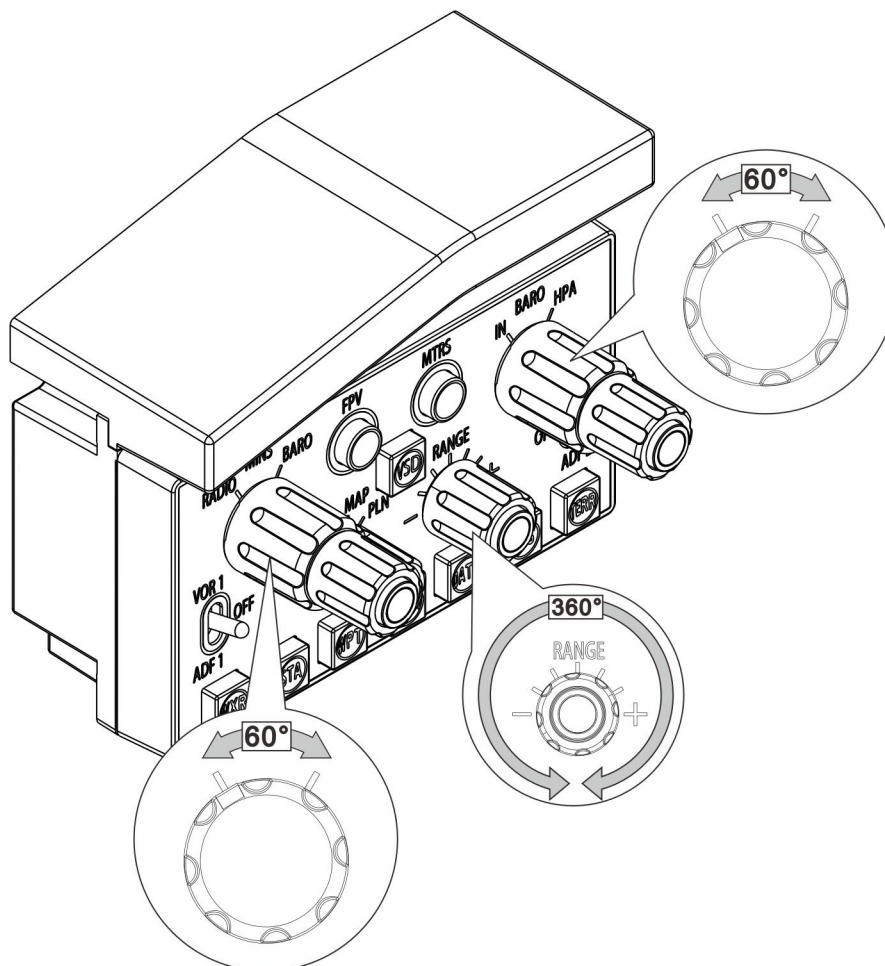

1.2.4 Two 2-position Selector, with 60° rotation angle. *NOTE: Rotation only, do not push/pull. Force push/pull may result in product damage.

1.2.5 One encoder, with 360° rotation angle (detent-free). *NOTE: Rotation only, do not push/pull. Force push/pull may result in product damage.

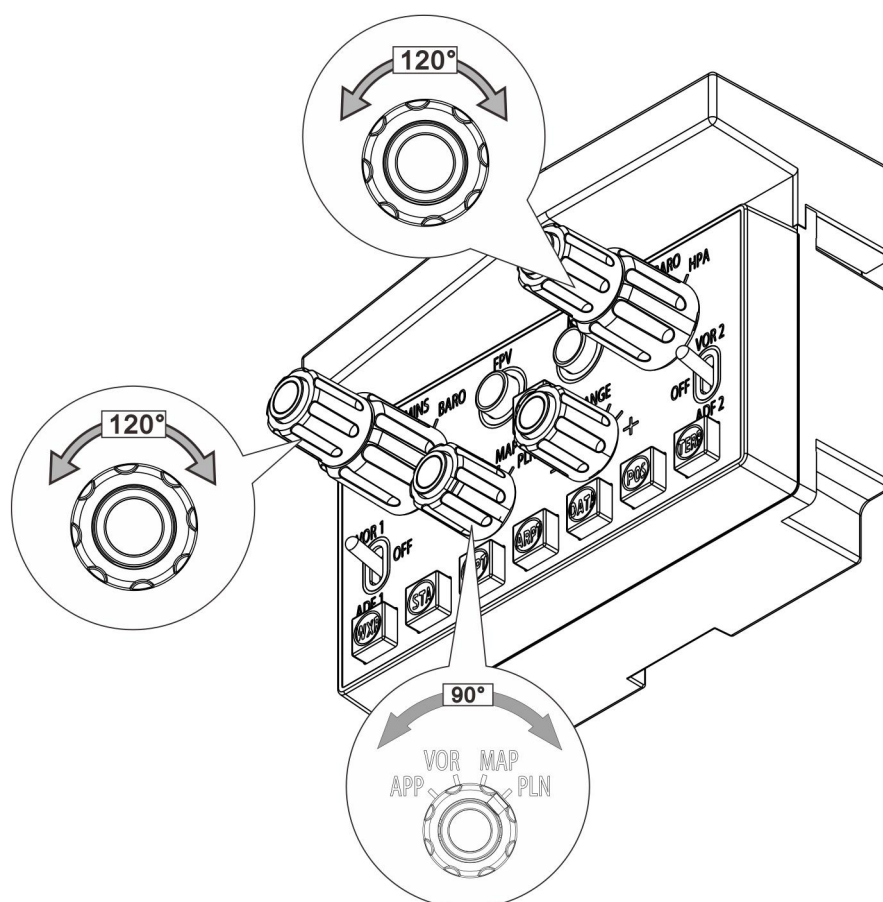

1.2.6 One 4-position selector, with 90° rotation angle, 30° interval.

*NOTE: When outer layer is at PLN position, center switch is non-pressable. Force press may result in product damage.

1.2.7 Two 2-position 2-sided auto-reset selector, with 120° rotation angle, 30° interval. Rotate clockwise/counterclockwise to 1st position (30°) or 2nd position (60°), the selector will auto reset to center position when released. A built-in demarcation tactile feedback is between 1st and 2nd position. *NOTE: Rotation only, do not push/pull. Force push/pull may result in product damage.

1.3 Product Dimensions

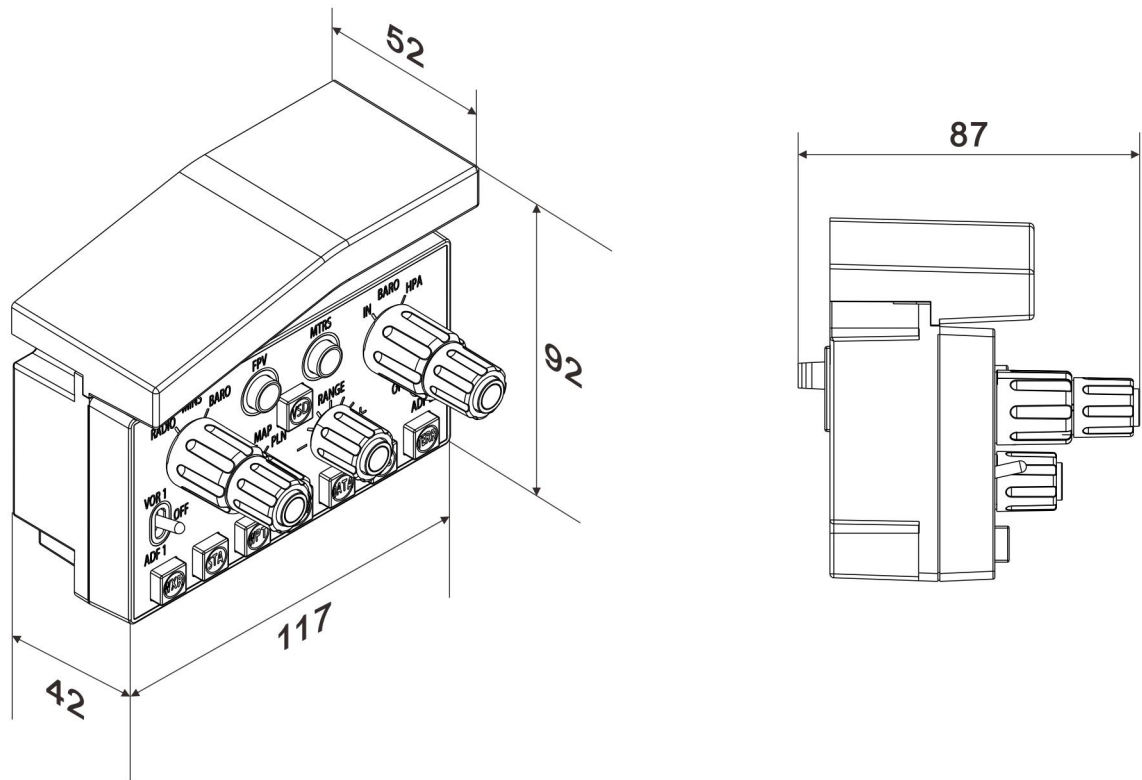

- LxWxH: 117mm*52mm*92mm; Weight: 0.26Kg=0.58lb
- Bracket Dimensions (Hole diameter supports M5 screws)

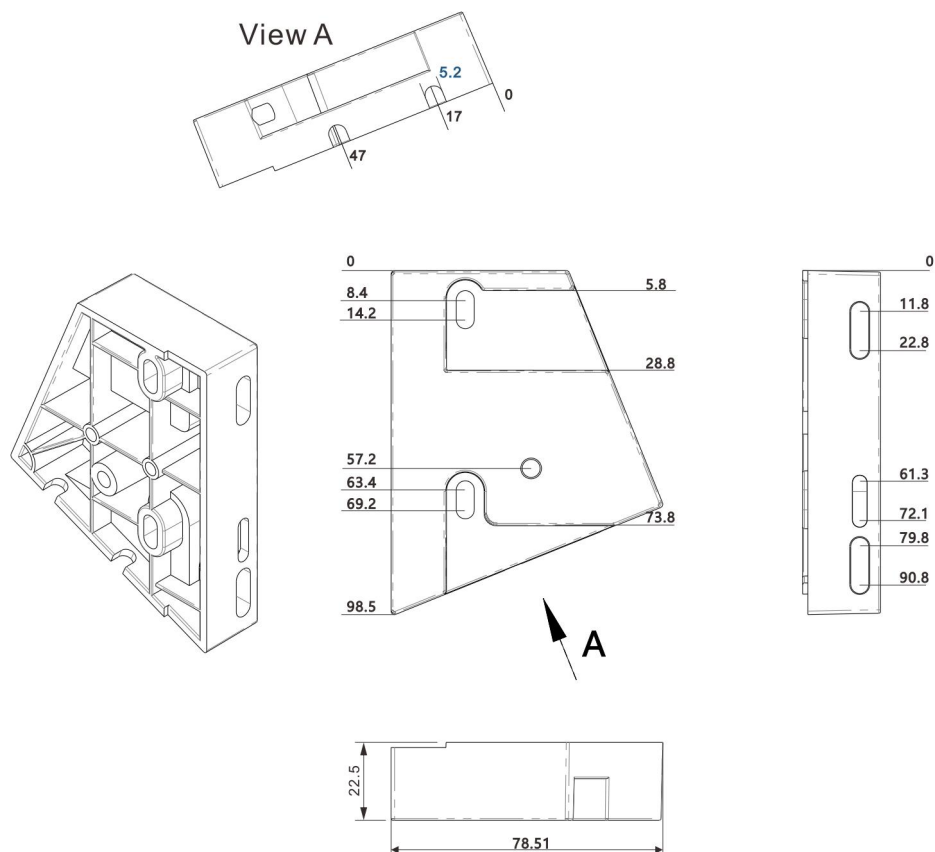

1.4 Installation Dimensions

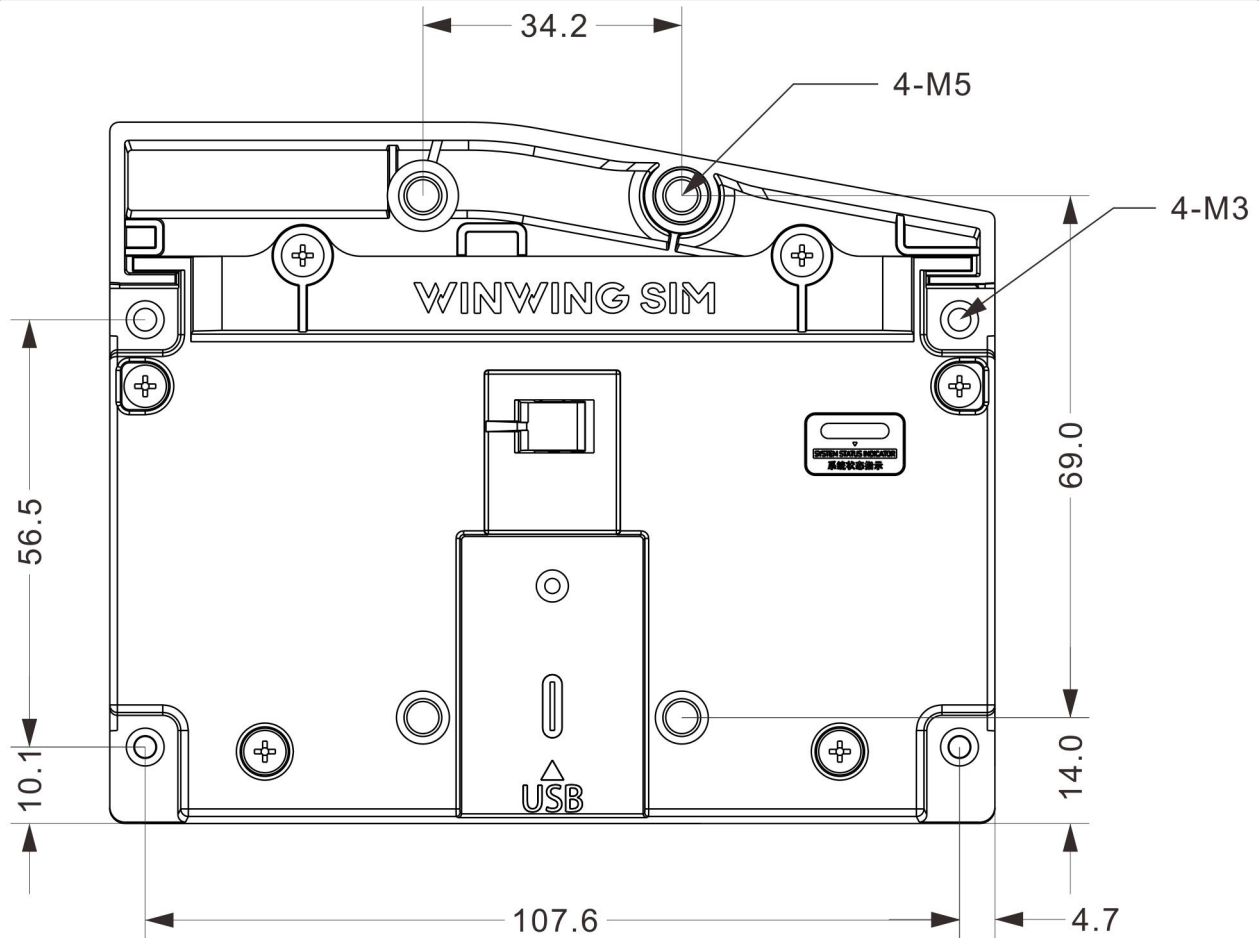

- 4-M5 maximum depth 6mm, 4-M3 maximum depth 4mm
- Picture above is installation dimensions for 3M. PDC 1.0 panel alone

1.5 Installation Compatibility

- Can be used independently.
- Can be paired together with PAP. N. 3N. 1. 1.

2 First Use

2.1 Software Installation

- Download SimAppPro

Download URL:

Mainland China Download Link: <https://cn.winwingsim.com/view/simappro.html>

Global Download Link: <https://winwingsim.com/view/simappro.html>

- Install SimAppPro

Please follow the instructions to install the software, then run the program.

The product can be customized within SimAppPro. (For more details, please refer to the

SimAppPro User Manual.)

- When using the product, please run SimAppPro first before entering the game (the product will automatically adapt to supported games and aircraft models, plug-and-play. For more details, please refer to the SimAppPro User Manual).

SimAppPro User Manual Download Link:

Chinese User Manual

<https://cn.winwingsim.com/view/regular.html#manual-130>

English User Manual

<https://winwingsim.com/view/regular.html#manual-132>

2.2 Parts Installation

- Glare Shield-R installation
- Unscrew and remove the pre-installed glare shield.

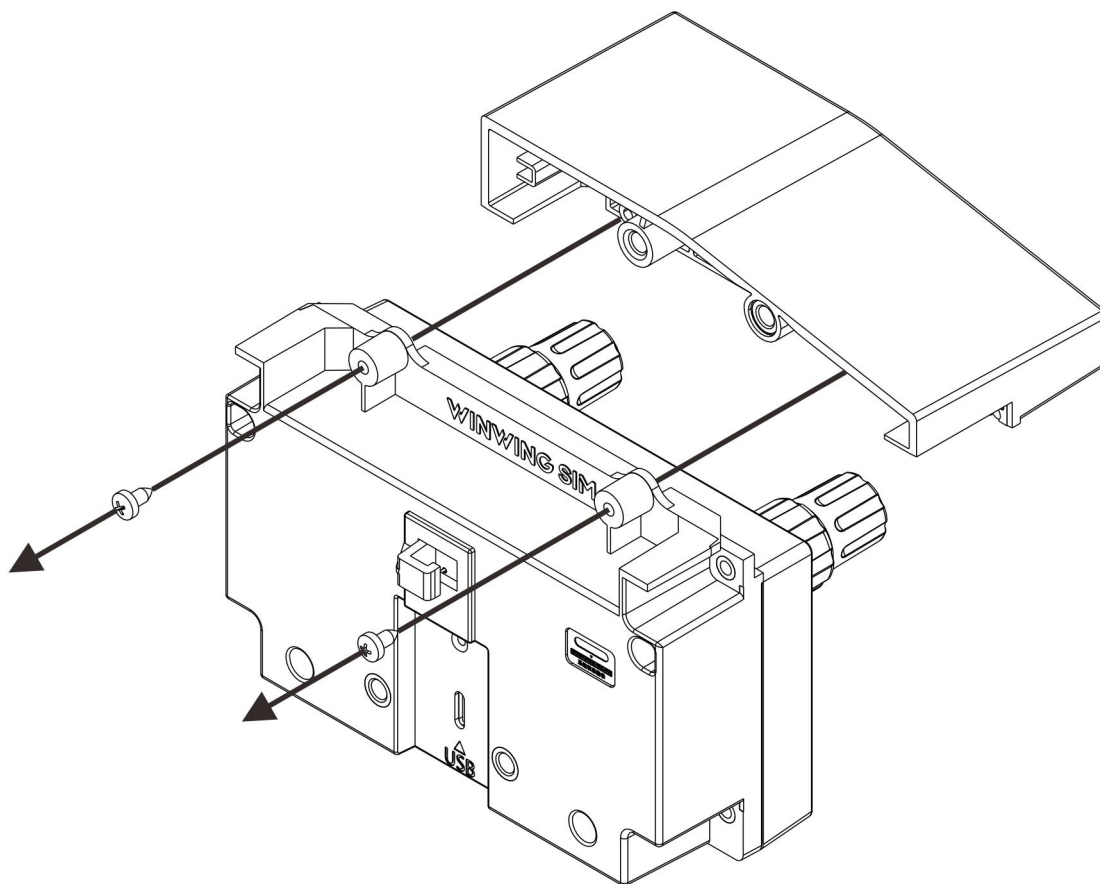

- Install glare shield-R and tighten the original screws.

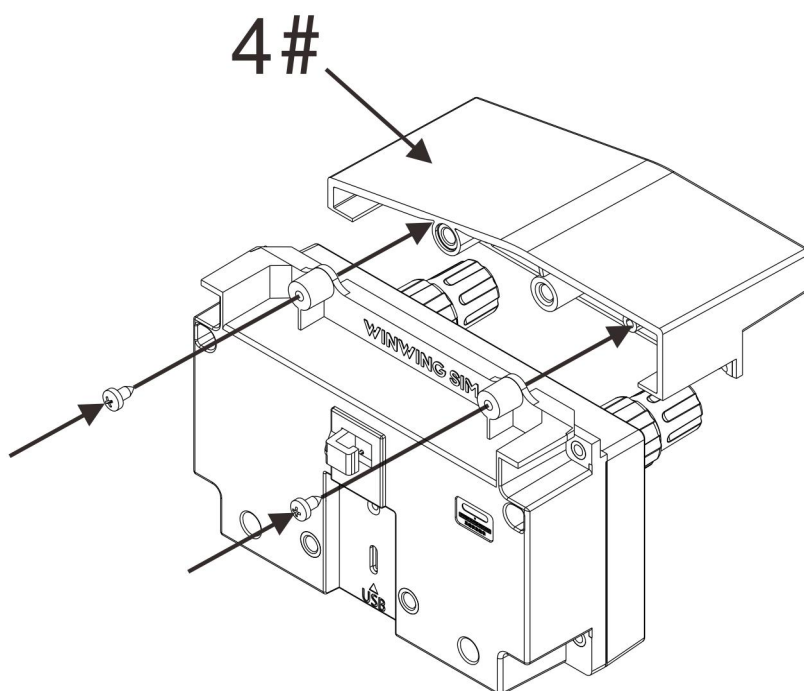

- Tighten the screws until no wobbling; over-tightening may cause damage.

2.3 How to Use

- Device Connection

The product connects to the computer via the data cable in the package. For details on the interfaces, refer to Section 3.3 Data Interface.

How to Connect:

Plug the data cable (14#) into the product's USB port and connect it to your computer.

For products requiring assembly, only the USB port supports hot-swapping. Connect other cables only after USB cable is connected.

(Note: If you need to connect other cables such as PS2, SATA, or aviation connectors, make sure to disconnect the USB cable before proceeding.)

After connecting the product to the computer, secure the cable to the bracket with the R-Shape Cable Clip (see Section 4 Installation Methods for details), so as to prevent damage to the port.

3 Function

3.1 Mechanical and Special Features

(/)

3.2 Buttons

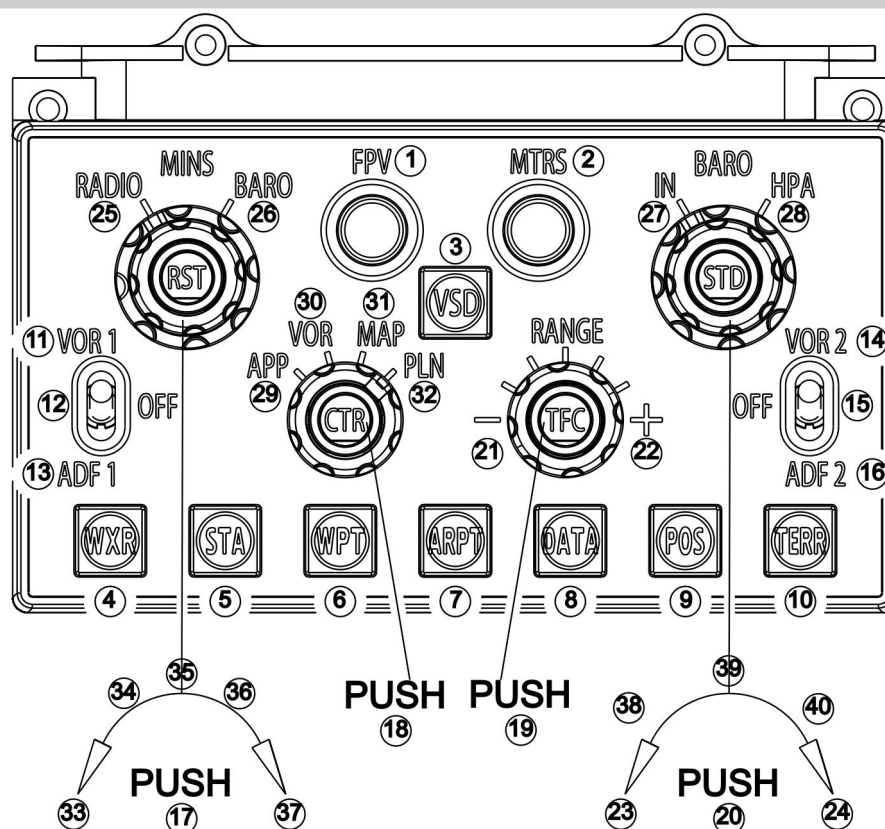

- LED Status Display:
 - Green steady slow flash (1s interval) — BOOT Mode
 - Green slow flash (1s interval) for 5 times, then stay on — Operation Mode
 - Green slow flash (1s interval) for 5 times, then off — Power-Only Mode

3.3 Data Interface

- USB Port (TYPE-C)

Used for transmission and power supply between the product and the computer.

Simply connect this cable to use the product.

Communication Protocol: HID

3.4 Adjustment Method

- The device itself doesn't require adjustment.

4 Installation Methods

4.1 Bracket Mounting Method

4.1.1 Desktop Mounting Method

- Bracket Mounting Method: Install the bracket at a 68° angle to the desktop.

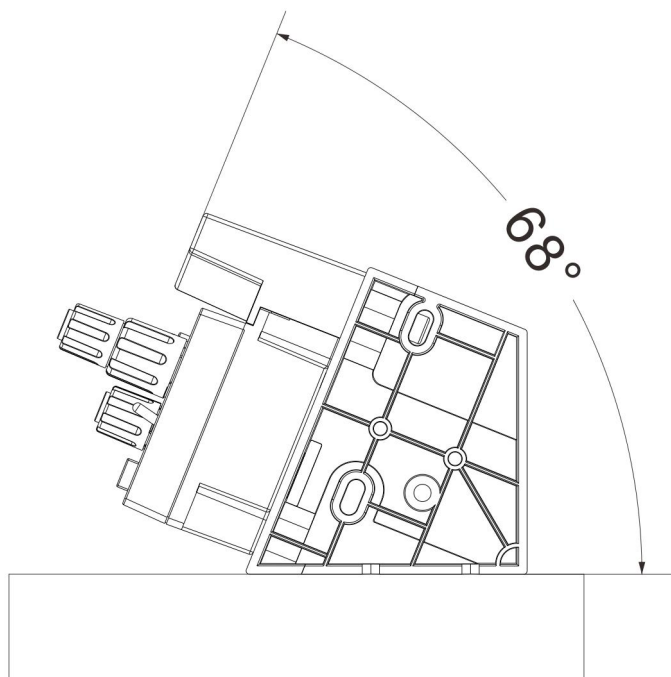

- Plug in USB data cable, set cable into the slot, and secure it to the bracket using the R-Shape Cable Clip.

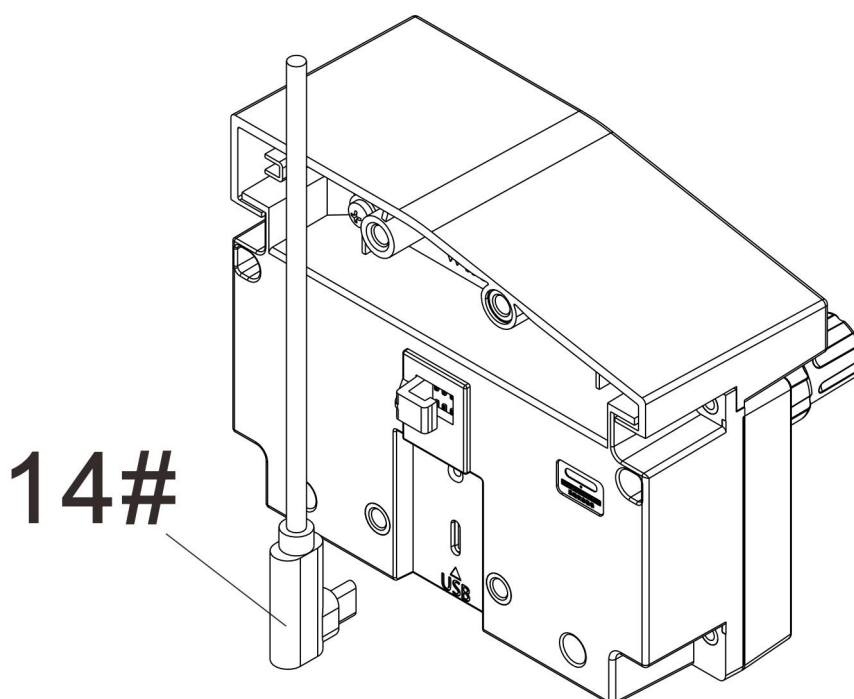

Mounting bracket 2-left 3 and mounting bracket 2-right 3 Mounting Method:

- Screw in but do not tighten them yet;

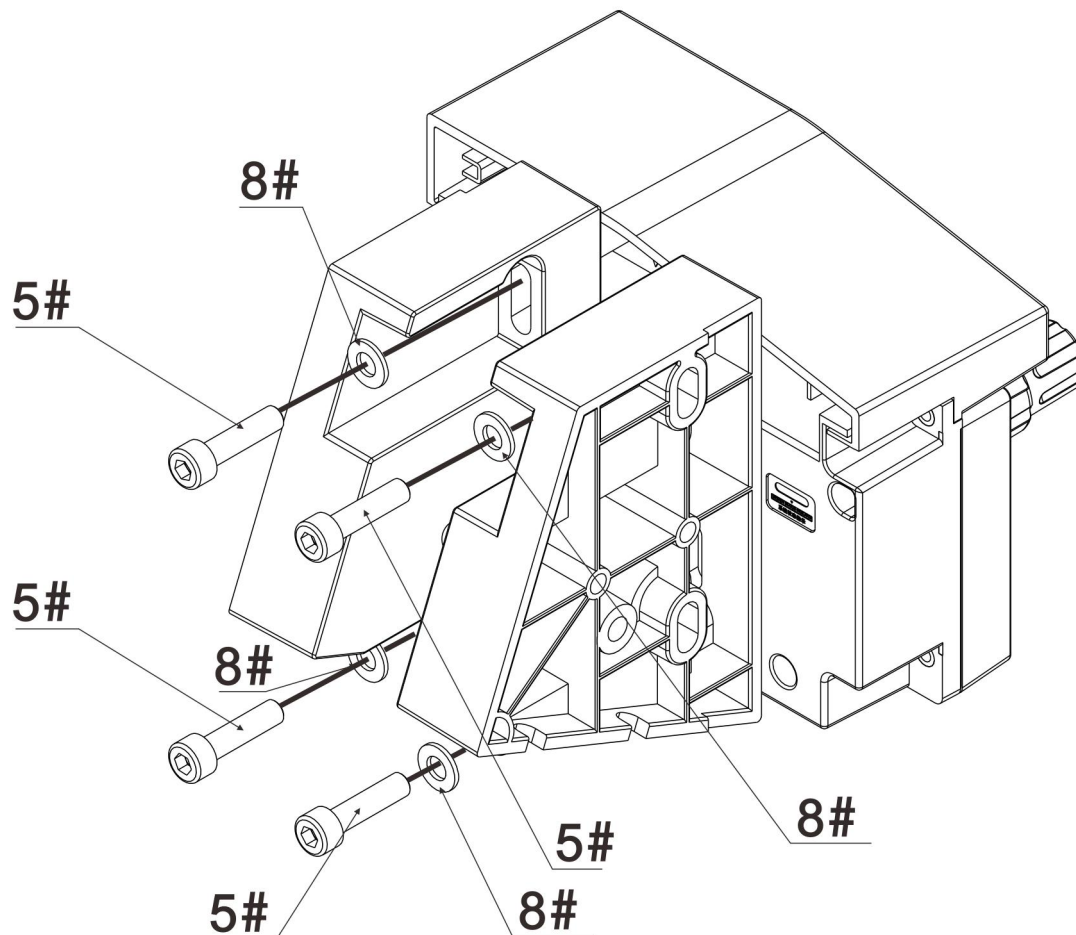

- Adjust the bracket position up and down until it is stable on the desktop, then tighten the screws.
- Tighten the screws until no wobbling; over-tightening may cause damage.

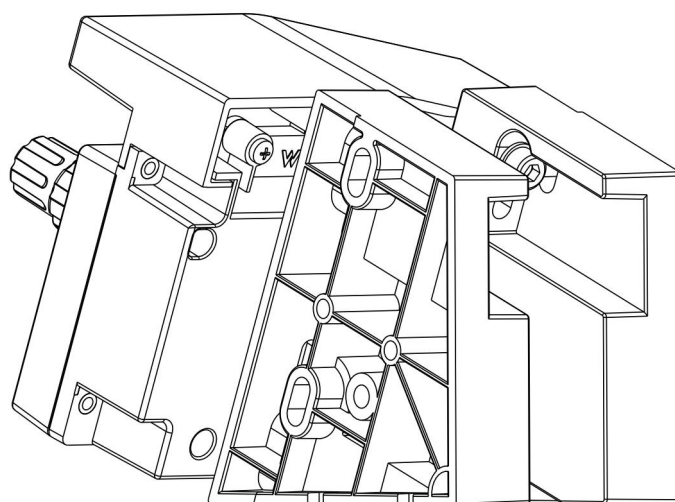

- Apply the Nano Double Sided Adhesive Dots (15#) to the bottom of the brackets:
- Clean the dust off the bracket surface before mounting;

- Press the dots firmly for at least 10 seconds and let it sit for 30 minutes to ensure the best adhesive effect;
- For single-use only on clean and smooth surfaces. Do not apply to surfaces with wax, oil, water stains, dust, dirt, or rough textures to avoid improper adhesion and potential detachment;
- The ideal temperature for application is between 10° C and 40° C.

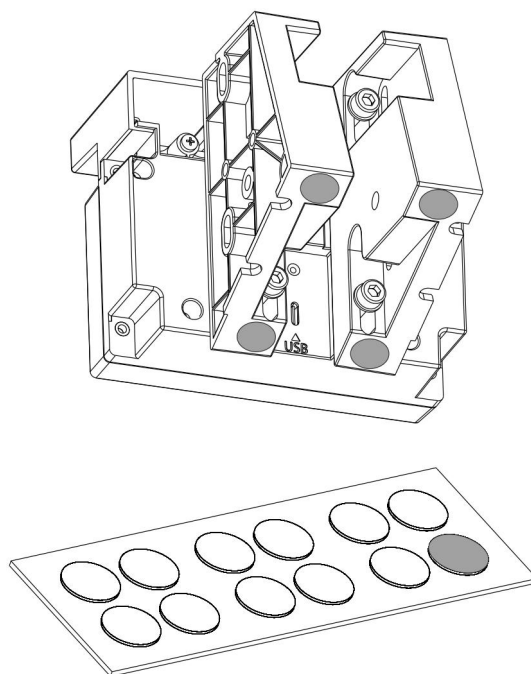

4.2 Integrated Device Assembly Method

4.2.1 Desktop mounting with PAP.N.3N.1.1 (PAP.N.3N.1.1 is sold separately, for detailed dimensions please refer to Panel of Auto Pilot 3 User Manual)

- Remove the screws, keep the nuts.

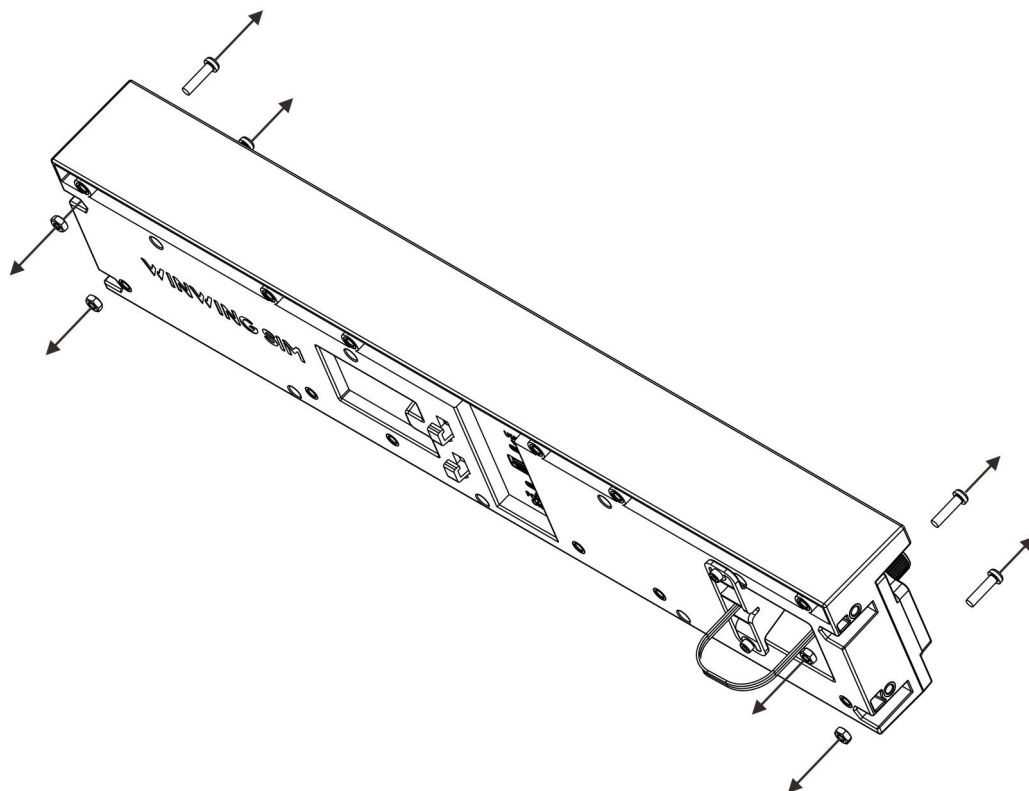

- Connect PCD.L. 3N.1.1 with PAP.N. 3N.1.1.

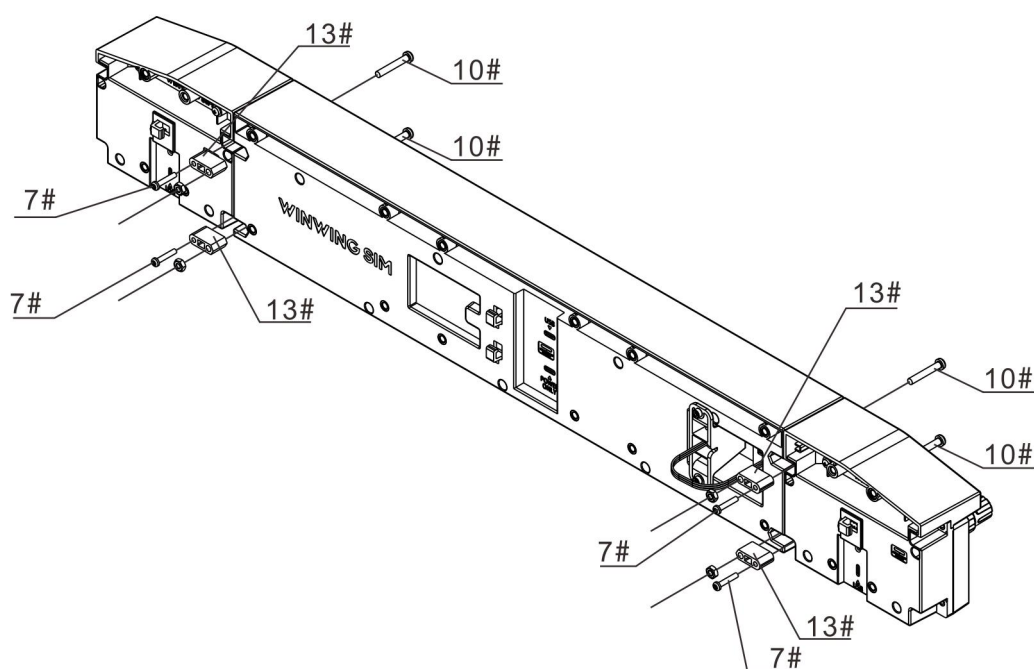

- Install PCD.L. 3N.1.1 and PAP.N. 3N.1.1 bracket, screw in but do not tighten them yet;

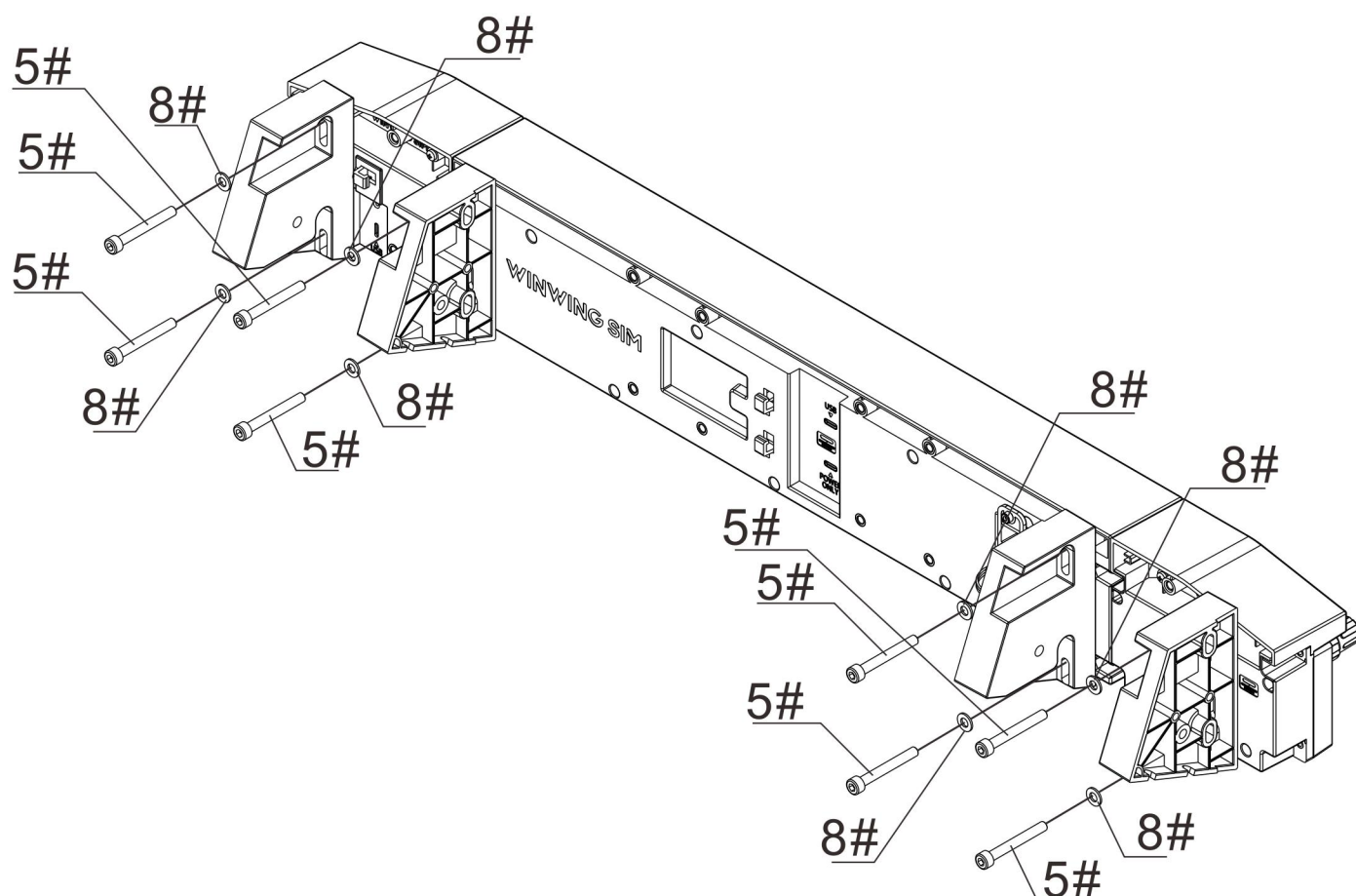

- Adjust the bracket position up and down until it is stable on the desktop, then tighten the screws;
- Tighten the screws until no wobbling; over-tightening may cause damage

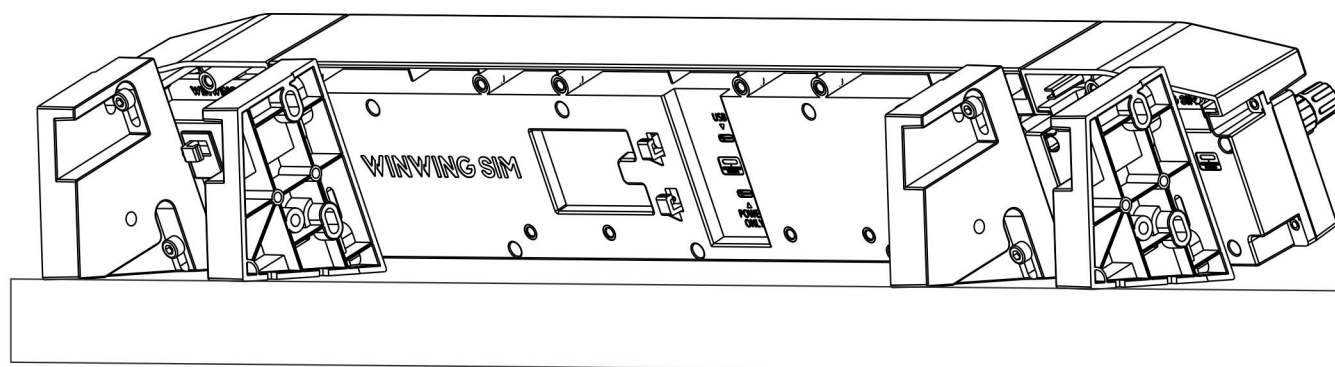

- Apply the Nano Double Sided Adhesive Dots (15#) to the bottom of the brackets:
- Clean the dust off the bracket surface before mounting.
- Press the dots firmly for at least 10 seconds and let it sit for 30 minutes to ensure the best adhesive effect;
- For single-use only on clean and smooth surfaces. Do not apply to surfaces with wax, oil, water stains, dust, dirt, or rough textures to avoid improper adhesion and potential detachment;
- The ideal temperature for application is between 10° C and 40° C

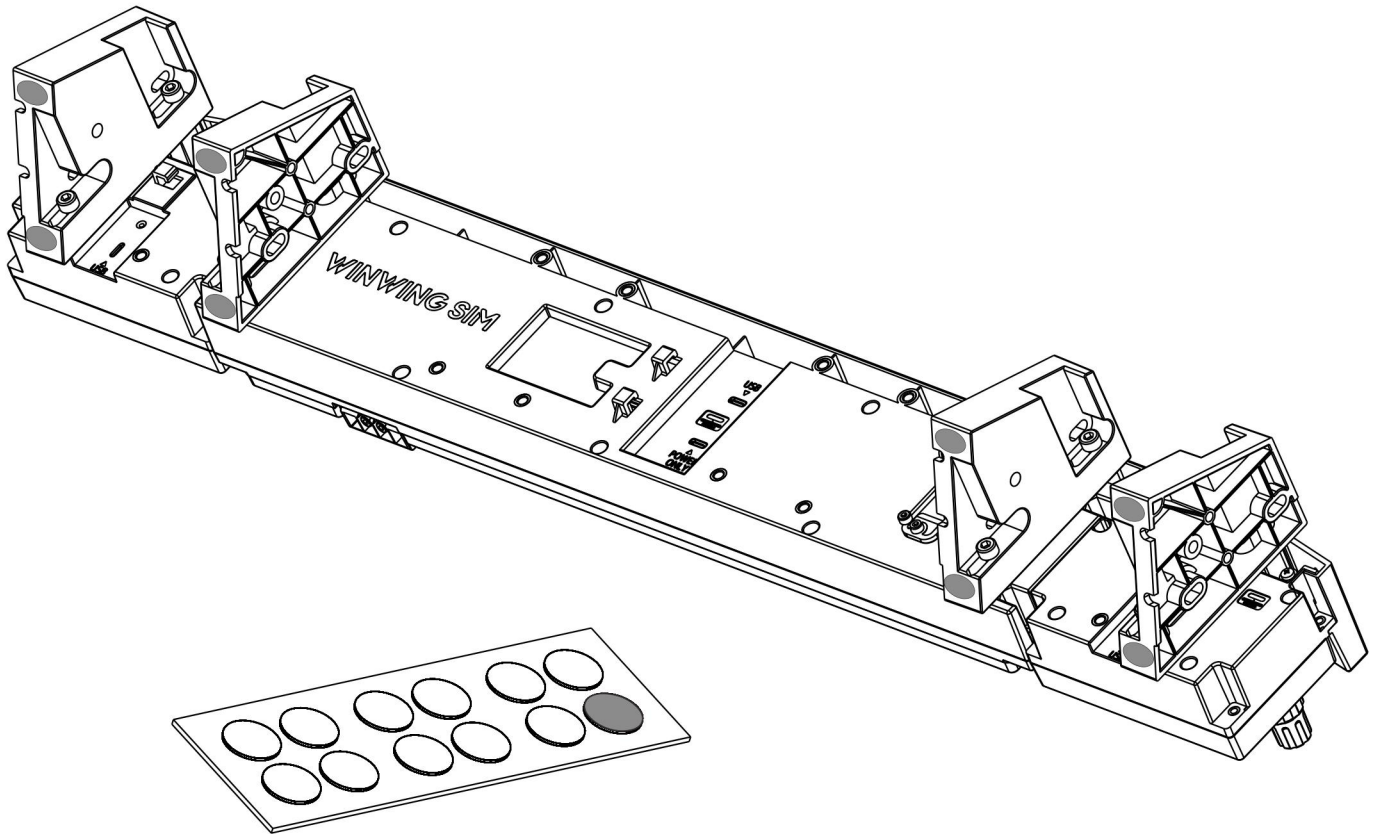

4. 2. 2 Mounting with PAP. N. 3N. 1. 1 and Panel Mount1 (MP1). * The Panel Mount1 (MP1) is sold separately.

Panel Mount (MP1) List

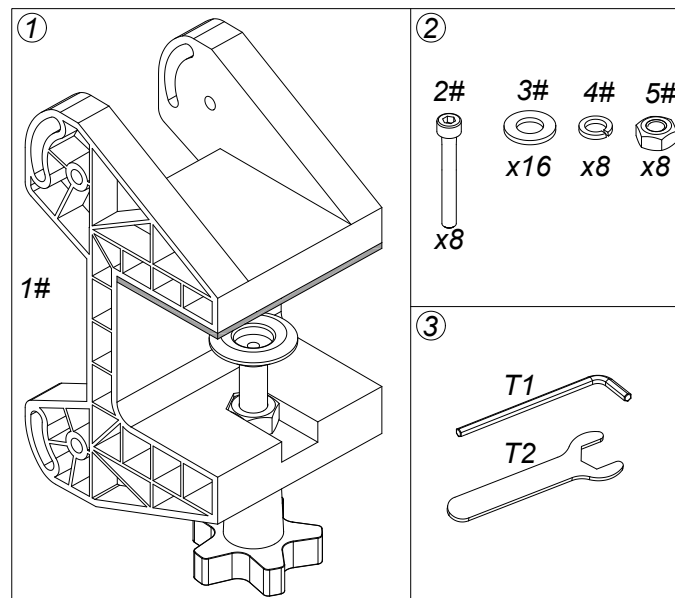

In this section, the materials shown in the figure will be described respectively as “MP1+NUMBER” (such as MP1+1#, MP1+2#, MP1+3#...)

- Remove the screws, keep the nuts.

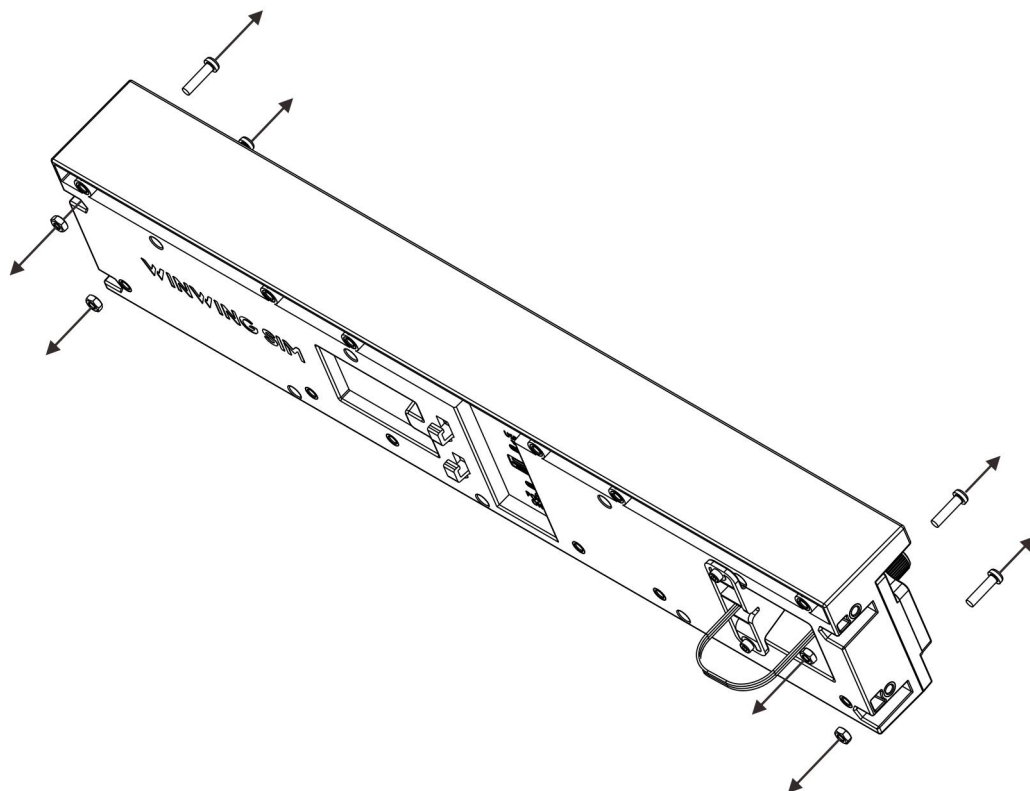

- Connect PCD.L. 3N.1.1 with PAP.N. 3N.1.1.

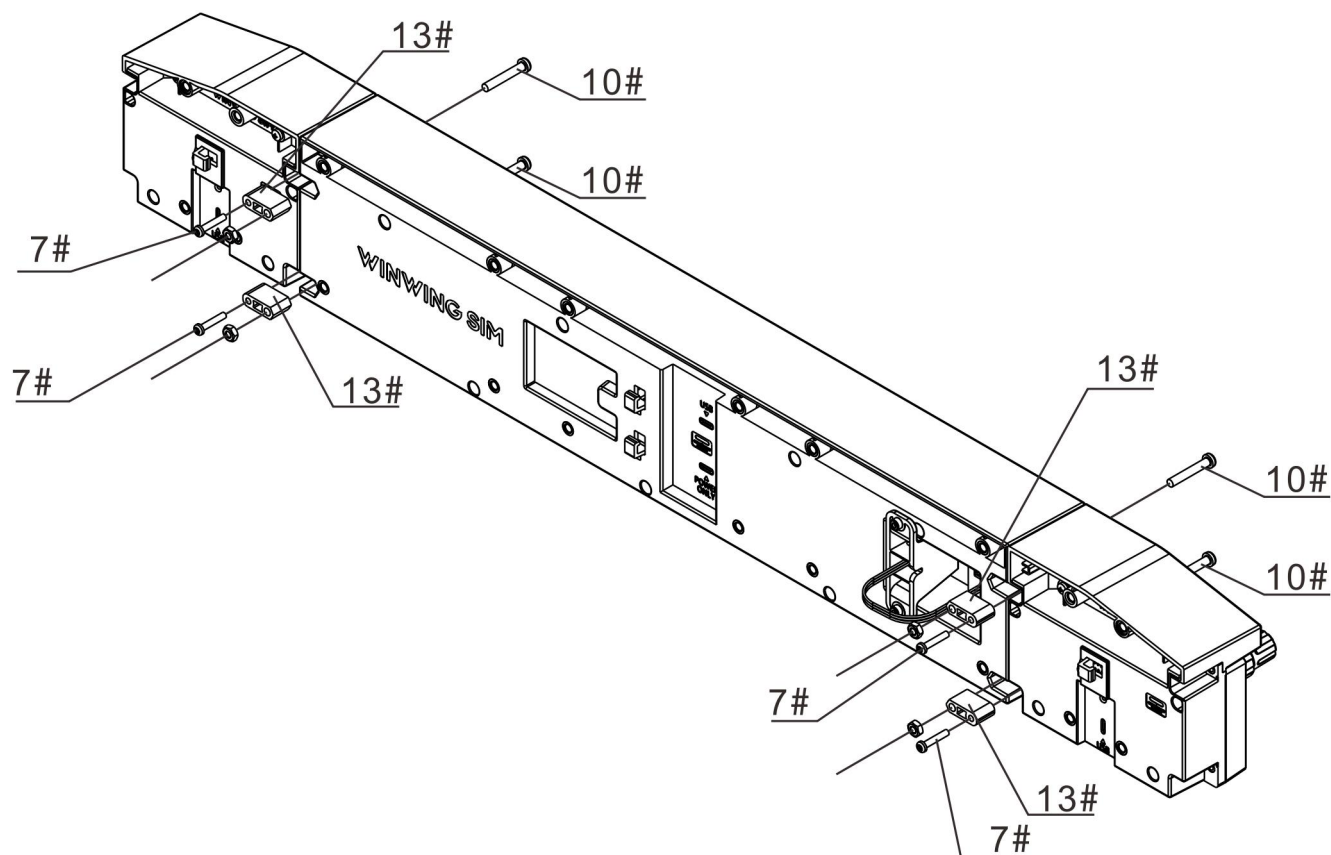

- Install PCD.L. 3N.1.1 and PAP.N. 3N.1.1 bracket, screw in but do not tighten them yet;

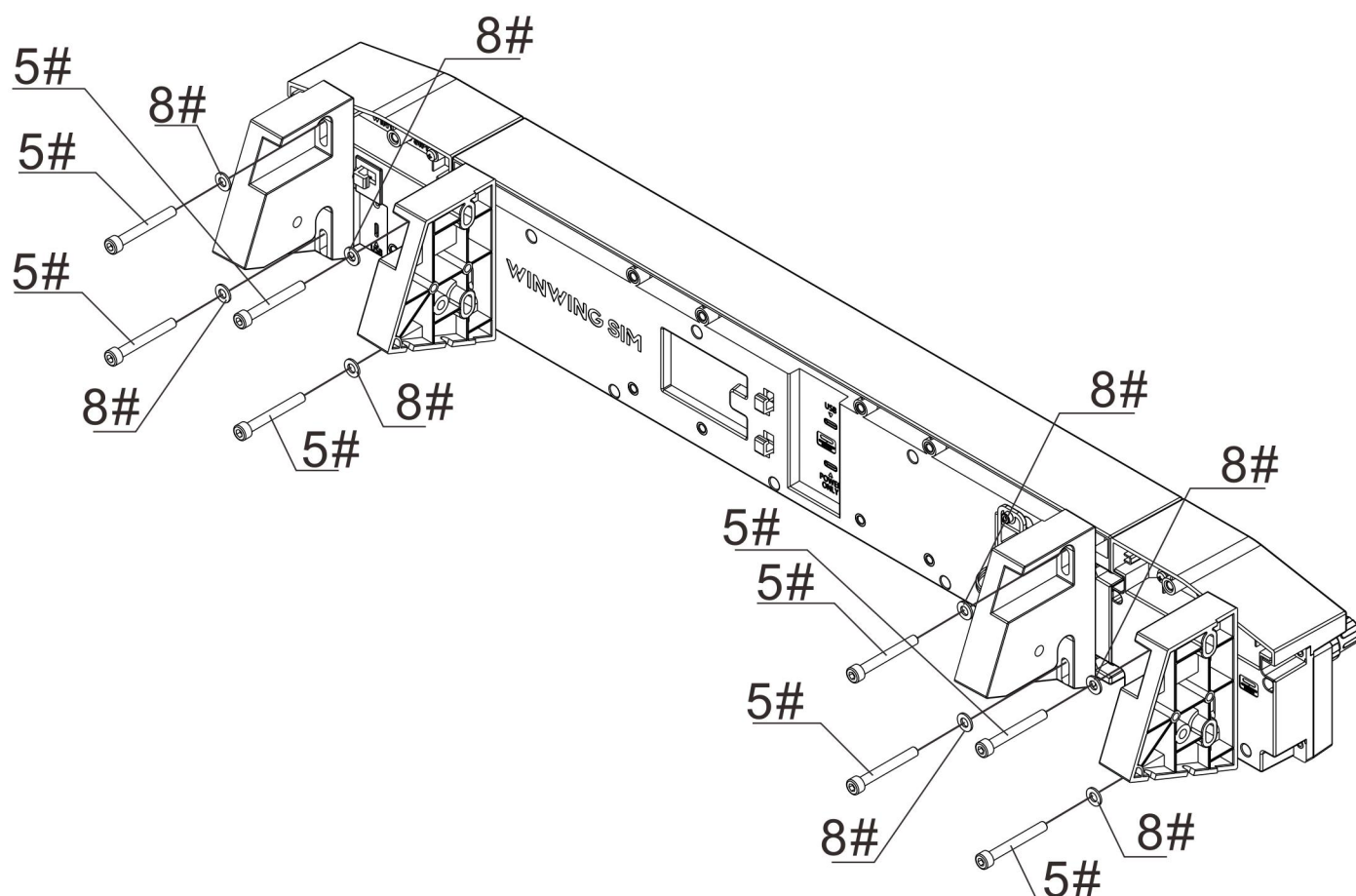

- Plug in USB data cable, set cable into the slot, and secure it to bracket using the R-Shape Cable Clip.

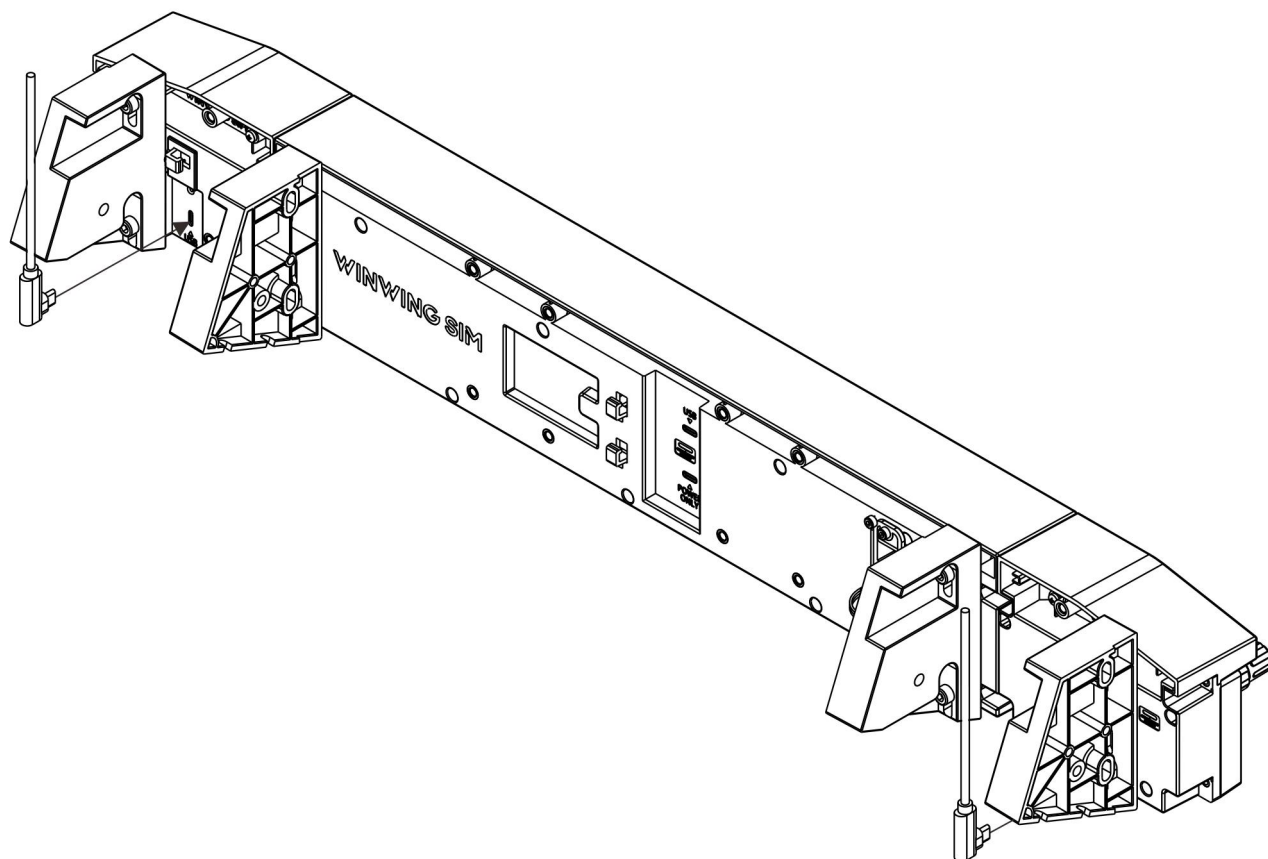

- Adjust the bracket position up and down until the holes match the ones on Panel Mount1 (MP1), then tighten the screws;
- Tighten the screws until no wobbling; over-tightening may cause damage.

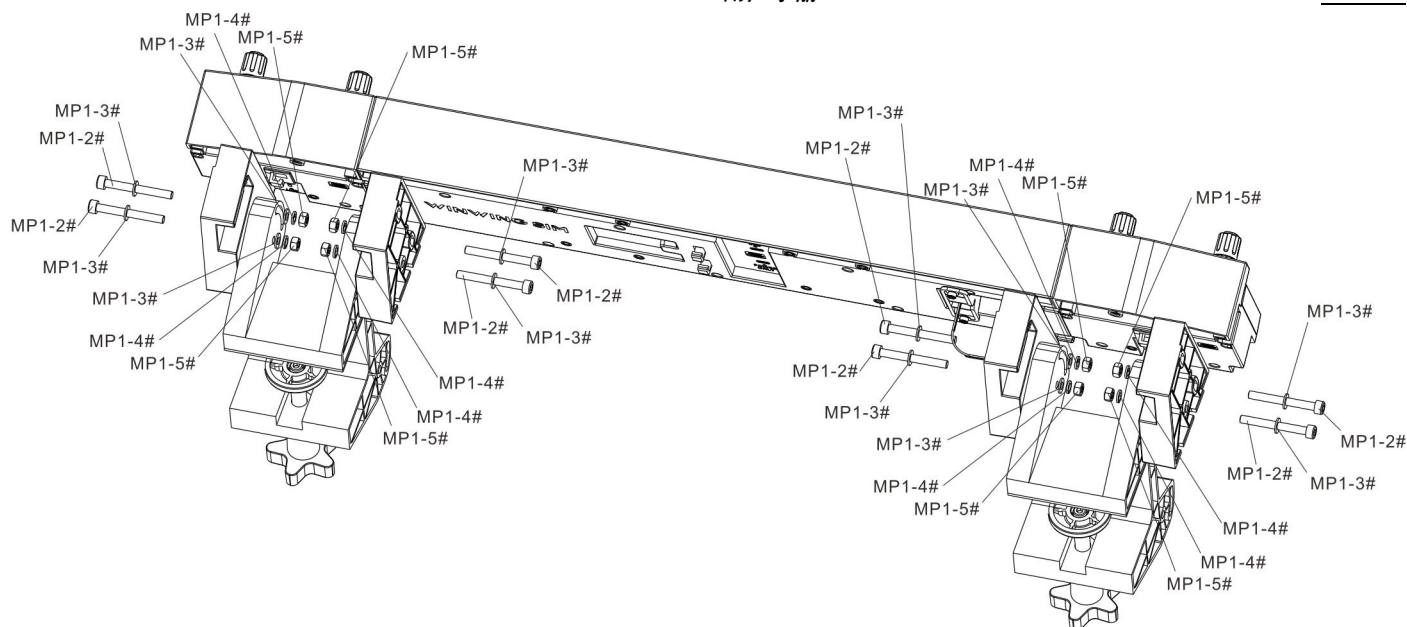

● MP1 Bracket Mounting

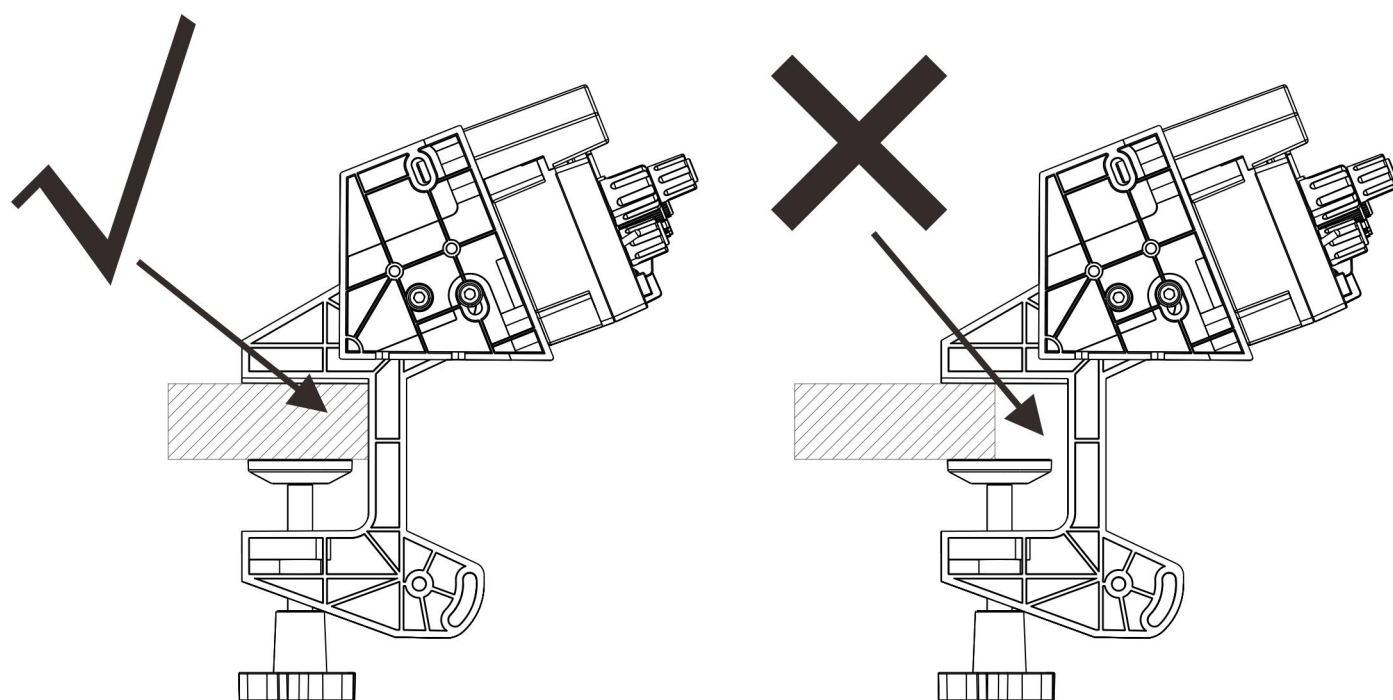

- Clean the dust off the bracket surface before mounting;
- Adjust the bracket position up and down until it is stable on the desktop, then tighten the screws;
- Tighten the screws until no wobbling; over-tightening may cause damage.

5 Maintenance and Care

5.1 Firmware Upgrade

- Use SimAppPro to upgrade firmware

Before upgrading, ensure the product is securely connected and follow the instructions on the SimAppPro interface.

If you encounter issues during the upgrade, try restarting SimAppPro and reconnecting the device. *NOTE: Other cables, such as PS2, SATA, or aviation connectors, do not support hot-swapping. Remove USB cable before connecting other cables.

If you still fail to upgrade, please contact Customer Service for technical support.

5.2 Cleaning and Maintenance

- To prevent accidental dust and dirt entering its interior, the product features a dust-proof design. However, it cannot guarantee complete prevention from dirt, dust, water or salt. Please keep the product clean and avoid above debris as much as possible.
- It is recommended to clean the product after use. Allowing dirt, dust, water or salt to remain on the product may cause malfunction.
- Do not place the product near objects with strong magnetic fields, such as magnets or electric motors. Strong magnetic fields may cause abnormal data from the product.
- Do not place the product in high-temperature areas, such as being exposed to direct sunlight inside a car. High temperatures may cause product malfunction.
- The product contains precision electronic circuits. Do not disassemble the product by yourself.
- Do not touch the product's electronic contacts with your fingers to avoid corrosion. Corroded contacts may lead to product malfunction.
- If the product is suddenly moved from a low-temperature environment to a warm room, condensation may form on the surface and interior. To prevent condensation, place the product in a sealed plastic bag and wait for the temperature to gradually rise before removing it from the bag.
- If condensation occurs on the product, refrain from using it to avoid damage. Wait for all moisture to evaporate before continuing to use the product. Even the product is fully dried, the internal components may still be at a low temperature.
- Avoid storing the product in chemical laboratories or areas with chemicals that may cause rust or corrosion.
- Use only original parts for maintenance and replacement.

5.3 FAQs and After-Sales Service

Frequently Asked Questions:

- If the product is experiencing abnormalities, please check if the firmware and SimAppPro version are up-to-date. Upgrade if necessary.
- If you experience signal instability or drift during use, try re-calibrating within SimAppPro or clearing the game controller data in Windows.
- If the product is having issues with unstable connection or is not recognized by the computer, try switching to a different USB port (it is recommended to use a USB port directly on the motherboard or a three-prong USB hub with independent power and proper grounding). Also, try cleaning the data cable's connectors with alcohol or replacing the cable to see if the signal stabilizes. *NOTE: If you need to connect other interfaces, such as PS2, SATA, or aviation connectors, please disconnect the USB cable first before proceeding.
- After connecting the product to the computer, make sure to secure the cables in the fixed clips to prevent damage to the connectors.
- When assembling and connecting the product and accessories, ensure that the screws

are tightened correctly and that no components are loose or over-tightened. Incorrect handling may cause unusual sounds during operation.

- When using a USB hub to connect the product, ensure that the three-prong hub has independent power supply and proper grounding. Otherwise, the product's signal may be unstable.

6 Safety Precautions

For safe use of the product, please be sure to read and follow these precautions to prevent harm or injury.

- Keep the product out of the reach of children.
- Swallowing product parts or accessories is extremely dangerous. If swallowed accidentally, seek medical attention immediately.
- Use only the intended power supply specified in the product user manual.
- Do not disassemble or modify the product.
- Do not subject the product to strong impacts or vibrations.
- Do not touch any exposed internal components.
- If the product emits smoke, unusual odor, or exhibits any abnormal behavior, stop using it immediately.
- Do not clean the product surface with organic solvents such as alcohol, gasoline, or paint thinner.
- Do not get the product wet, and do not insert foreign objects or pour liquids into the product.
- Do not use the product in environments where flammable gases may be present, as static electricity may cause explosions or fires.
- During thunderstorms, do not touch the product connected to a power outlet, as this may result in electric shock.

Disclaimer

Please read and understand the contents of the product user manual carefully. Failure to follow the instructions may result in personal injury or damage to the product.

Ensure that all personnel using this product are familiar with and understand the user manual for best utility.

Any personal injury, property damage, or product damage resulting from improper use or failure to follow the user manual will be the sole responsibility of the user. The company will not be held liable for such incidents.

When users are using the product:

Users should install, handle, store, use, maintain, and dispose of the product according to the product guidelines, relevant laws, regulations, and safety standards, without violating any applicable laws.

Since the conditions and methods in which the user uses this product are beyond the control of the company, the company is not liable for any consequences arising from the following situations. The responsibility lies solely with the user:

- Personal injury, property damage, or product damage caused by improper user operation, failure to follow the product user manual, or other uncertain factors.
- Changes in the product's technical specifications, data, or content of the user manual due to improvements in reliability, functionality, design, or other reasons, without prior notice.

NO: 20241018-01A-P

WINWING SIM

WINWINGSIM.COM