

# WINWING SIM

Panel of Auto Pilot 3

Model: PAP.N.3N.1.1

User Manual

V1.0 2025.03.06

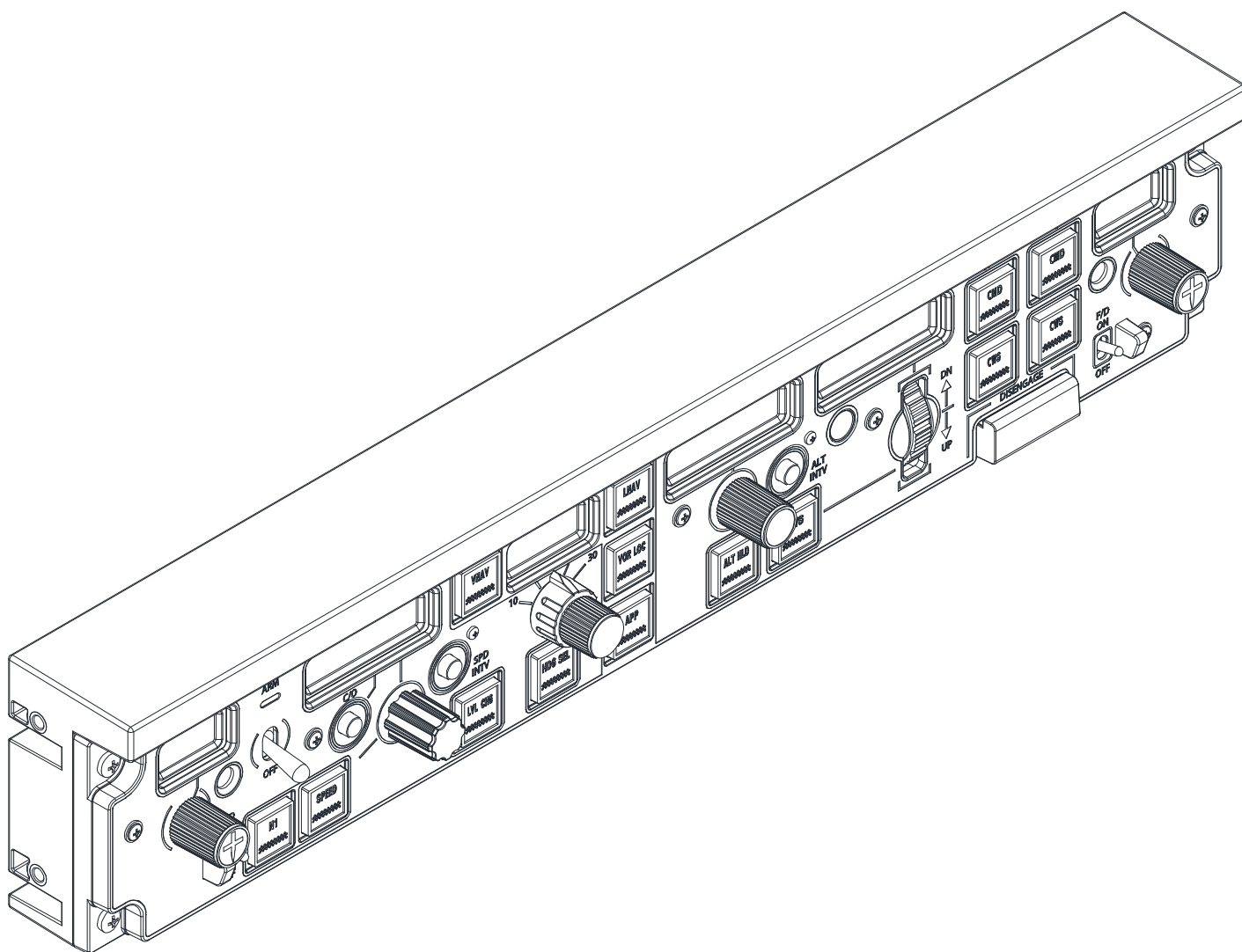

# Packing list

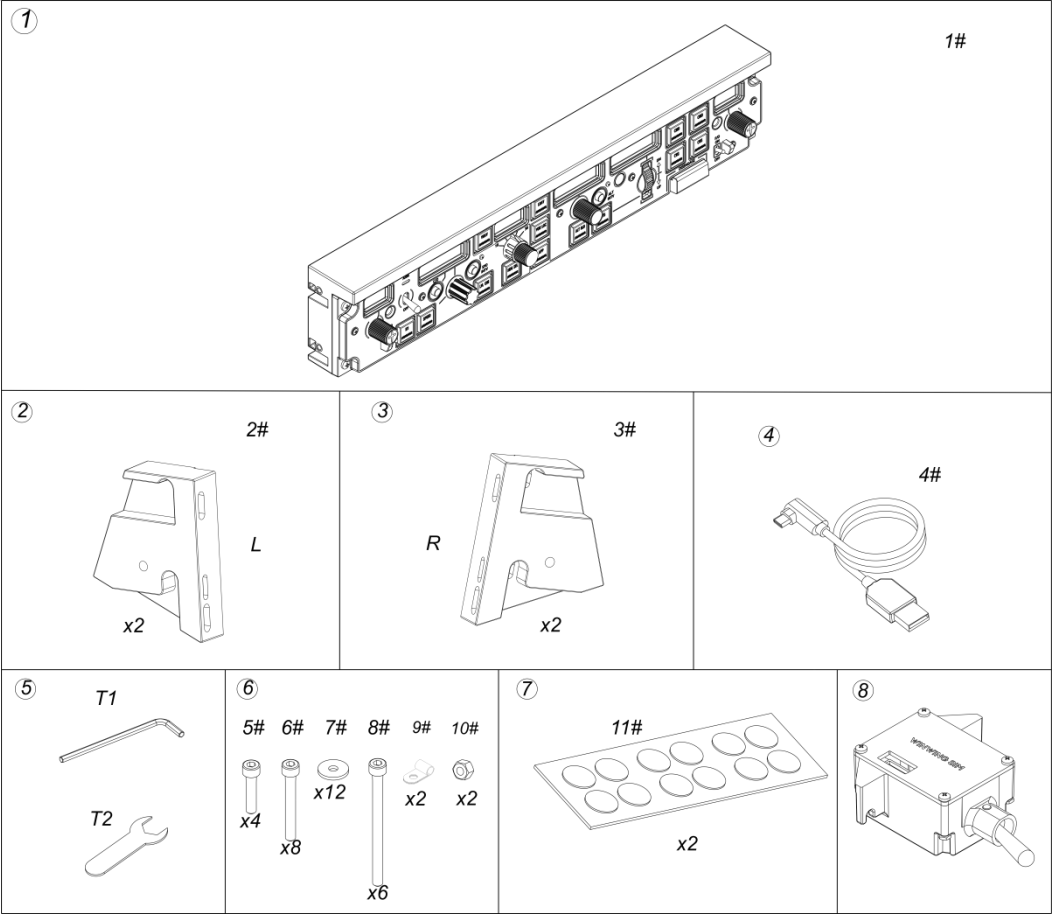

①. PAP.N.3N.1.1 (1#)	1
②. Mounting Bracket-Left (2#)	2
③. Mounting Bracket-Right (3#)	2
④. Data Cable (4#)	1
⑤. Tool Bag (T1、T2)	1
⑥. Accessory Bag (5#~10#)	1
5#: Socket Cap Screw M5*16;	
6#: Socket Cap Screw M5*22;	
7#: Flat Washer M5*10*1;	
8#: Socket Cap Screw M5*40;	
9#: R Shape Cable Clip UC-0.5 Black;	
10#:Hexagon Nut M5 304;	
⑦. Nano Double Sided Adhesive Dots (7#)	2
⑧. Magnetic Switch (sold separately) (8#)	1

## Catalog

1. Product Profile .....	4
1.1 Parts Diagram .....	4
1.2 Performance Specifications .....	5
1.3 Product Dimensions .....	7
1.4 Installation Dimensions .....	8
1.5 Installation Compatibility .....	10
2 First Use .....	11
2.1 Software Installation .....	11
2.2 Parts Installation .....	11
2.3 How to Use .....	12
3 Function .....	13
3.1 Mechanical and Special Features .....	13
3.2 Buttons .....	13
3.3 Data Interface .....	14
3.4 Adjustment Method .....	14
4 Installation Methods .....	15
4.1 Desktop Mounting Method .....	15
4.2 Profile Installation (*Profile rails and related accessories are required and not included.) .....	22
4.3 Integrated Device Installation .....	23
4.4 Magnetic Switch Installation (*Magnetic Switch is sold separately) .....	30
5 Maintenance and Care .....	31

5.1 Firmware Upgrade .....	31
5.2 Cleaning and Maintenance .....	32
5.3 FAQs and After-Sales Service .....	33
6 Safety Precautions .....	34



# 1. Product Profile

## 1.1 Parts Diagram

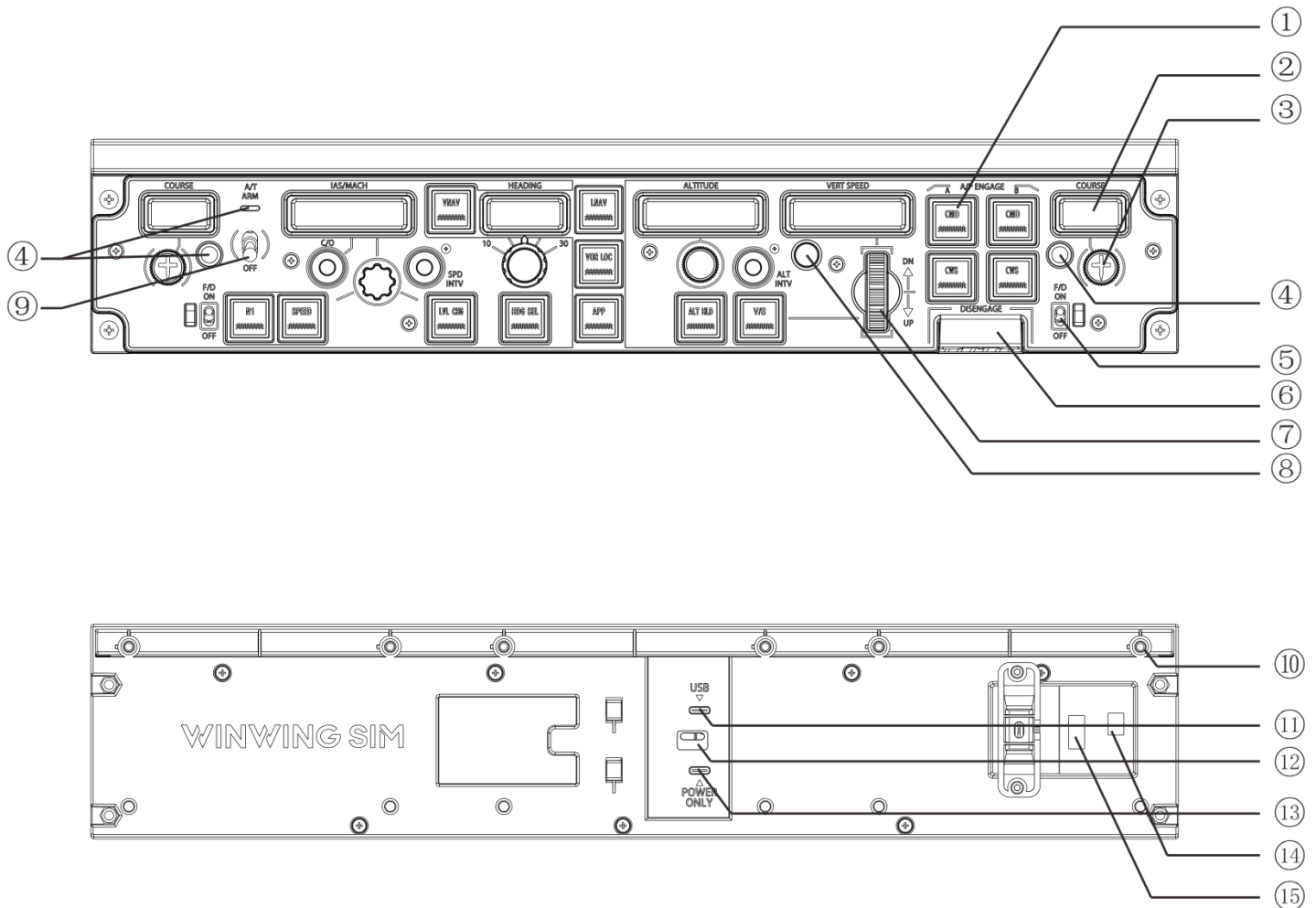

① Push Button

② Display

③ Rotary Switch

④ Indicator Light

⑤ 2-Position Toggle Switch

⑥ 2-Position Switch

⑦ Thumb Wheel Switch

⑧ Light Sensor Unit

⑨ 2-Position Auto-Reset Toggle Switch

Switch

⑩ Mounting Holes for Included Brackets

⑪ USB Data Port (TYPE-C)

⑫ LED Indicator

⑬ POWER ONLY Port (5V Voltage)

⑭ 2-Position Auto-Reset Switch Port

⑮ Reserved Magnetic Switch Port

## 1.2 Performance Specifications

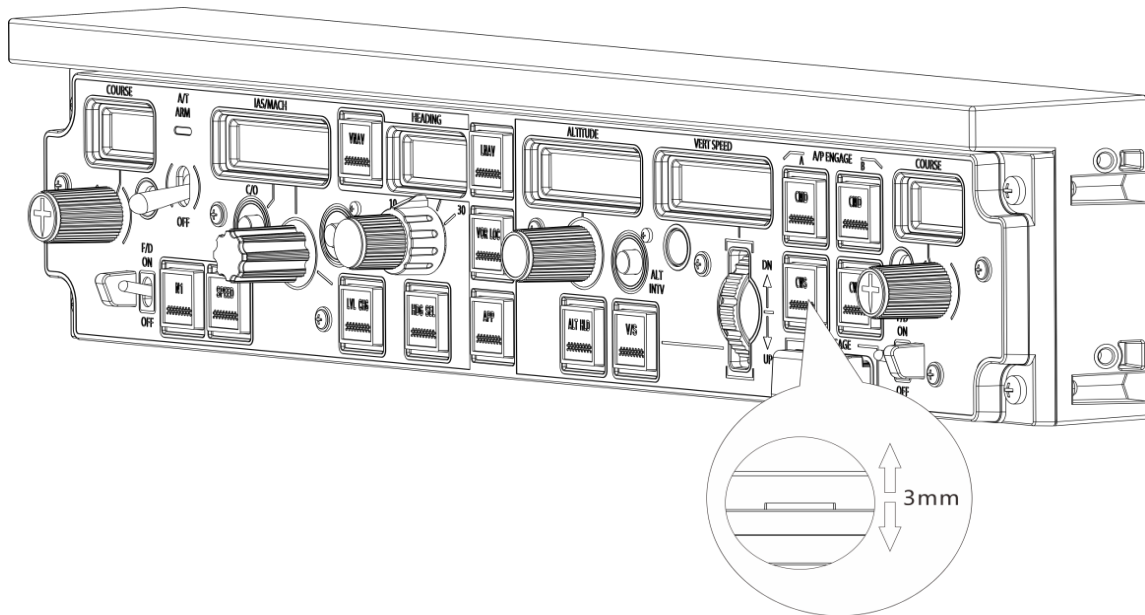

### 1.2.1 17 push buttons, with press travel of 3mm.

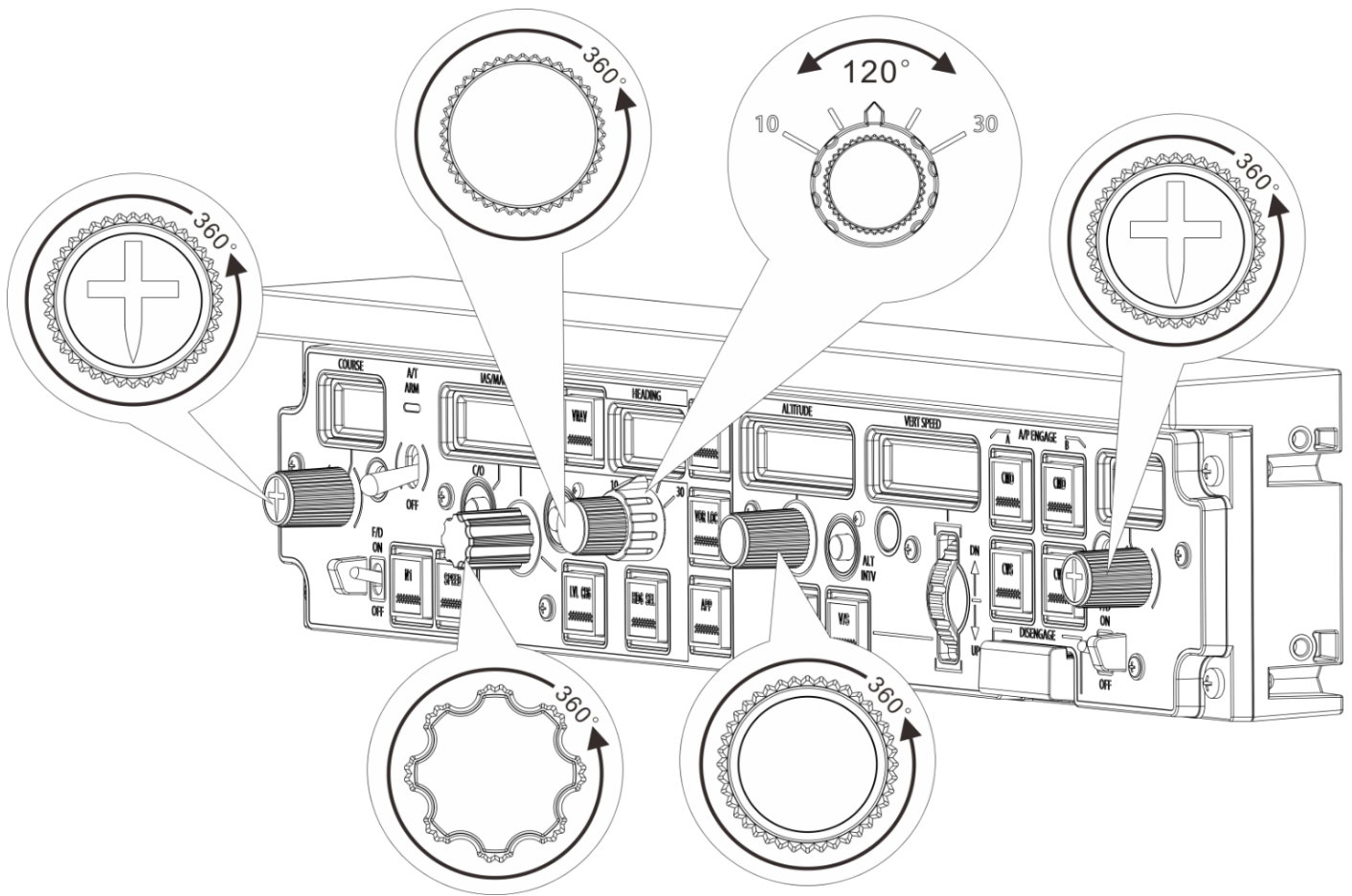

### 1.2.2 5 knobs, with rotation angle of 360° (no detent). NOTE: Only rotate is allowed, do not push/pull. Push/pull with excessive force may result in product damage.

1.2.3 Rotation angle of  $120^\circ$  for the 5-position knob. NOTE: Only rotate, do not push/pull. Push/pull with excessive force may result in product damage.

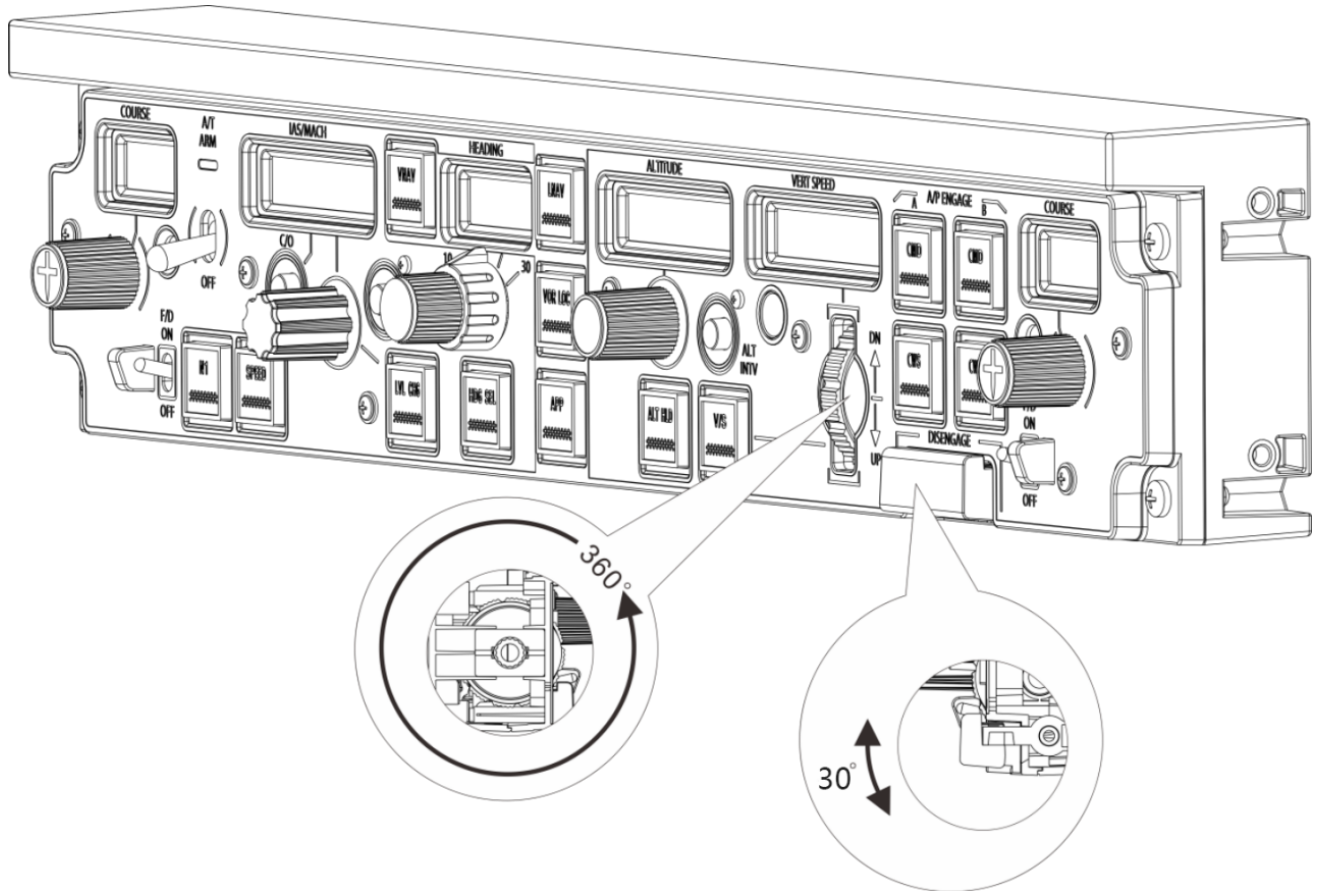

1.2.4 Thumb wheel switch with rotation angle of  $360^\circ$  (no detent). NOTE: Do not place radial excessive force on the switch, push with excessive force may result in product damage.

1.2.5 2-position switch with travel angle of  $30^\circ$ . NOTE: Do not place excessive force on the switch, push with excessive force may result in product damage.

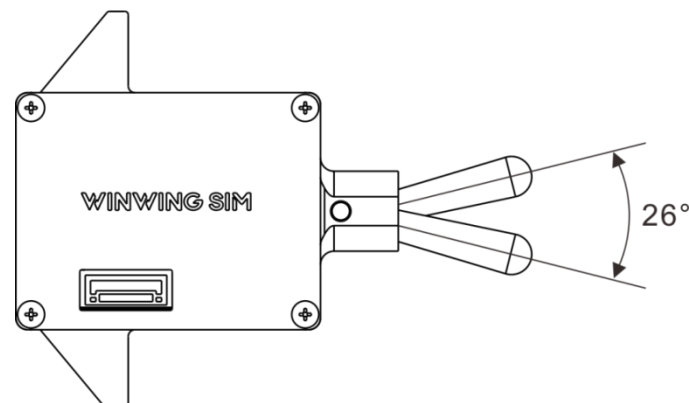

1.2.6 Magnetic switch (sold separately) with travel angle of  $26^\circ$ . NOTE: Do not place

excessive force on the switch, push with excessive force may result in product damage. The electromagnetic switch is a consumable component with an estimated service life of approximately 10,000 cycles. (The magnetic switch need to be purchased separately)

## 1.3 Product Dimensions

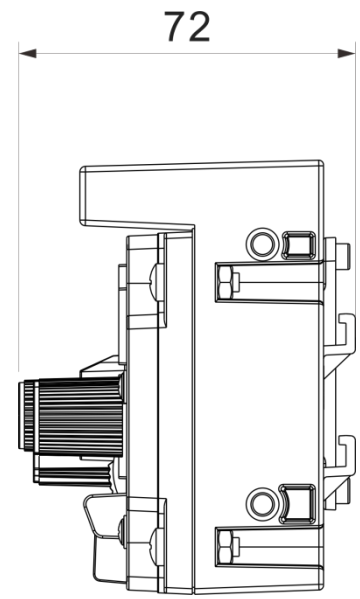
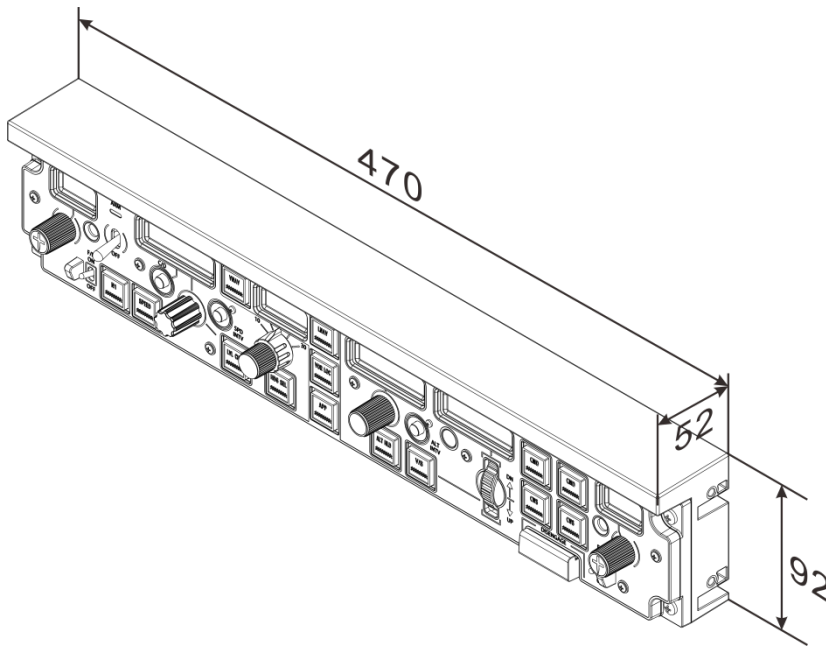

- LxWxH: 470mm\*52mm\*92mm; Weight: 0.92Kg (2.03lb)
- Bracket Dimensions (Hole diameter supports M5 screws)

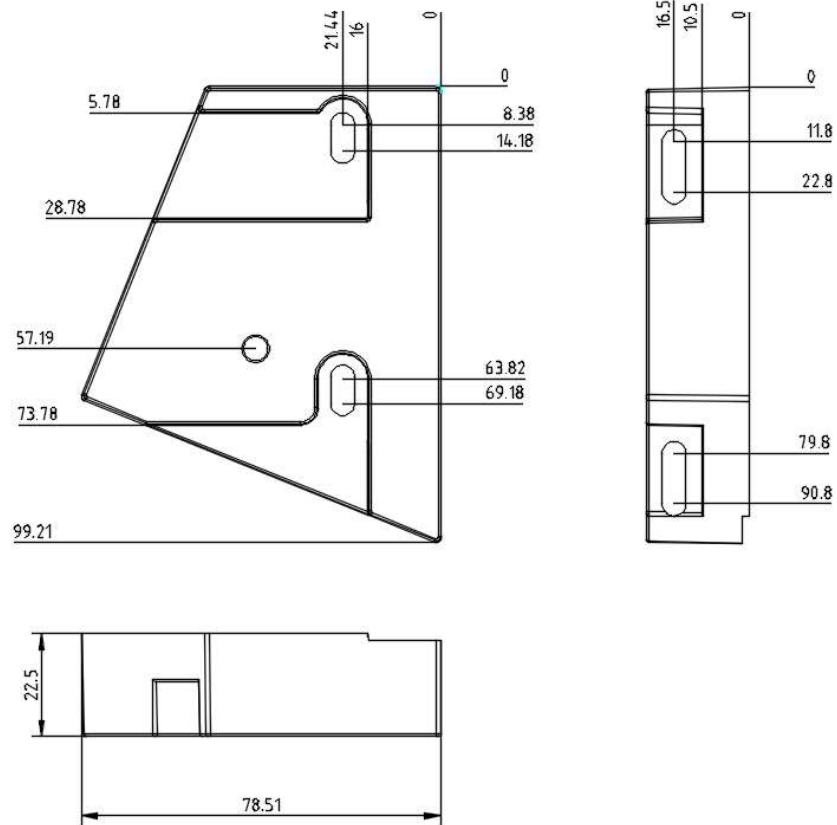

## 1.4 Installation Dimensions

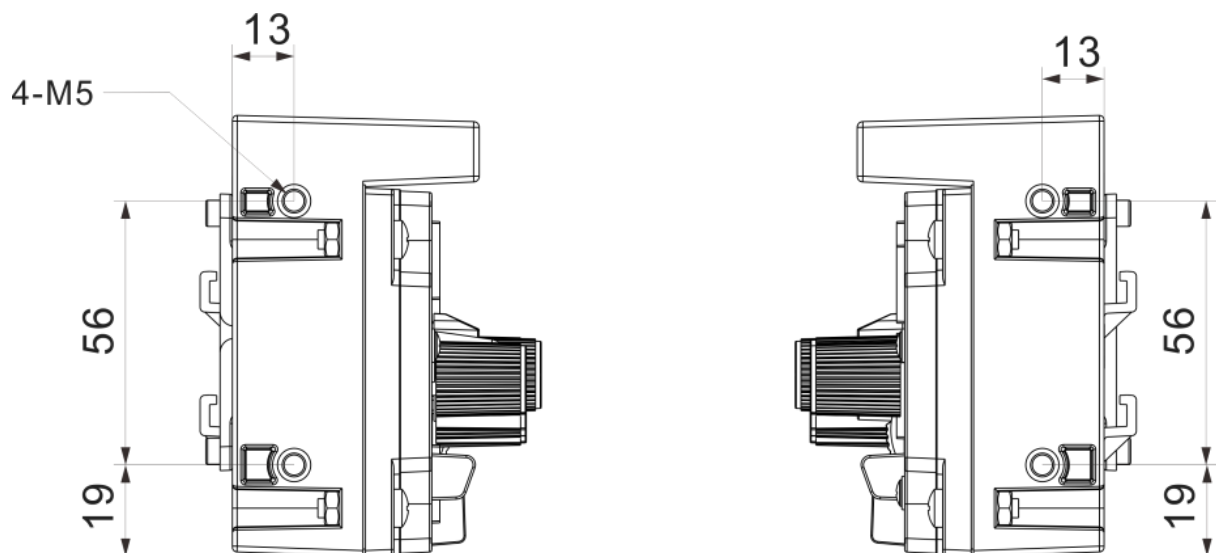

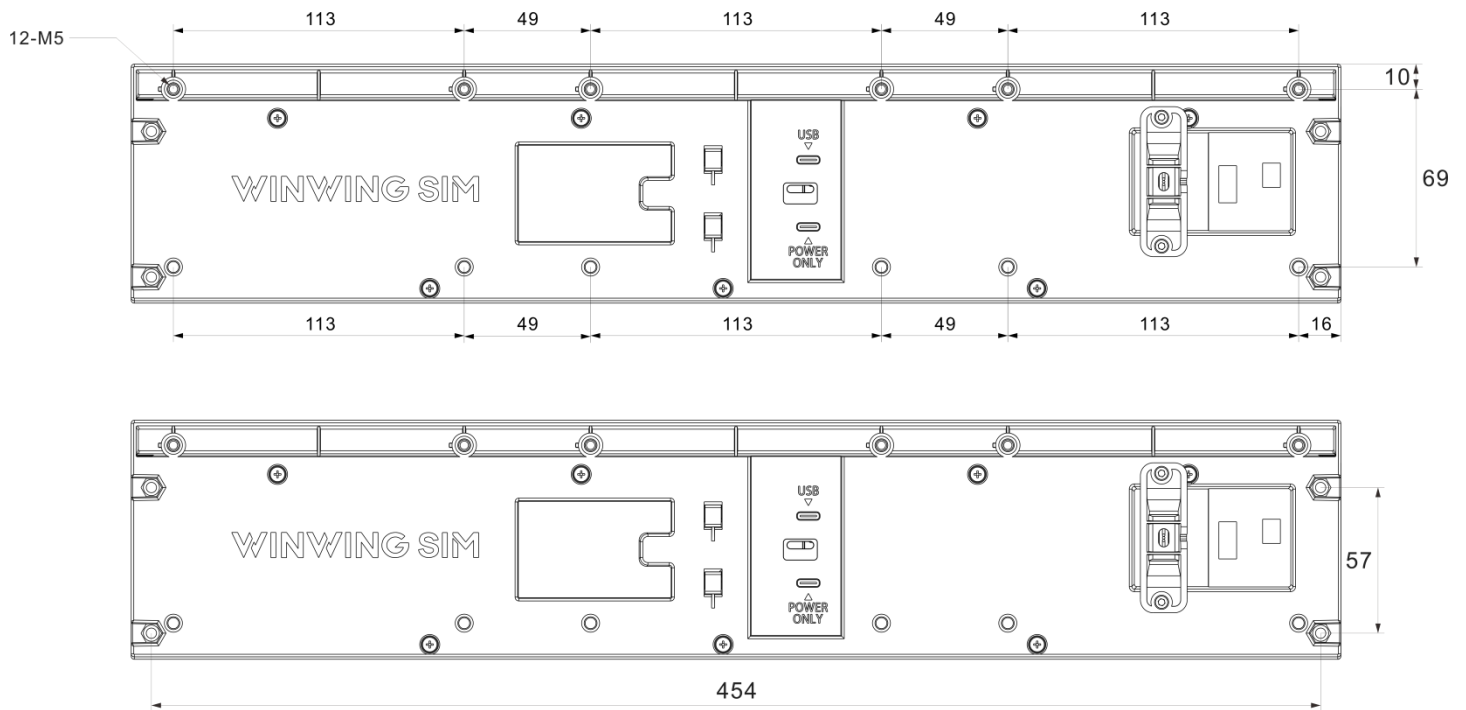

- 4-M5, 12-M5 maximum depth 5mm
- Diagram above is installation dimensions for panel alone

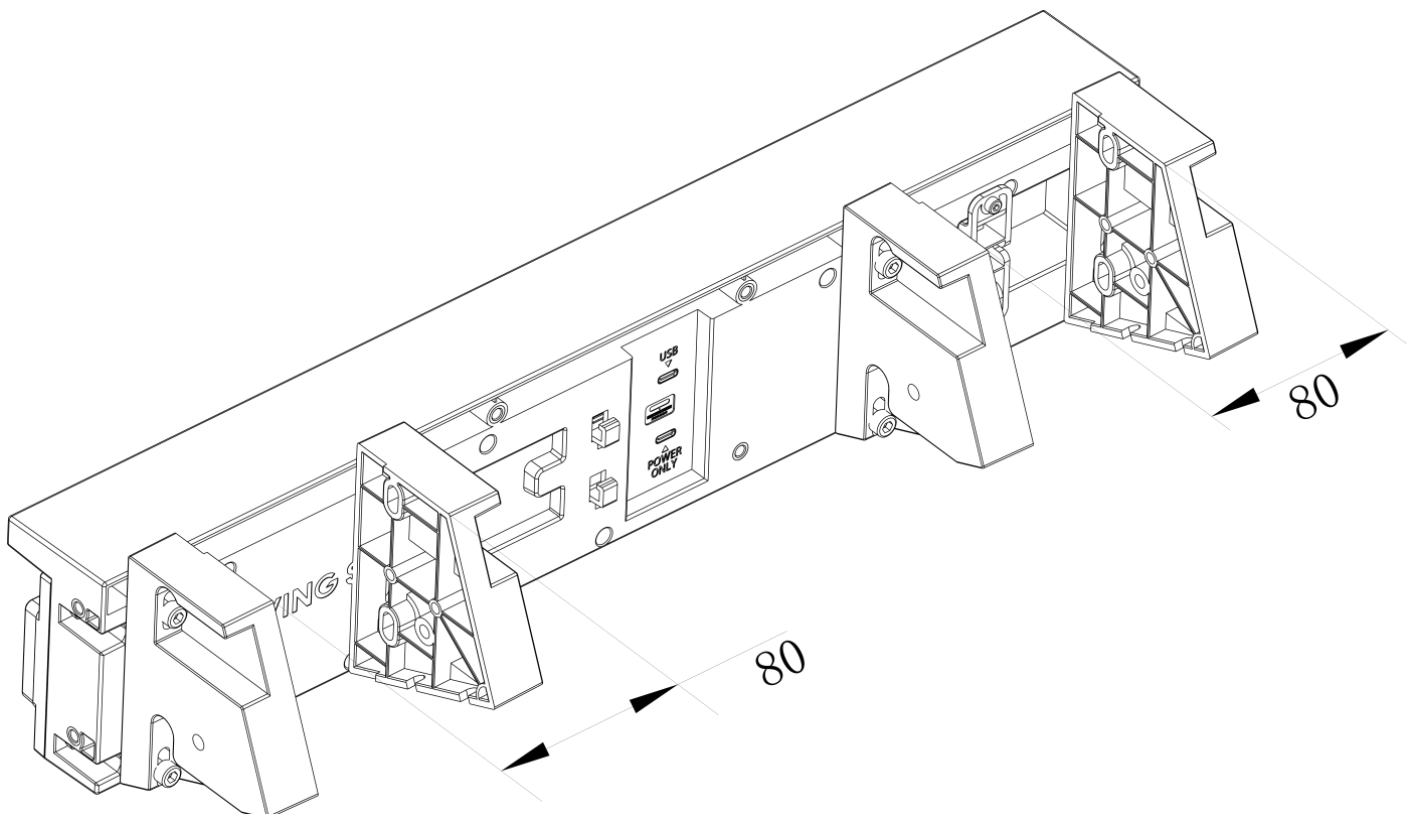

- Diagram above is between-bracket dimensions after brackets installed

## 1.5 Installation Compatibility

- Can be used independently.
- Can be mounted in combination with various control panels using brackets (see upcoming products for details).
- Can be mounted with the MP1 bracket.
- Supports installation on 4080 profiles (profile and related accessories need to be supplied separately)

## 2 First Use

### 2.1 Software Installation

- Download SimAppPro Download URL: Mainland China Download Link  
<https://cn.winwingsim.com/view/simapppro.html> Overseas Download Link  
<https://winwingsim.com/view/simapppro.html>
- Install SimAppPro  
Please follow the instructions to install the software, then run the program.  
The product can be customized within SimAppPro. (For more details, refer to the SimAppPro User Manual.)
- When using the product, please run SimAppPro first before entering the game (the product will automatically adapt to supported games and aircraft modules, plug-and-play. For more details, refer to the SimAppPro User Manual).  
SimAppPro User Manual Download Link:  
Chinese User Manual  
<https://cn.winwingsim.com/view/regular.html#manual-130>  
English User Manual  
<https://winwingsim.com/view/regular.html#manual-132>

### 2.2 Parts Installation

- Install the bracket in a suitable position according to your needs (see Section 4 Installation Methods for details).
- Alternatively, it can be installed on the profile for use (see Section 4 Installation Methods for details).



## 2.3 How to Use

- Device Connection

The product connects to the computer via the included data cable. For details on the interfaces, refer to Section 3.3 Data Interface.

### How to Connect

Insert the included data cable (4#) into the product's USB data interface and connect it to your computer.

For products requiring assembly, only the USB interface supports hot-swapping. For other interfaces, ensure that the product is properly connected before connecting to the computer.

( Important: If you need to connect other interfaces such as PS2, SATA, or aviation connectors, make sure to disconnect the USB cable before proceeding.)

After connecting the product to the computer, secure the cable with R Shape Cable Clip to the bracket (see Section 4 Installation Methods for details), so as to prevent damage to the product' s interface.

## 3 Function

### 3.1 Mechanical and Special Features

⑨ 2-Position Auto-Reset Toggle Switch can be updated to Magnetic Switch. \*Magnetic Switch is not included in the main product and is sold separately.

Magnetic Switch function: Can be auto locked by pulling upwards when power up, and auto-reset when power off.

- Light sensor: Uses Rx axis signal to output light sensor signal, backlight adjustment for digital tubes backlight and etc. can be bound to signal of this axis to realize automatic backlight adjustment. (NOTE: To avoid the screen blinking caused by short time covering light sensor during hand operation, we set filter for the light sensor output axis, making the axis output more smooth, decreasing screen blinking probability and thus increasing usage experience.)

### 3.2 Buttons

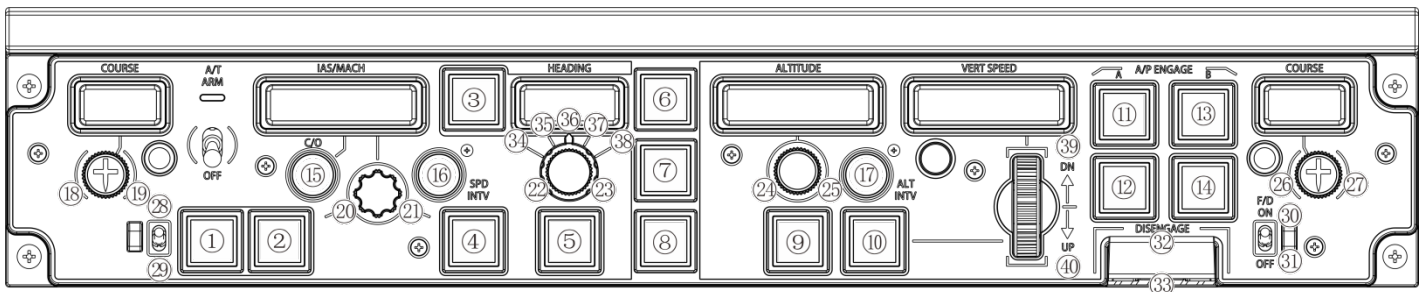

- LED Status Display:
  - Green steady slow flash (1s interval) — BOOT Mode
  - Green slow flash (1s interval) for 5 times, then steady on — Operation Mode
  - Green slow flash (1s interval) for 5 times, then off — Power-Only Mode

## 3.3 Data Interface

- USB Data Port (TYPE-C)

Used for communication and power supply between the product and the computer.

Simply connect this cable to use the product.

Communication Protocol: HID

- POWER ONLY Port (5V Voltage)

When only the ⑪ USB Data Port is connected, some computers may experience insufficient power supply, which could result in low screen brightness, failure to display properly, or the device not being recognized. Using this ⑬ TYPE-C interface to connect an additional 5V power supply can provide independent power to the device.

## 3.4 Adjustment Method

- The device itself doesn't need adjustment.
- Can realize panel angle adjustment with MP1 bracket. (For details, please refer to MP1 user manual) (NOTE: MP1 bracket is not included and is sold separately).

## 4 Installation Methods

### 4.1 Desktop Mounting Method

#### 4.1.1 Desktop Mounting Method 1 (Recommended for Desktop Mounting)

- **Bracket Mounting Method:** Install the bracket at a 68-degree angle relative to the desktop.

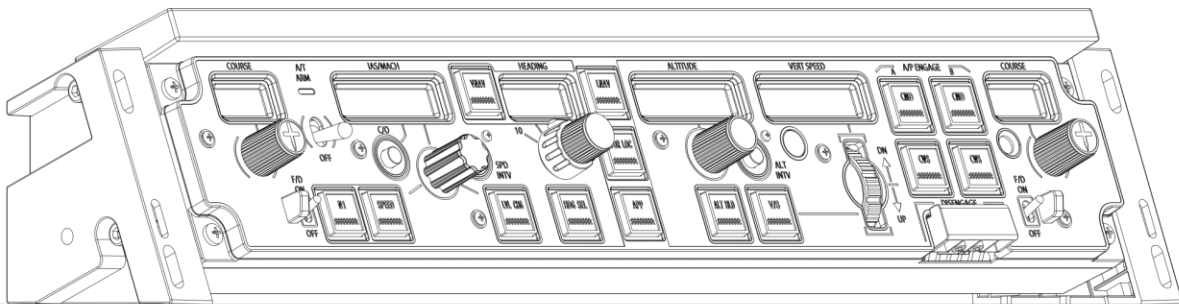

- Insert USB data cable, set cable into the slot, and mount it to bracket using the R Shape Cable Clip.

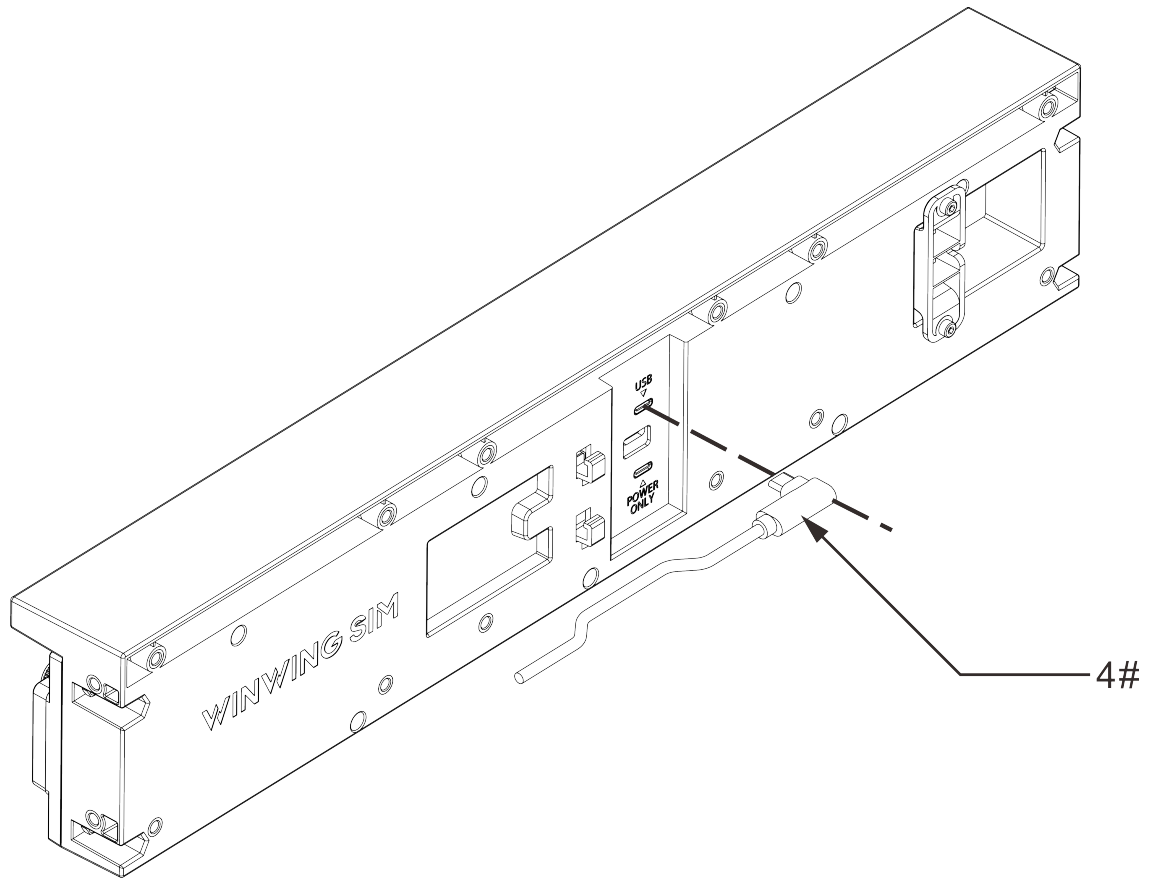

- Left and Right Brackets Mounting Method:
- Screw in the screws, but do not tighten them yet;
- Adjust the bracket position up and down until it is stable on the desktop, then tighten the screws.
- Tighten the screws until there is no wobbling; over-tightening may cause damage.

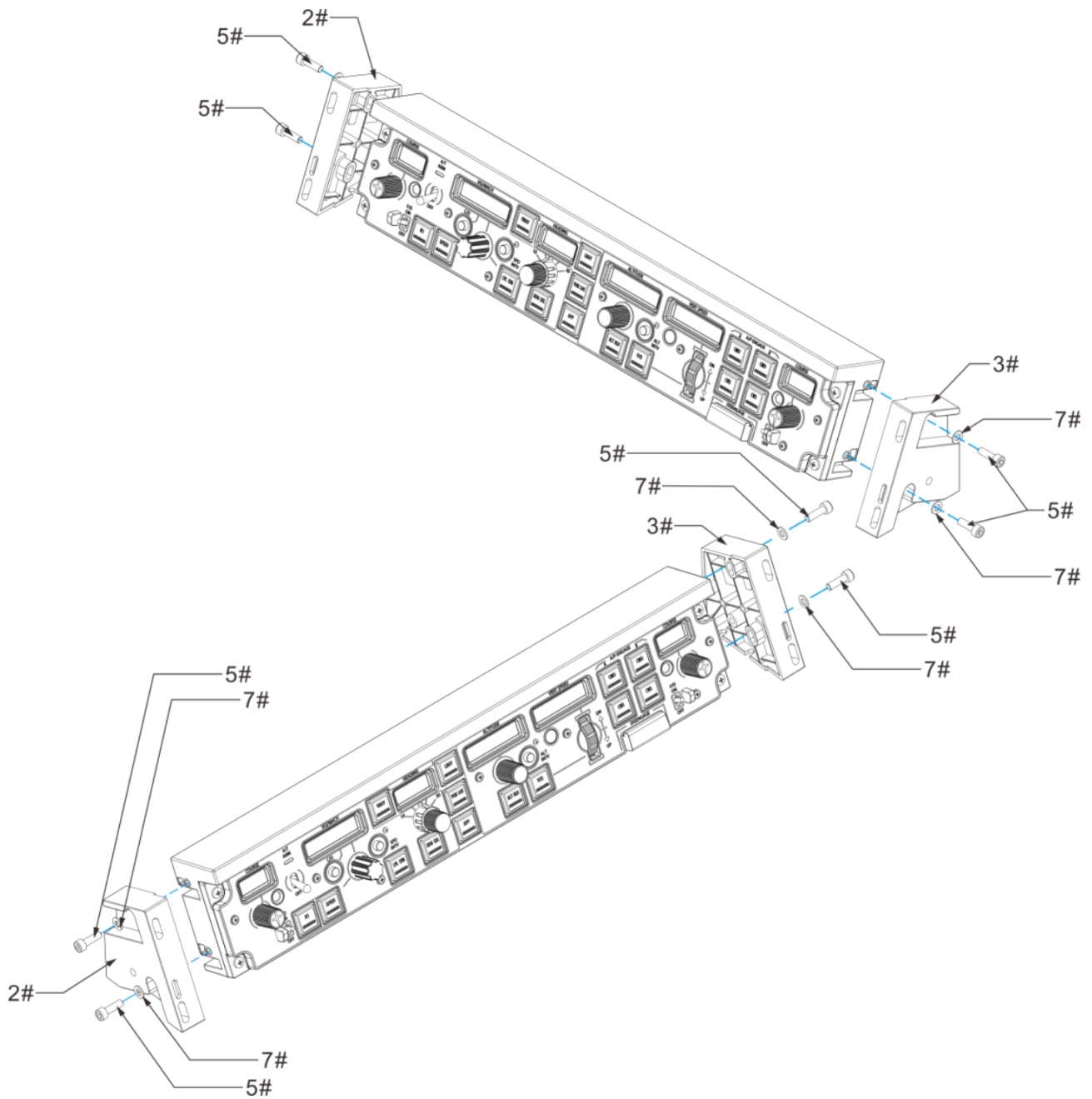

- Apply the Nano Double Sided Adhesive Dots (11#) to the bottom of the bracket:
- Clean the dust off the bracket surface before mounting;
- Press firmly for at least 10 seconds during application and let it sit for 30 minutes to ensure the best adhesive effect;

- For single-use application only on clean, smooth surfaces. Do not apply to surfaces with wax, oil, water stains, dust, dirt, or rough textures to avoid improper adhesion and potential detachment;
- The ideal temperature for application is between 10°C and 40°C.

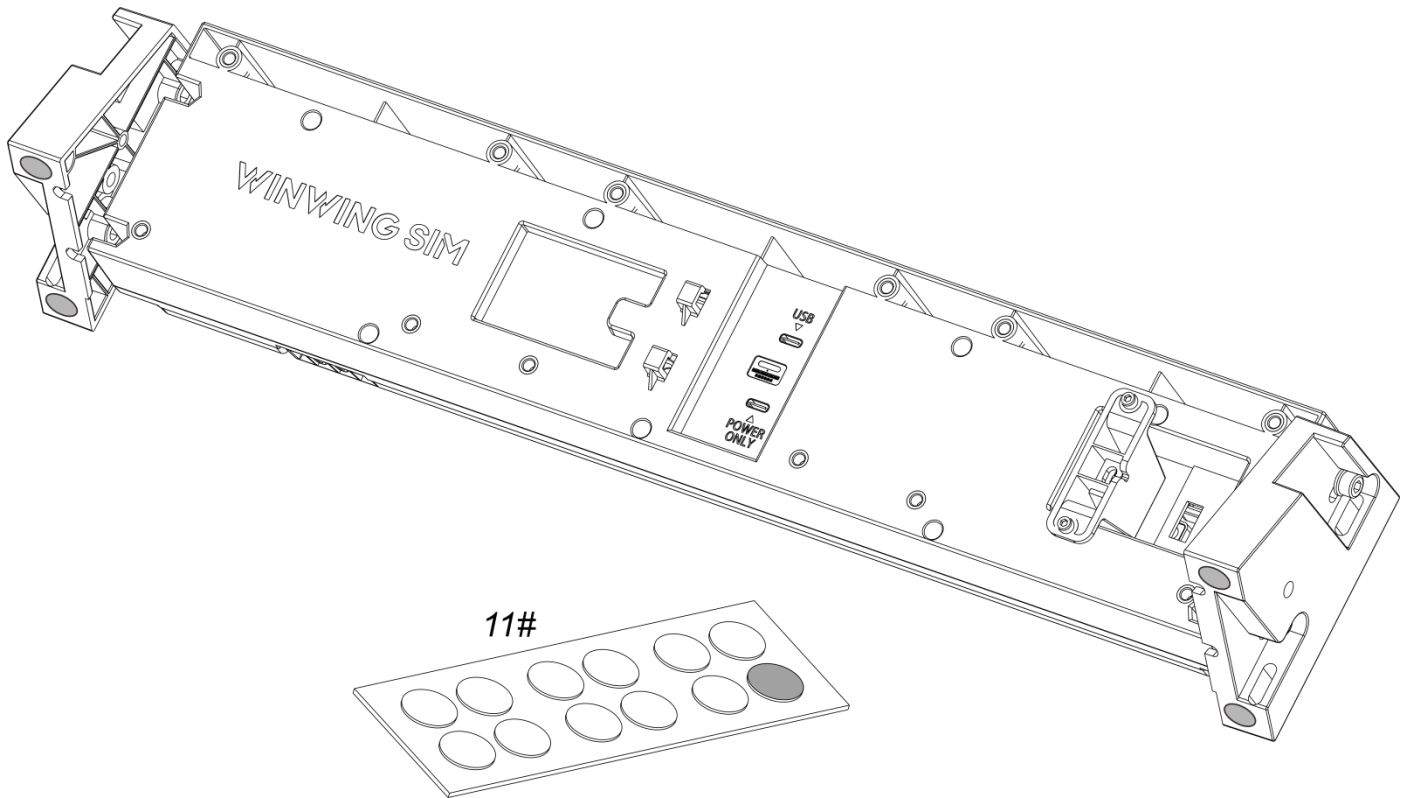

## 4.1.2 Desktop Mounting Method 2

- **Bracket Mounting Method:** Install the bracket at a 68-degree angle relative to the desktop.

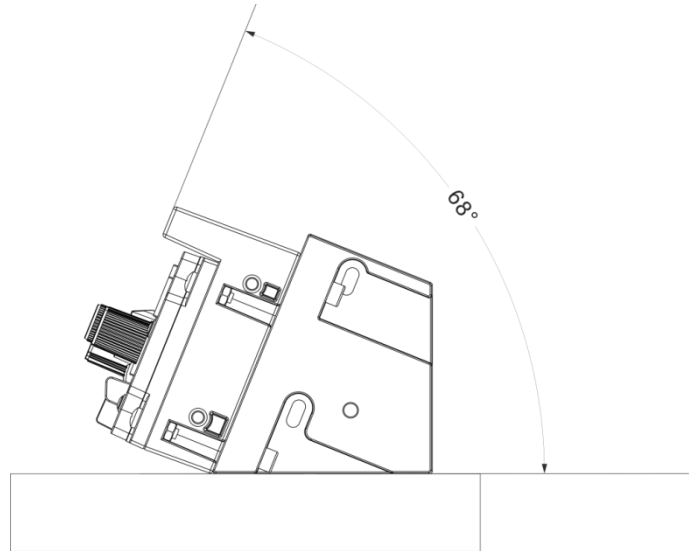

- Insert USB data cable, set cable into the slot, and mount it to bracket using the R Shape Cable Clip.

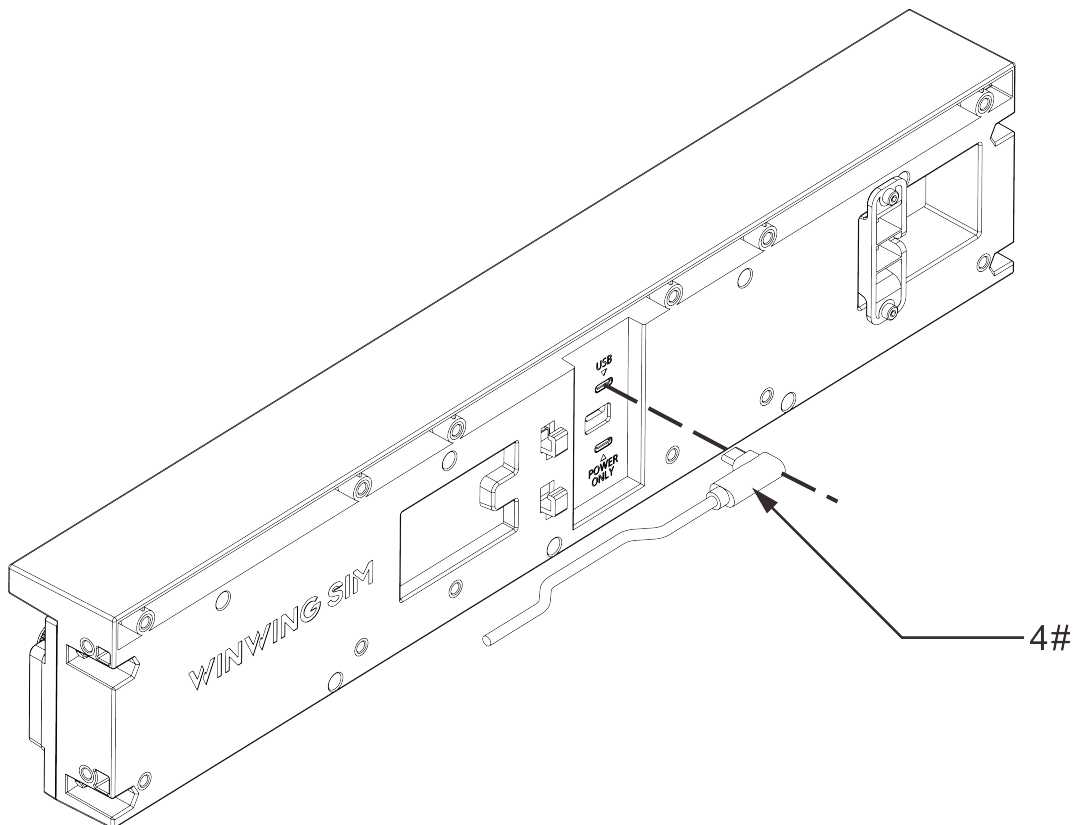

- **Left and Right Brackets Mounting Method:**



- Screw in the screws, but do not tighten them yet;
- Adjust the bracket position up and down until it is stable on the desktop, then tighten the screws.
- Tighten the screws until there is no wobbling; over-tightening may cause damage

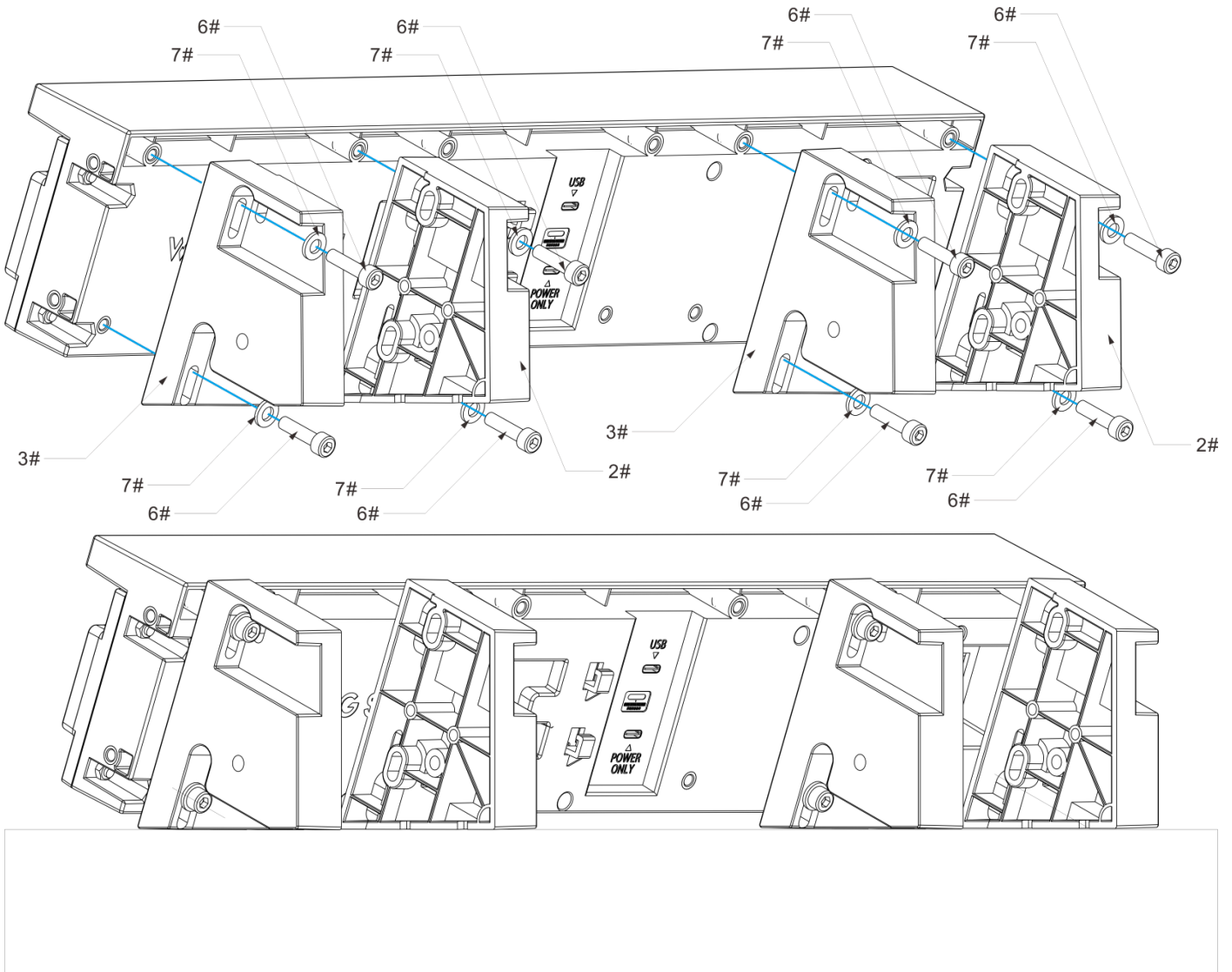

- Apply the Nano Double Sided Adhesive Dots (11#) to the bottom of the bracket:
- Clean the dust off the bracket surface before mounting.
- Press firmly for at least 10 seconds during application and let it sit for 30 minutes to ensure the best adhesive effect.
- For single-use application only on clean, smooth surfaces. Do not apply to surfaces with

wax, oil, water stains, dust, dirt, or rough textures to avoid improper adhesion and potential detachment.

- The ideal temperature for application is between 10°C and 40°C

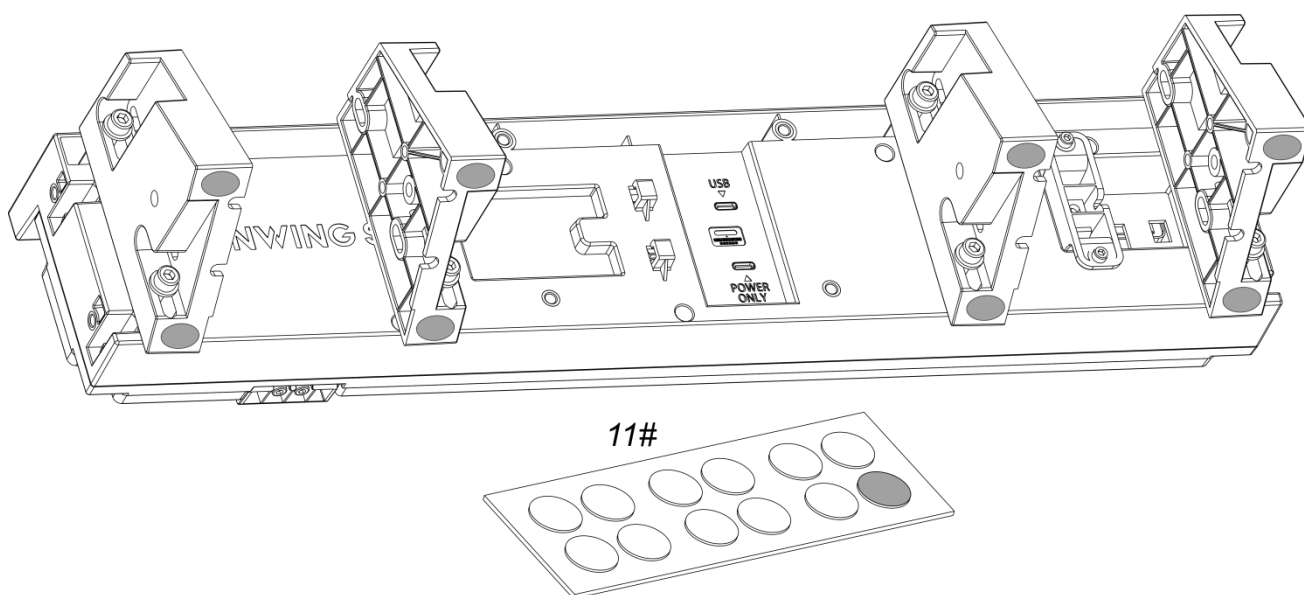

## 4.2 Profile Installation (\*Profile rails and related accessories are required and not included.)

- Recommended Specifications for Self-Prepared Accessories

Item	Specifications	Quantity (Minimum)
Profile	Standard 4080	1
Profile Nut	40 Series - M5	4
Socket Cap Screw	M5*22	2
Socket Cap Screw	M5*35	2
Flat Washer	φ5	8

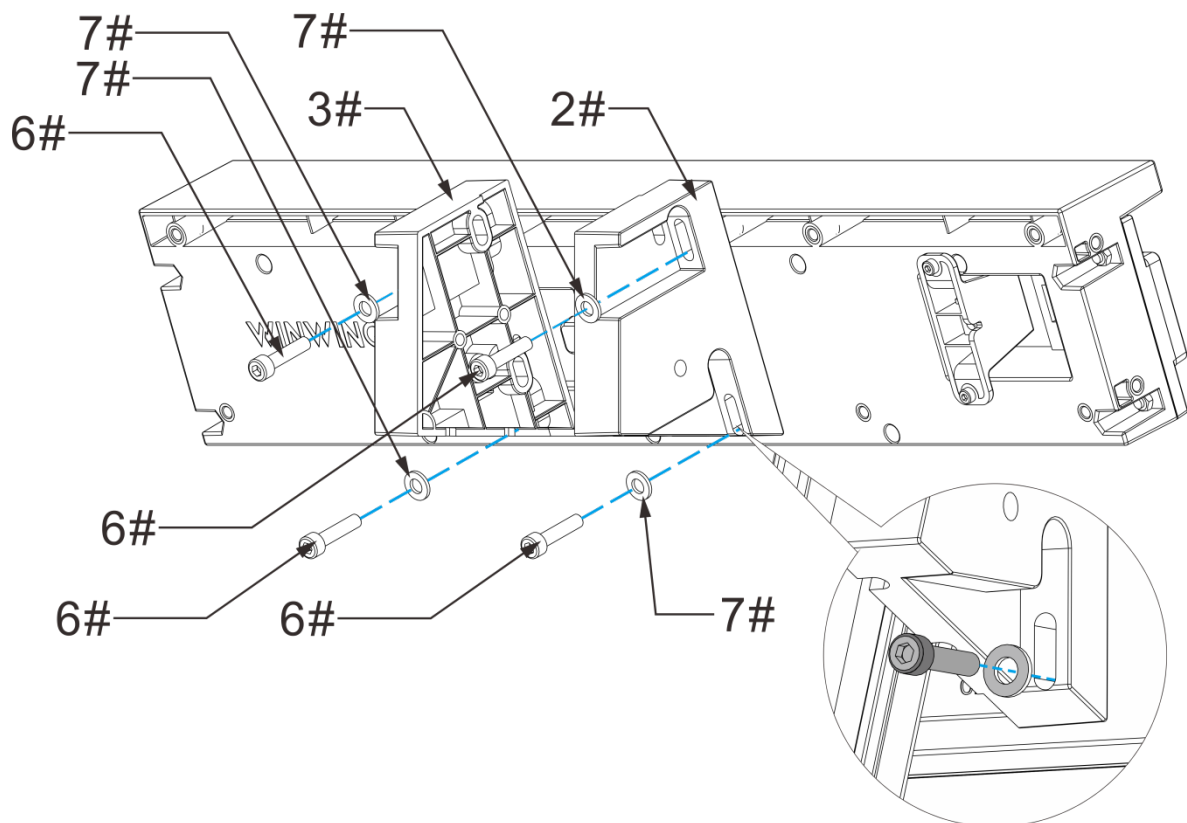

- Tighten the screws, making sure the bottom of long form holes on 2# bracket and 3# bracket match the screw hole on product.

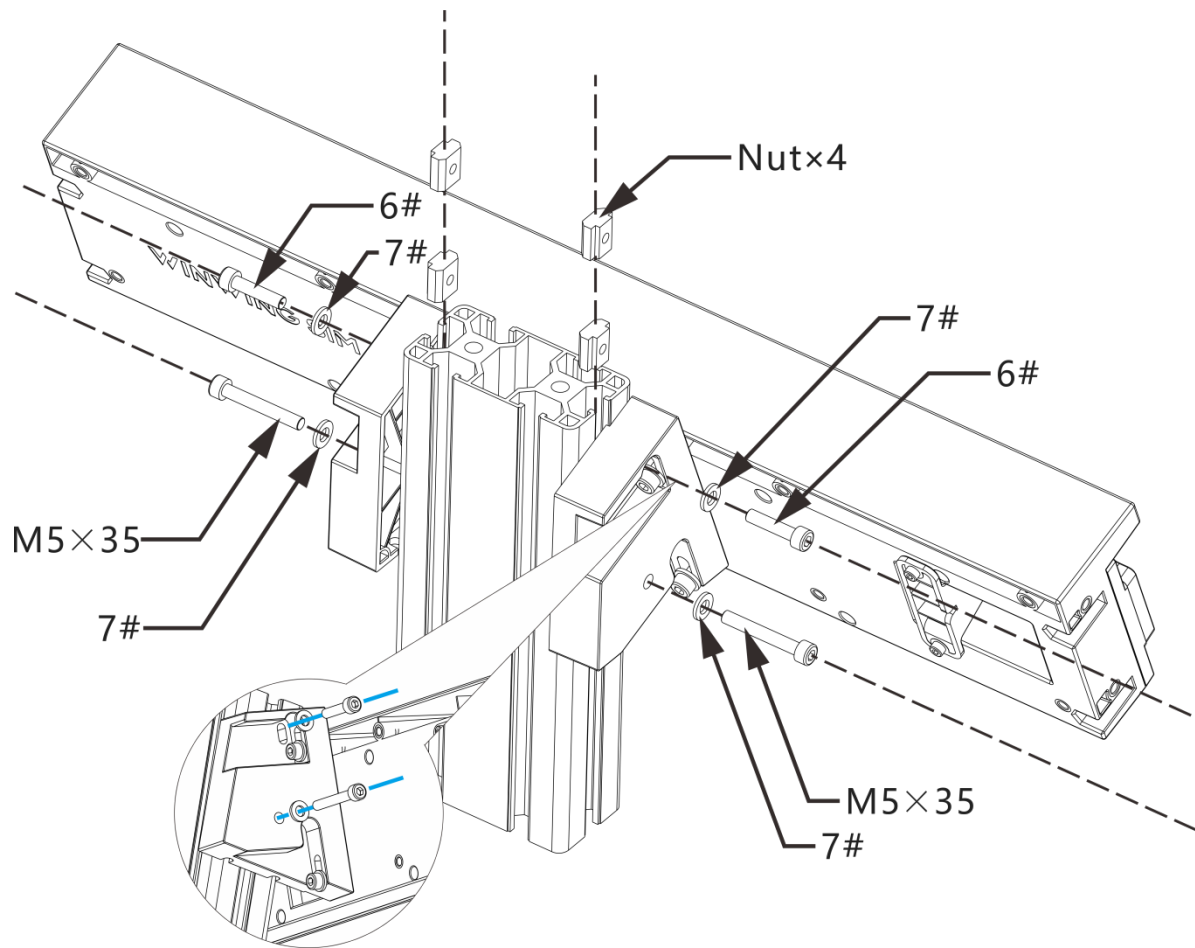

- Put in profile nuts, adjust product position, then tighten the screws.

## 4.3 Integrated Device Installation

- Can be cascaded with various control panels for installation, see upcoming products for details. (Optional)
- Install with the Panel Mounting Bracket (MP1). \* The Panel Mounting Bracket (MP1) is sold separately.
- Panel Mounting Bracket (MP1) List (Sold separately, refer to the MP1 User Manual for detailed specifications).

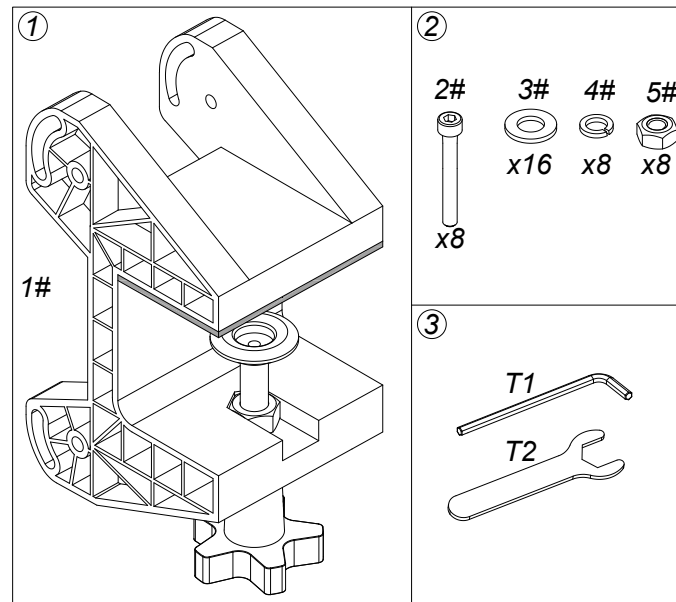

In this section, the materials shown in the figure will be described respectively as

“MP1+NUMBER” (such as MP11#, MP12#, MP13#.....).

- Mounting Method 1 (Recommended for MP1 Mounting)

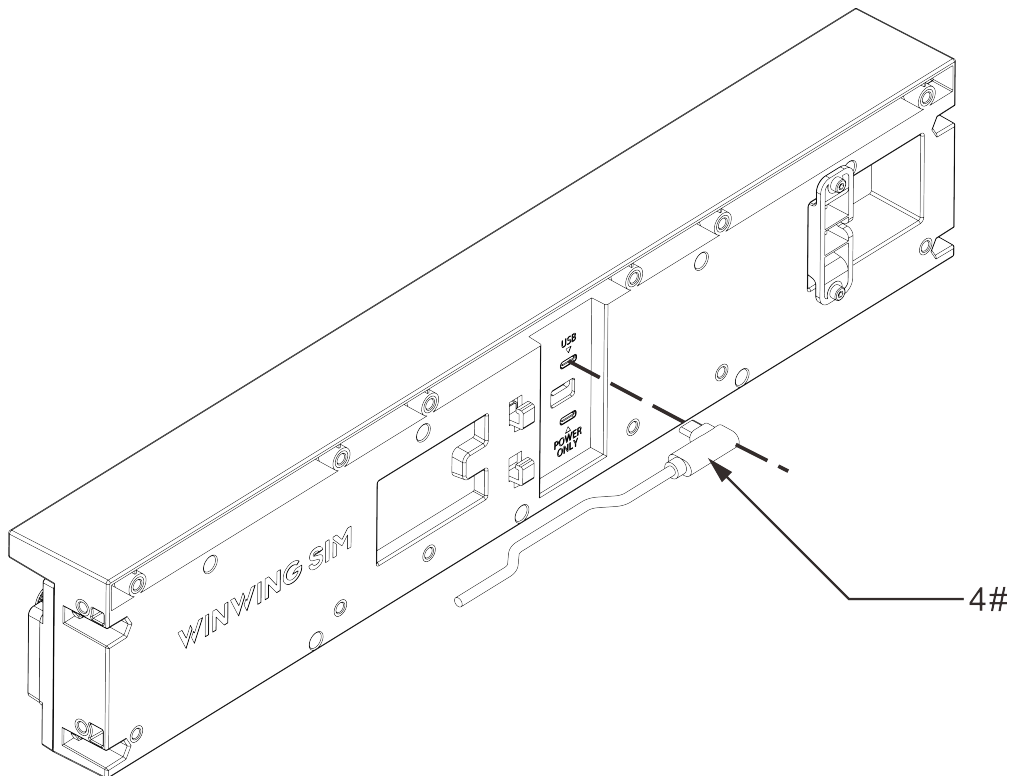

- Insert USB data cable, set cable into the slot, and mount it to bracket using the R Shape Cable Clip.

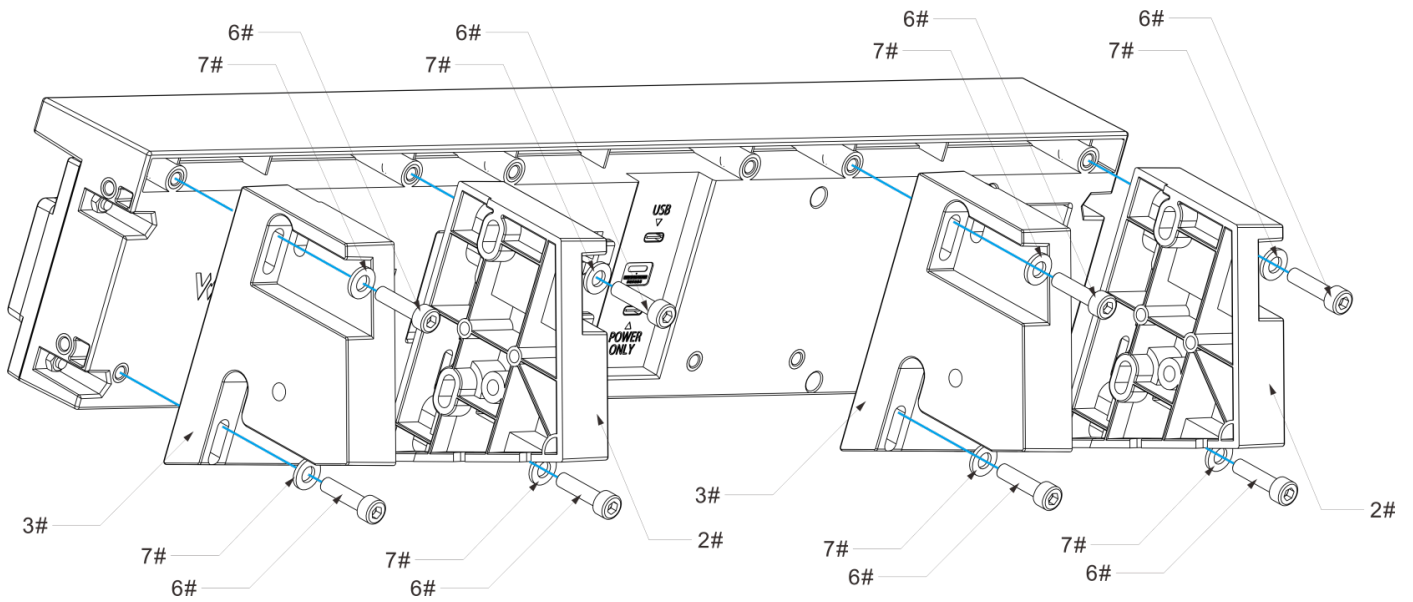

- Install left and right bracket;

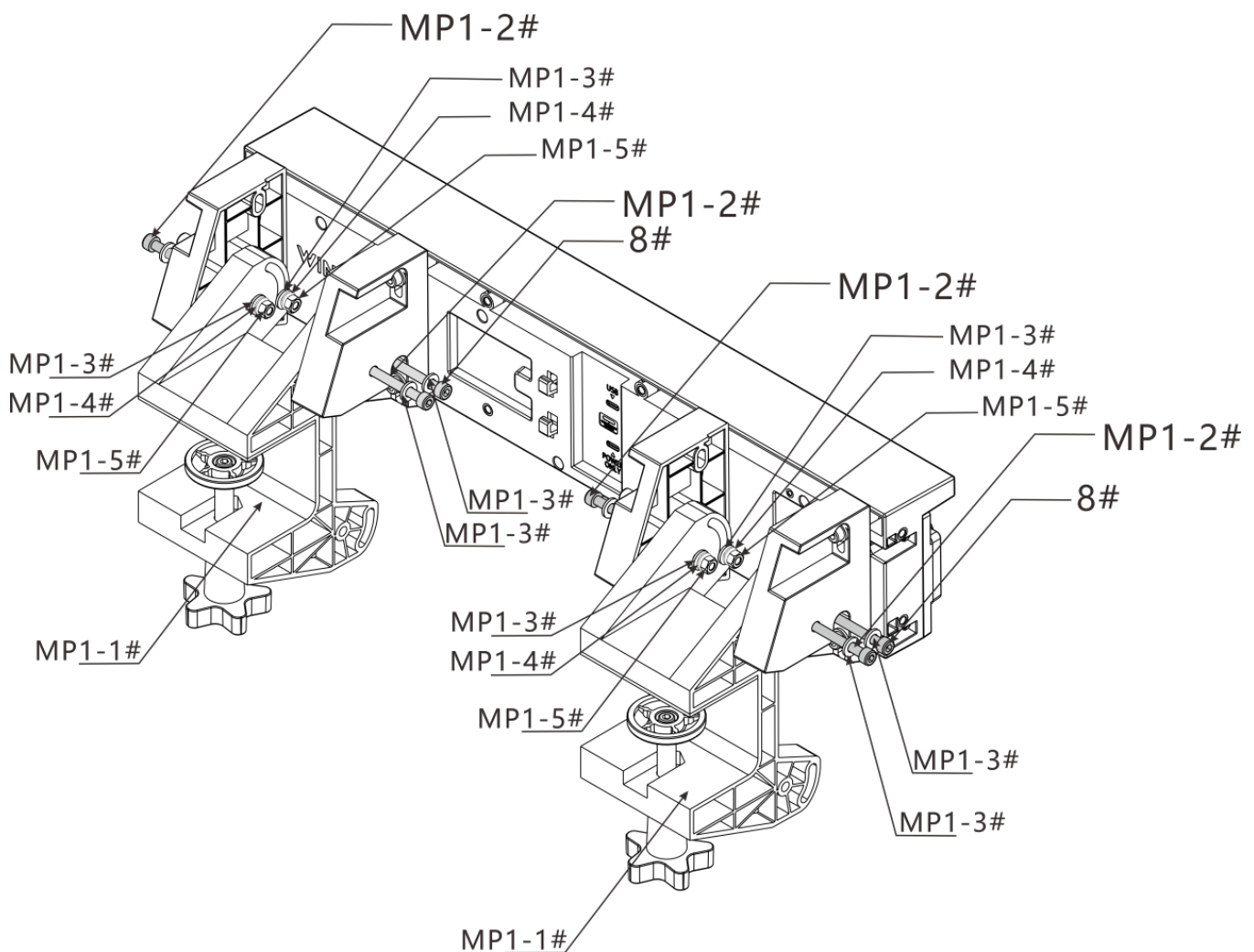

- Tighten the screws until there is no wobbling; over-tightening may cause damage;

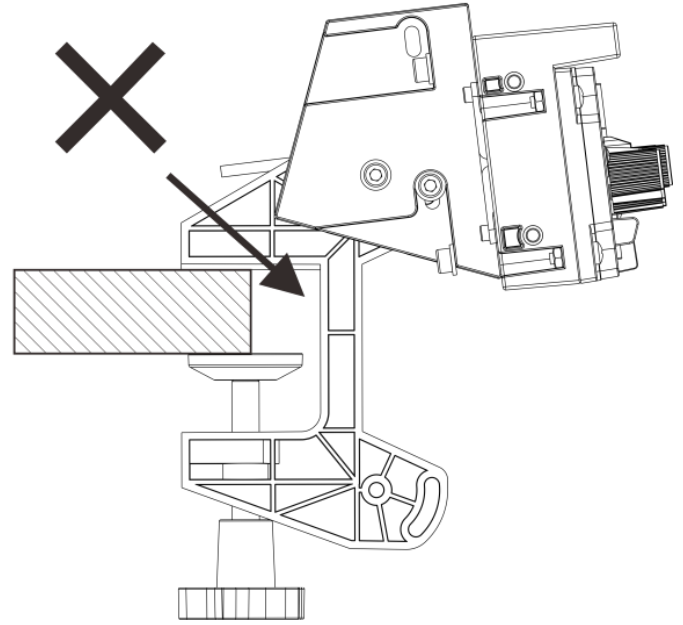
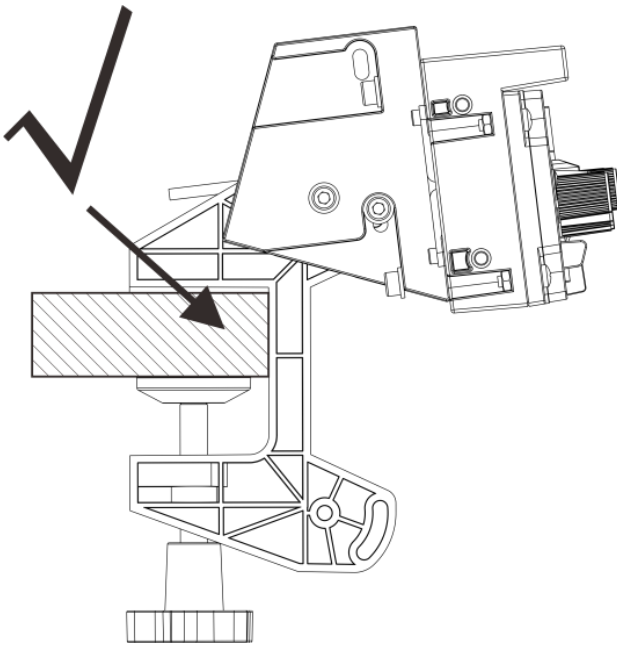

**\*Clean the dust off the bracket surface before mounting.**

**Adjust the bracket position up and down until it is stable on the desktop, then tighten the screws;**

**Tighten the screws until there is no wobbling; over-tightening may cause damage.**

- Mounting Method 2:

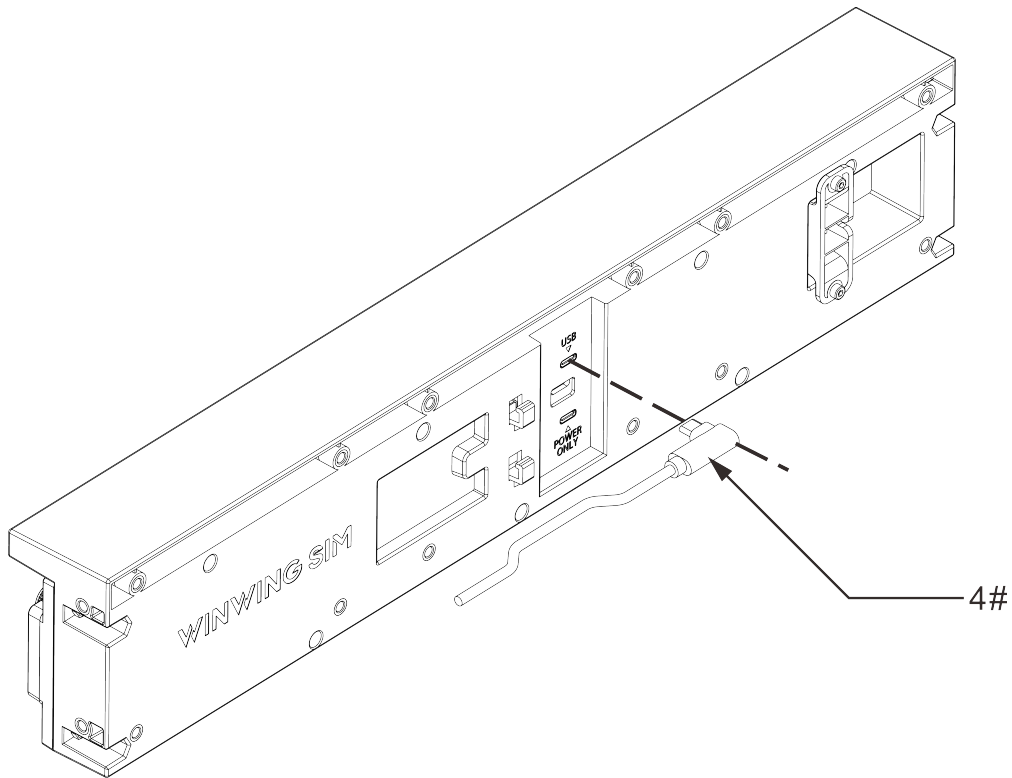

- Insert USB data cable, set cable into the slot, and mount it to bracket using the R Shape Cable Clip;

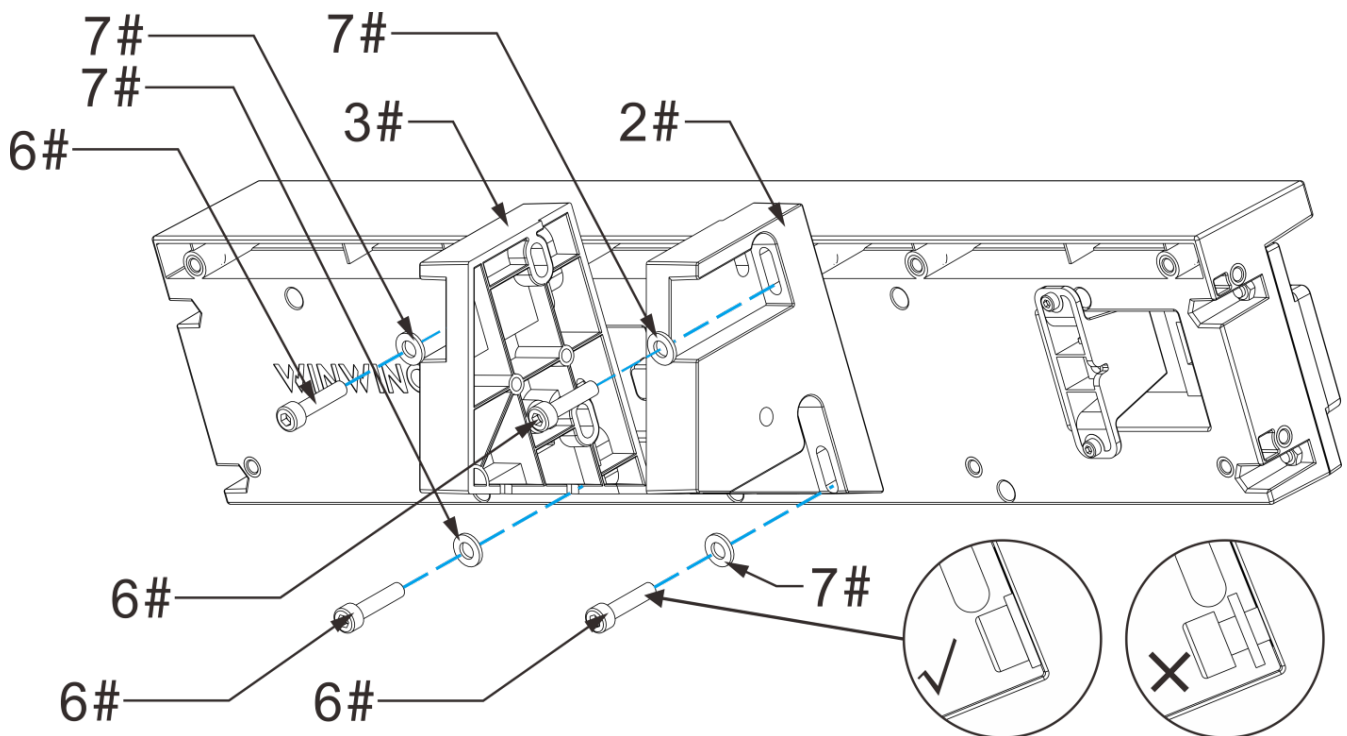



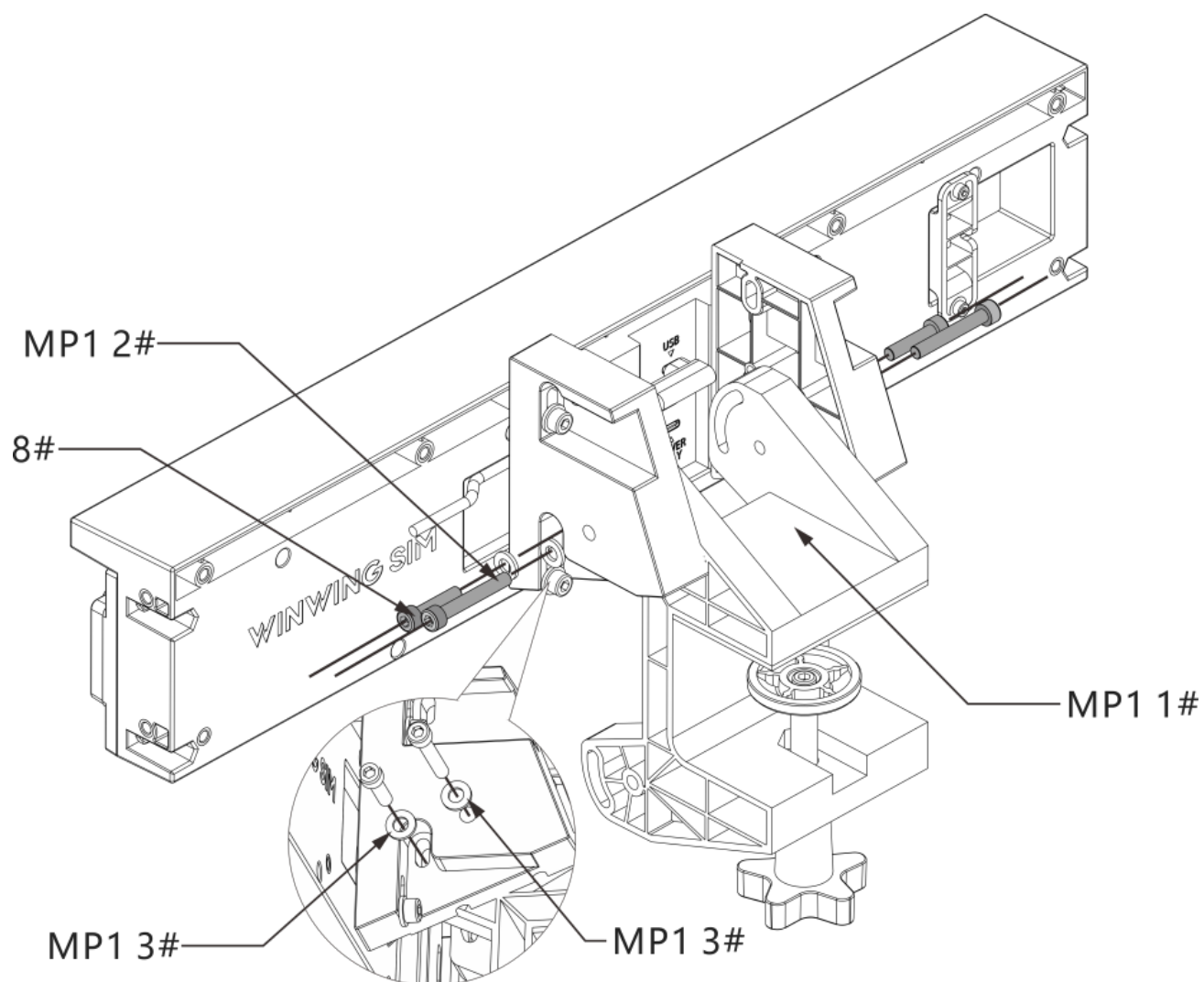

- Screw in the screws, but do not tighten them yet;

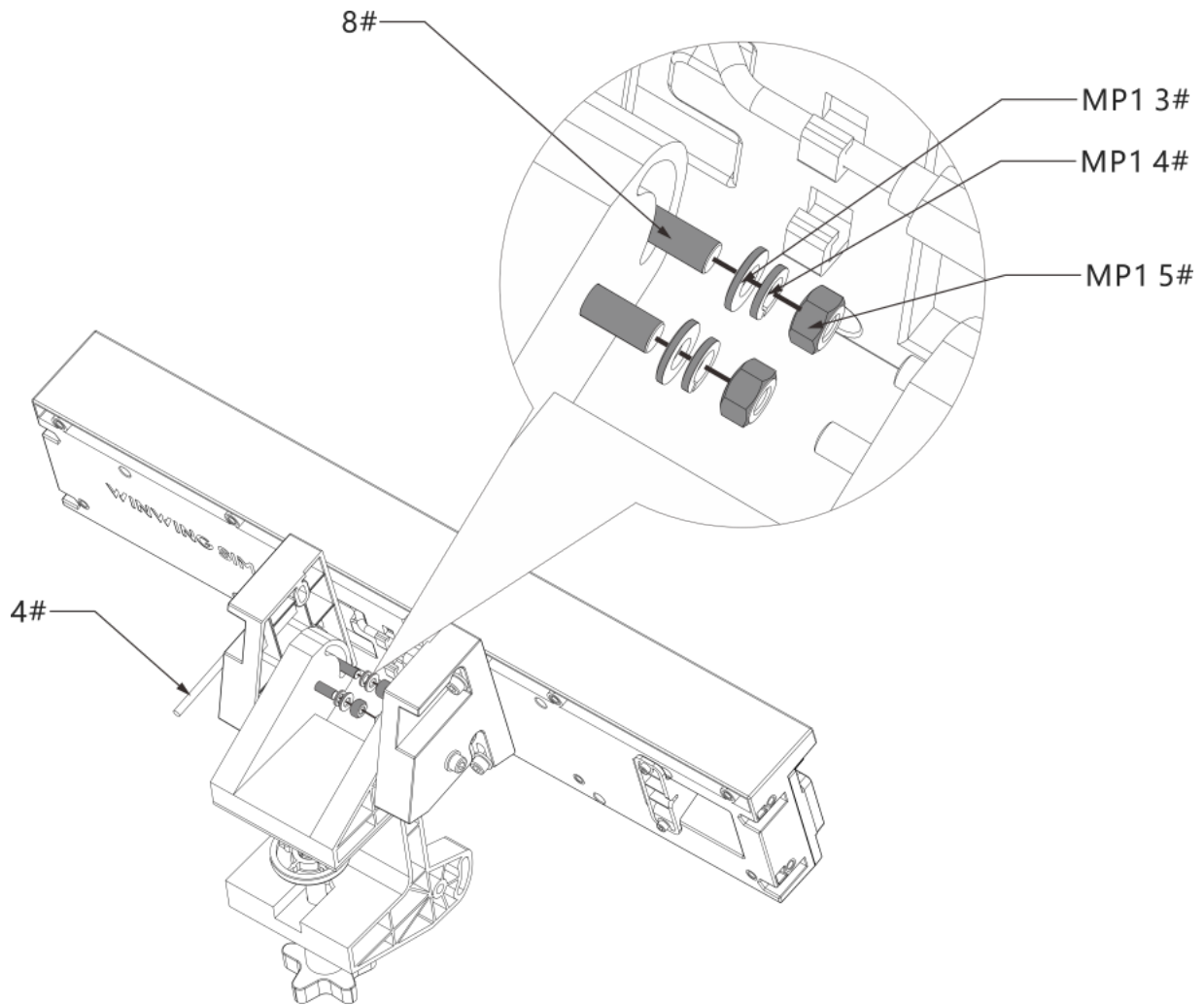

- Tighten the screws until there is no wobbling; over-tightening may cause damage;

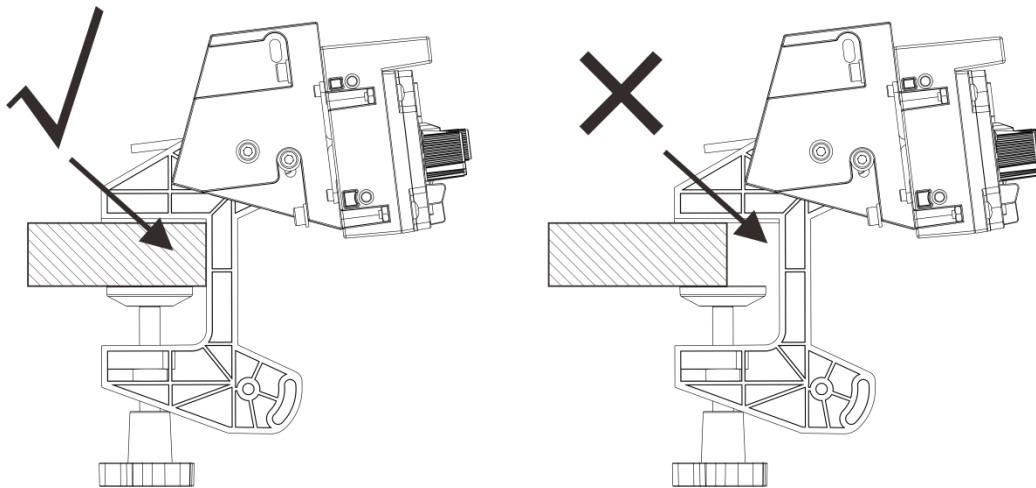

\*Clean the dust off the bracket surface before mounting.

Adjust the bracket position up and down until it is stable on the desktop, then tighten the screws;

Tighten the screws until there is no wobbling; over-tightening may cause damage.

## 4.4 Magnetic Switch Installation (\*Magnetic Switch is sold separately)

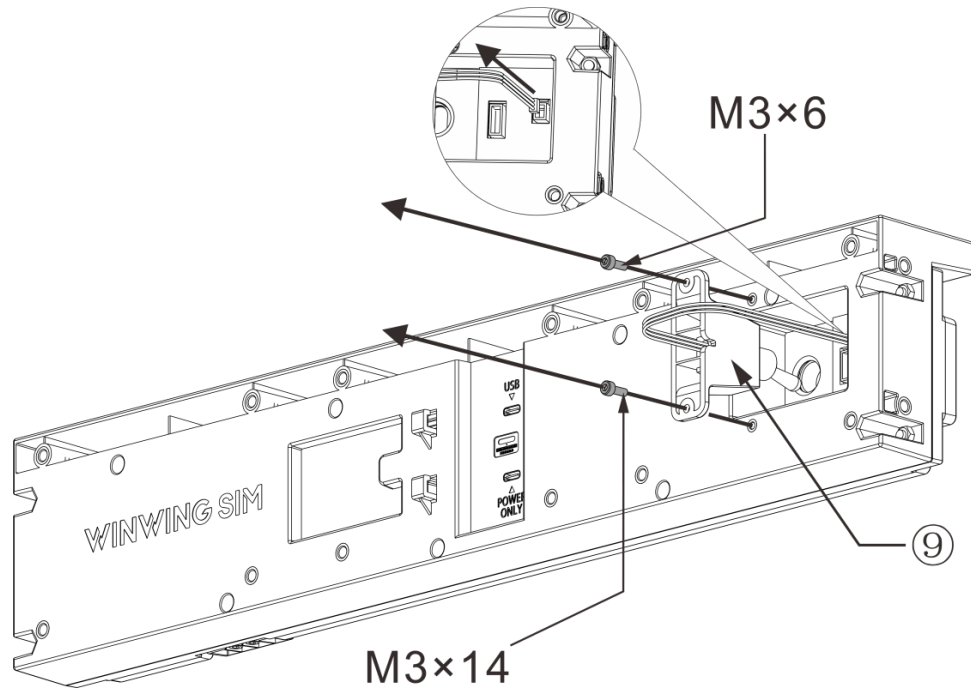

- Remove the two M3 screws (NOTE: the screws have different length).
- Press white snap, remove the signal cable connector for ⑭ 2-Position Auto-Reset Switch.

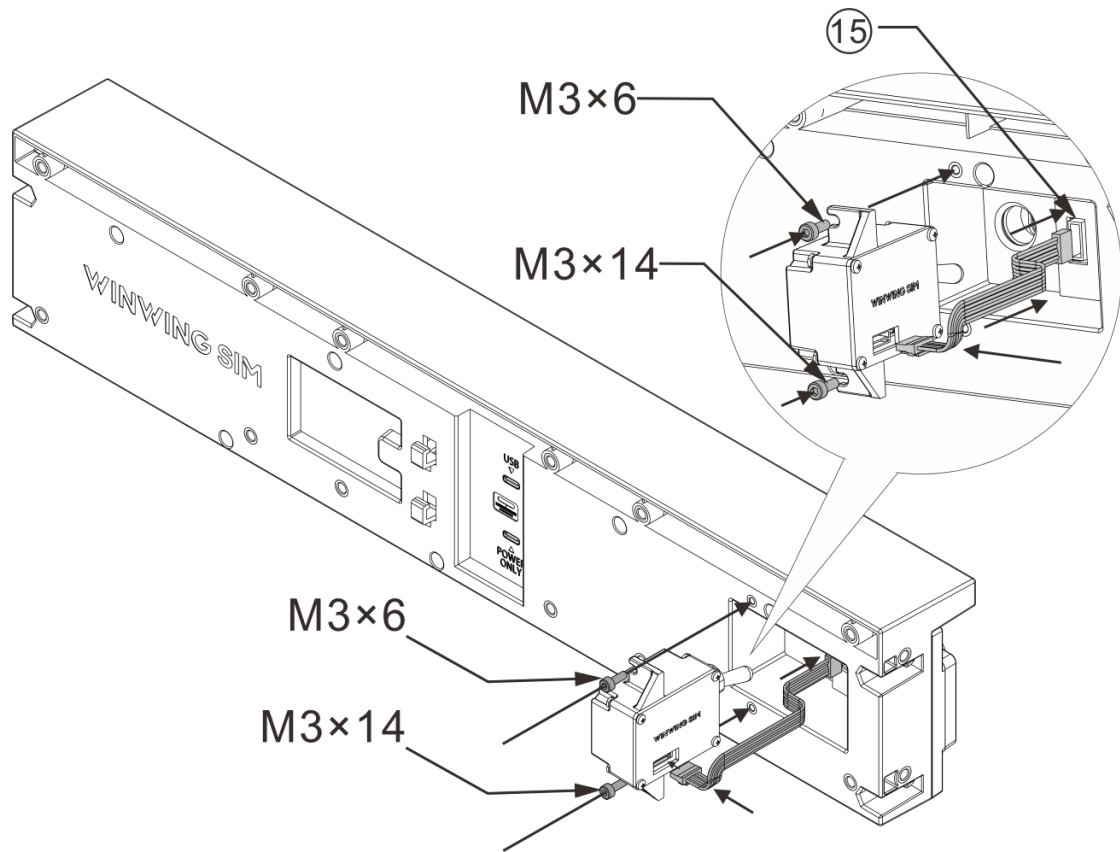

Insert one side of 7pin signal cable to Magnetic Switch, another side to ⑮ Reserved Magnetic Switch Port.

- Tighten the M3 screws. \*NOTE: Please pay attention to the M3 screws length and corresponding install place, do not wrongly install them. When installing, tighten the screws just until they are flush with the casing. Over-tightening may cause damage to the product.

## 5 Maintenance and Care

### 5.1 Firmware Upgrade

- Before upgrading, ensure the product's wiring is securely connected and follow the instructions on the SimAppPro interface.
- If you encounter issues during the upgrade, try restarting SimAppPro and reconnecting the device's USB Data Port. \* NOTE: Other interfaces, such as PS2, SATA, or aviation

connectors, do not support hot-swapping. If you need to connect these interfaces, please disconnect the USB cable first.

- If the upgrade still cannot be completed, please contact Customer Service on WINWING website for technical support.

## 5.2 Cleaning and Maintenance

- To prevent sand, dust, and dirt from accidentally entering the product, this product features a dust-resistant design. However, it cannot completely prevent dirt, dust, water, or salt from entering the internal components. Avoid allowing dirt, dust, water, or salt to fall onto the product, and keep it clean.
- It is recommended to clean the product after use. Allowing dirt, dust, water, or salt to remain on the product may cause malfunction.
- Do not place the product near objects with strong magnetic fields, such as magnets or electric motors. Strong magnetic fields may cause abnormal data in the product.
- Do not place the product in high-temperature areas, such as inside a car exposed to direct sunlight. High temperatures may cause product malfunction.
- The product contains precision electronic circuits. Do not disassemble the product.
- Do not touch the product's electronic contacts with your fingers to avoid corrosion. Corroded contacts may lead to product malfunction.
- If the product suddenly moves from a low-temperature environment to a warm room, condensation may form on the surface and internal components. To prevent condensation, place the product in a sealed plastic bag and wait for the temperature to gradually rise before removing it from the bag.

- If condensation occurs on the product, do not use it to avoid damage. Wait for all moisture to evaporate before continuing to use the product. Even after the product is fully dried, the internal components may still be at a low temperature.
- Avoid storing the product in chemical laboratories or areas with chemicals that may cause rust or corrosion.
- Use only original accessories for maintenance and replacement.

## 5.3 FAQs and After-Sales Service

### Frequently Asked Questions:

- If the product is experiencing abnormalities, please check if the firmware and SimAppPro version are up to date and perform an upgrade if necessary.
- If you experience signal instability or drift during use, try recalibrating within SimAppPro or clearing the game controller data in Windows.
- If the product is having issues with unstable connection or is not recognized by the computer, try switching to a different USB port (it is recommended to use a USB port directly on the motherboard or a three-prong USB hub with independent power and proper grounding). Also, try cleaning the data cable's connectors with alcohol or replacing the cable to see if the signal stabilizes. \* NOTE: If you need to connect other interfaces, such as PS2, SATA, or aviation connectors, please disconnect the USB cable first before proceeding.
- After connecting the product to the computer, make sure to secure the cables in the fixed clips to prevent damage to the product's connectors.
- When assembling and connecting the product and accessories, ensure that the screws

are tightened correctly and that no components are loose or over-tightened. Incorrect handling may cause unusual sounds during operation.

- When using a USB hub to connect the product, ensure that the three-prong hub has independent power supply and proper grounding. Otherwise, the product's signal may be unstable.

## 6 Safety Precautions

For safe use of the product, please be sure to read these precautions. Please follow these precautions to prevent harm or injury to the user or others.

- Keep the product out of the reach of children.
- Swallowing product parts or accessories is extremely dangerous. If swallowed accidentally, seek medical attention immediately.
- Use only the power supply specified in the product user manual that is intended for use with this product.
- Do not disassemble or modify the product.
- Do not subject the product to strong impacts or vibrations.
- Do not touch any exposed internal components.
- If the product emits smoke, an unusual odor, or exhibits any abnormal behavior, stop using it immediately.
- Do not clean the product surface with organic solvents such as alcohol, gasoline, or paint thinner.
- Do not get the product wet, and do not insert foreign objects or pour liquids into the product.

- Do not use the product in environments where flammable gases may be present, as static electricity may cause explosions or fires.
- During thunderstorms, do not touch the product connected to a power outlet, as this may result in electric shock.

## Disclaimer

Please read and understand the contents of the product user manual carefully. Failure to follow the instructions may result in personal injury or damage to the product.

Ensure that all personnel using this product are familiar with and understand the user manual to maximize the product's value.

Any personal injury, property damage, or product damage resulting from improper use or failure to follow the user manual will be the sole responsibility of the user. The company will not be held liable for such incidents.

When users are using the product:

Users should install, handle, store, use, maintain, and dispose of the product according to the product guidelines, relevant laws, regulations, and safety standards, without violating any applicable laws.

Since the conditions and methods in which the user uses this product are beyond the control of the company, the company is not liable for any consequences arising from the following situations. The responsibility lies solely with the user:

- Personal injury, property damage, or product damage caused by improper user operation, failure to follow the product user manual, or other uncertain factors.



- Changes in the product's technical specifications, data, or content of the user manual due to improvements in reliability, functionality, design, or other reasons, without prior notice.

NO:20241018-01A-P

# WINWING SIM

