

# WINWING SIM

WINWING 32 PAC Metal 1.0

Model: 32. PAC. MET. 1

User Manual

V1.0 2025.08.26

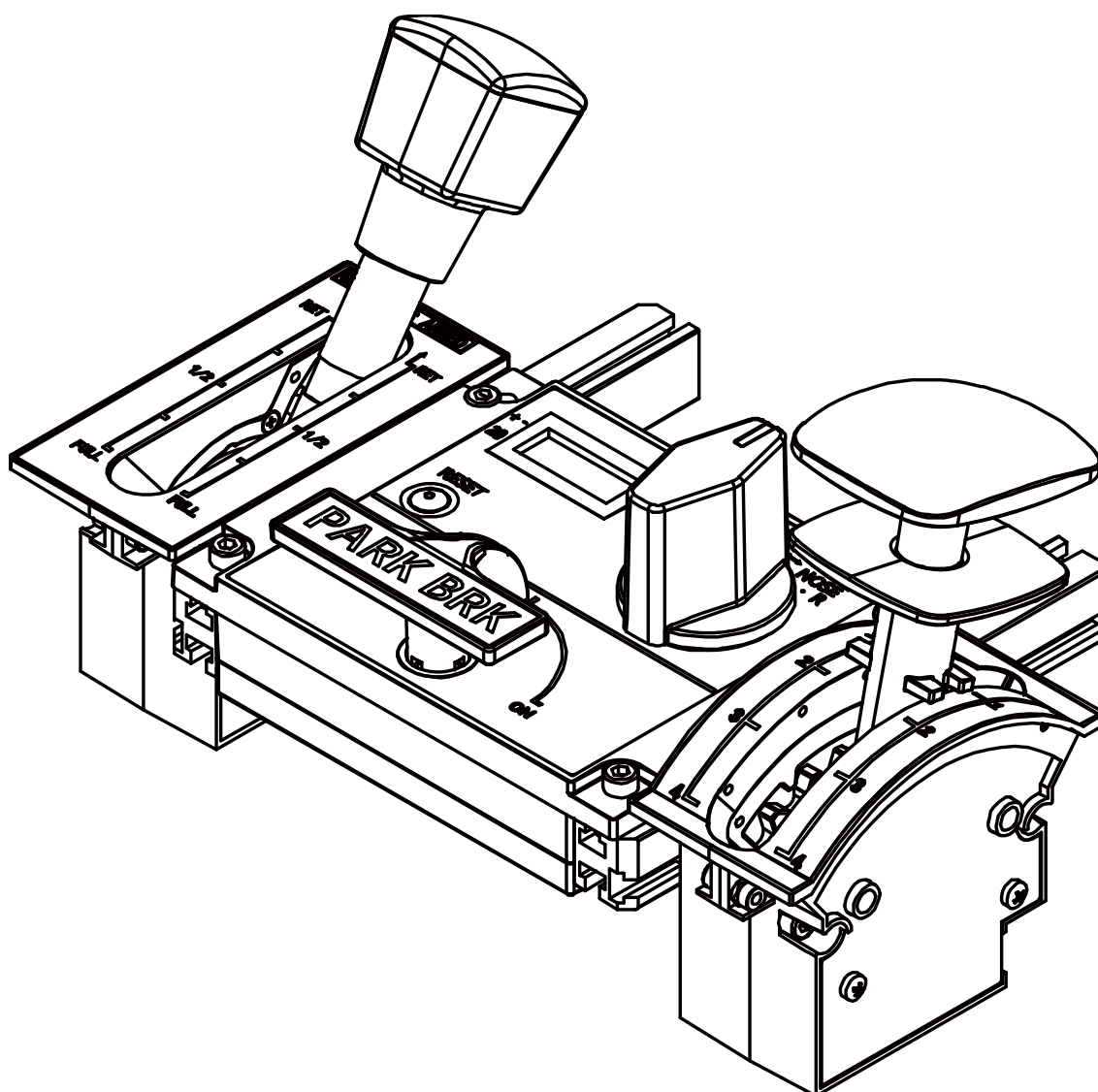

# Packing List

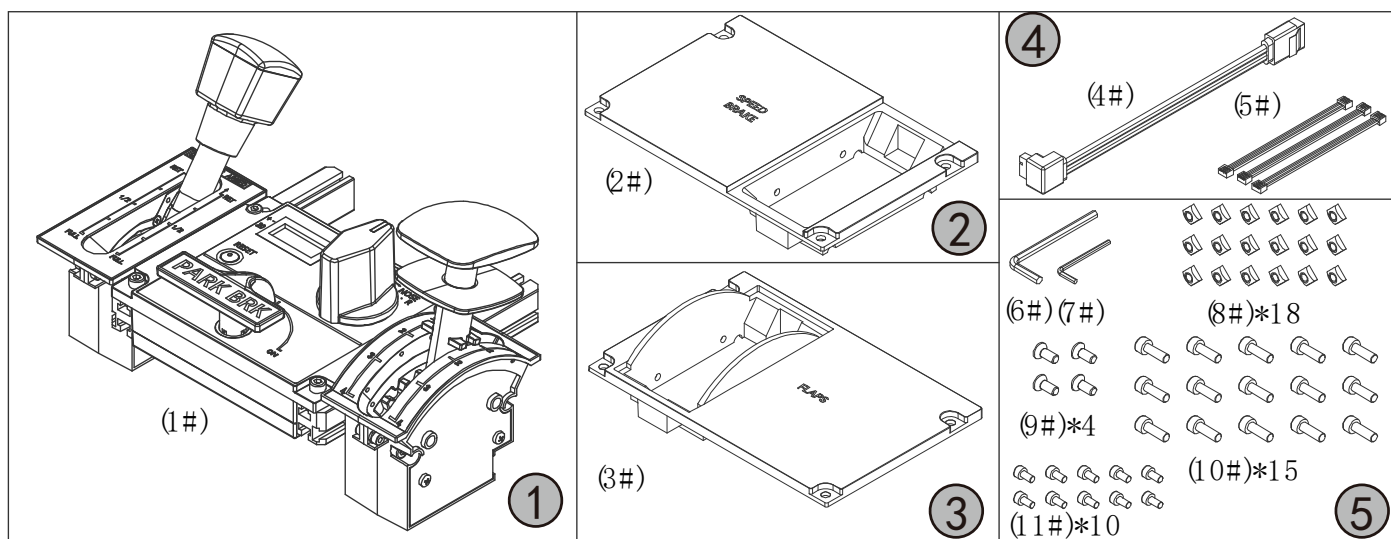

① PAC. Met. 32. 1 (1#) .....1

② SPEED BRAKE Panel (2#) .....1

③ FLAPS Panel (3#) .....1

④ Cables Kit (4#、5#) .....1

4#: SATA Cable

5#: 5P Cable

⑤ Accessory Kit (6#-11#) .....1

6#: Hex Wrench 3 (6#)

7#: Hex Wrench 2.5 (7#)

8#: Square Nut M4 (8#)

9#: Flat Head Socket Cap Screw M4\*10 (9#)

10#: Socket Head Cap Screw M4\*8 (10#)

11#: Socket Head Cap Screw M3\*4 (11#)

## Catalog

|                                                                                    |    |
|------------------------------------------------------------------------------------|----|
| 1. Product Profile .....                                                           | 1  |
| 1.1. Parts Diagram .....                                                           | 1  |
| 1.2. Performance Specifications .....                                              | 2  |
| 1.3. Product Dimensions .....                                                      | 3  |
| 1.4. Installation Dimensions .....                                                 | 4  |
| 1.5. Compatible Unit .....                                                         | 4  |
| 2. First Use .....                                                                 | 5  |
| 2.1. Software Installation .....                                                   | 5  |
| 2.2. Parts Installation .....                                                      | 5  |
| 2.3. How to Use .....                                                              | 5  |
| 3. Function .....                                                                  | 6  |
| 3.1. Mechanical and Special Features .....                                         | 6  |
| 3.2. Buttons .....                                                                 | 6  |
| 3.3. Data Interface .....                                                          | 6  |
| 3.4. Adjustment Method .....                                                       | 7  |
| 4. Installation Methods .....                                                      | 9  |
| 4.1. Connection to U. 32. T. Met. 1.0 .....                                        | 9  |
| 4.2. Panel Disassembly .....                                                       | 11 |
| 4.3. Desk Mount Installation <sup>*(need to be purchased additionally)</sup> ..... | 12 |
| 4.4. Profile Frame Installation <sup>*need to be self-prepared *</sup> .....       | 23 |
| 5. Maintenance and Care .....                                                      | 24 |
| 5.1. Firmware Upgrade .....                                                        | 24 |
| 5.2. Cleaning and Maintenance .....                                                | 24 |
| 5.3. FAQs and After-Sales Service .....                                            | 25 |
| 6 Safety Precautions .....                                                         | 26 |
| Disclaimer .....                                                                   | 27 |



## 1. Product Profile

### 1.1. Parts Diagram

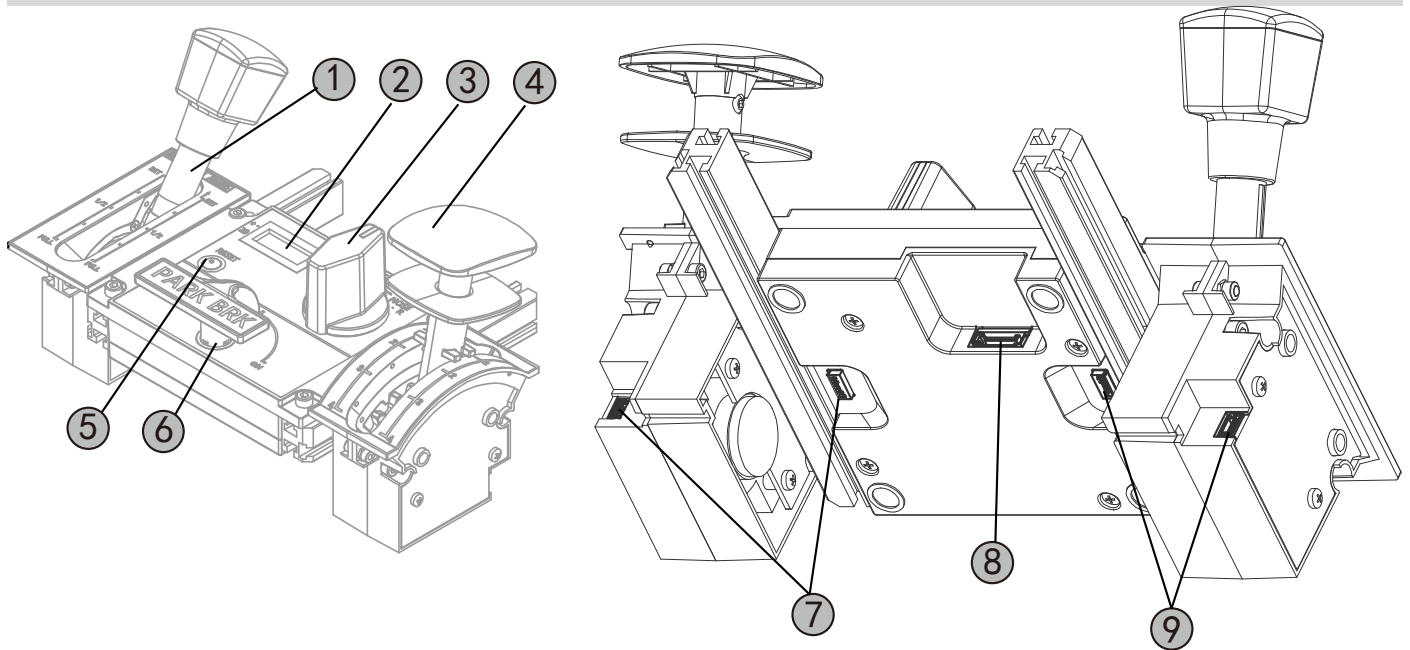

① Speed Brake Axis

④ Flaps Axis

⑧ SATA Communication

② Indicator

⑤ Reset Button

Interface

③ Three-Position

⑥ Parking Brake

⑨ Speed Brake Cable

Auto-Reset Switch

⑦ Flaps Cable Interface

interface

## 1.2. Performance Specifications

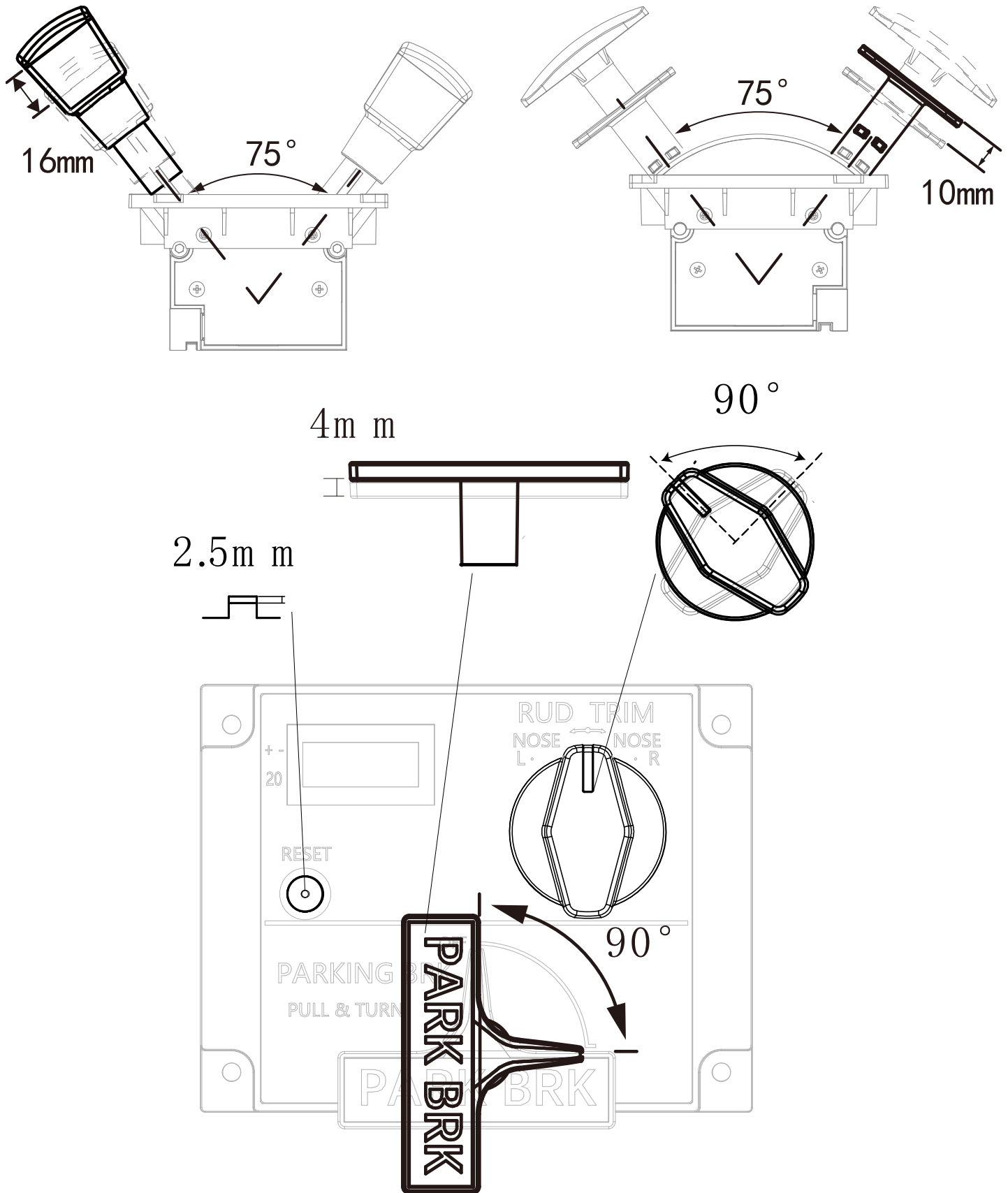

1.2.1. Speed Brake axis travel angle:  $75^{\circ}$  ; lift travel: 16mm;

1.2.2. Flaps axis travel angle:  $75^{\circ}$  ; lift Travel: 10mm;

1.2.3. Reset button press travel: 2.5mm

1.2.4. Parking Brake rotational angle:  $90^{\circ}$  ; lift travel: 4mm;

1.2.5. Auto-Rest Rud Trim rotational angle:  $90^{\circ}$  ;

1.2.6. Indicator

Note: The parking brake is made of plastic; forcing it to turn without properly lifting may cause it to come off or deform.

### 1.3. Product Dimensions

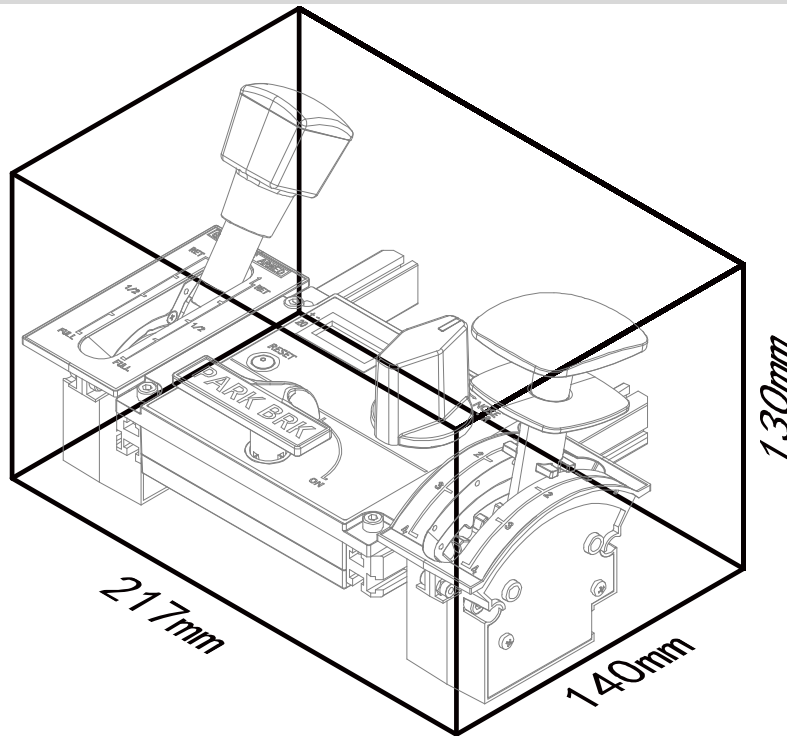

L\*W\*H: 217mm\*140mm\*130mm;

Wight: 0.75 kg=1.66 lb

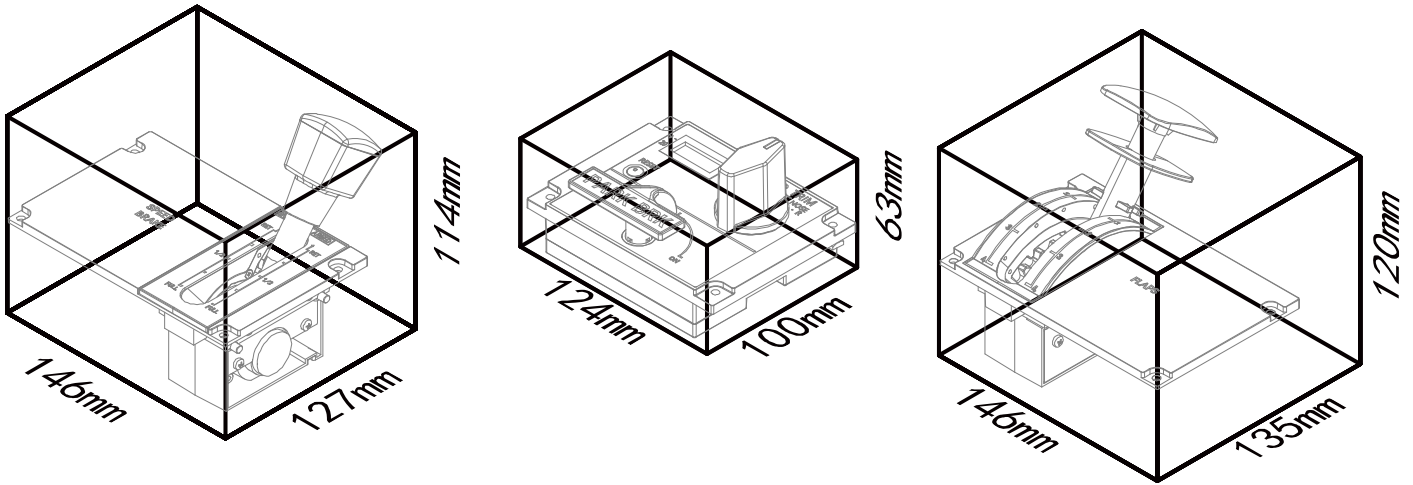

- Speed Brake Panel Assembly: L\*W\*H:146mm\*127mm\*114mm
- Rud Trim Panel Assembly: L\*W\*H:124mm\*100mm\*63mm
- Flaps Panel Assembly: L\*W\*H:146mm\*135mm\*120mm

#### 1.4. Installation Dimensions

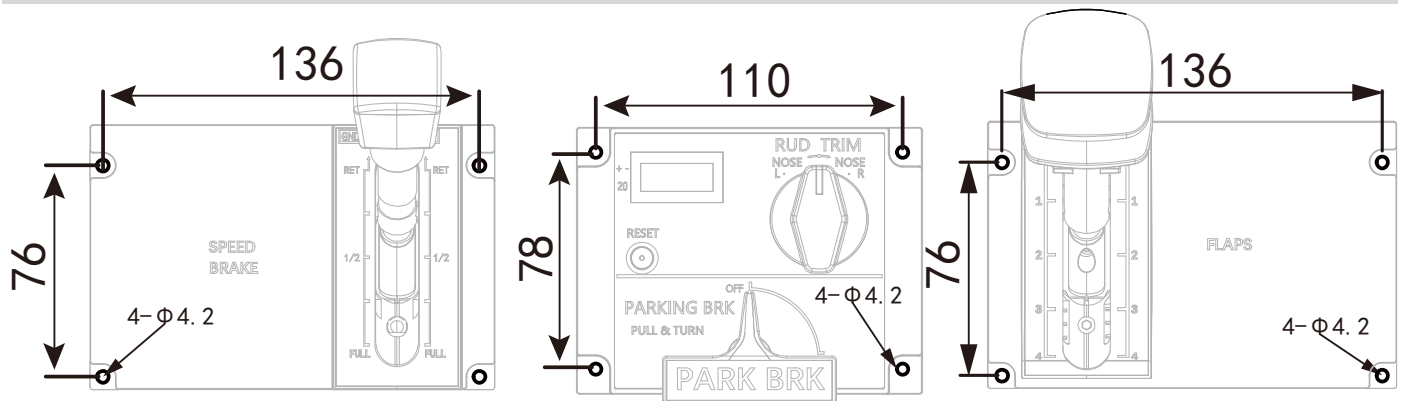

- Speed Brake Panel Mounting Hole: 4-Ø 4.2, Spacing: 136mm\*76mm;
- Rud Trim Panel Mounting Hole: 4-Ø 4.2, Spacing: 110mm\*78mm;
- Flaps Panel Mounting Hole: 4-Ø 4.2, Spacing: 136mm\*76mm.

#### 1.5. Compatible Unit

- Need to connect to U.32.T.Met.1.0 throttle (URSA MINOR 32 Throttle Metal) for use.

## 2. First Use

### 2.1. Software Installation

- Download SimAppPro

Download URL:

For Mainland China Download: <https://cn.winwingsim.com/view/simapppro.html>

For Global Download: <https://winwingsim.com/view/simapppro.html>

- Install SimAppPro

Please follow the instructions to install the software, then run the program.

The product can be customized within SimAppPro. (For more details, refer to the SimAppPro User Manual.)

- When using the product, please run SimAppPro first before entering the game (the product will automatically adapt to supported games and aircraft models, plug-and-play. For more details, refer to the SimAppPro User Manual).

SimAppPro User Manual Download Link:

Chinese User Manual: <https://cn.winwingsim.com/view/regular.html#manual-130>

English User Manual: <https://winwingsim.com/view/regular.html#manual-132>

### 2.2. Parts Installation

- Install with desk mounts (see Section 4 Installation Methods for details).
- Install with profile frames (see Section 4 Installation Methods for details).

### 2.3. How to Use

Device Connection

The product connects to U. 32. T. Met. 1.0 (URSA MINOR 32 Throttle Metal) via the SATA cable (4#). For details on the interface, refer to Section 3.3 Data Interface.

## How to Connect

Insert the included SATA cable (4#) into the product's SATA interface and connect it to your U. 32. T. Met. 1. 0.

For products requiring assembly, only the USB interface supports hot-swapping. For other interfaces, ensure that the product is properly connected before connecting to the computer

(Important: If you need to connect other interfaces such as PS2 or SATA, make sure to disconnect the USB cable before proceeding.)

## 3. Function

### 3.1. Mechanical and Special Features

无/

### 3.2. Buttons

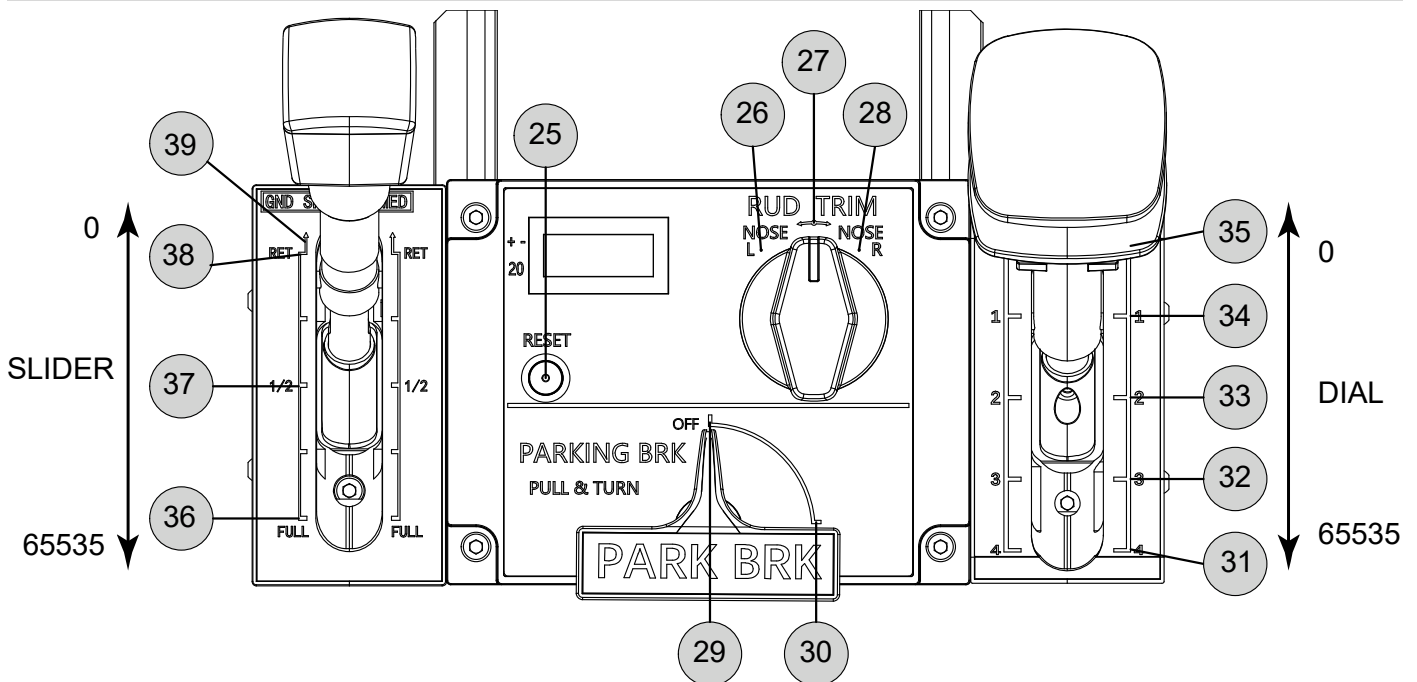

LED Status Display: /

### 3.3. Data Interface

#### SATA Interface

Used for communication and power supply between the product and U. 32. T. Met. 1. 0.

## 55P Interface

Used for communication and power supply for the Flaps and Speed Brake units.

### 3.4. Adjustment Method

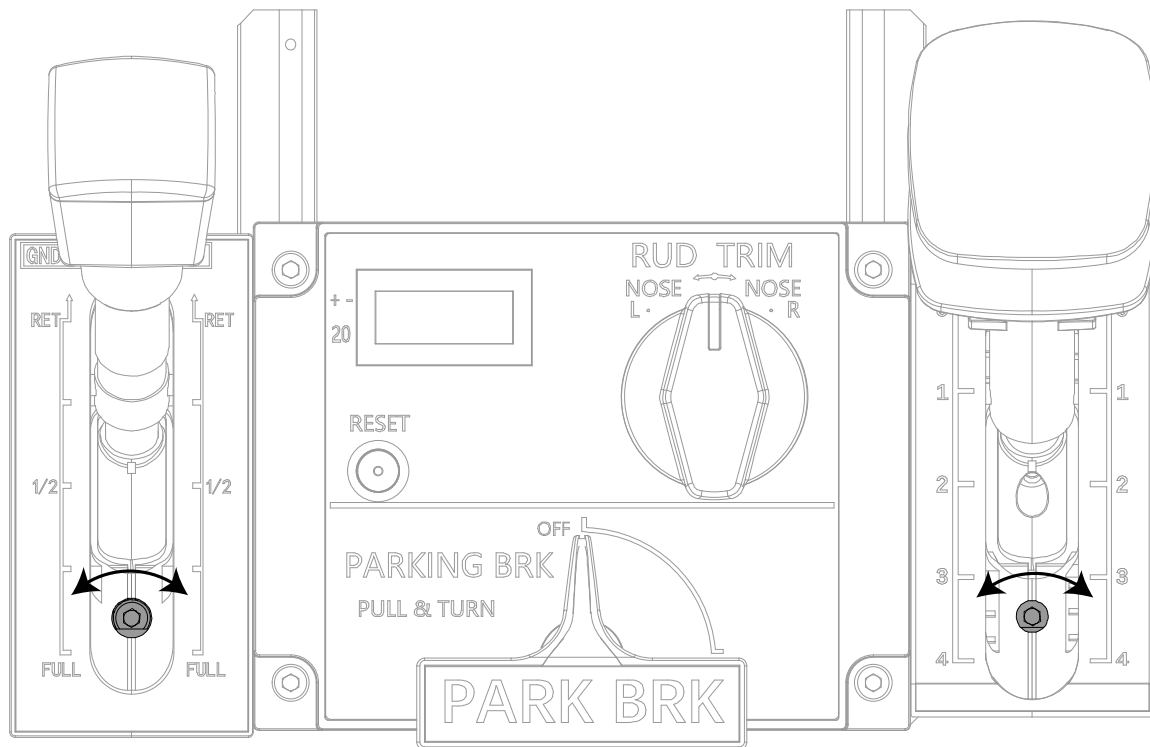

- Speed Brake and Flaps axis resistance adjustment: Tightening the screws in the above diagram clockwise with the Hex Wrench (6#), to increase the resistance of the axis; loosening the screw counterclockwise, to reduce the resistance of the axis.

Note: The screw connection is made of plastic; tightening torque must not exceed 1 N m, as over-tightening may cause the product's resistance adjustment to fail.

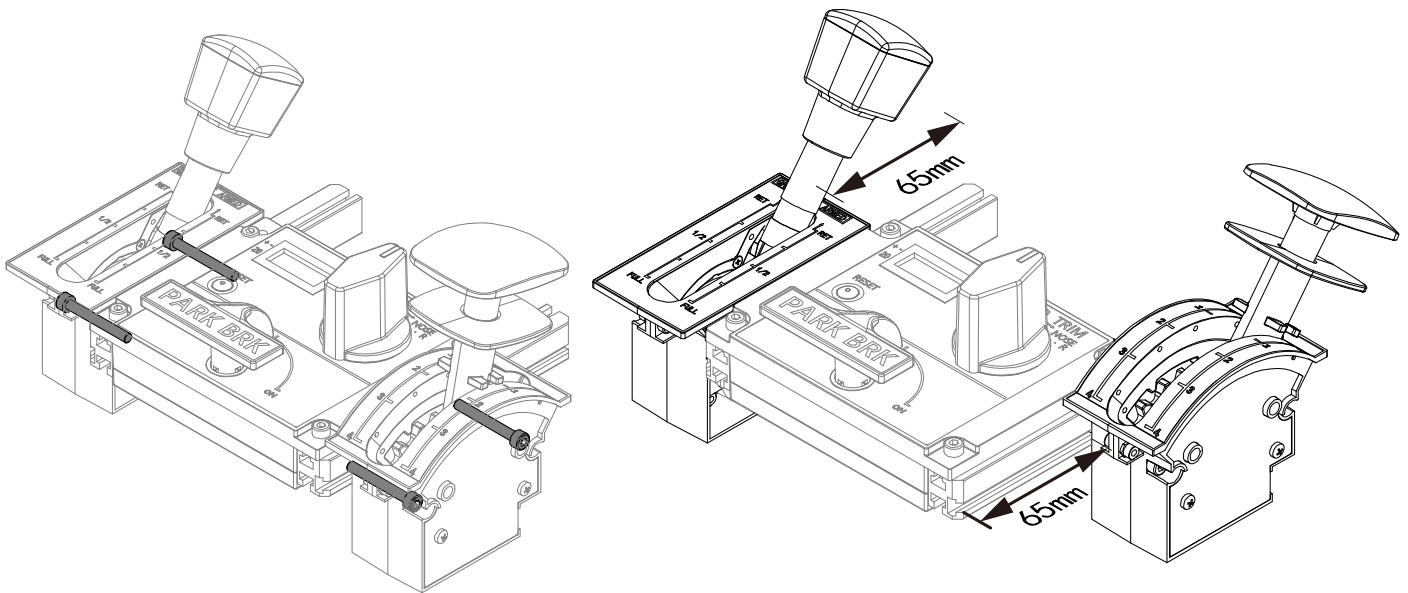

Flaps and Speed Brake units sliding adjustment: Loosen the two screws shown using a 6 mm Hex Wrench (2 - 3 turns counterclockwise). Slide the units forward or backward to the desired position, then tighten the screws.

## 4. Installation Methods

### 4.1. Connection to U.32.T.Met.1.0

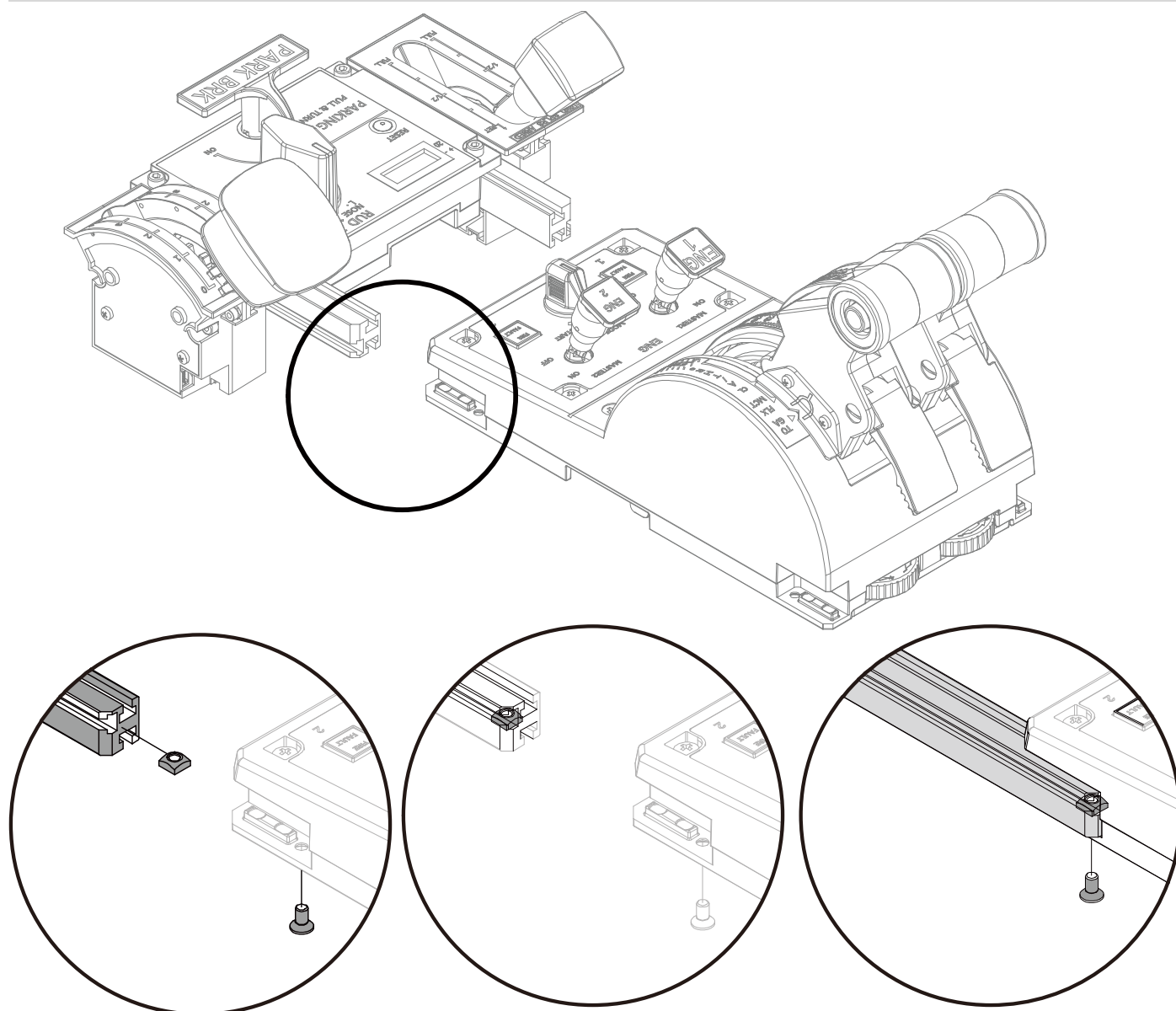

- Place the square nut (8#) inside the rail slot, and insert the rail into the notch of the U.32.T.Met.1.0. Use the Hex Wrench (7#) to tighten the flat head socket cap screw (9#) to the square nut (8#) on the rail.

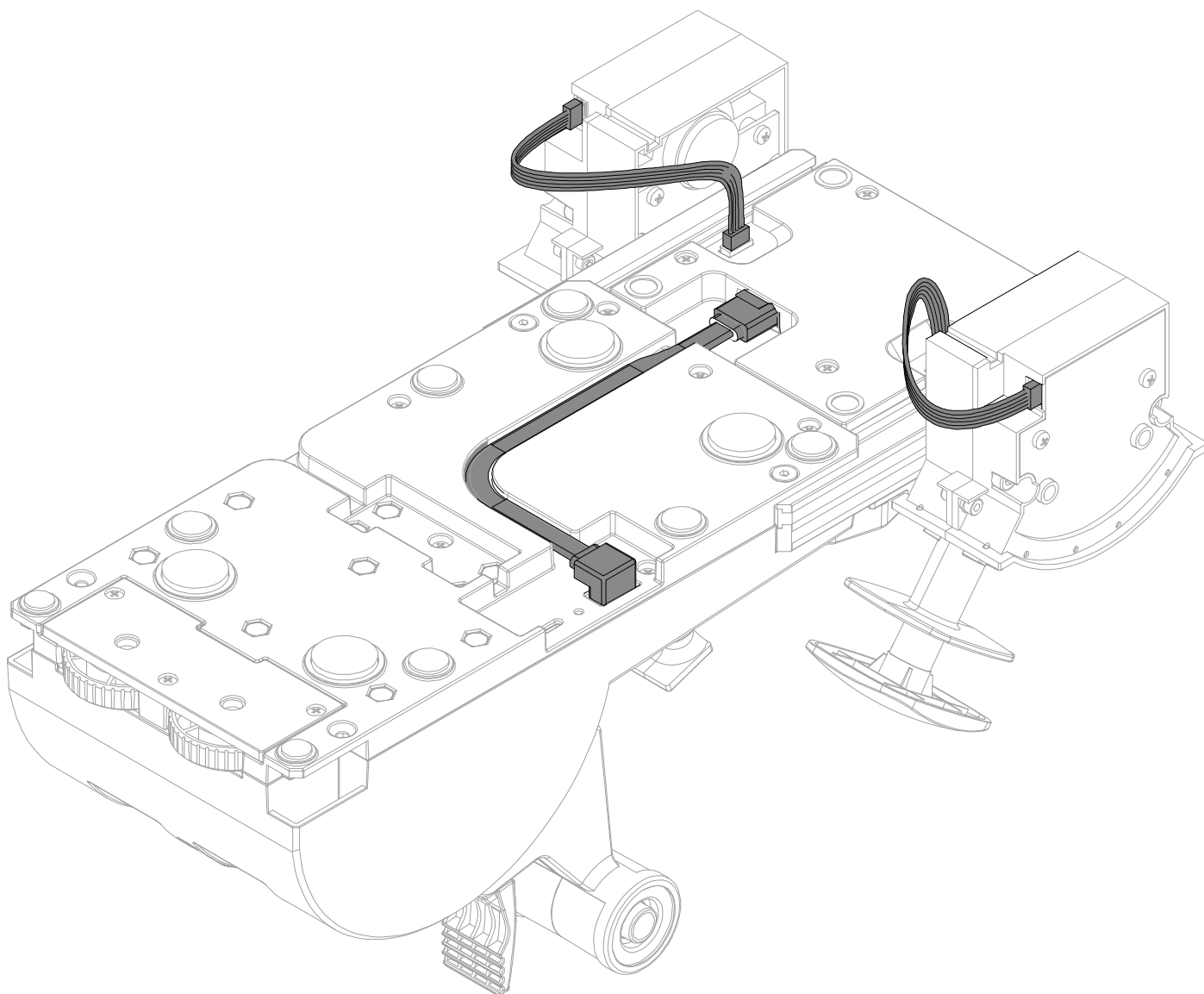

- The SATA cable (4#) should be arranged along the groove. The straight end should be inserted into this product, and the bent end should be inserted into the U. 32. T. Met. 1. 0.

## 4.2. Panel Disassembly

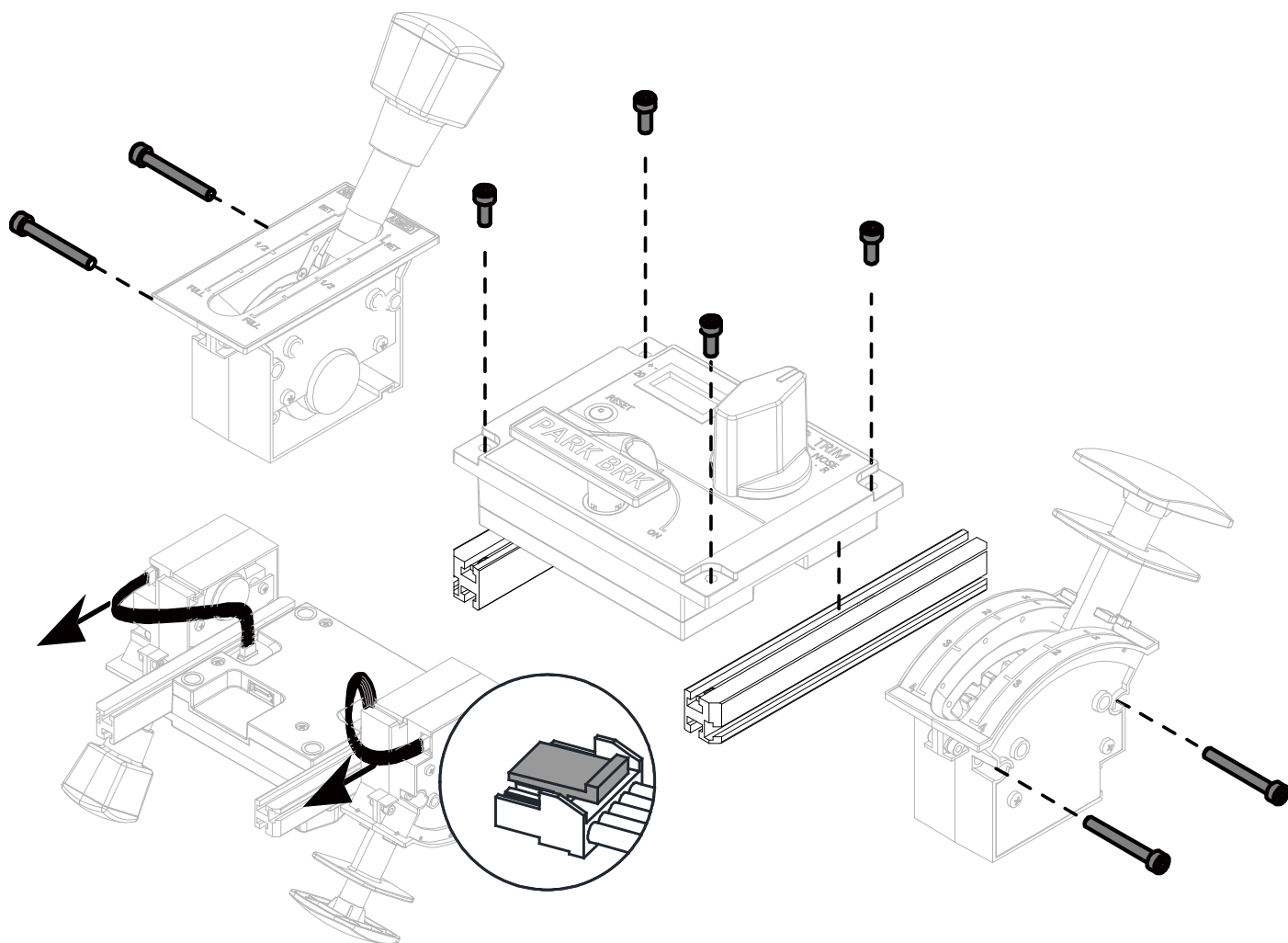

- Remove the cables of the Speed Brake and Flaps units. Use the Hex Wrench (6#) to remove the above screws to separate the assembly.

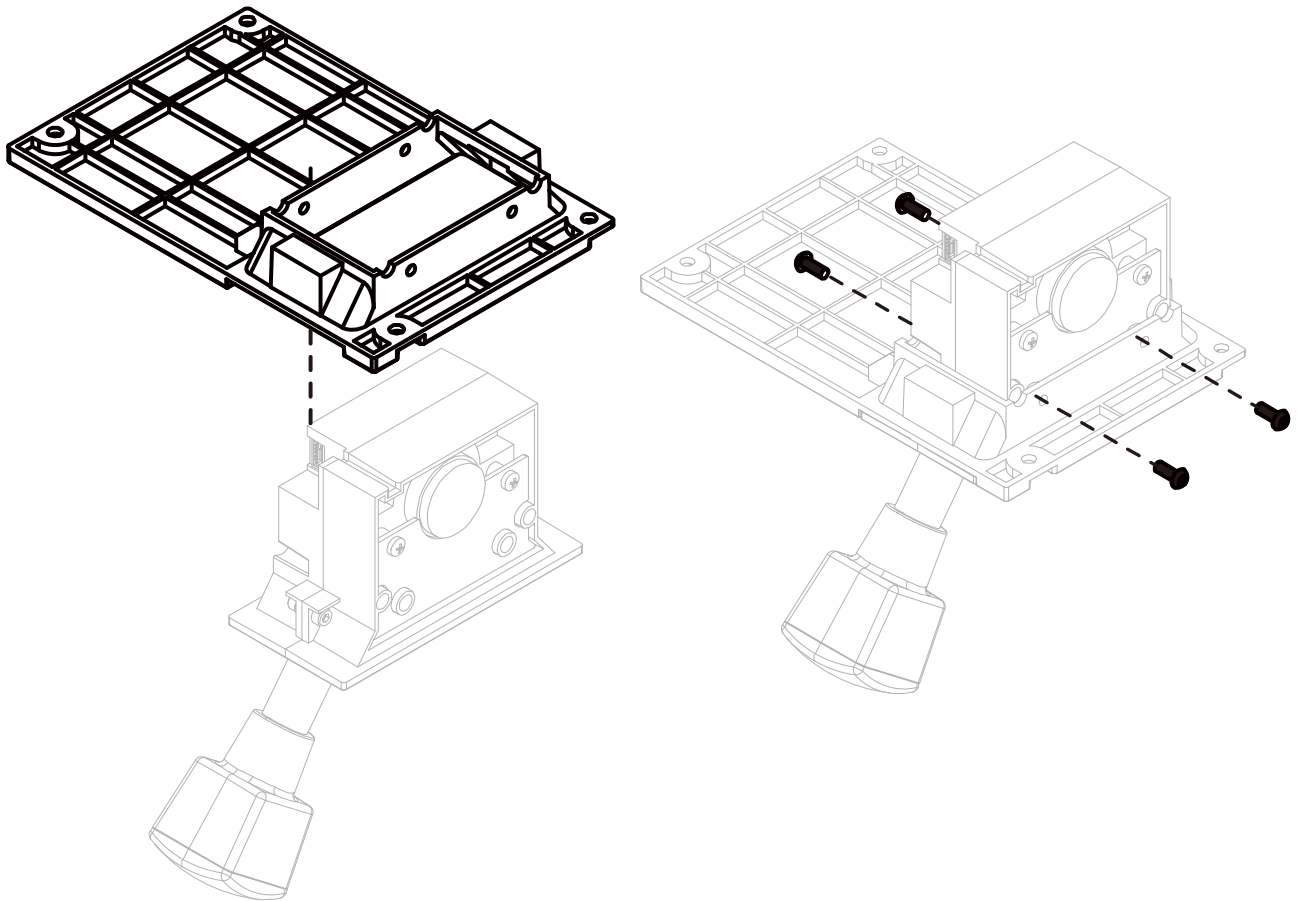

- Put the Speed Brake panel (2#) into the Speed Brake Unit in the direction indicated by the diagram, and then tighten the above four screws 11#.

Note: Same with the Flaps panel. Please safe-keep the screws and nuts to prevent loss.

### 4.3. Desk Mount Installation <sup>\*(need to be purchased additionally)</sup>

4.3.1. Please refer to MT.N.N.5.1 User Manual for Desk Mount assembly.

4.3.2. Install with two U.32.T.Met.1.0

#### ● Recommended Self-Prepared Accessories List

| Item           | Specifications | Quantity |
|----------------|----------------|----------|
| Desk Mount     | MT. N. N. 5. 1 | 4        |
| Hex Head Screw | M5*22          | 12       |

|                                                |                            |    |
|------------------------------------------------|----------------------------|----|
| Sliding Nut                                    | 20-M5                      | 12 |
| Flat Washer                                    | $\phi 5$                   | 12 |
| Flat Washer                                    | $\phi 4$                   | 4  |
| Double-headed<br>GH1.25-5P<br>Connecting Cable | 200mm                      | 2  |
| Mounting Plate                                 | As shown in the<br>diagram | 1  |
| Profile                                        | 1050 (550mm long)          | 4  |
| Open-End Wrench                                | 8                          | 1  |

The size of mounting plate:

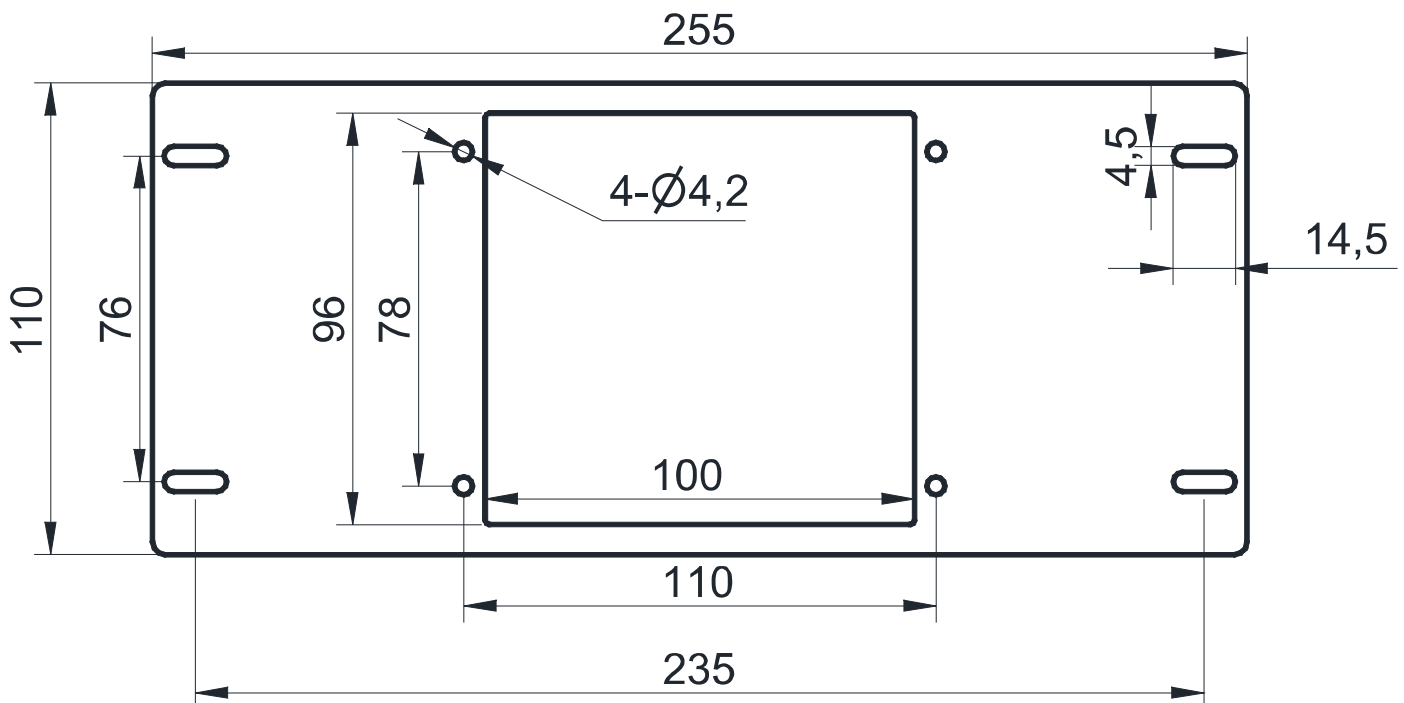

Sectional view of profile 1050

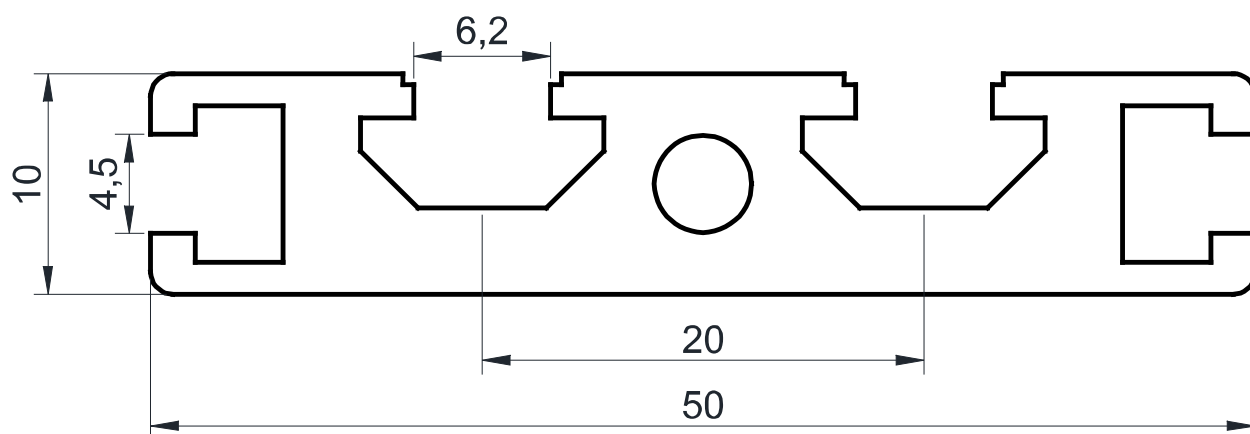

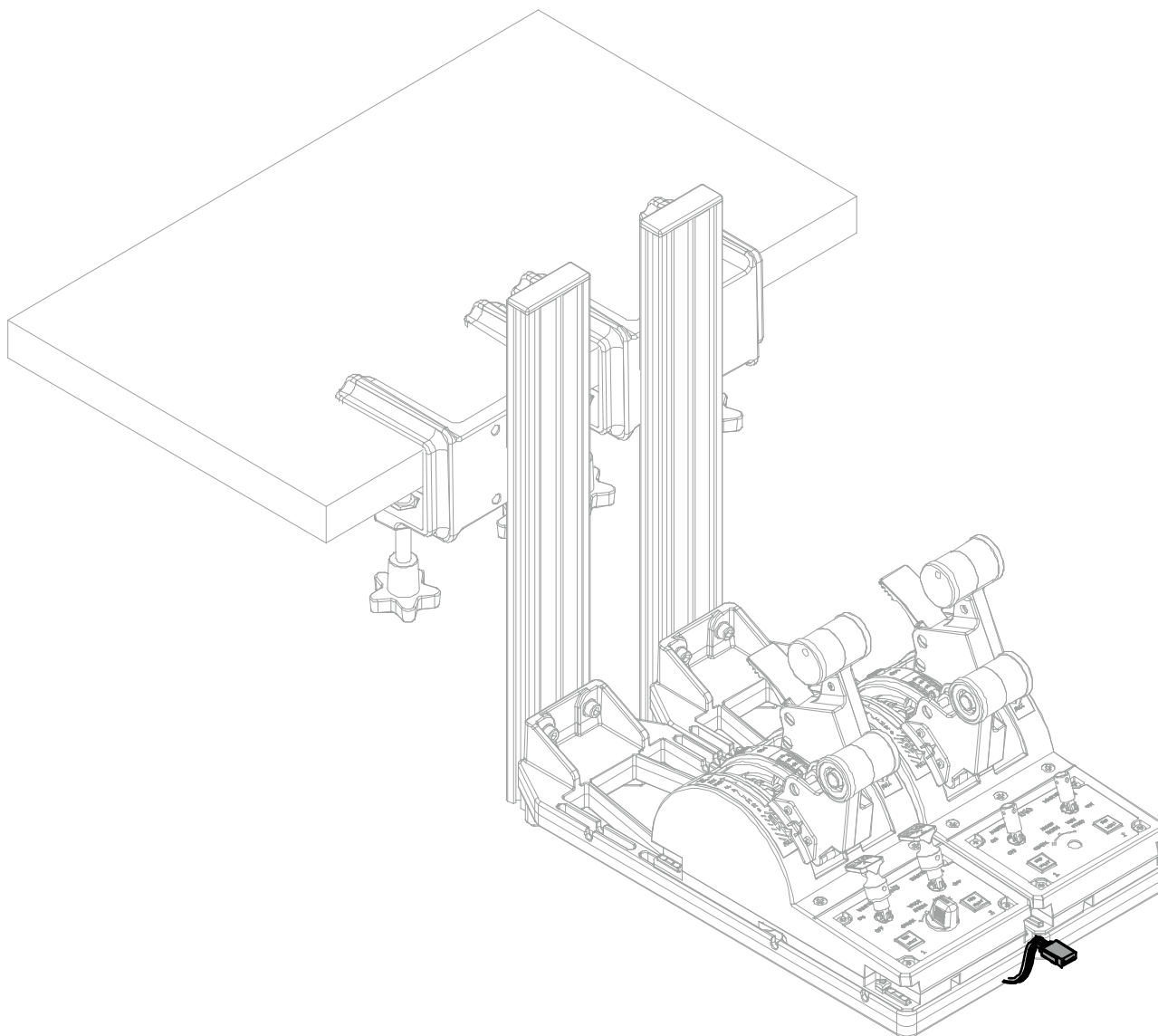

- According to the U. 32. T. Met. 1. 0 User Manual, Connect U. 32. T. Met. 1. 0 and MT. N. N. 5. 1, for desktop mounting. (connect the SATA cable to either one of the U. 32. T. Met. 1. 0 in advance).

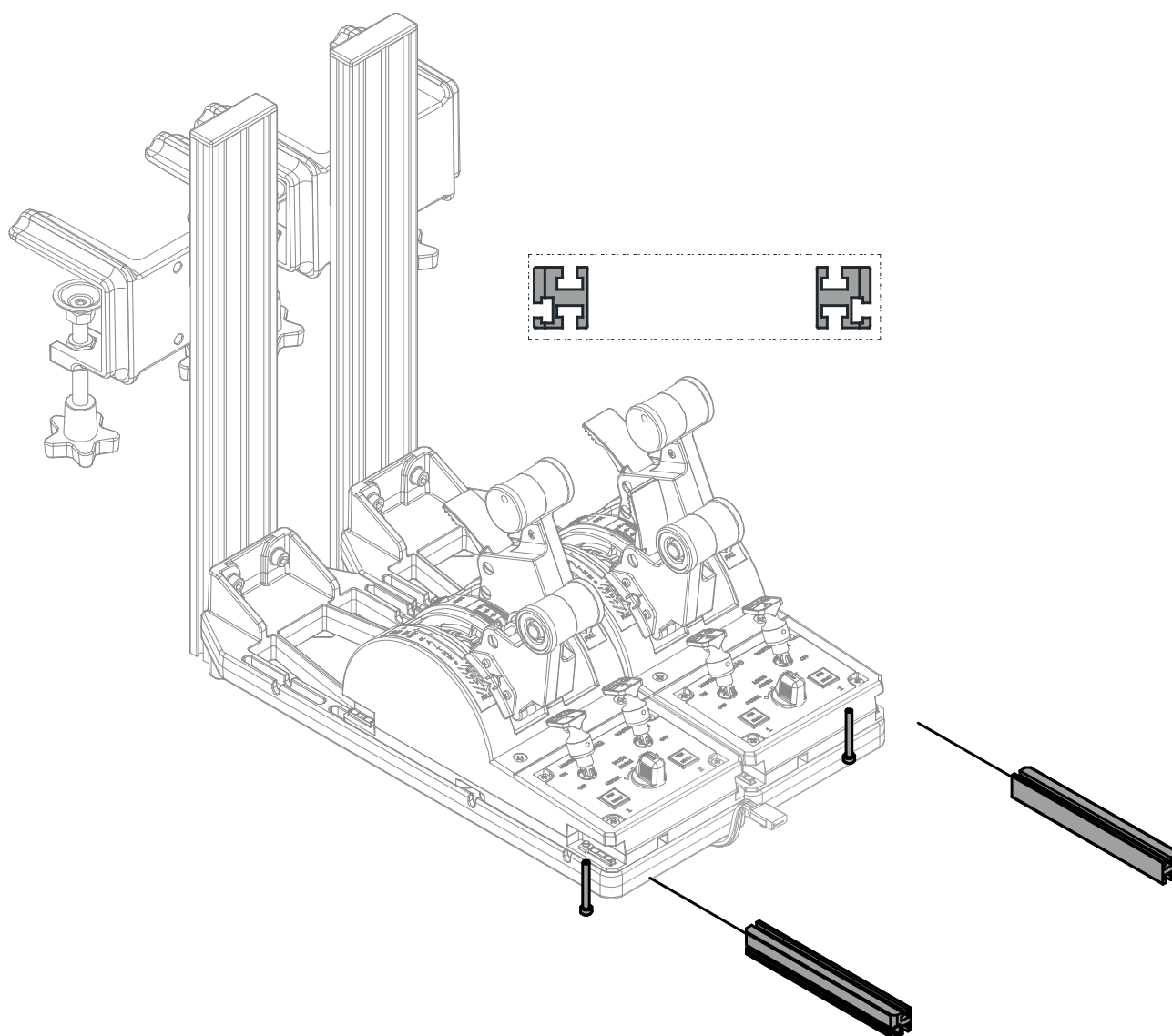

Loosen the two M4 screws on the outer side, insert the rail disassembled in step 4.2 into the notch, and place the square nuts inside the rail to lock the screws (the direction of the guide rail is as shown in the diagram);

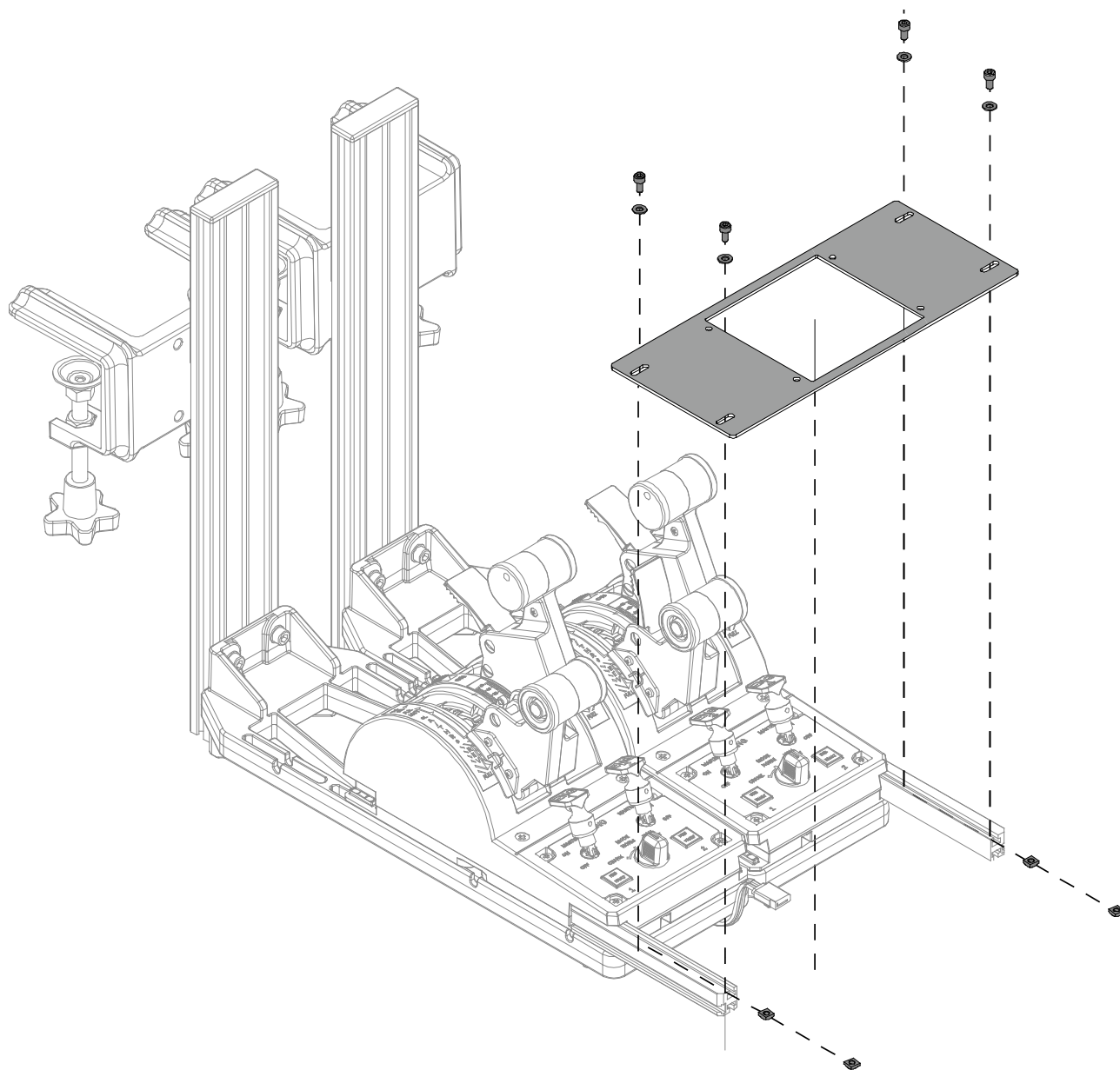

Place the square nuts (8#) inside the rail, and insert the screws (10#) into the flat washers (4) to fix the mounting plate.

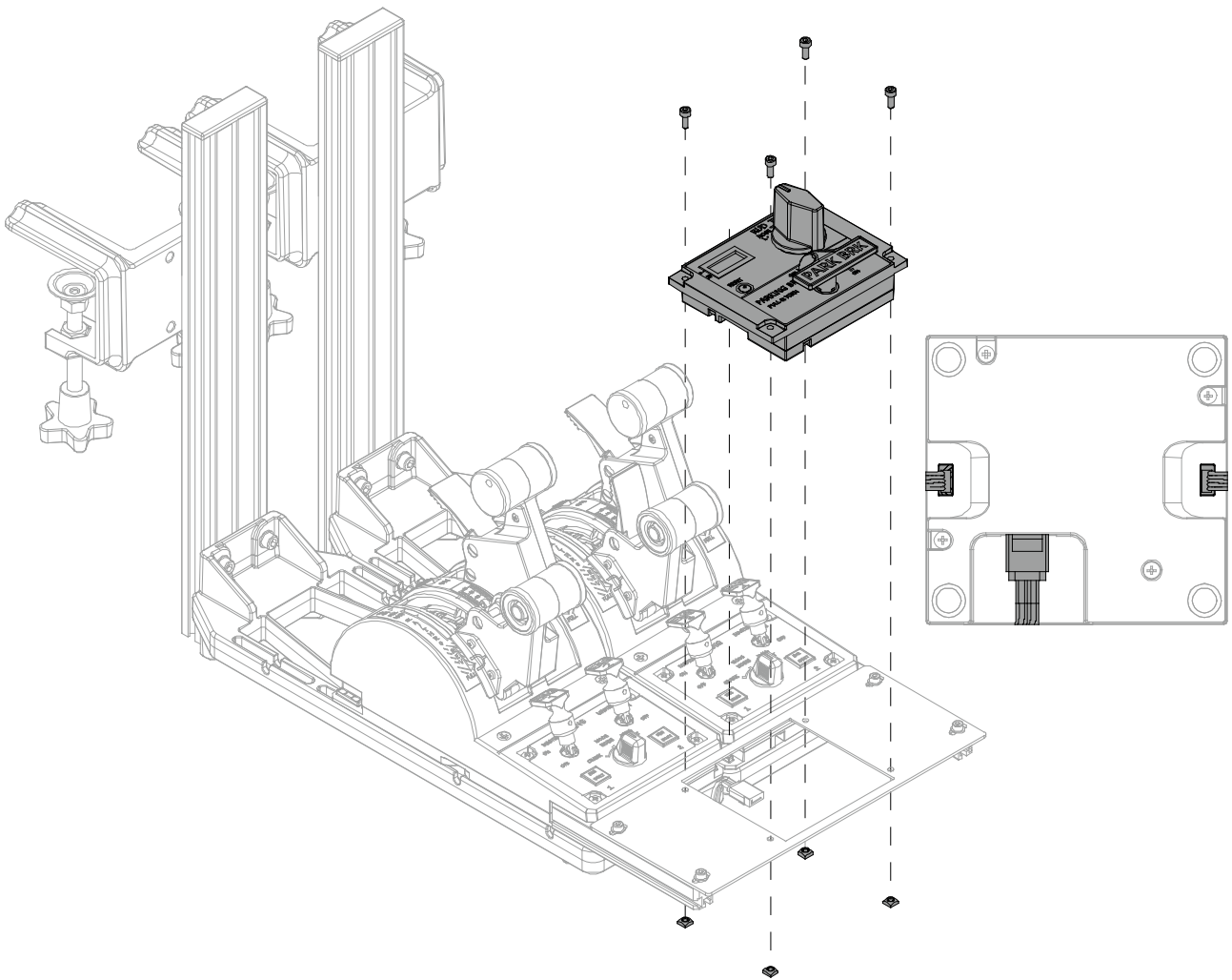

Use the M4\*10 screws and M4 square nuts disassembled in step 4.2 to connect the Rud Trim unit to the mounting plate, and then insert the SATA cable and the self-prepared 5P extension cable;

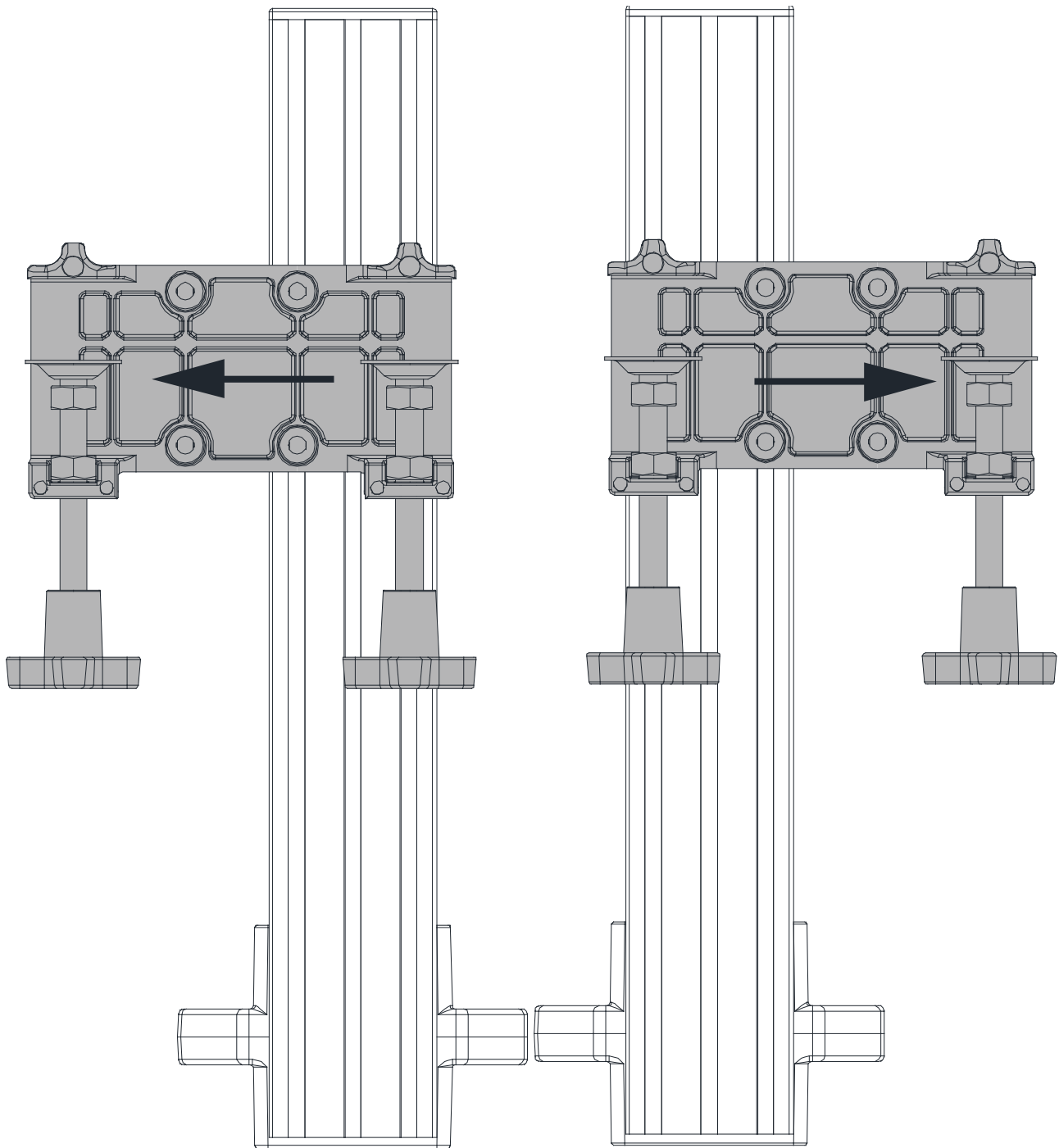

Use the tools included to remove the clamp and move it 40mm horizontally for installation, which is approximately the distance of two grooves. (the clamp of the left bracket moves to the left, and the clamp of the right bracket moves to the right)

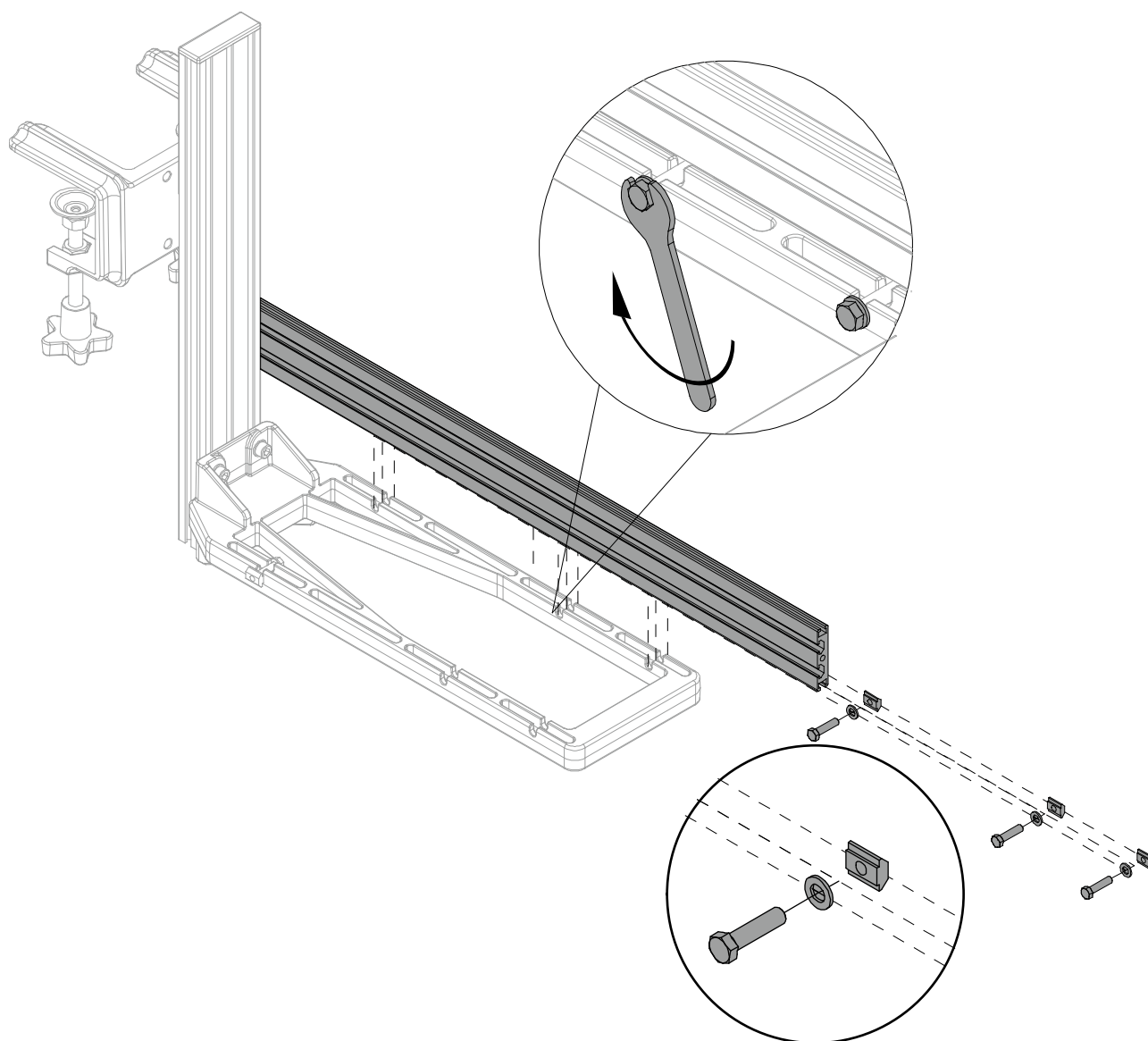

- Insert the M5 hex head screw into the  $\phi 5$  flat washer and screw it into the M5 sliding nut (for 3 to 5 turns). Place the nut into the slot of the 1050 profile and then screw into the groove of the bracket. Use the open-end wrench 8 to tighten the screw. Repeat this step to install the remaining three profiles onto the bracket.

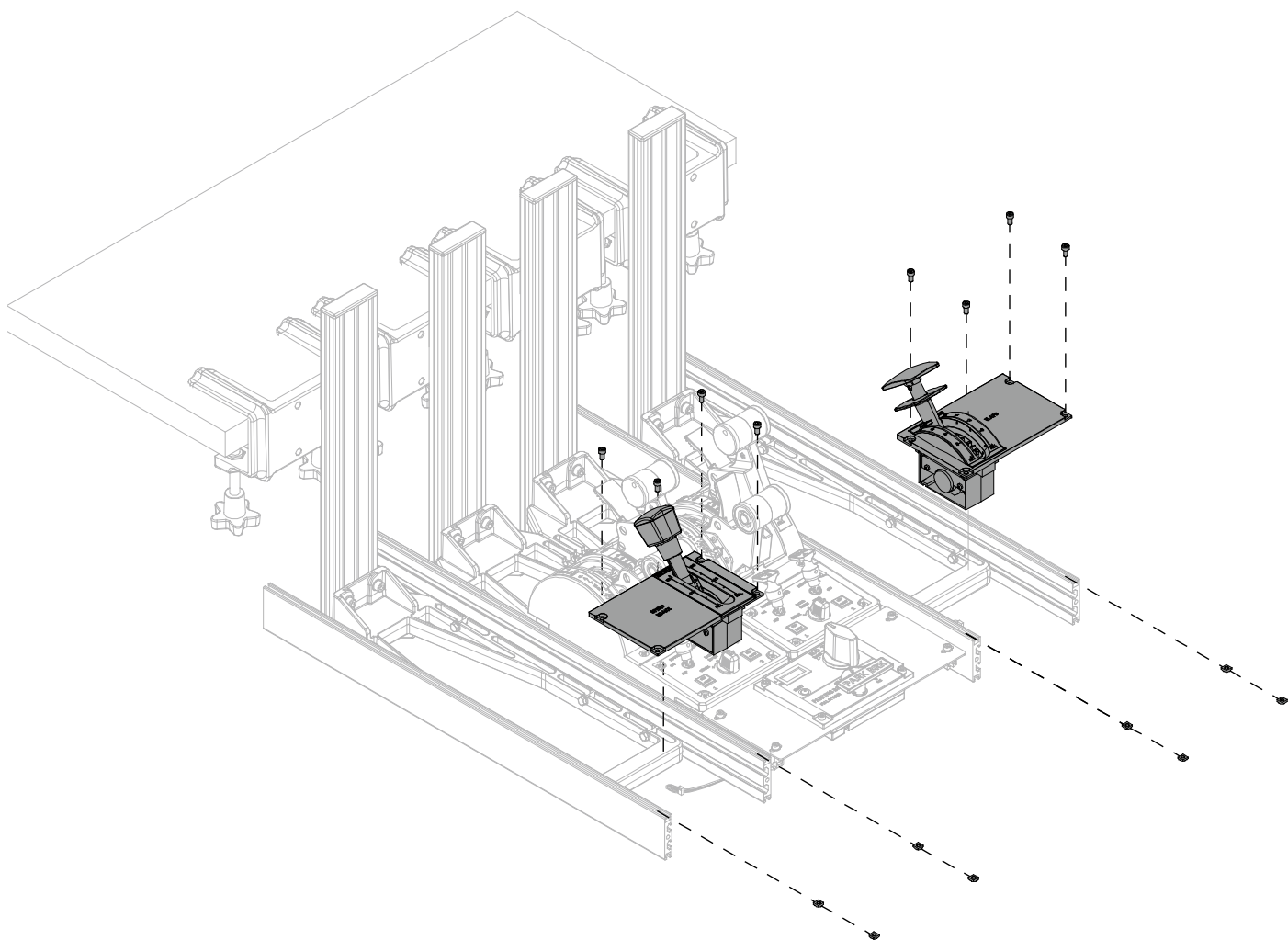

After clamping the Desk Mount, insert the square nut (8#) into the 1050 profile, and use the screws (10#) to fix the Speed Brake and Flaps assemblies to the profile.

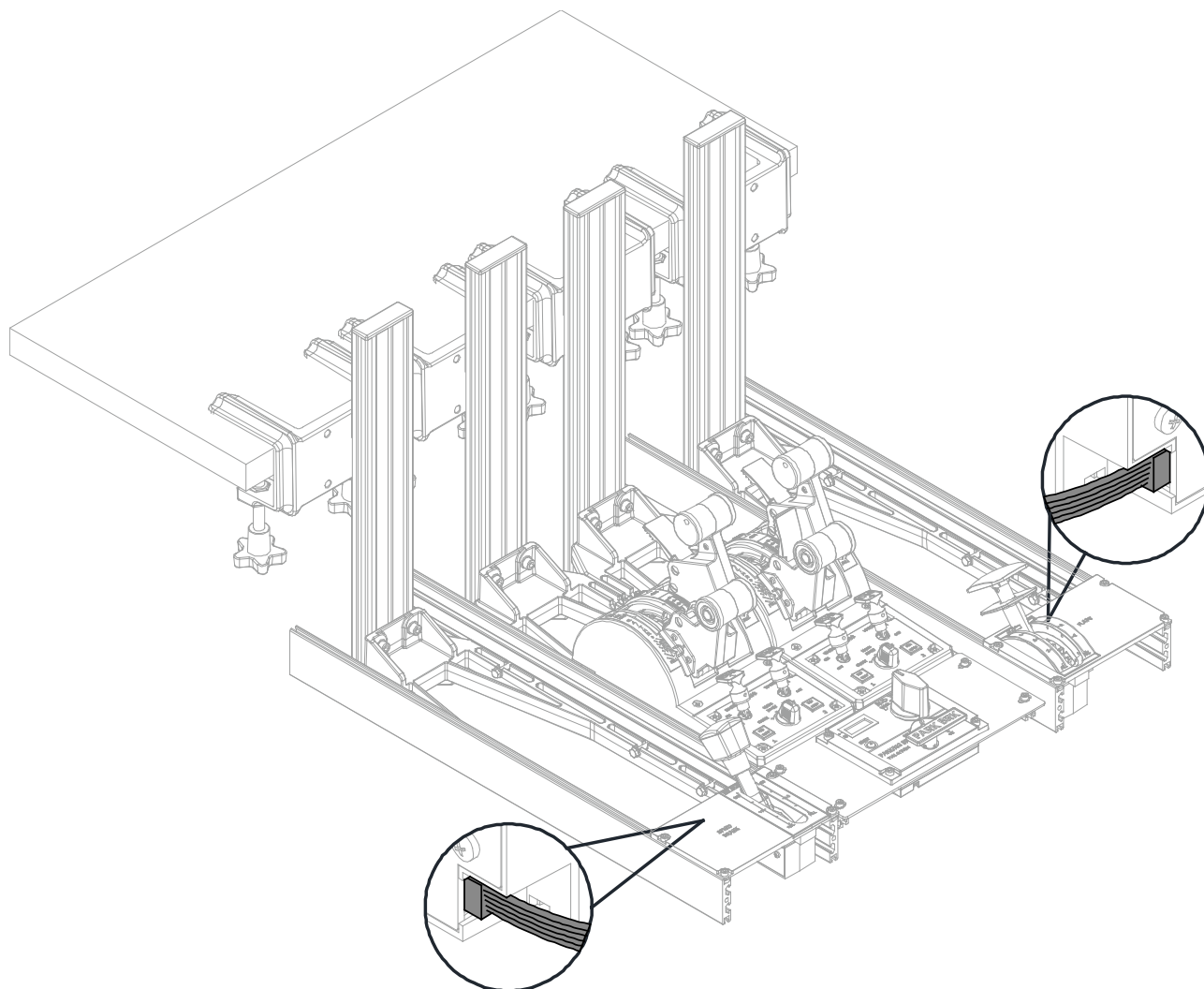

Insert the 5P extension cables into the Speed Brake and Flaps assemblies respectively.

## 4.4. Profile Frame Installation \*need to be self-prepared

- Recommended Self-Prepared Accessories List

| Item    | Specifications                                 | Quantity |
|---------|------------------------------------------------|----------|
| Profile | 1030 (could be changed base on practical need) | 6        |

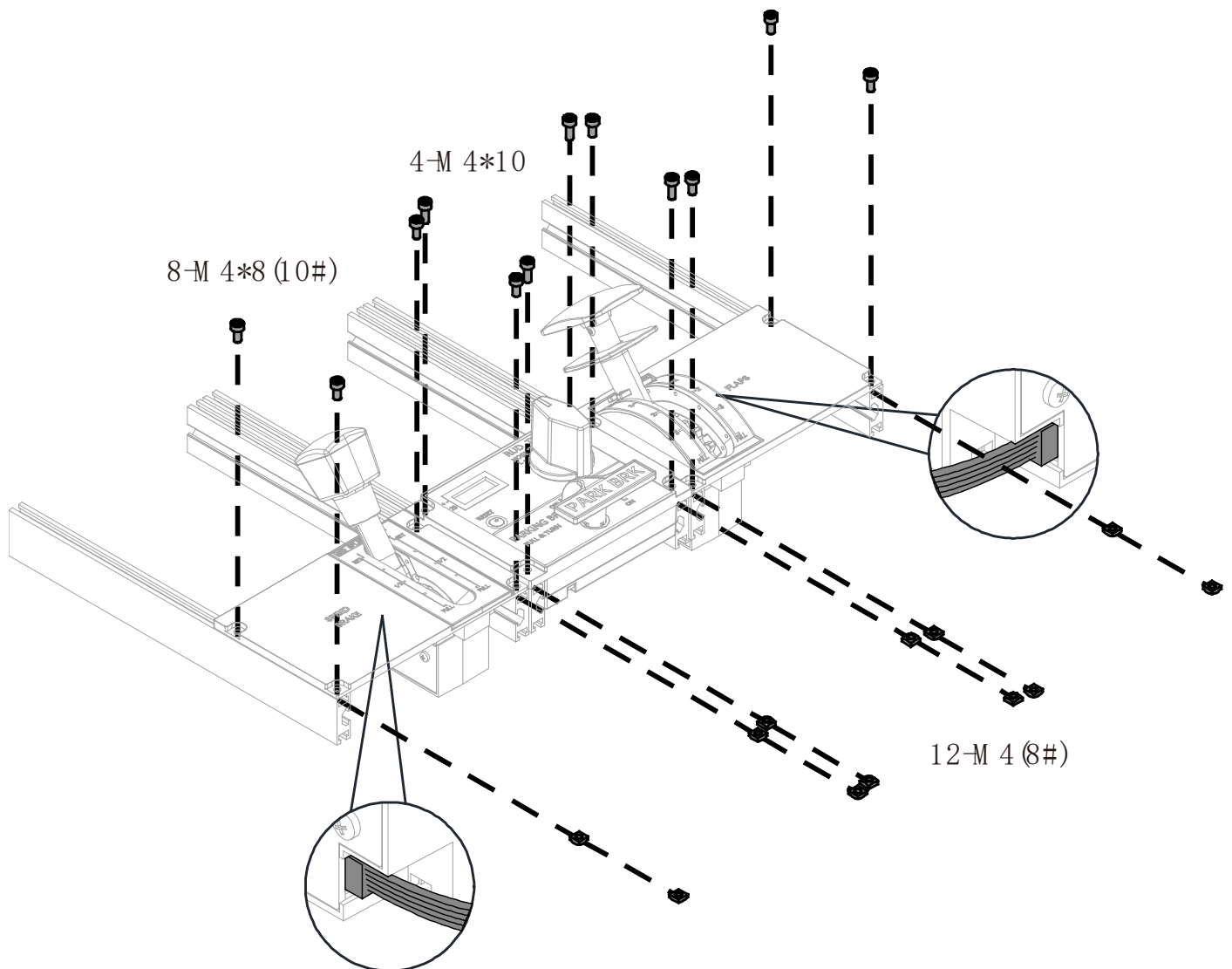

Place 12 square nuts (8#) into the profile respectively. After aligning the positions of the nuts with the corresponding holes of each assembly, screw them in (use the M4\*10 screws removed in Step 4.2 for the Rud Trim assembly, and M4\*8 screws (10#) for the Speed Brake and Flaps assemblies).

Insert the 5P cables into the Speed Brake and Flaps assemblies respectively.

Note: This installation method only demonstrates the connection between the products and the profile. The profile needs to be fixed to the chassis by yourself.

## 5. Maintenance and Care

### 5.1. Firmware Upgrade

#### Firmware Upgrade via SimAppPro

Before upgrading, ensure the product's wiring is securely connected and follow the instructions on the SimAppPro interface.

If you encounter issues during the upgrade, try restarting SimAppPro and reconnecting the device' s USB Data Port.

\* NOTE: Other interfaces, such as PS2 or SATA, do not support hot-swapping. If you need to connect these interfaces, please disconnect the USB cable first.

If the upgrade still cannot be completed, please contact Customer Service on WINWING website for technical support.

### 5.2. Cleaning and Maintenance

- To prevent accidental dust and dirt entering its interior, the product features a dust-proof design. However, it cannot guarantee complete prevention from dirt, dust, water or salt. Please keep the product clean and avoid above debris as much as possible.

- It is recommended to clean the product after use. Allowing dirt, dust, water or salt to remain on the product may cause malfunction.
- Do not place the product near objects with strong magnetic fields, such as magnets or electric motors. Strong magnetic fields may cause abnormal data from the product.
- Do not place the product in high-temperature areas, such as being exposed to direct sunlight inside a car. High temperatures may cause product malfunction.
- The product contains precision electronic circuits. Do not disassemble the product by yourself.
- Do not touch the product's electronic contacts with your fingers to avoid corrosion. Corroded contacts may lead to product malfunction.
- If the product is suddenly moved from a low-temperature environment to a warm room, condensation may form on the surface and interior. To prevent condensation, place the product in a sealed plastic bag and wait for the temperature to gradually rise before removing it from the bag.
- If condensation occurs on the product, refrain from using it to avoid damage. Wait for all moisture to evaporate before continuing to use the product. Even the product is fully dried, the internal components may still be at a low temperature.
- Avoid storing the product in chemical laboratories or areas with chemicals that may cause rust or corrosion.
- Use only original parts for maintenance and replacement.

### 5.3. FAQs and After-Sales Service

Frequently Asked Questions:

- If the product is experiencing abnormalities, please check if the firmware and SimAppPro version are up to date and perform an upgrade if necessary.
- If you experience signal instability or drift during use, try re-calibrating within SimAppPro or clearing the game controller data in Windows.
- If the product is having issues with unstable connection or is not recognized by the computer, try switching to a different USB port (it is recommended to use a USB port directly on the motherboard or a three-prong USB hub with independent power and proper grounding). Also, try cleaning the data cable's connectors with alcohol or replacing the cable to see if the signal stabilizes.

\* NOTE: If you need to connect other interfaces, such as PS2 or SATA, please disconnect the USB cable first before proceeding.

- After connecting the product to the computer, make sure to secure the cables in the fixed clips to prevent damage to the product's connectors.
- When assembling and connecting the product and accessories, ensure that the screws are tightened correctly and that no components are loose or over-tightened. Incorrect handling may cause unusual sounds during operation.
- When using a USB hub to connect the product, ensure that the three-prong hub has independent power supply and proper grounding. Otherwise, the product's signal may be unstable.

## 6 Safety Precautions

For safe use of the product, please be sure to read and follow these precautions to prevent harm or injury.

- Keep the product out of the reach of children.
- Swallowing product parts or accessories is extremely dangerous. If swallowed accidentally, seek medical attention immediately.
- Use only the intended power supply specified in the product user manual.
- Do not disassemble or modify the product.
- Do not subject the product to strong impacts or vibrations.
- Do not touch any exposed internal components.
- If the product emits smoke, unusual odor, or exhibits any abnormal behavior, stop using it immediately.
- Do not clean the product surface with organic solvents such as alcohol, gasoline, or paint thinner.
- Do not get the product wet, and do not insert foreign objects or pour liquids into the product.
- Do not use the product in environments where flammable gases may be present, as static electricity may cause explosions or fires.
- During thunderstorms, do not touch the product connected to a power outlet, as this may result in electric shock.

## Disclaimer

Please read and understand the contents of the product user manual carefully. Failure to follow the instructions may result in personal injury or damage to the product.

Ensure that all personnel using this product are familiar with and understand the user manual for best utility.

Any personal injury, property damage, or product damage resulting from improper use or failure to follow the user manual will be the sole responsibility of the user. The company will not be held liable for such incidents.

When users are using the product:

Users should install, handle, store, use, maintain, and dispose of the product according to the product guidelines, relevant laws, regulations, and safety standards, without violating any applicable laws.

Since the conditions and methods in which the user uses this product are beyond the control of the company, the company is not liable for any consequences arising from the following situations. The responsibility lies solely with the user:

- Personal injury, property damage, or product damage caused by improper user operation, failure to follow the product user manual, or other uncertain factors.
- Changes in the product's technical specifications, data, or content of the user manual due to improvements in reliability, functionality, design, or other reasons, without prior notice.

NO: 20241018-01A-P

# **WINWING SIM**

[WINWINGSIM.COM](http://WINWINGSIM.COM)