

EFIS-32L

User Manual V1.02024.09

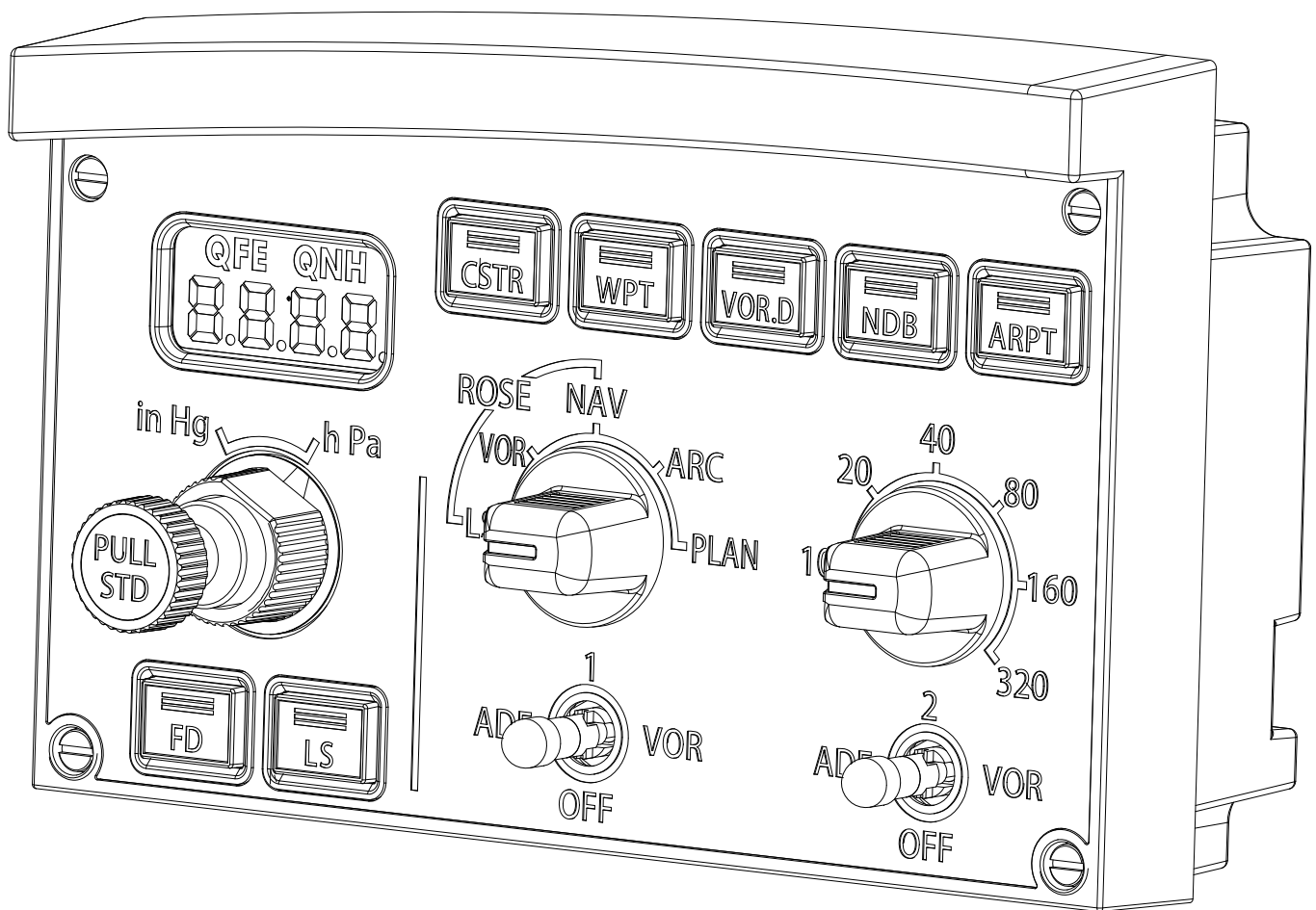

Catalog:

Package List	1
1 Parameters	2
1.1 Performance Parameters	2
1.2 Applicable Models	3
1.3 Dimensions	3
1.4 Installation Dimentions	4
2 Functions	5
2.1 Mechanical/Special Functions	5
2.2 Key Functionality	5
2.3 Adjustment Methods	6
3 Components Assembly and Disassembly	6
4 Installation Methods <small>*FCU1 and EFIS-32R Sold Separately.</small>	7
4.1 Mounting with FCU* <small>FCU Sold Separately</small>	7
4.2 Bracket Mounting	10
4.3 Panel Mount 1 (MP1) Mounting <small>*MP1 Sold Separately</small>	15
4.4 Game Seat Mounting	17
4.5 Cockpit Mounting <small>*Cockpit frame and mounting screws need to be self-prepared.</small>	18
4.6 Cascading	19

Package List

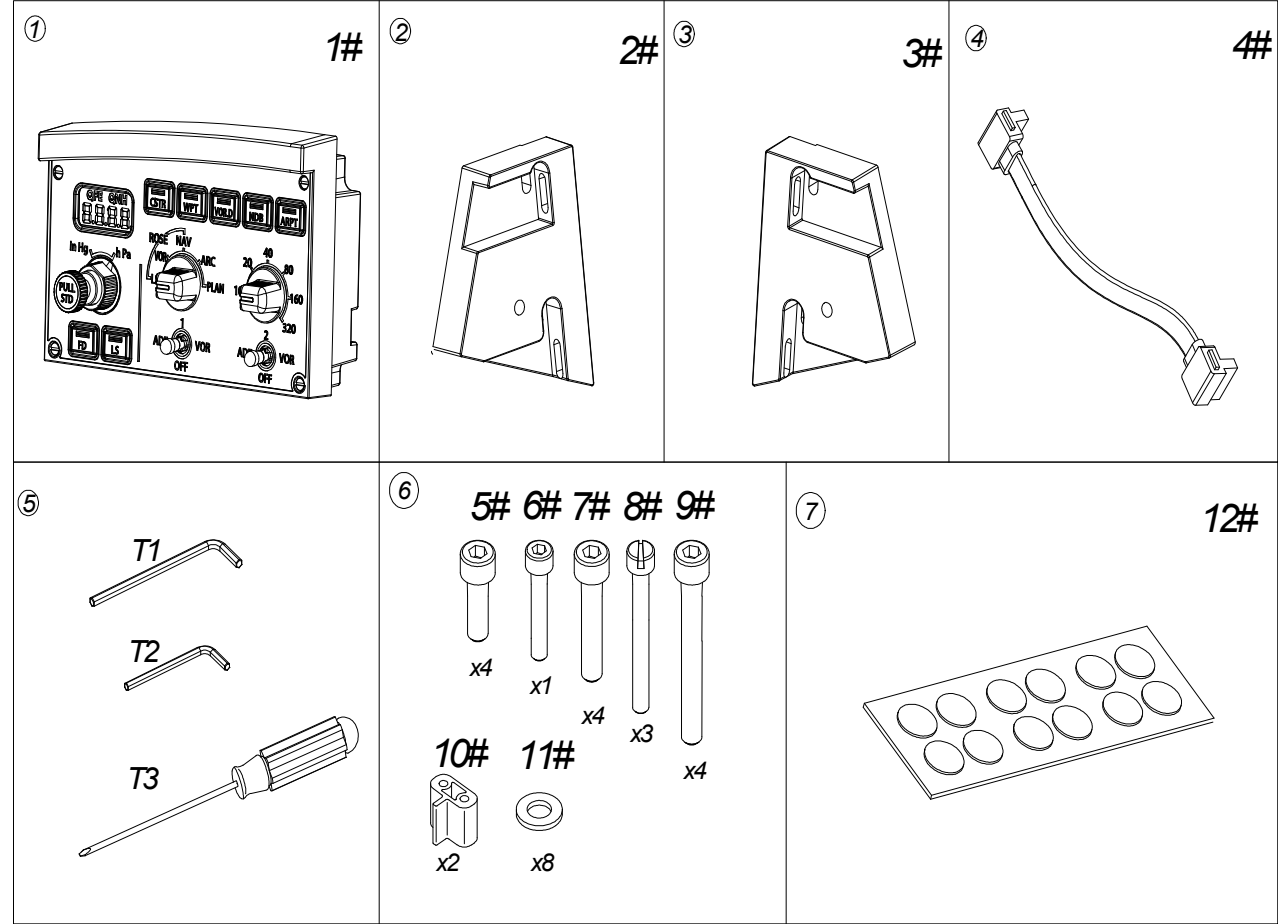

①	EFIS-32L (1#)	1
②	Mounting Bracket-Left (2#)	1
③	Mounting Bracket-Right (3#)	1
④	Data Cable (4#)	1
⑤	Tools Kit (T1-T3)	1
⑥	Accessories Kit 1 (5#-11#)	1

5#	Hexagon Socket Screw M5*16	6#	Hexagon Socket Screw M3*20
7#	Hexagon Socket Screw M5*22	8#	Slotted Cylinder Screw M3*35
9#	Hexagon Socket Screw M5*40	10#	EFIS-32-Connector 1
11#	Washer M5*10*1		

⑦	Nano Double Sided Adhesive Dots (12#)	1
---	---------------------------------------	---

1 Parameters

1.1 Performance Parameters

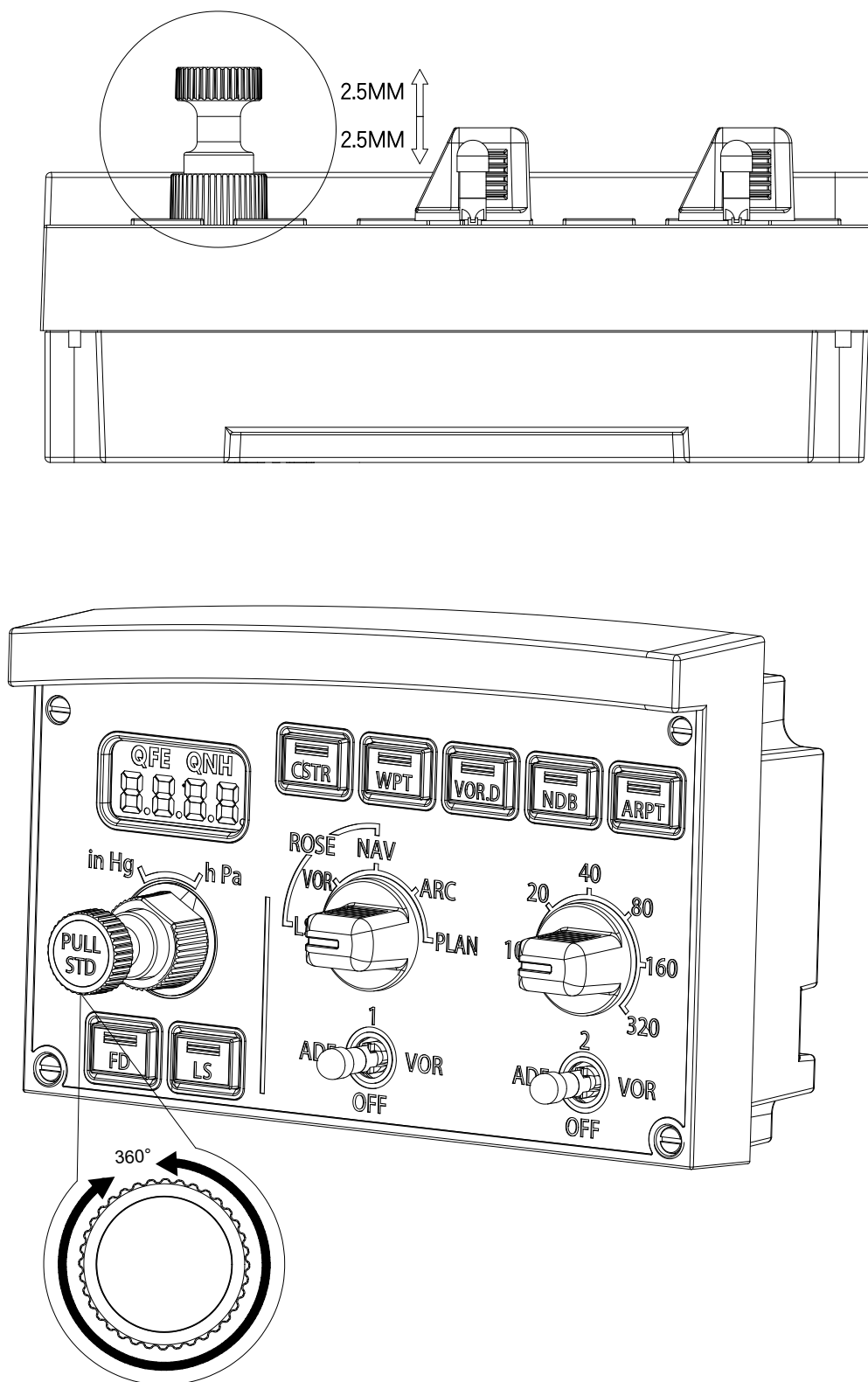

- ① PULL STD Knob has a push-pull stroke of 2.5mm and can rotate 360° (without detents).
Note: Only push, pull, and rotate; do not bend. Bending destructive force is 500gf.
Maximum rotational torque is 150gf · cm, maximum push-pull force is 1200gf.

1.2 Applicable Models

- ① Use together with one FCU
- ② Compatible with panel mount (MP1)
- ③ Compatible with 4080 profile (profile rails and accessories need to be self-prepared)

1.3 Dimensions

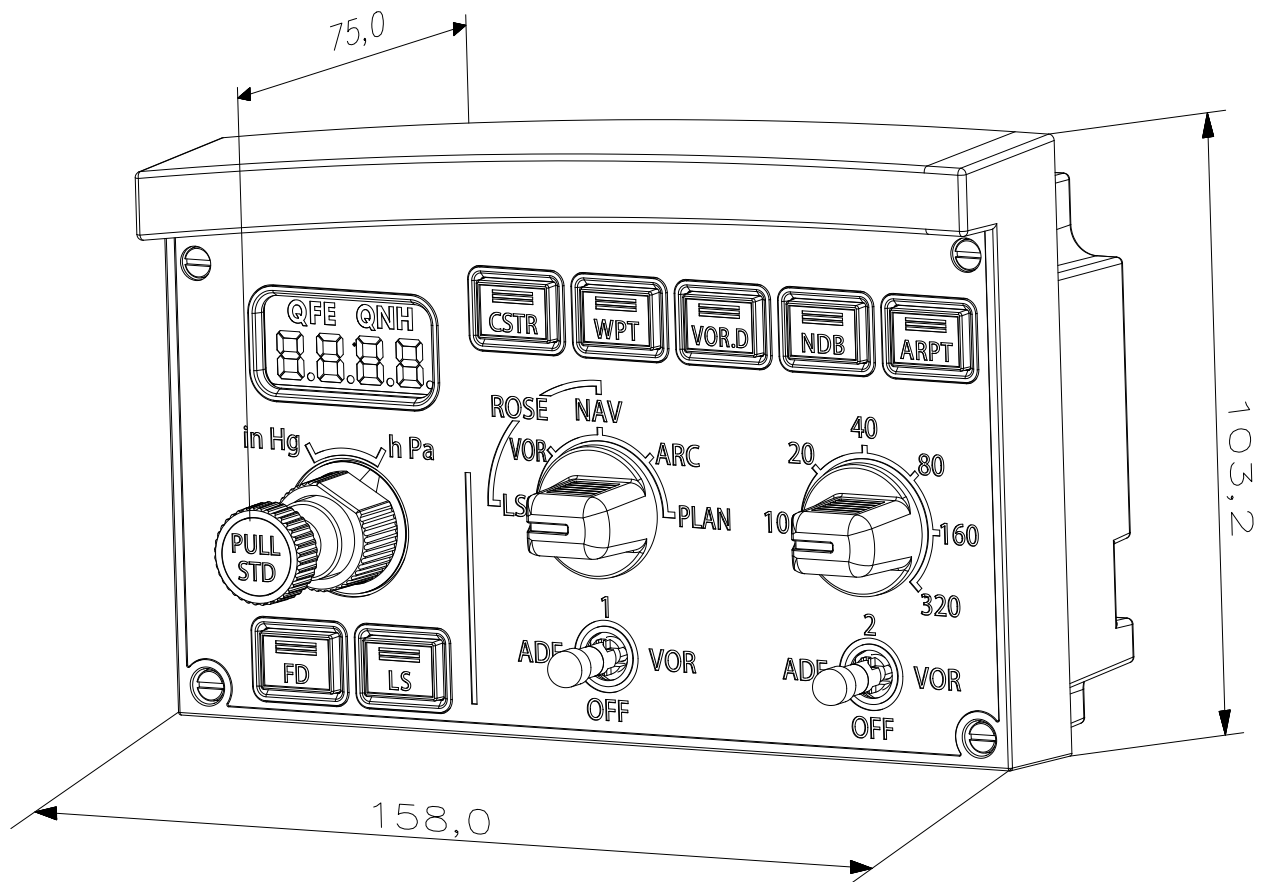

L*W*H: 158mm*103.2mm*75mm

Weight: 0.36kg≈0.8lb

1.4 Installation Dimentions

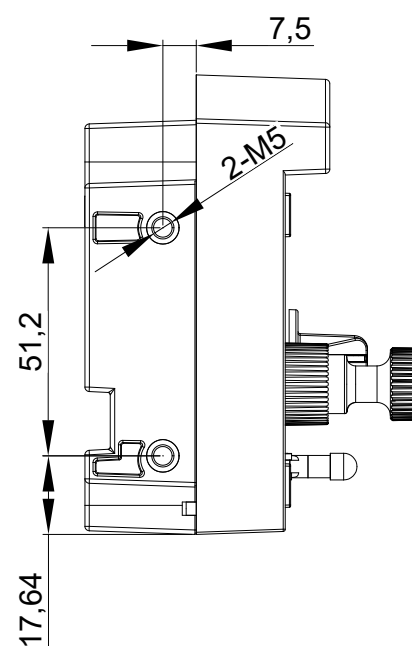
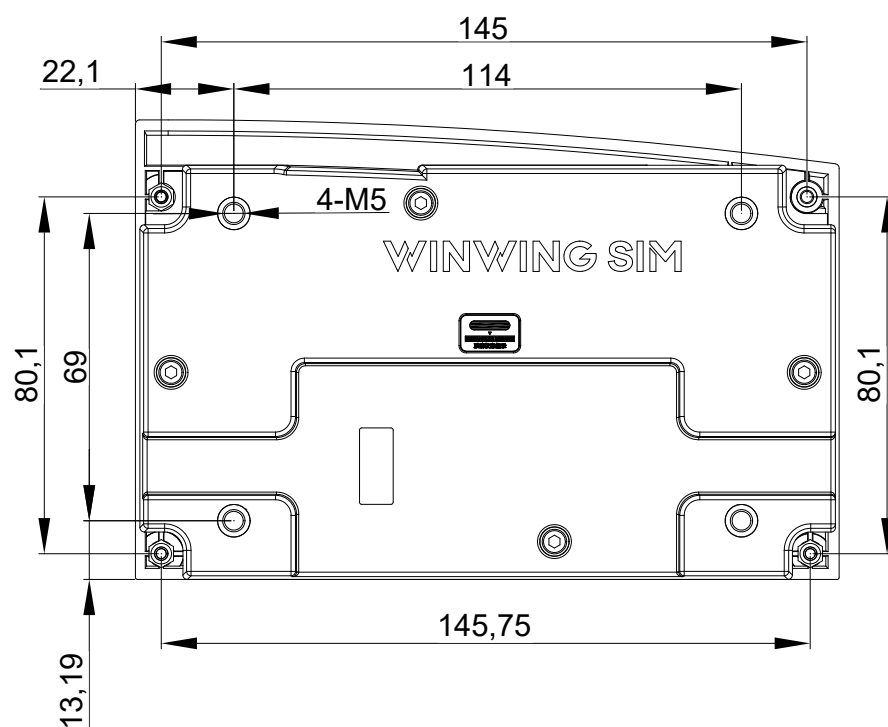

* 2-M5 / 4-M5 Maximum Depth: 5mm

2 Functions

2.1 Mechanical/Special Functions

/

2.2 Key Functionality

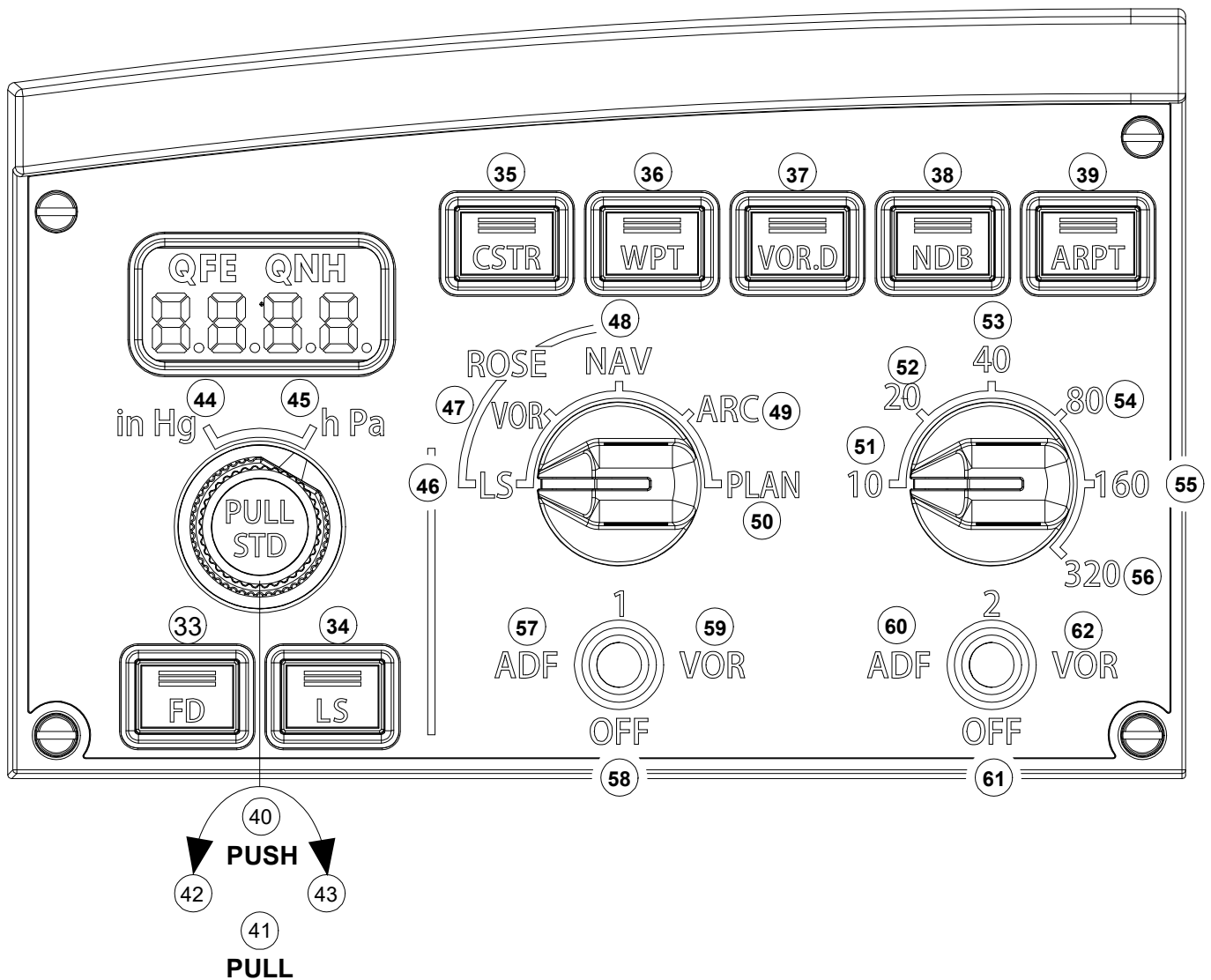

Keys 44, 45, and 42, 43 cannot be rotated simultaneously. When operating keys 44 or 45, rotation signals from keys 42 and 43 are automatically disabled.

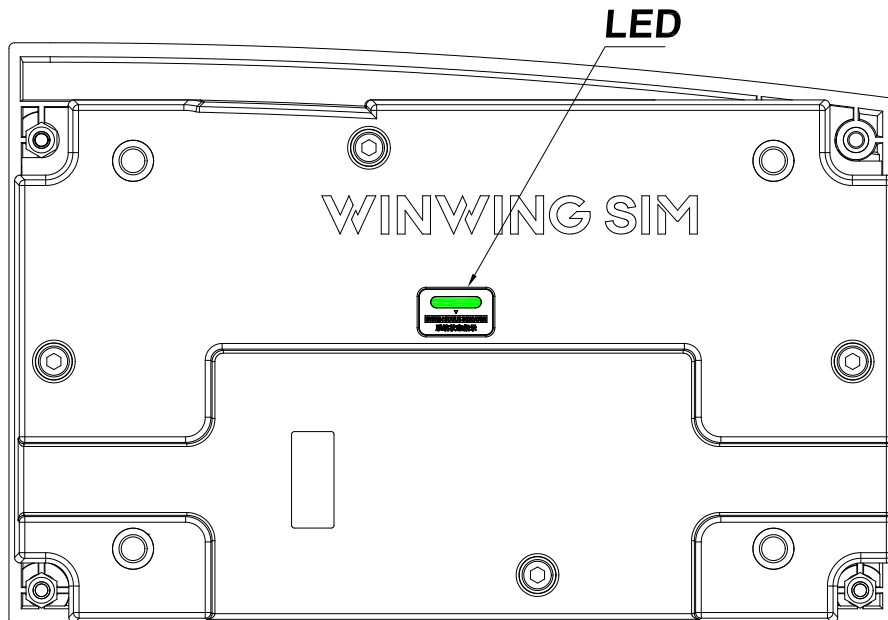

LED Status Indicators:

- Green slow flash (1-second interval): BOOT Mode
- Green slow flash 5 times, then solid: Operating Mode
- Green slow flash 5 times, then off: Power-only Mode

2.3 Adjustment Methods

/

3 Components Assembly and Disassembly

/

4 Installation Methods

*FCU1 and EFIS-32R Sold Separately.

4.1 Mounting with FCU*^{FCU Sold Separately}

- ① Remove the existing screws here.

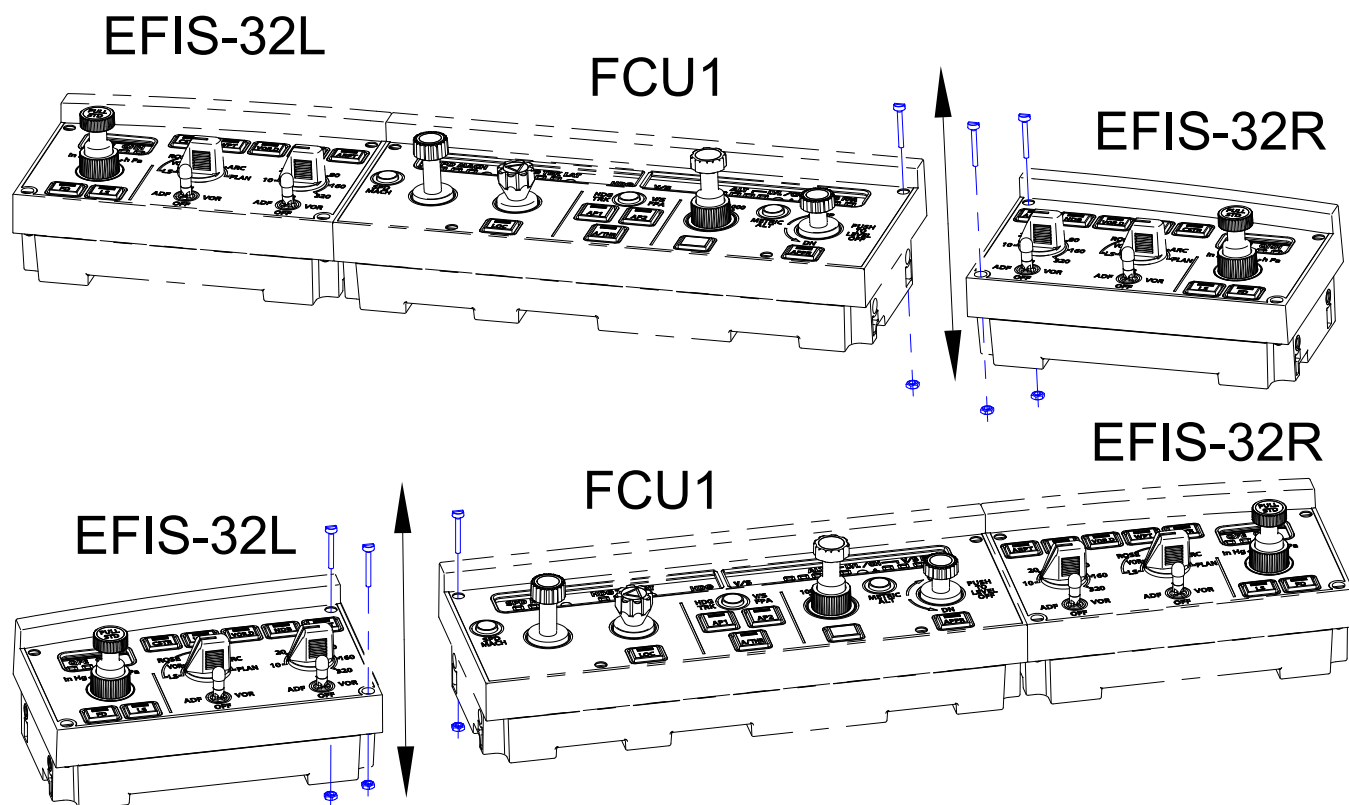

② Install the screws as shown below.

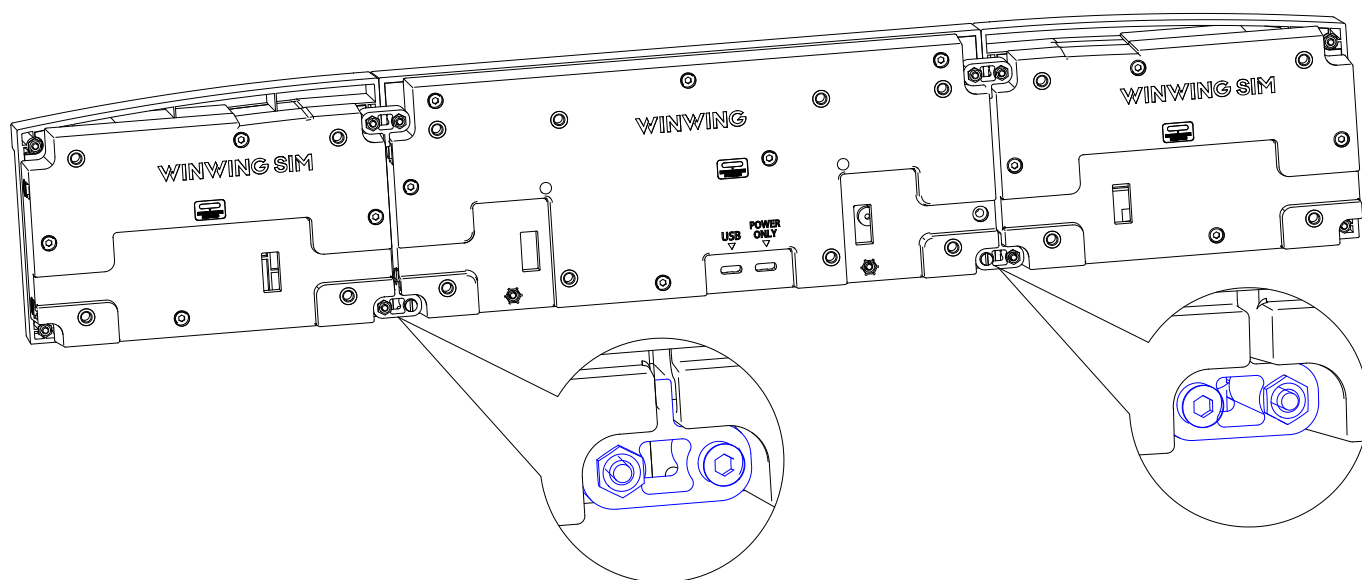
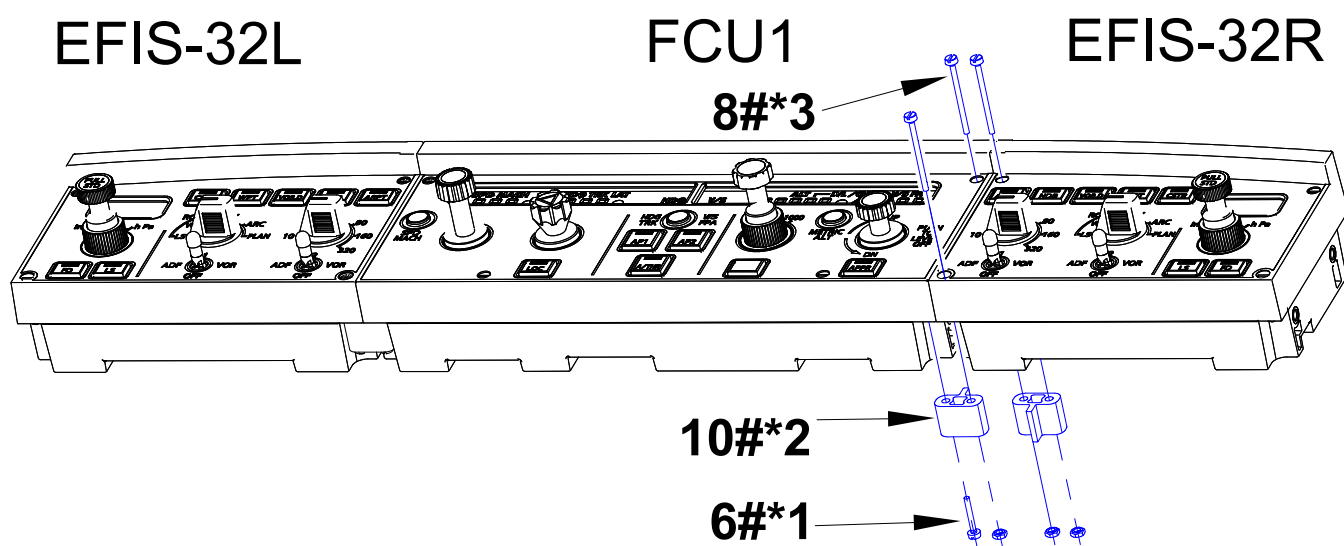
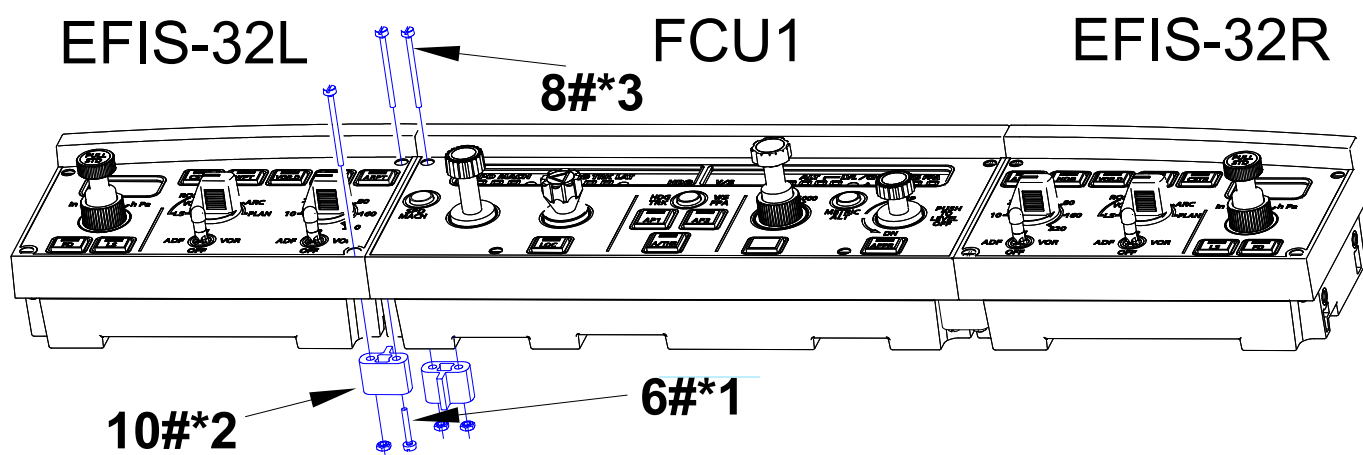

- ③ Install the data cables (4#) as shown below.

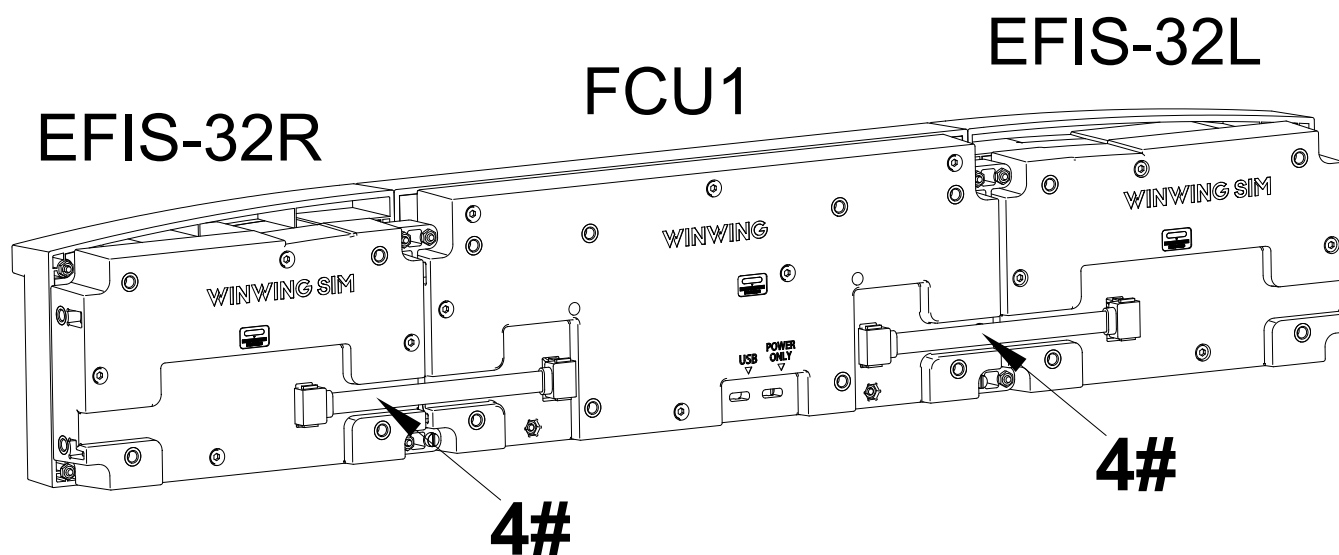

4.2 Bracket Mounting

1. Desktop Mounting Method 1 (Recommended for Desktop Mounting)

Bracket Mounting: Install the bracket at a 71-degree angle relative to the desktop (the same as the real aircraft view).

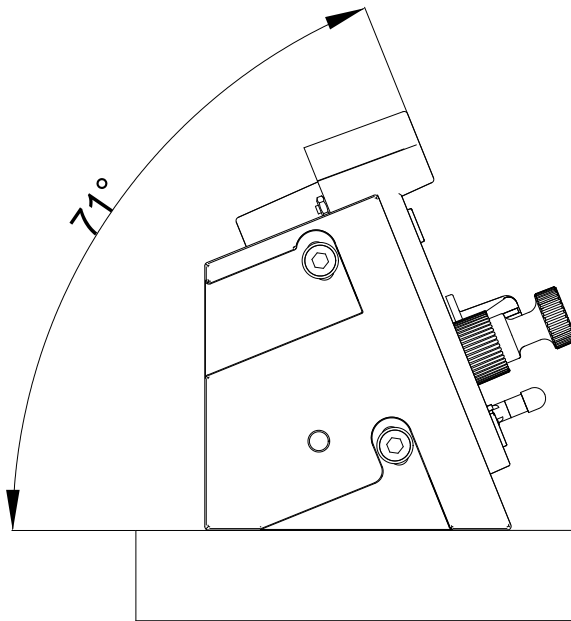

① Install the left bracket.

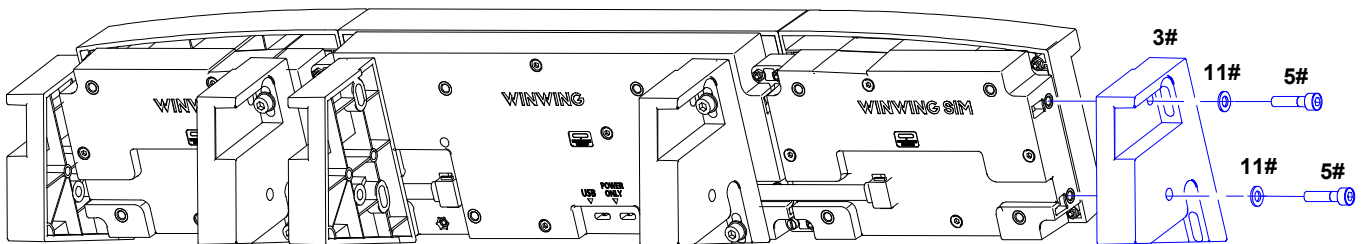

*Screw in the screws, but do not tighten them yet.

② Install the rear bracket.

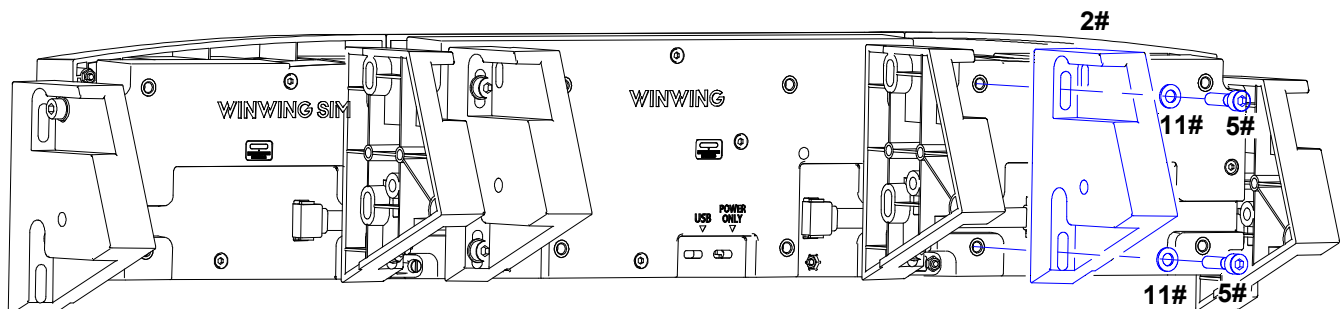

*Screw in the screws, but do not tighten them yet.

2. Desktop Mounting Method 2

Profile Mounting (*Profile rails and related accessories are required and not included.)
The dimension for 4080 profile rail mounting shows below.

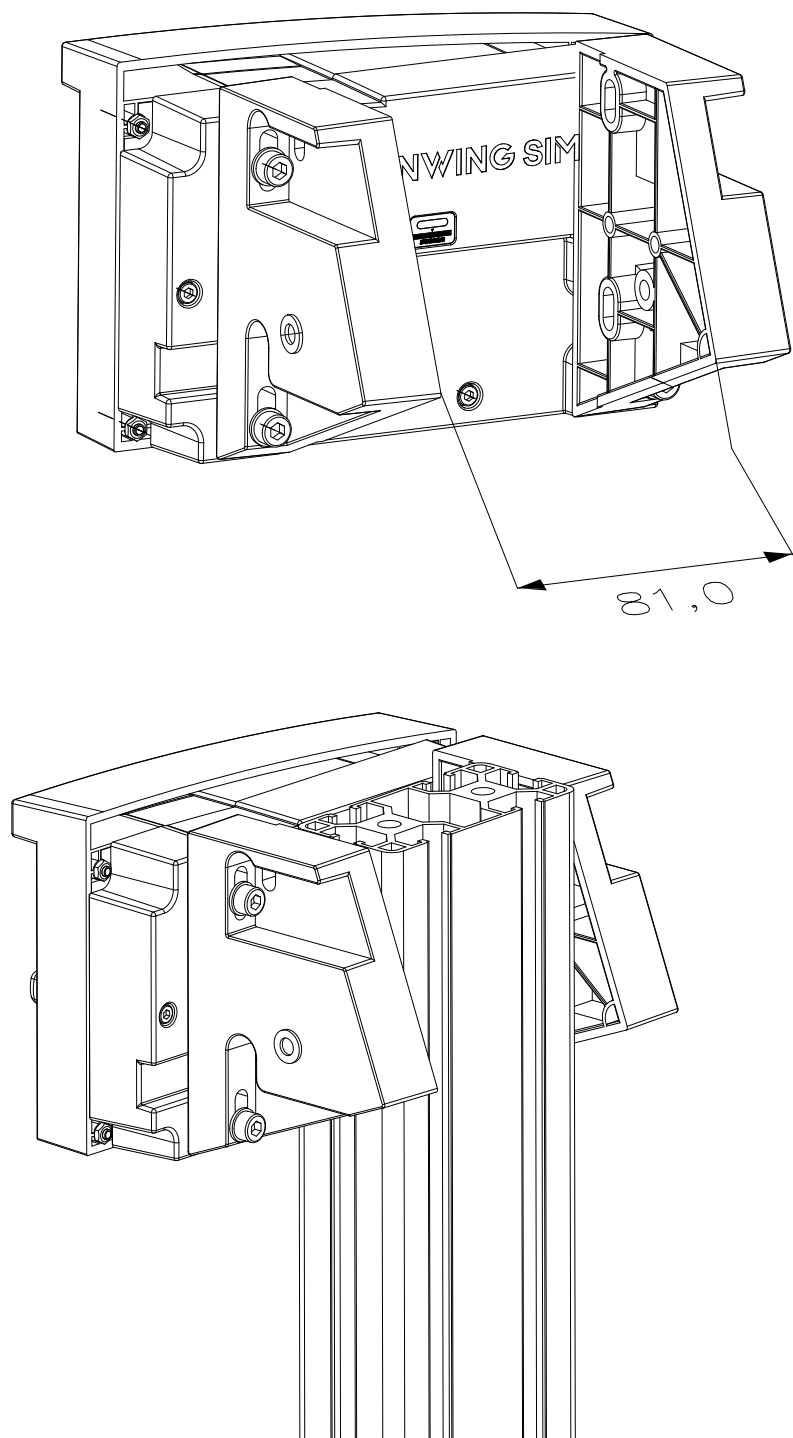

The diagram above shows the mounting method for the 4080 profile (profile rails and accessories need to be self-prepared).

- ① Install the units as shown in section 4.1, and connect the data cables.

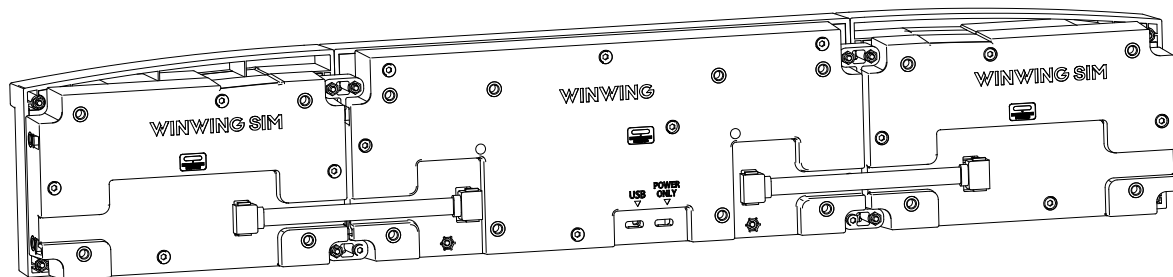

Install the screws as shown.

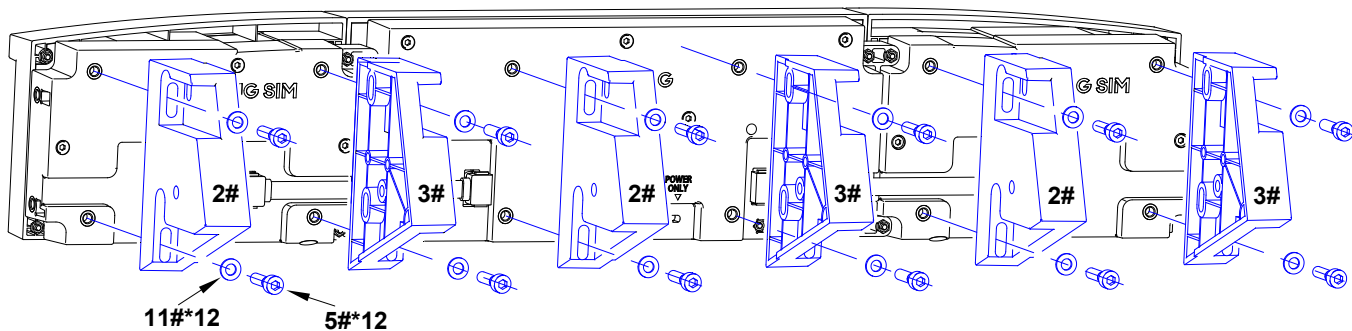

*Screw in the screws, but do not tighten them yet.

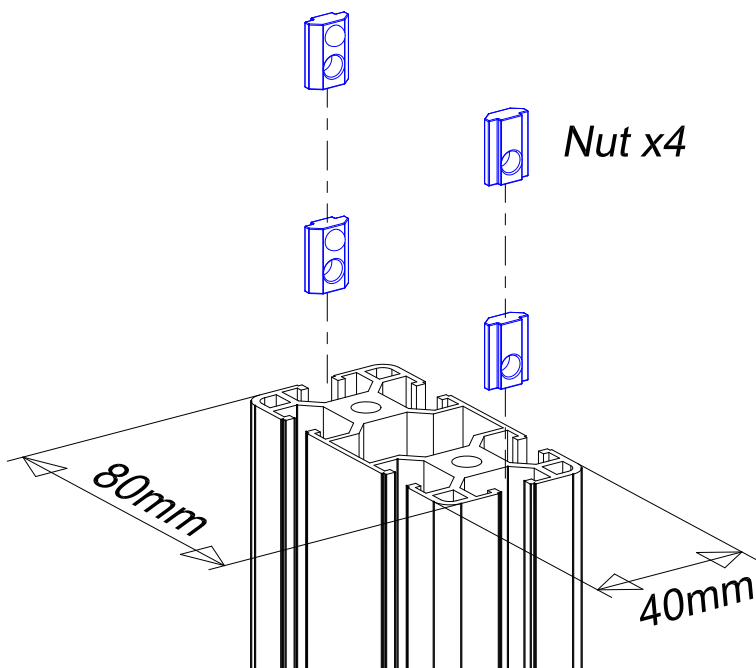

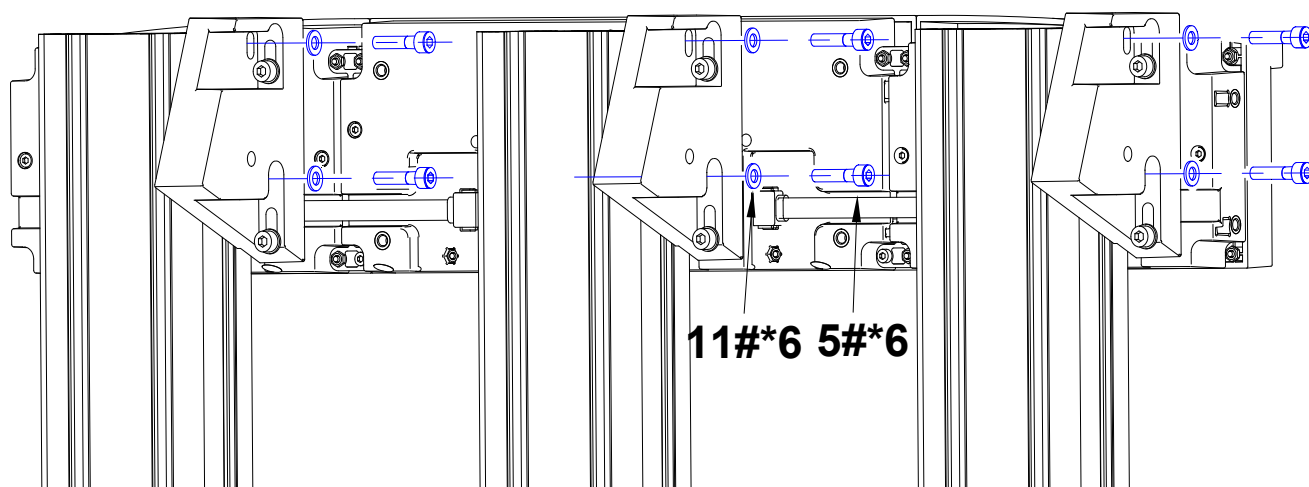
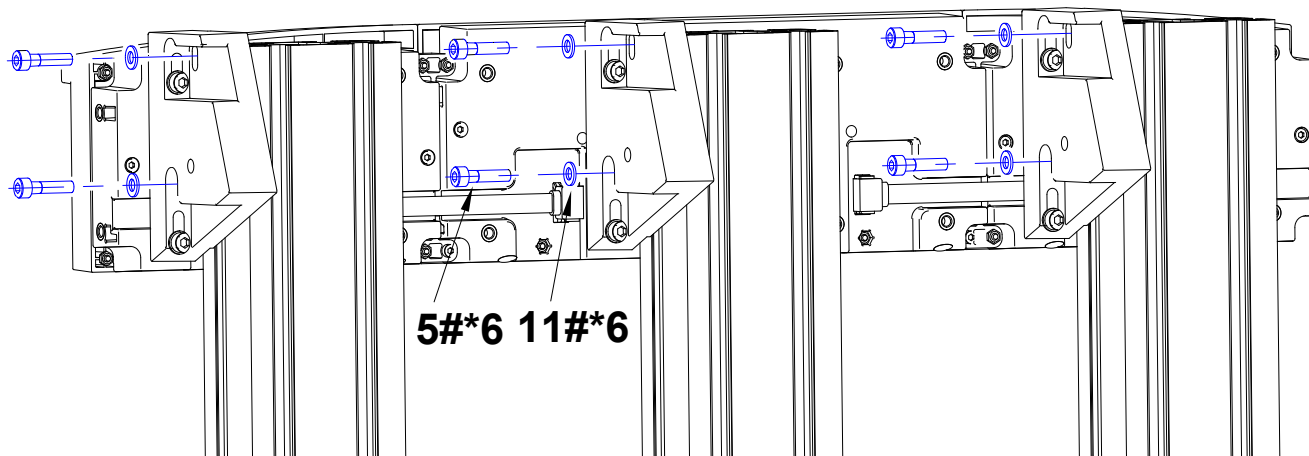

Above diagrams provide an overview of the 4080 profile mounting (profile rails and accessories need to be self-prepared).

4.3 Panel Mount 1 (MP1) Mounting ^{*MP1 Sold Separately}

MP1 Package List

Note: MP1 is sold separately. For dimentions, please refer to MP1 User Manual.

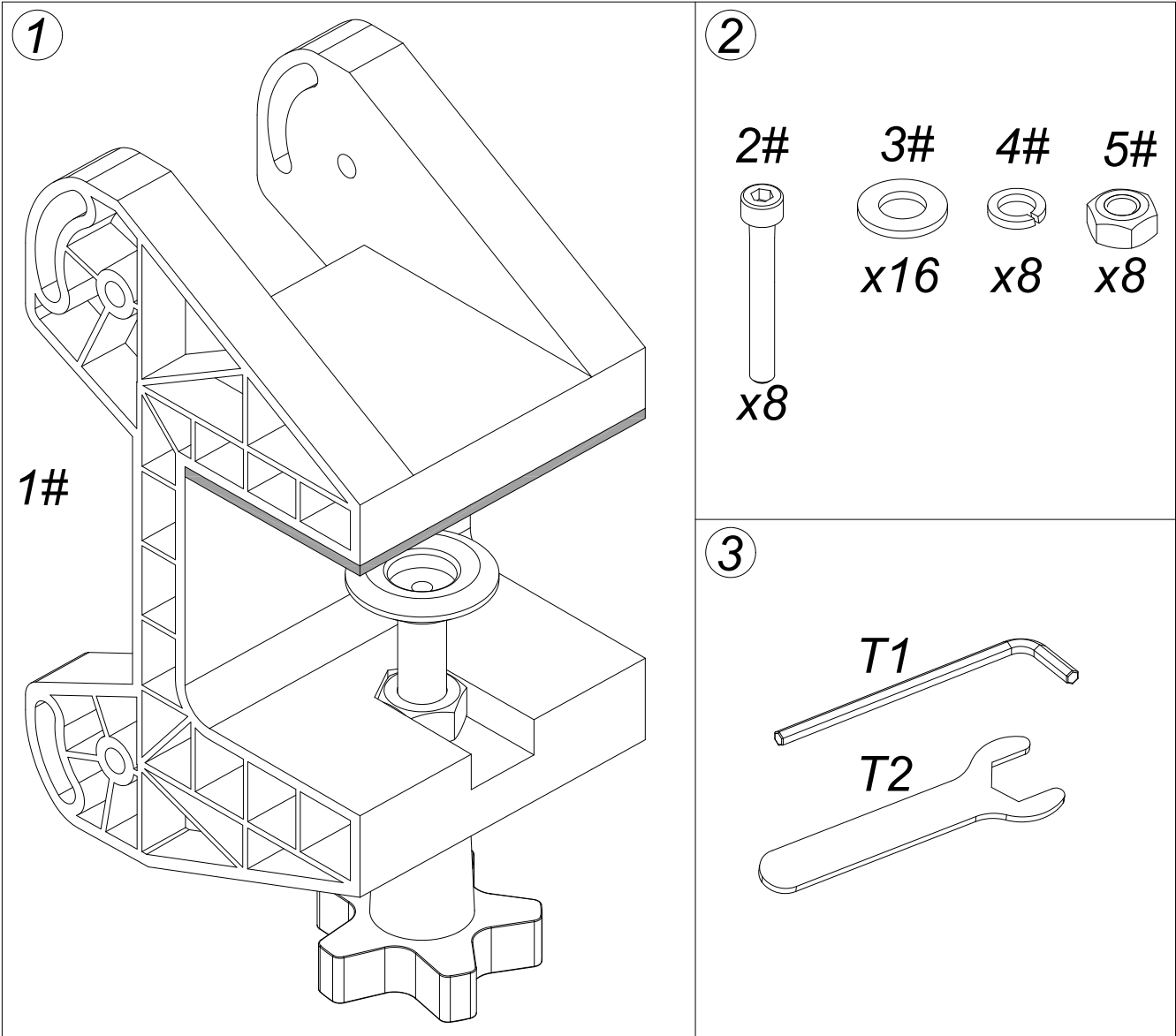

In this section, the materials shown in the figure will be described respectively as “MP1+NUMBER” (such as MP1 1#, MP1 2#, MP1 3#).

Mounting Method:

Install the screws as shown.

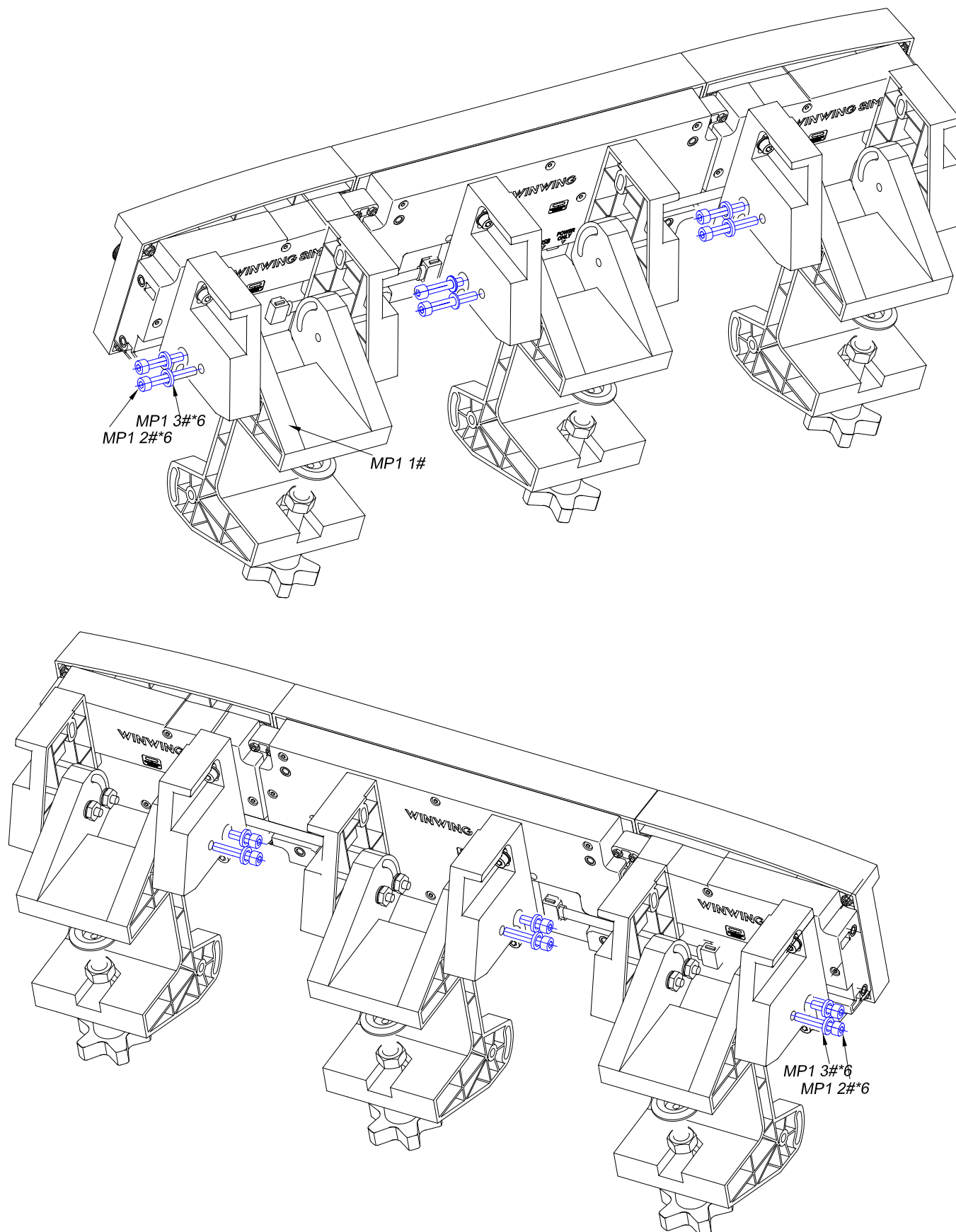

*Screw in the screws, but do not tighten them yet.

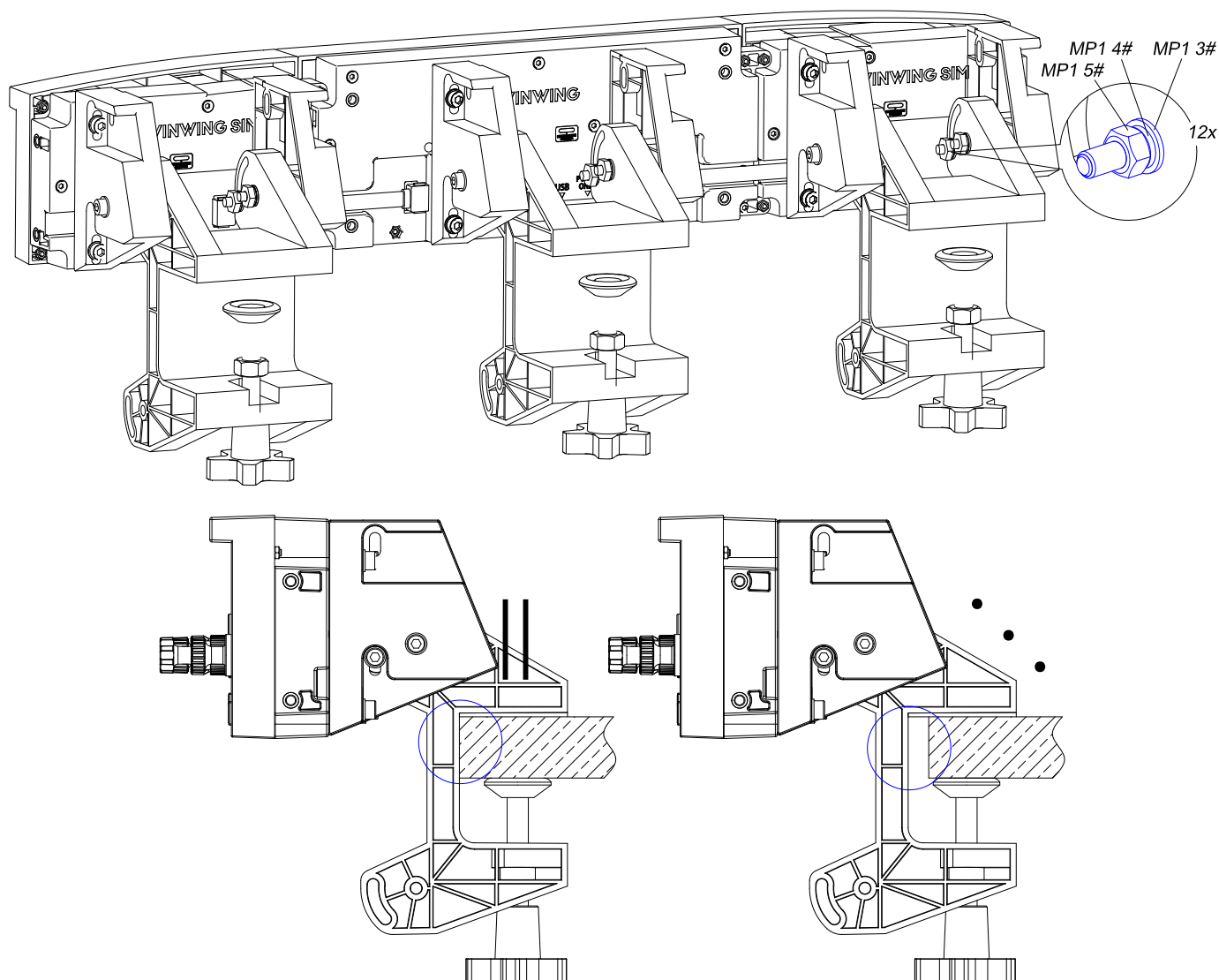

*Clean dust from the bracket surface before mounting.

Adjust the bracket position vertically and horizontally to ensure it is stable on the desktop before tightening the screws.

Tighten screws until there is no wobble; overtightening may cause damage.

4.4 Game Seat Mounting

/

4.5 Cockpit Mounting

*Cockpit frame and mounting screws need to be self-prepared.

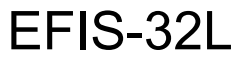

FCU1

EFIS-32R

X. ± 0.5

$.X \pm 0.2$

Cockpit Frame Drilling Diagram

1. Remove the screws here and keep the nuts.

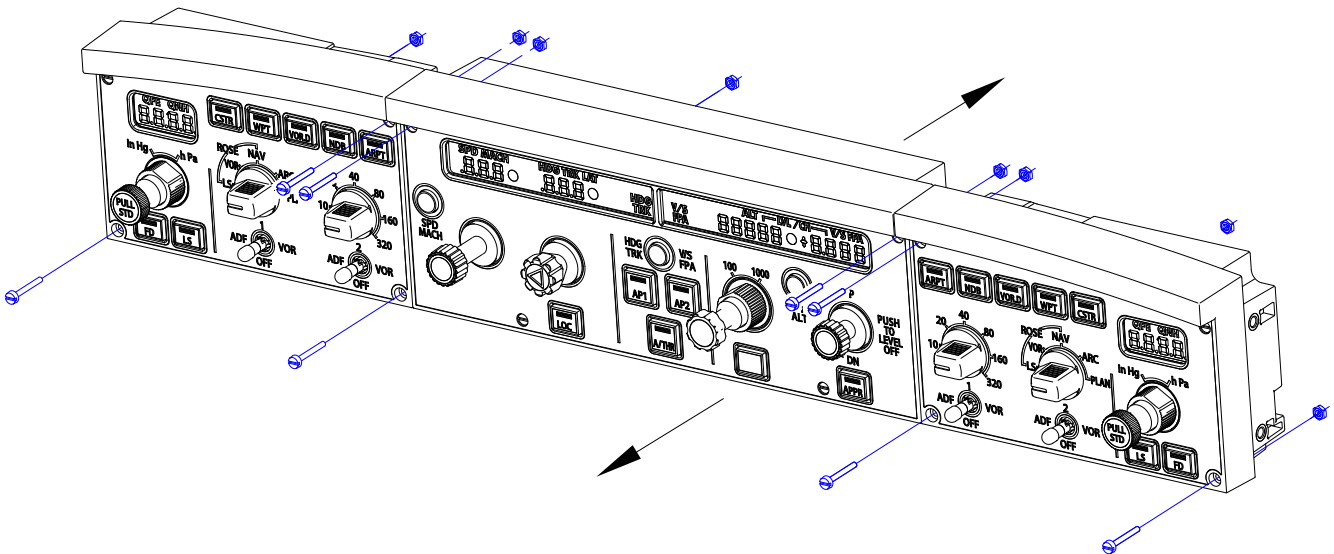

2. Install EFIS-32L on the cockpit frame; screw specifications are listed below:

1	Screw Specification: M3, Length = (22-25) + Cockpit frame thickness.
2	Hexagon Socket Screw M3, length = (5-8) + Cockpit frame thickness
3	Hexagon Nut M3

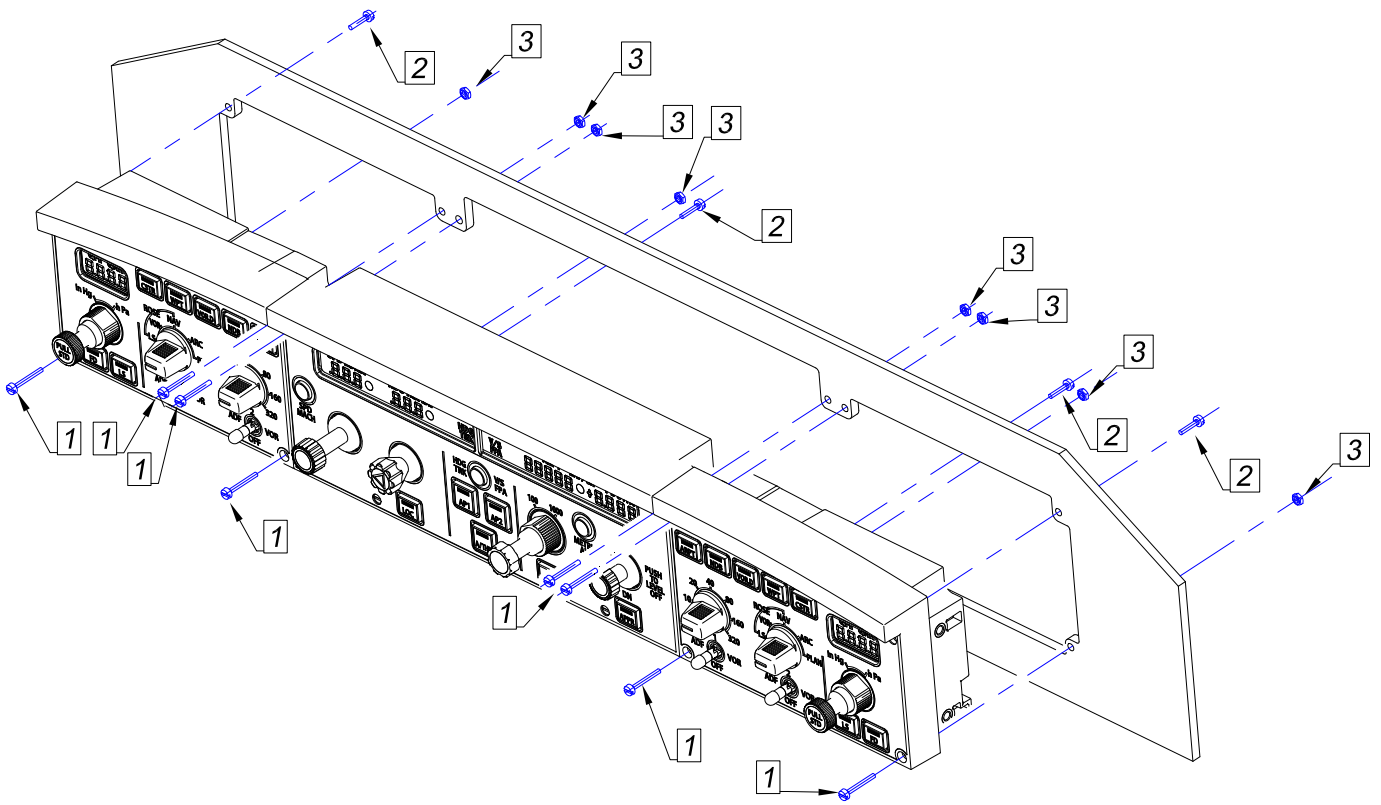

4.6 Cascading

/

Contents are subject to updating without notice. Please download online.

Chengdu Winwing Technology Co., Ltd.

WWW.WINWING.CN

INFO@WINWING.CN

High-Tech International Enterprise Zone No.19 Building, Changshengqiao Road 1111#, Pidu
District, Chengdu, Sichuan, China 610000