

WINWING SIM

Joystick Desk Mount2 with Profile Bar 1

Model MJ.N.N.2.1

User Manual

V1.0 2025.04.25

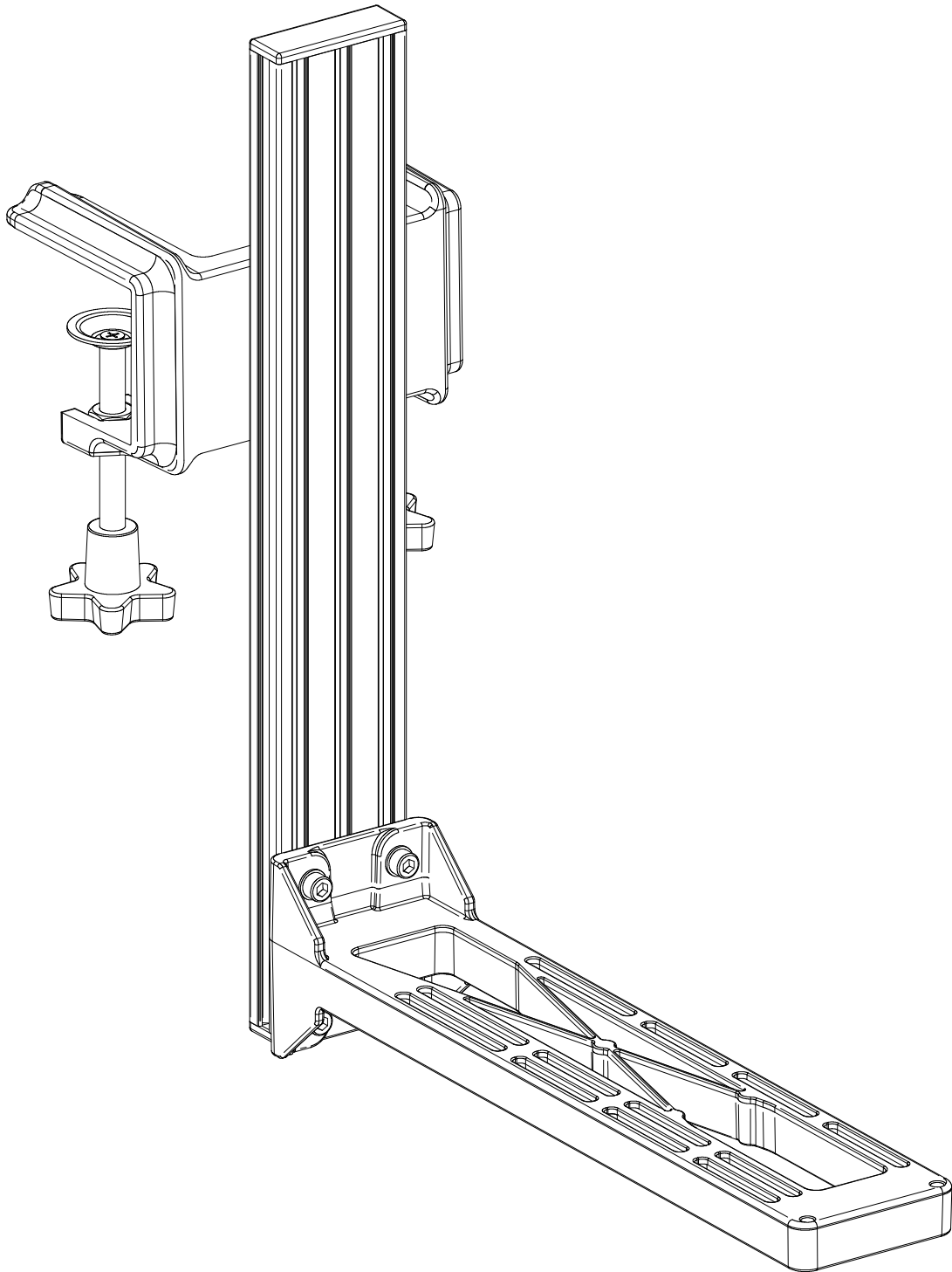

Packing list

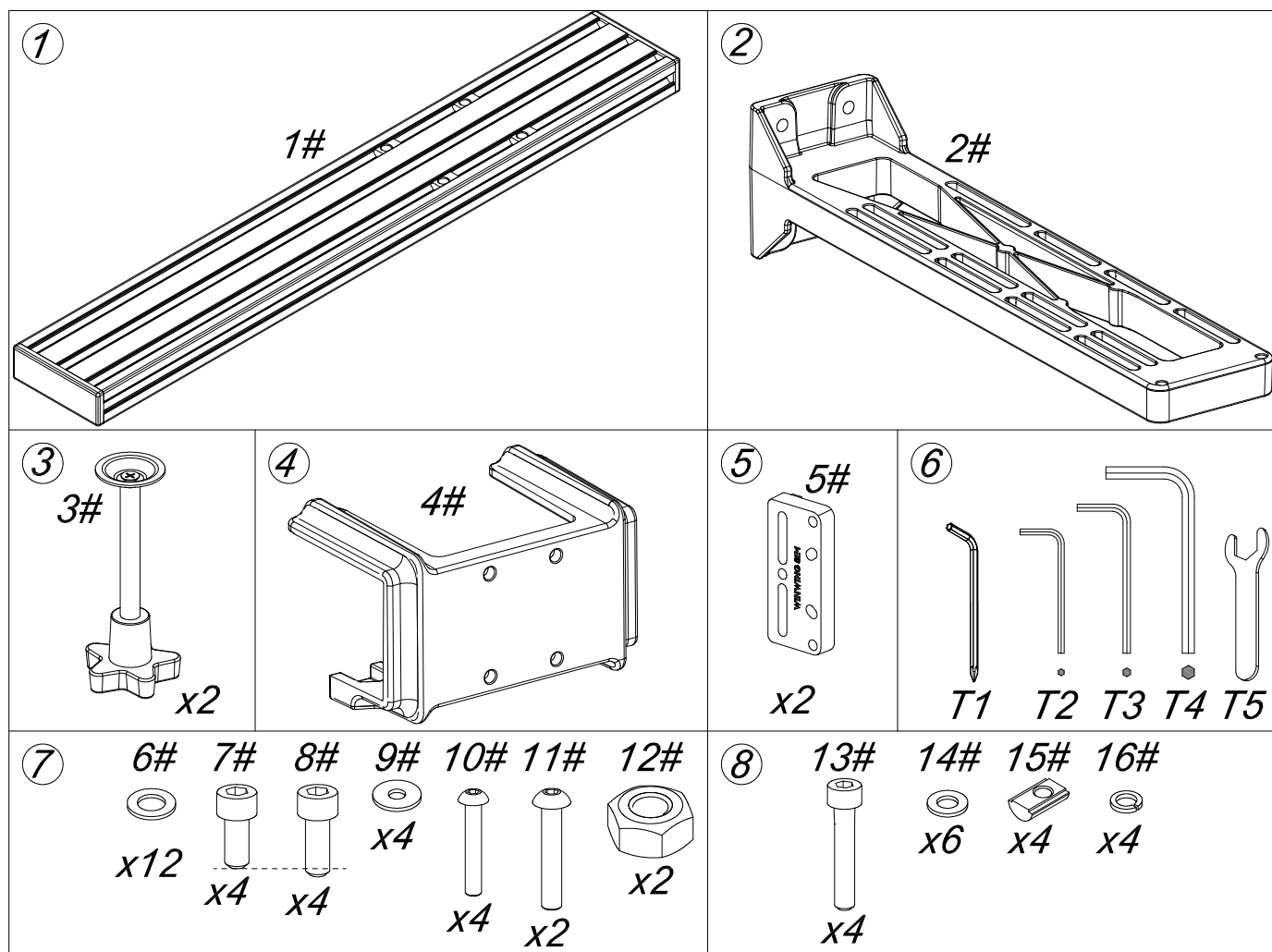

①. Profile assembly (1#).....	1
②. MJX bracket (2#).....	1
③. Handle bolt (3#).....	2
④. Clamping bracket 2 (4#).....	1
⑤. Bracket pad 1 (5#).....	2
⑥. Toolkit (T1~T5).....	1
⑦. Accessory Pack 1 (6#~12#).....	1
6#: Flat pad M6*12*1;	
7#: Hexagon Socket cylindrical head screw M6*12;	
8#: Hexagon socket head screw M6*14;	
9#: Flat pad M4*12*1;	
10#: Hexagon socket head screw M4*25;	
11#: Hexagon socket head screw M5*28;	
12#: Hexagon nut M10;	
⑧. Accessory Pack 2 (13#~16#).....	1
13#: Hexagon socket cylindrical head screw M5*28;	
14#: Flat pad M5*10*1;	
15#: Elastic nut 20 Euro standard M5;	
16#: Spring Pad M5	

Catalog

1. Product Introduction	3
1.1 Component Introduction	3
1.2 Performance Parameters	4
1.3 Shape dimensions	6
1.4 Installation dimensions	7
1.5 Fit model	10
2 First-time use	12
2.1 Software Installation	12
2.2 Component installation	12
2.3 Product Usage	13
3 Functions	13
3.1 Mechanical and special functions	13
3.2 Key Positions	13
3.3 Data interface	13
3.4 Adjustment methods	13
4 Installation Methods	14
4.1 Bracket assembly	14
4.2 Up and down adjustment	17
4.3 Install the Orion 2 flight joystick	19
4.4 Installation of Ursa Minor Joystick	22
4.5 Installation of the FCU Unit1	23
4.6 Installation of NavyAce-UFC unit 1	28
4.7 Installation for NavyAce-UFC unit 1+Navy Ace-HUD unit 1	32
4.8 Install Multifunctional MFD1 Unit	37
4.9 Installation of NavyAce-UFC Unit1+NavyAce-HUD Unit1+Multifunctional MFD1 Unit	41
5 Maintenance	46
5.1 Firmware upgrade	46
5.2 Cleaning and maintenance	46
5.3 Frequently asked questions and after-sales service	47
6 Safety precautions	47

1. Product Introduction

1.1 Component Introduction

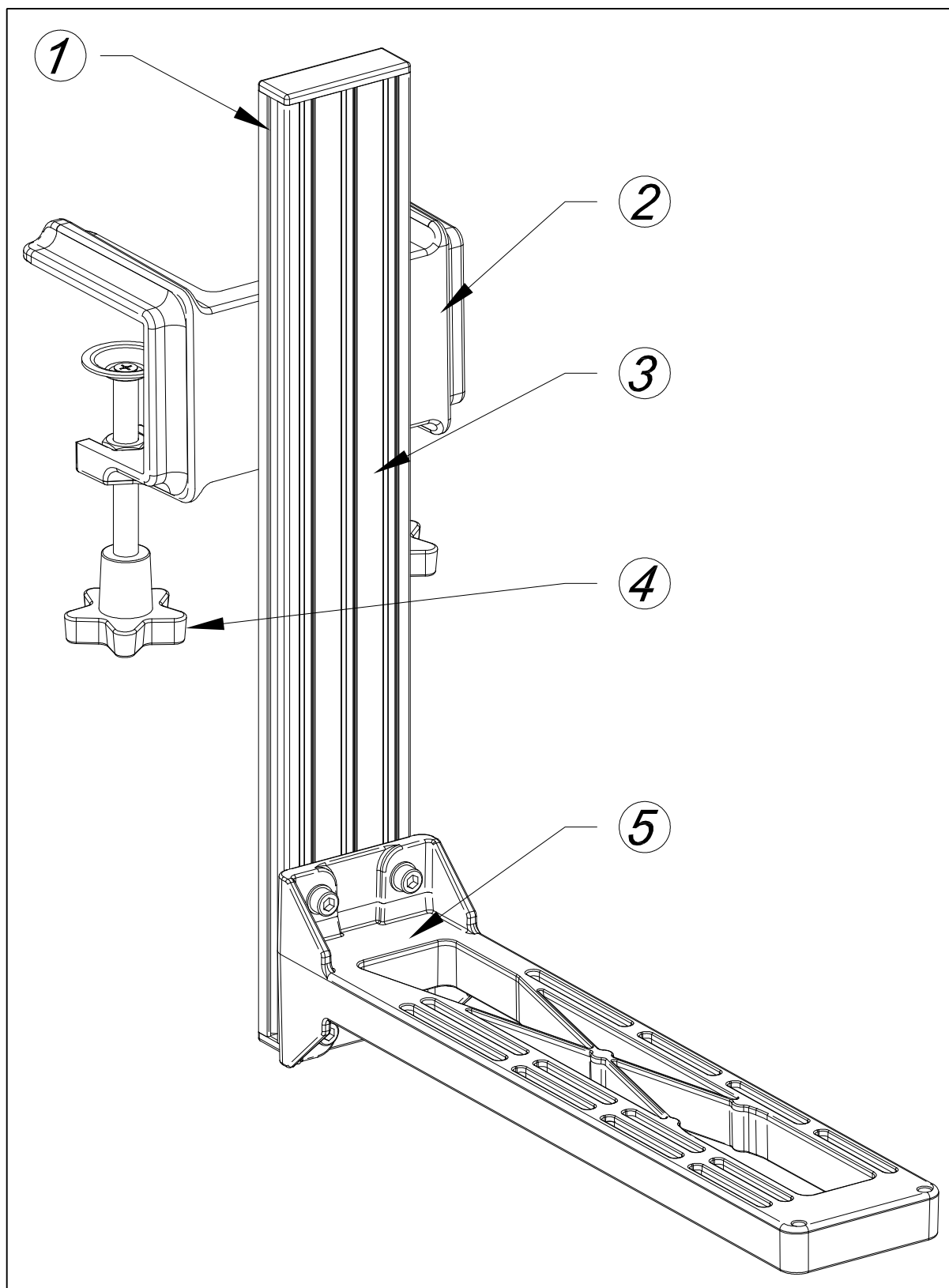

- ① Bracket pad mounting slot ② Clamping bracket ③ Profile assembly ④ Handle bolt ⑤

MJX bracket

1.2 Performance Parameters

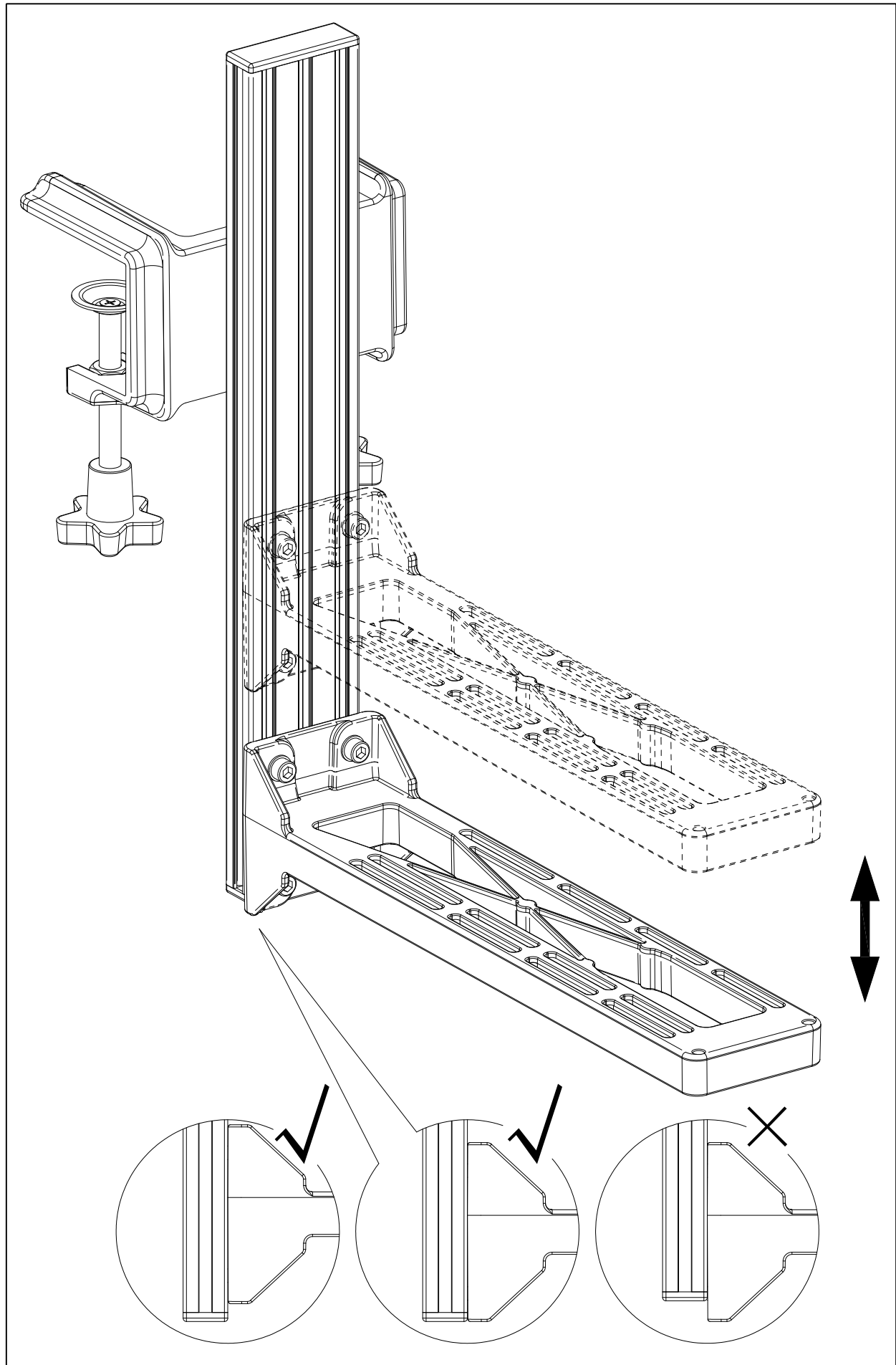

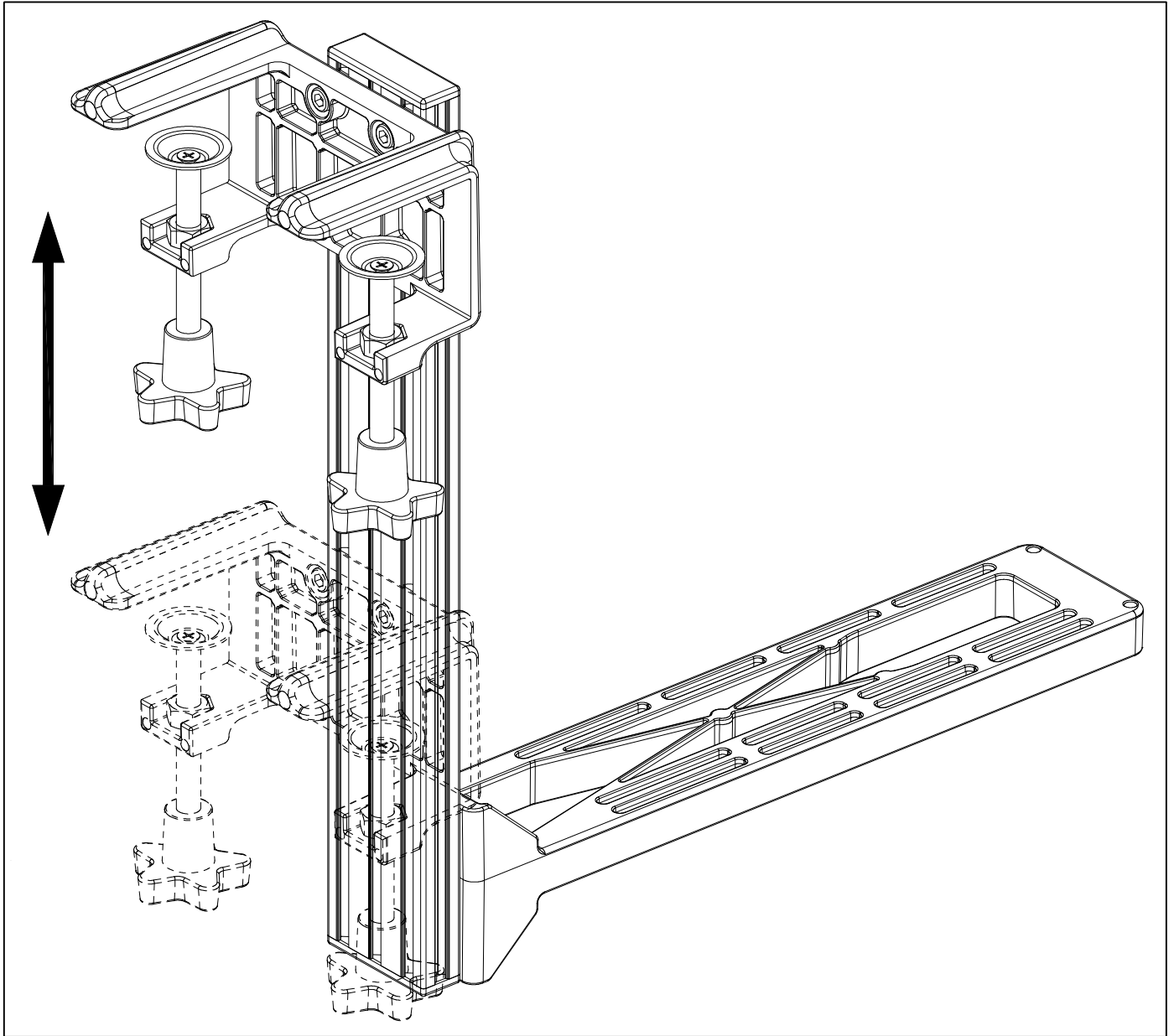

- Both the MJX bracket and the clamping bracket 2 can be adjusted up and down within the profile's chute, with an adjustable travel of $\geq 200\text{mm}$. Excessively high or low positions may impact usability. Please adjust according to actual needs.

1.3 Shape dimensions

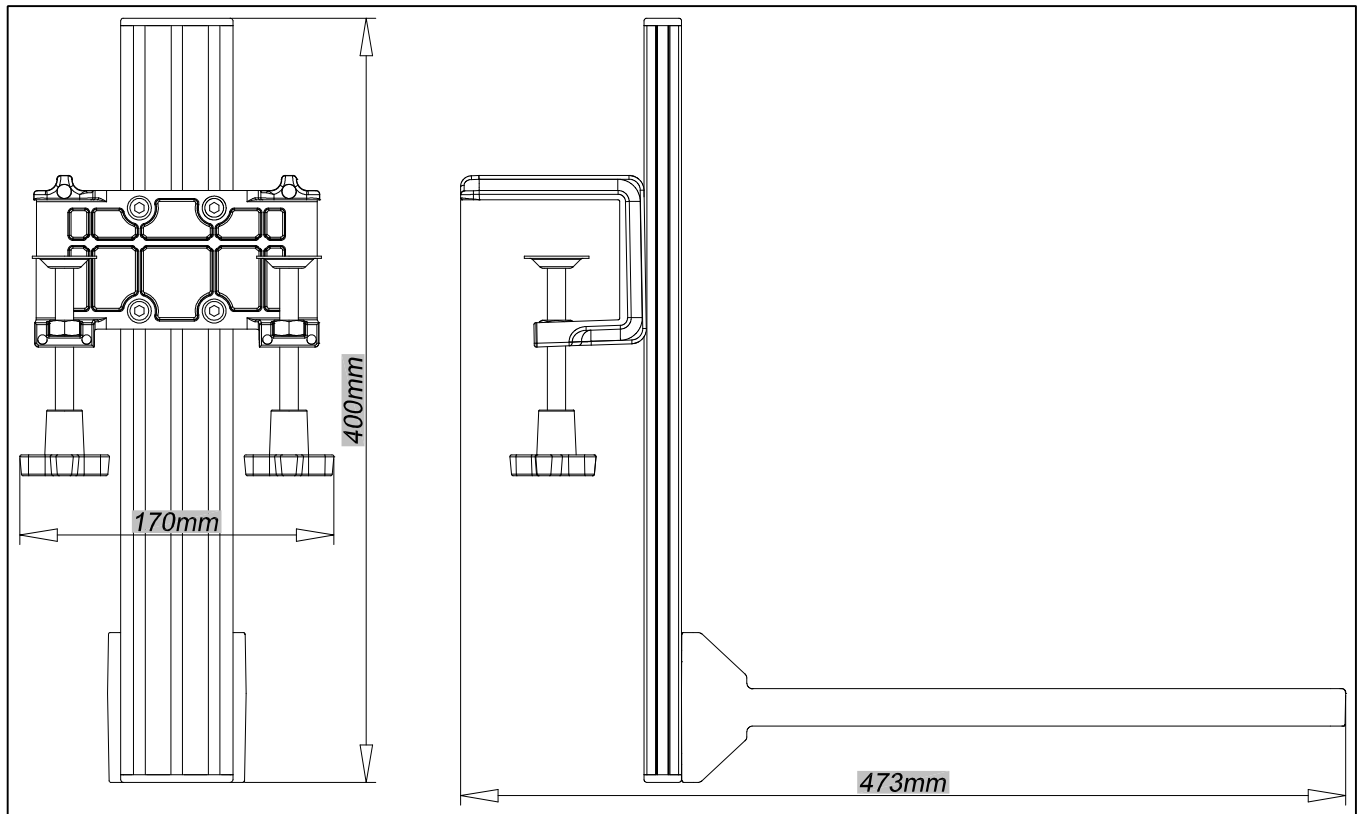

- The product dimension is 473mm*170mm*400mm after installation; The weight is 1.7Kg=3.75lb (The data in this manual and the dimensions marked on the drawing are design values. Due to the inevitable errors in the manufacturing and assembly process, the actual values cannot be exactly the same as the design values. Please refer to the actual product.)
- Bracket pad size (Hole diameter fits M5 screw. Unless otherwise specified, size measurement in this manual are all in millimeter.)

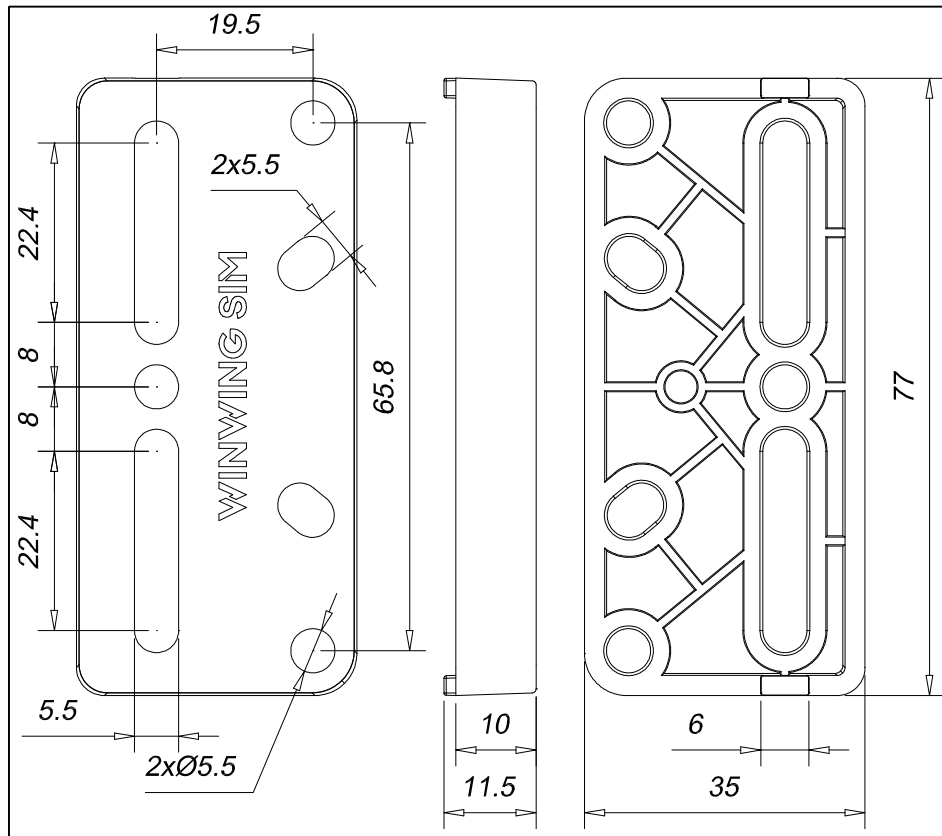

1.4 Installation dimensions

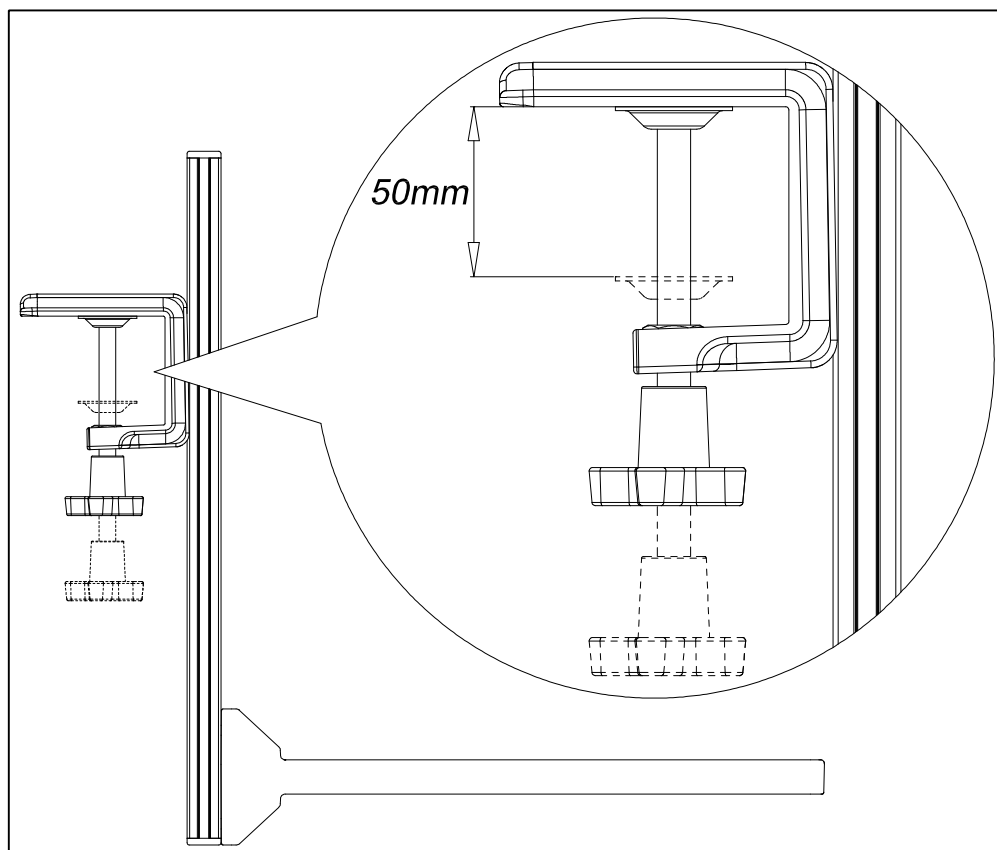

The thickness of the desktop should be $\leq 50\text{mm}$, and the desktop compressive strength should be $\geq 1.8\text{ MPa}$. (1. Depending on the material, clamping may cause indentations, scratches, or deformation. Perform a trial fit first, gradually increasing clamping force to

assess acceptable limits. 2. Desktops must resist flexing, as deformation may lead to increased mount instability.)

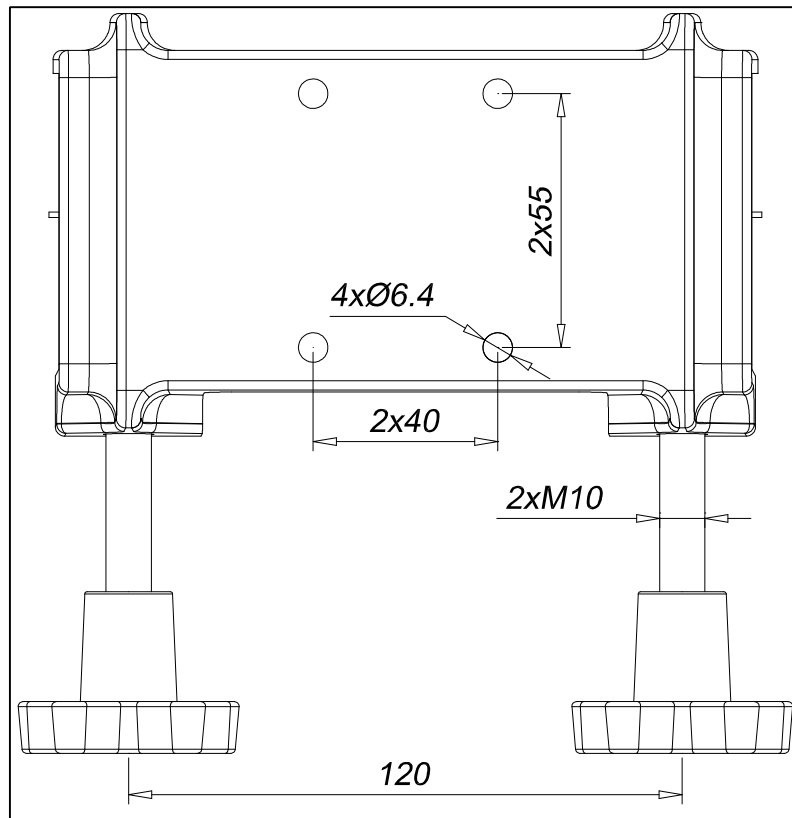

Hole diameter fits M6 screws

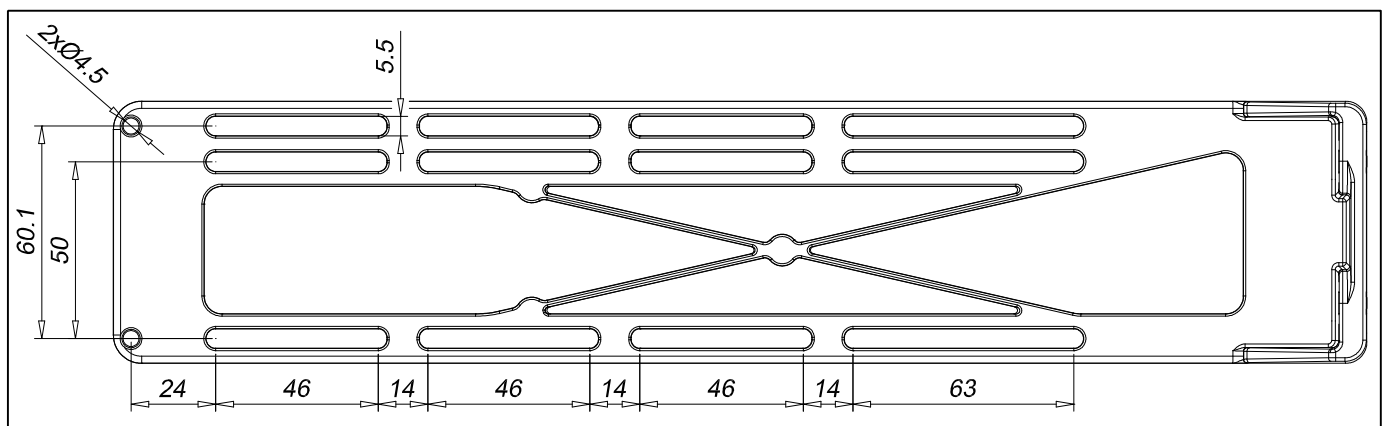

2xØ4.5 holes fit M4 screws, and the rest of the holes fit M4, M5 screws.

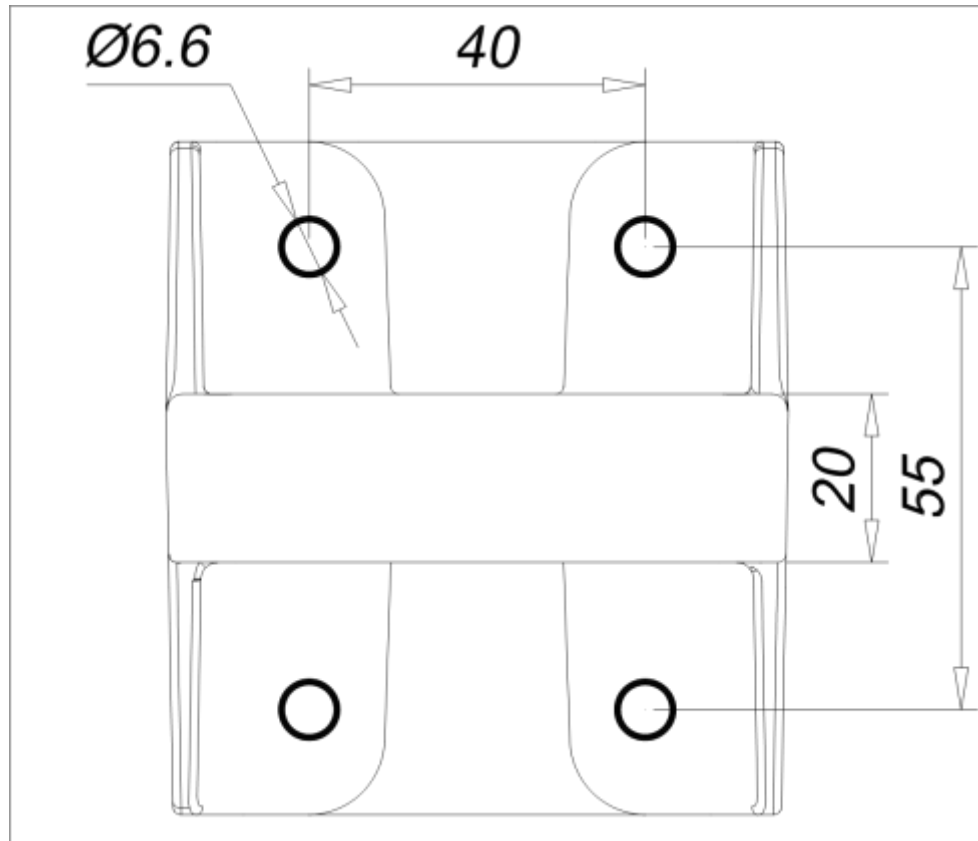

Bracket thickness is 20mm, hole diameter fits M6 screw.

1.5 Fit model

- Suitable for mounting one of the following joysticks: Orion Joystick Combo, Orion 2 Joystick Combo, Ursa Minor joysticks.
- Orion and Orion 2 joysticks are should be mounted without extension rods and support mounting with the Z-axis; (The installation of the extension rod will cause operational inconvenience).
- Applicable for installing one FCU Unit1 (EFIS installation is not supported), FCU installs vertically with no angle adjustment..
- Support replacement of European standard 4080 profiles (replacement profiles and accessories need to be self-prepared).

Recommended specification for self-prepared replacements:

Item	Specifications	Quantity (at least)
Profiles	Euro standard 4080	1
Profile Nut	Type 40-M6	8
Hex socket cylindrical head screw	M6*18	4
Hex socket cylindrical head screws	M6*20	4

- Other Compatibility and Self-Prepared Accessories List

No.	Compatibility	Self-Prepared Accessories	
		Item and Specification	Amount
A	For Orion Joystick Base, or Orion 2 Joystick Base (Z-axis supported) Installation Only		
B	For Extension Rod +A Installation	EU Standard 2060 Profile, length: 550mm	1
C	For FCU1+B Installation	EU Standard 2060 Profile, length: 600mm	1
D	For UFC1+A Installation	Hex Round Head Bolt M5*50	2
		Hex Round Head Bolt M5*40	2
		Hex Round Head Bolt M5*16	2
		Hex Nut M5	2

E	For UFC1+HUD1+A Installation	Specification and amount are the same as No. D	
F	For MFD1+A Installation	Hex Round Head Bolt M5*50	4
		Hex Round Head Bolt M5*16	2
		Hex Nut M5	2
G	For UFC1+HUD1+MFD1+A Installation	EU Standard 4080 Profile, length: 500mm ^a	1
		Profile Nut Type 40-M6	8
		Profile Nut Type 40-M5	4
		Hex Round Head Bolt M6*18	4
		Hex Round Head Bolt M6*20	4
		Hex Round Head Bolt M5*45	4
H	For UFC1+HUD1+MFD1+B Installation	EU Standard 4080 Profile, length: 700mm ^a	1
		Specification and amount are the same as No. G	

Note: For No. A and No. B, if the installation of both UFC1 and MFD1 is needed, 4080 profile should be self-prepared; the pre-packed profile is 2060 profile equipped with 2 bracket spacers, and only supports one panel installation (including UFC1+HUD1).

2 First-time use

2.1 Software Installation

(Empty)

2.2 Component installation

(Empty)

2.3 Product Usage

- The components of the product are mechanically connected. Scratches and indentations may occur during installation, use, and adjustment, but will not affect the product's functionality.
- The main material of the product is aluminium, which is an reactive metal. During transportation and use, contact with acids, alkalis, oxidants, sweat stains, etc. will cause oxidation on the surface, resulting in discoloration, which will not affect the product's functionality.

3 Functions

3.1 Mechanical and special functions

(Empty)

3.2 Key Positions

(Empty)

3.3 Data interface

(Empty)

3.4 Adjustment methods

- Supports adjustment in four directions: front and back, up and down (for detailed adjustment methods, see Chapter 4 of this manual: Installation Methods).

4 Installation Methods

4.1 Bracket assembly

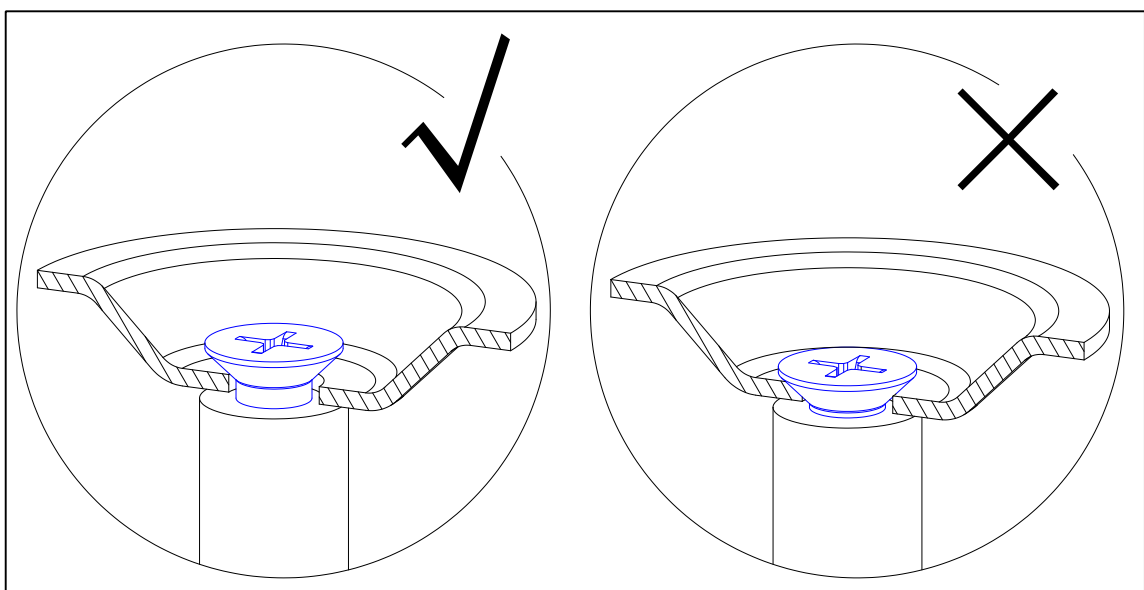
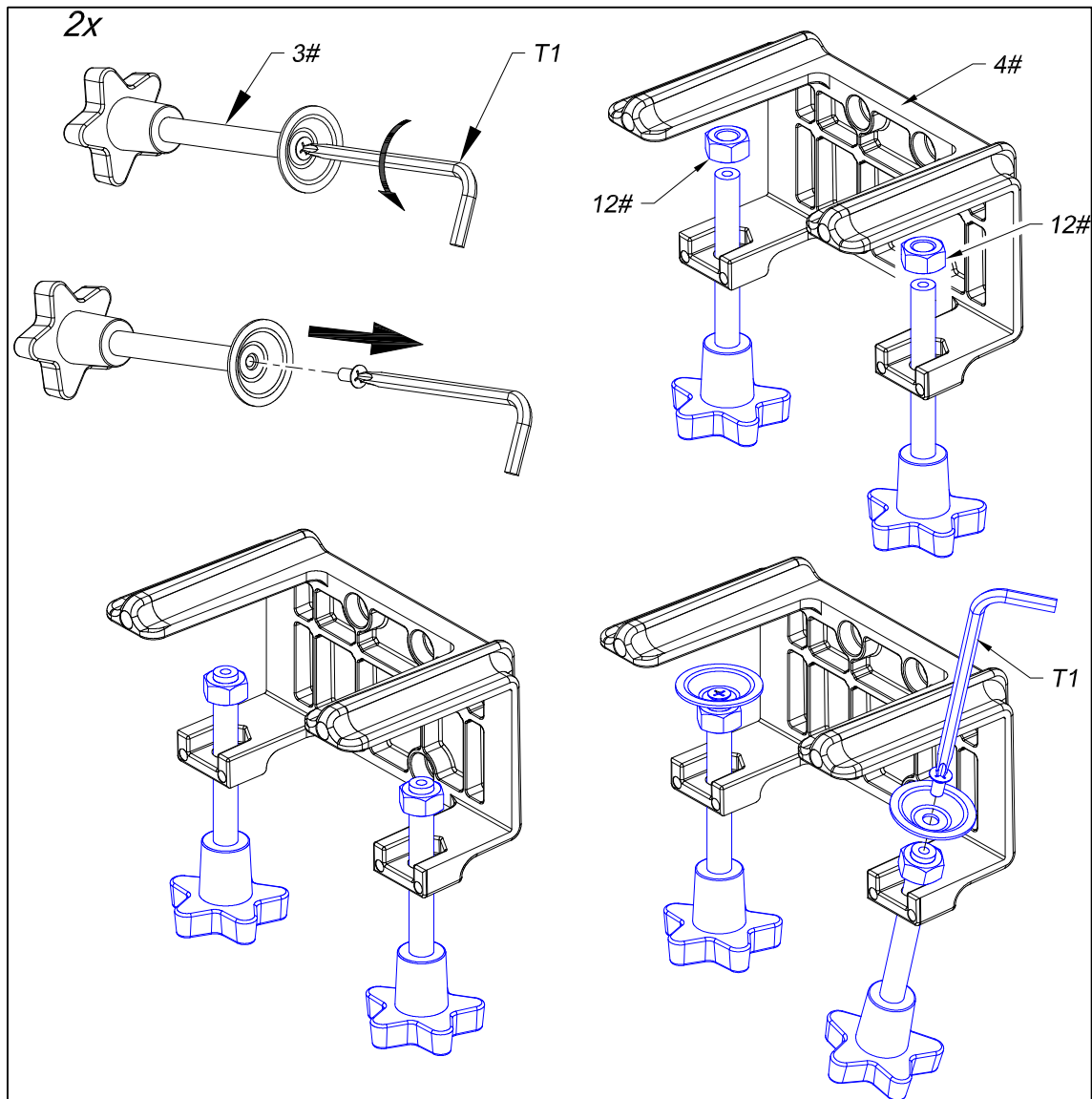

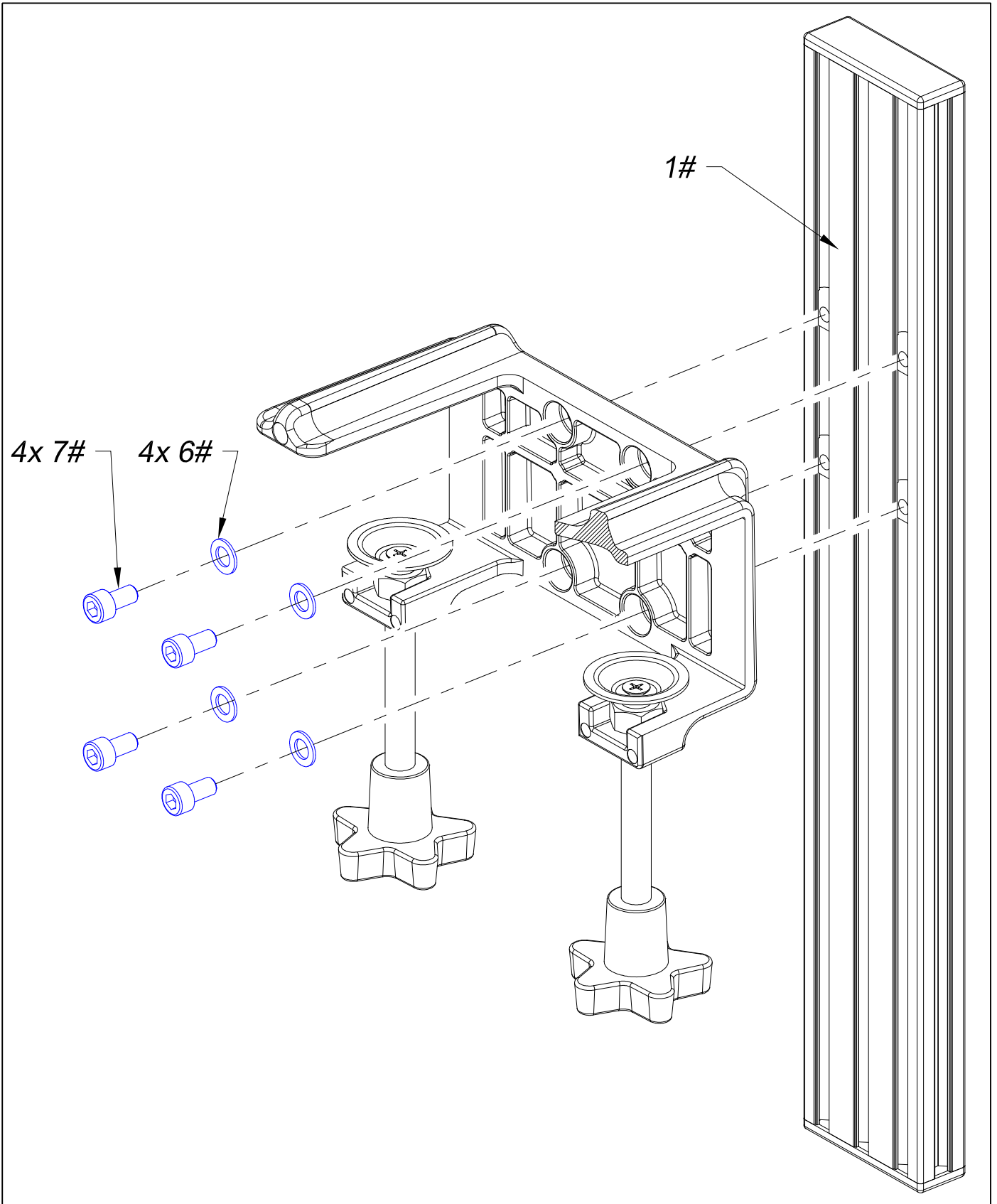

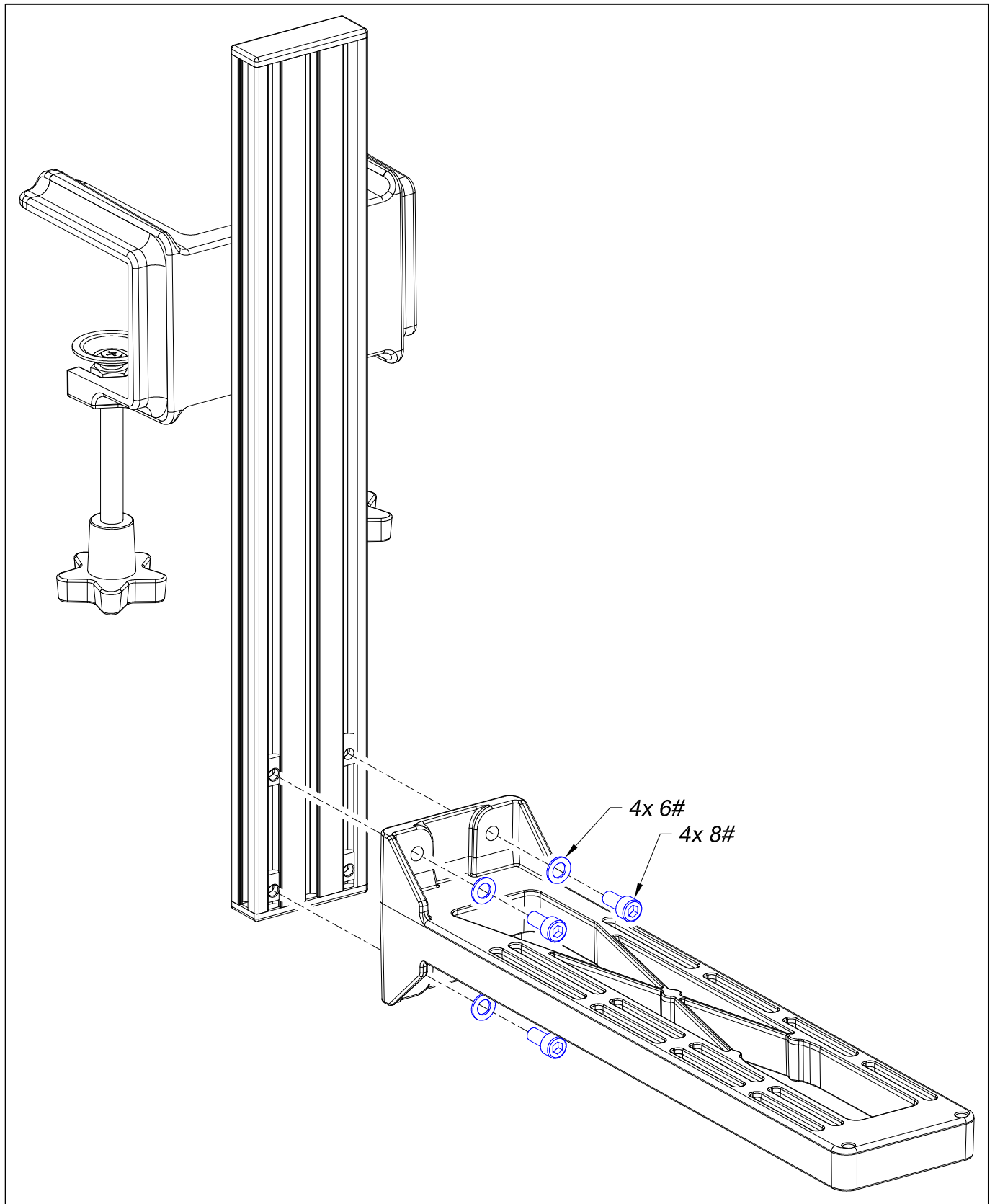

4.2 Up and down adjustment

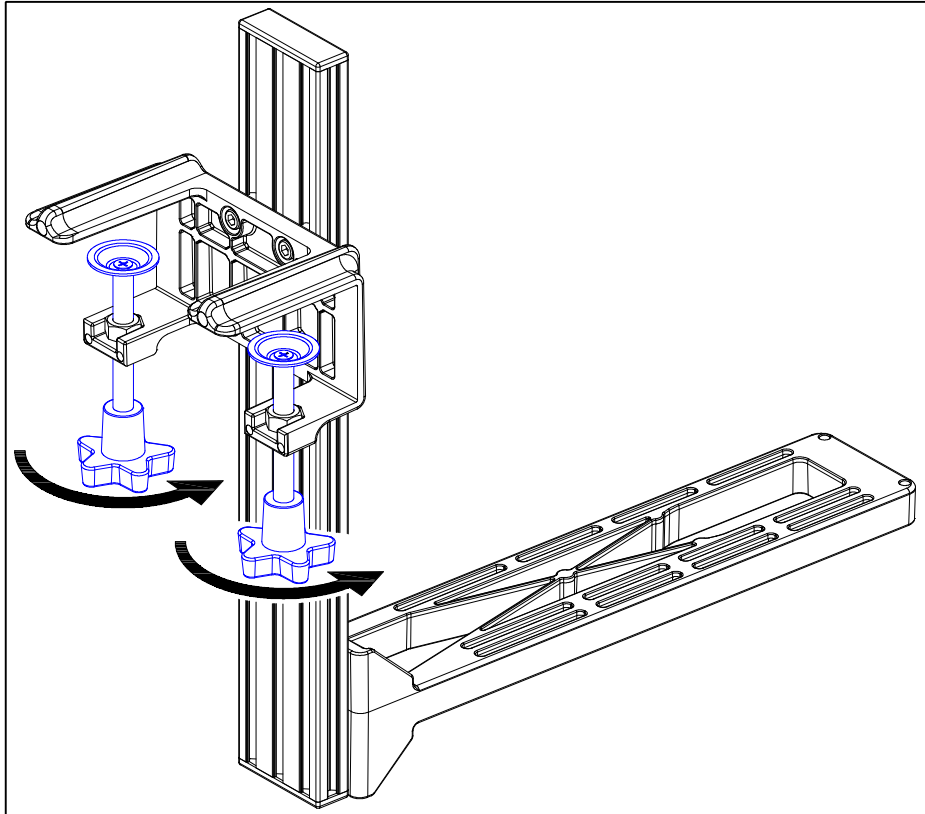

Rotate the handle bolt until the opening size of the clamp is close to the thickness of the desktop.

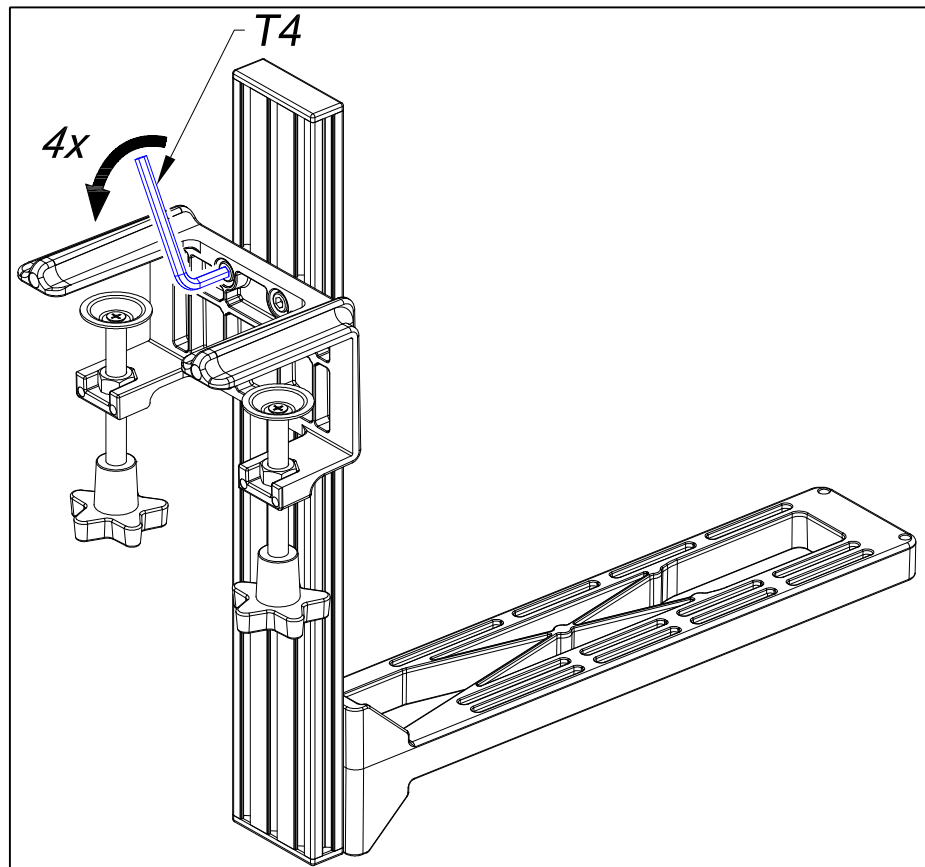

Loosen the screws by half to one turn.

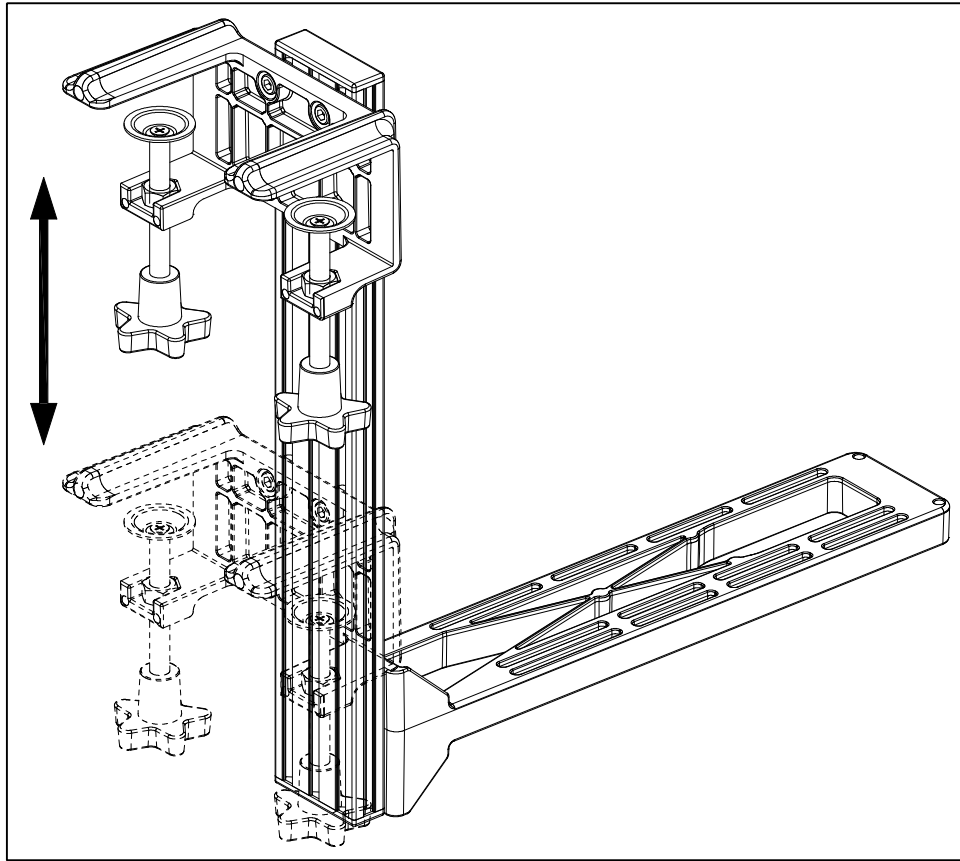

After adjusting the bracket up and down to the appropriate position, tighten the screws.
(For FCU Unit1 installation, adjust to the position shown in the picture below).

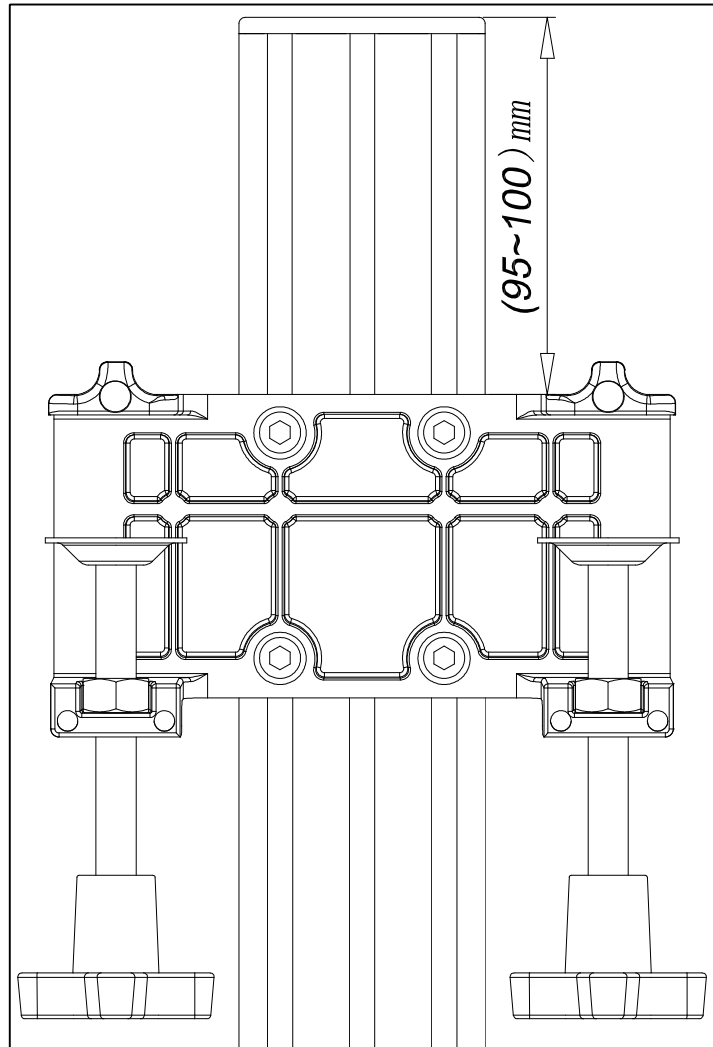

4.3 Install the Orion 2 flight joystick

- This section uses the Orion 2 Joystick as an example. Other joysticks are installed in the same way and will not be repeated.
- This section uses the ViperAce EX Grip as an example. Other grips and the Z-axis are installed in the same way, which will not be repeated.

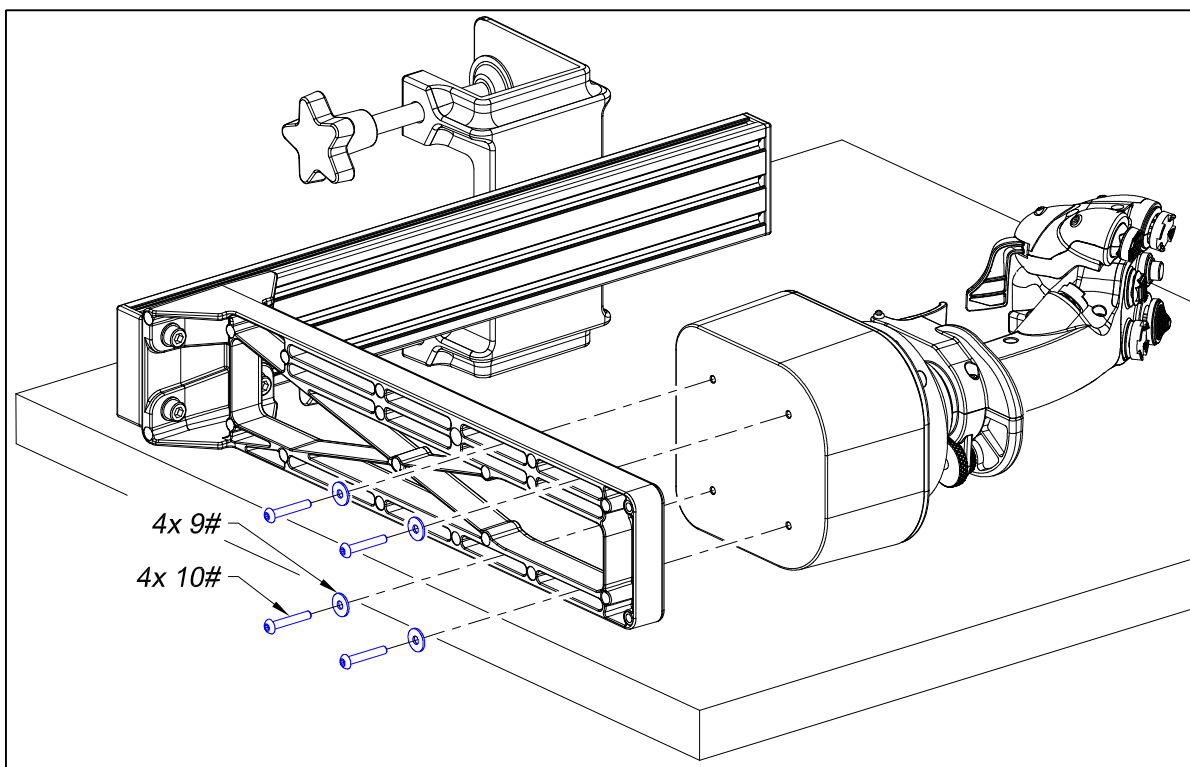

- Place the Orion 2 Joystick Combo on the MJX bracket, adjust the front and back positions, and then tighten the screws.

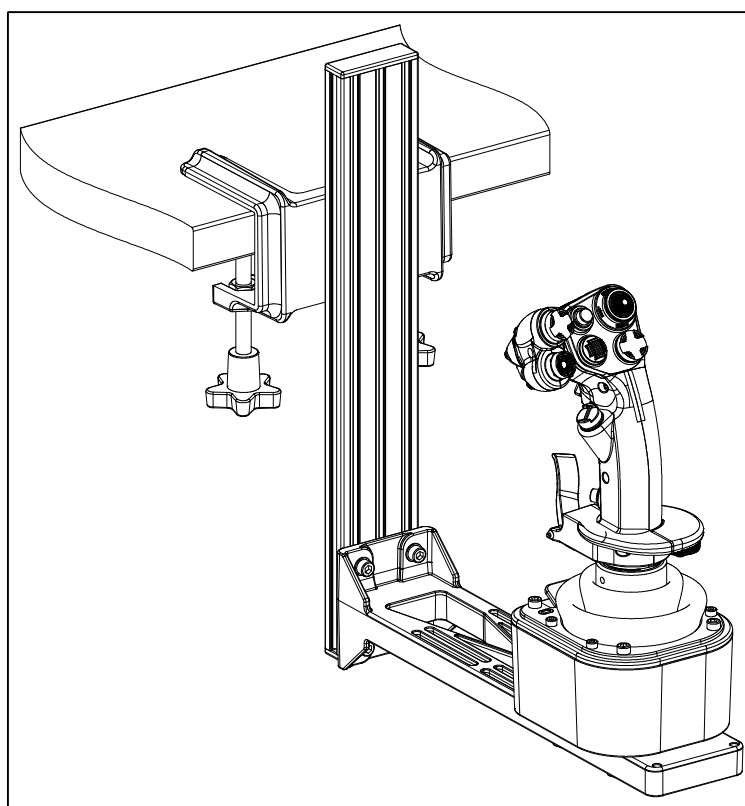

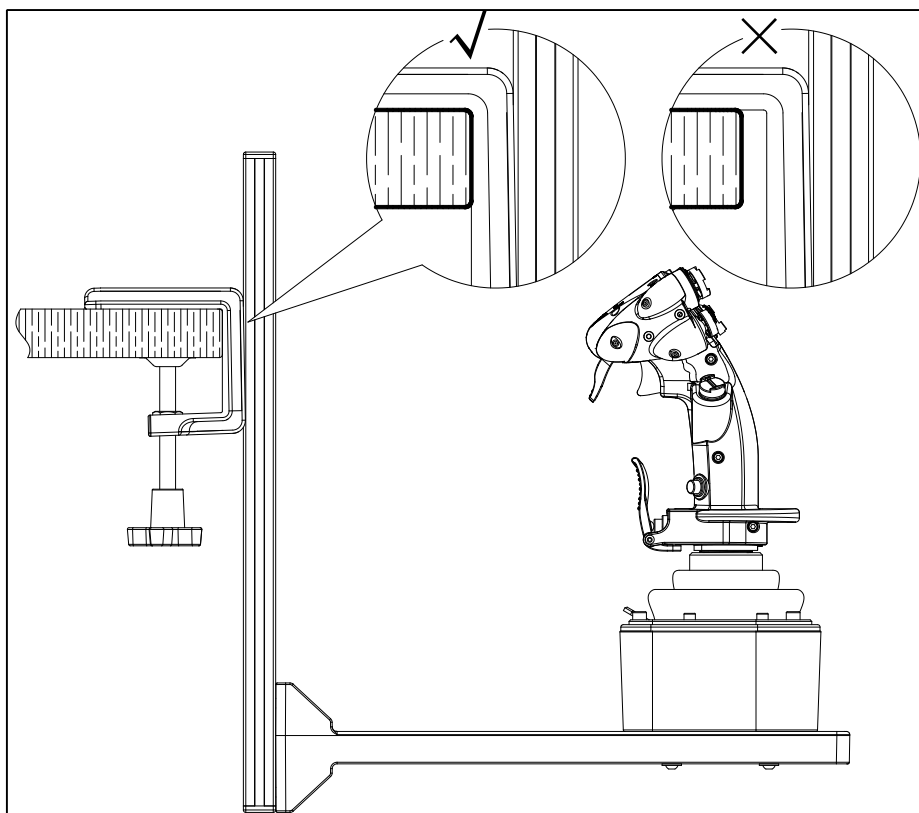

- Clamp the mount on the table and alternate tightening the handle bolts left and right with a torque of $2.5\text{N} \cdot \text{m}$.

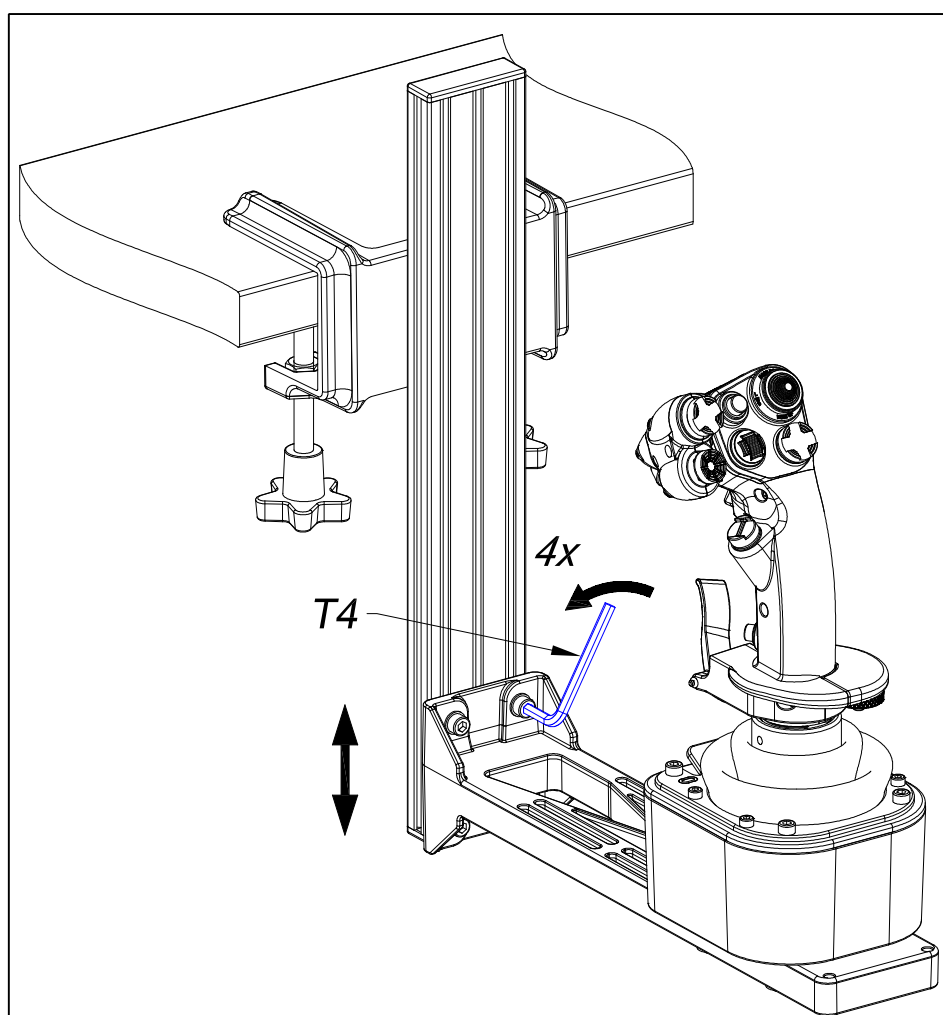

- Loosen the four screws that connect the profile to the MJX bracket, adjust the MJX bracket up and down to a suitable height and tighten the screws.
-

4.4 Installation of Ursa Minor Joystick

- This section uses the right hand of the Ursa Minor fighter as an example. The installation methods for the left hand of the Ursa Minor Fighter, the civil aviation joystick (left/right), and the space joystick (left/right) are the same and will not be repeated.

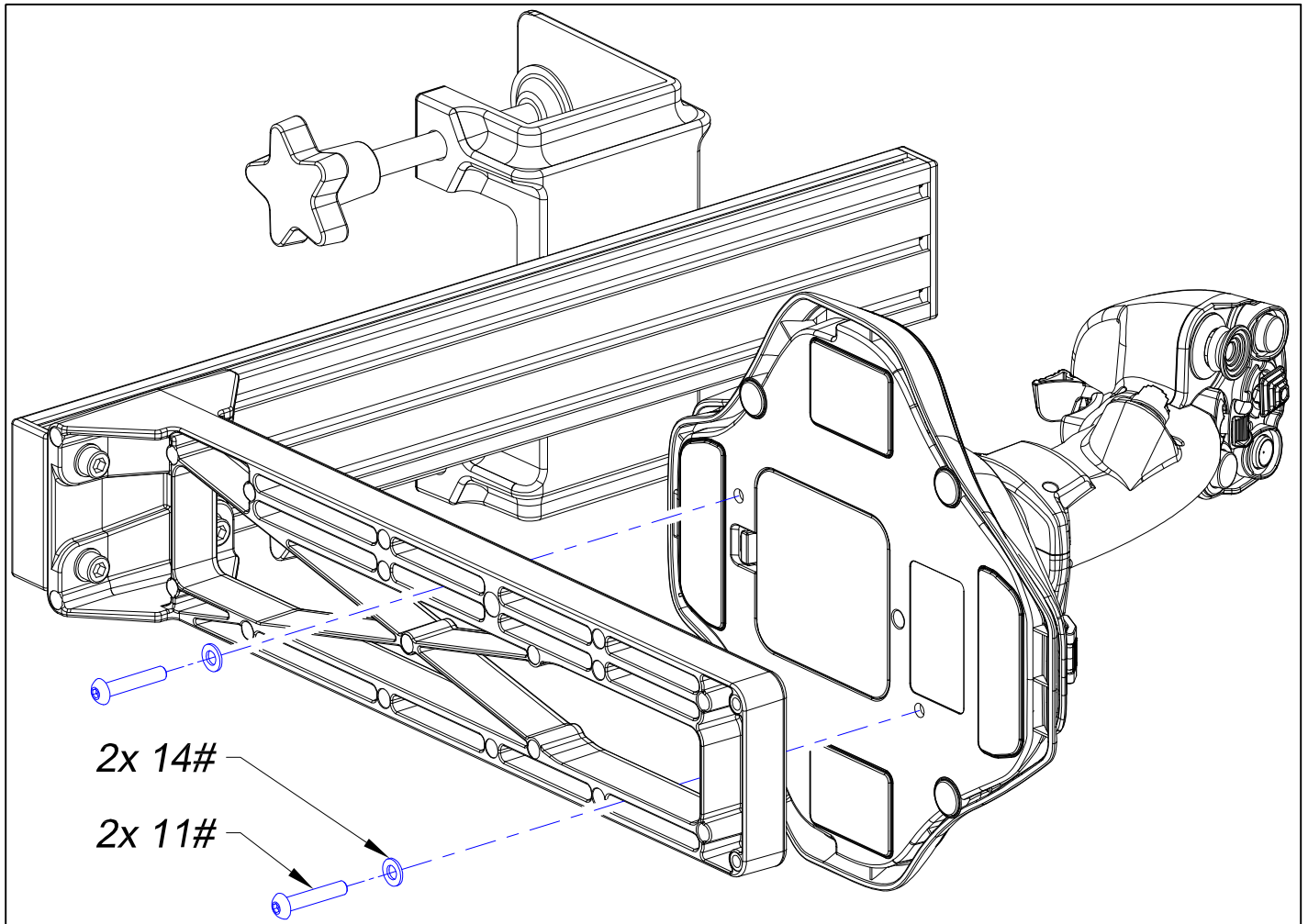

- Place the Ursa Minor Joystick on the MJX bracket, adjust the front and back positions, screw in but do not tighten yet.
Follow the descriptions in Section 4.3 of this manual for the following two steps:
- Clamp the mount on the desktop and alternate tightening the handle bolts left and right with a torque of $2.5\text{N} \cdot \text{m}$.
- Loosen the four screws that connect the profile to the MJX bracket, adjust the MJX bracket up and down to a suitable height and then tighten the screws.

4.5 Installation of the FCU Unit1

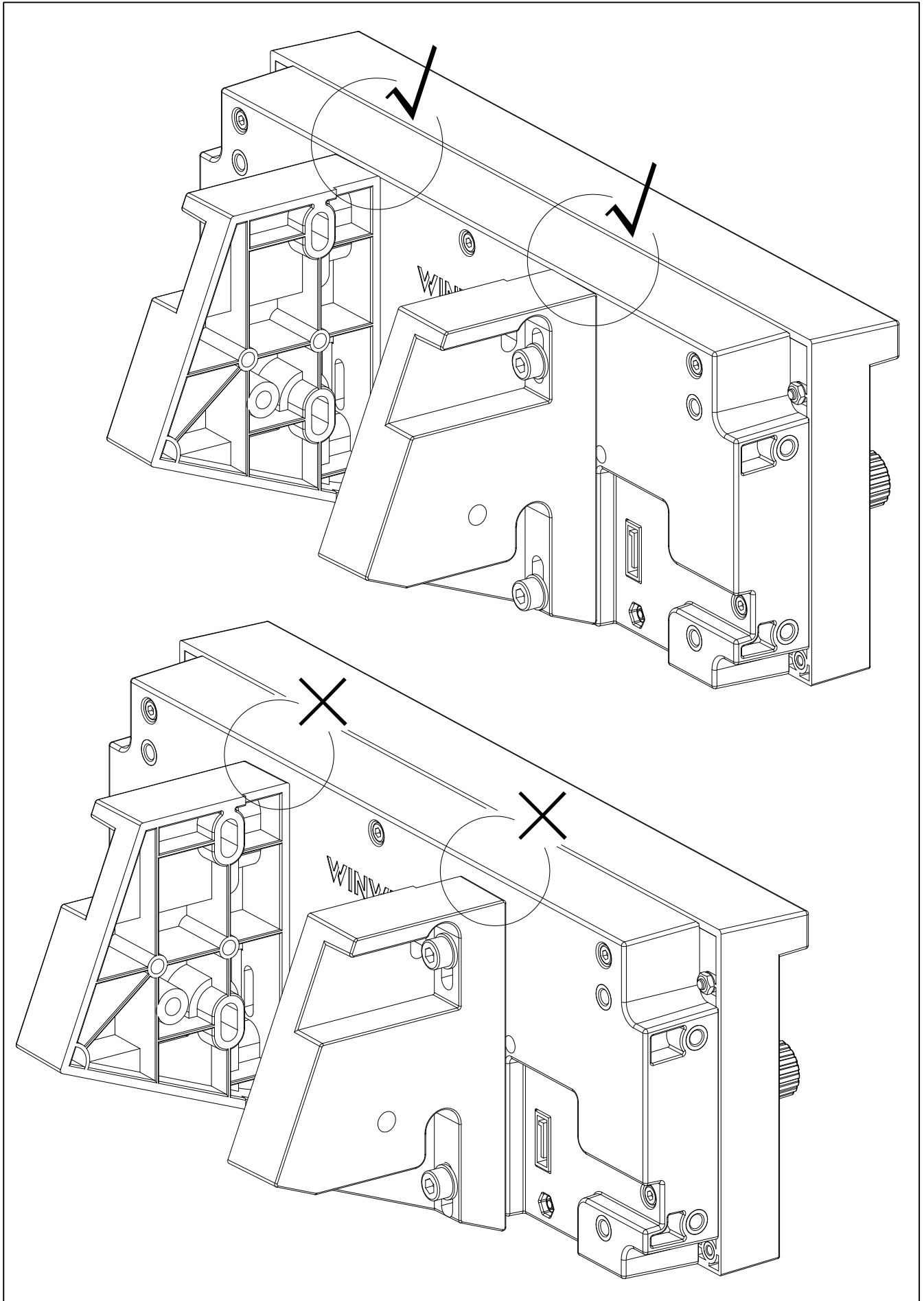

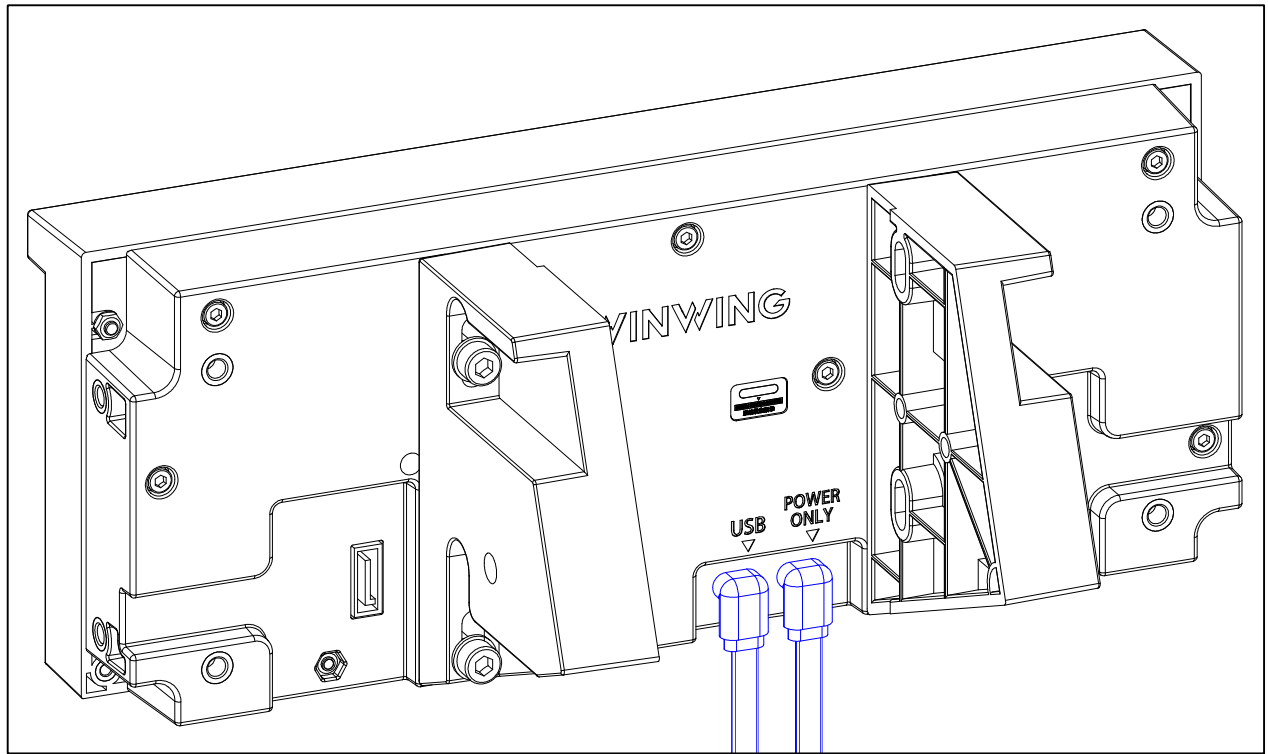

- Install the bracket for FCU1 as described in Section 4.2 of the FCU1 User Manual, and prepare data cables that meet the profile installation requirements as described in that section.
- Adjust the clamping bracket to the correct position as described in Section 4.2 of this manual.
- Clamp the mount on the desktop and alternate tightening the handle bolts left and right with a torque of $2.5\text{N} \cdot \text{m}$.

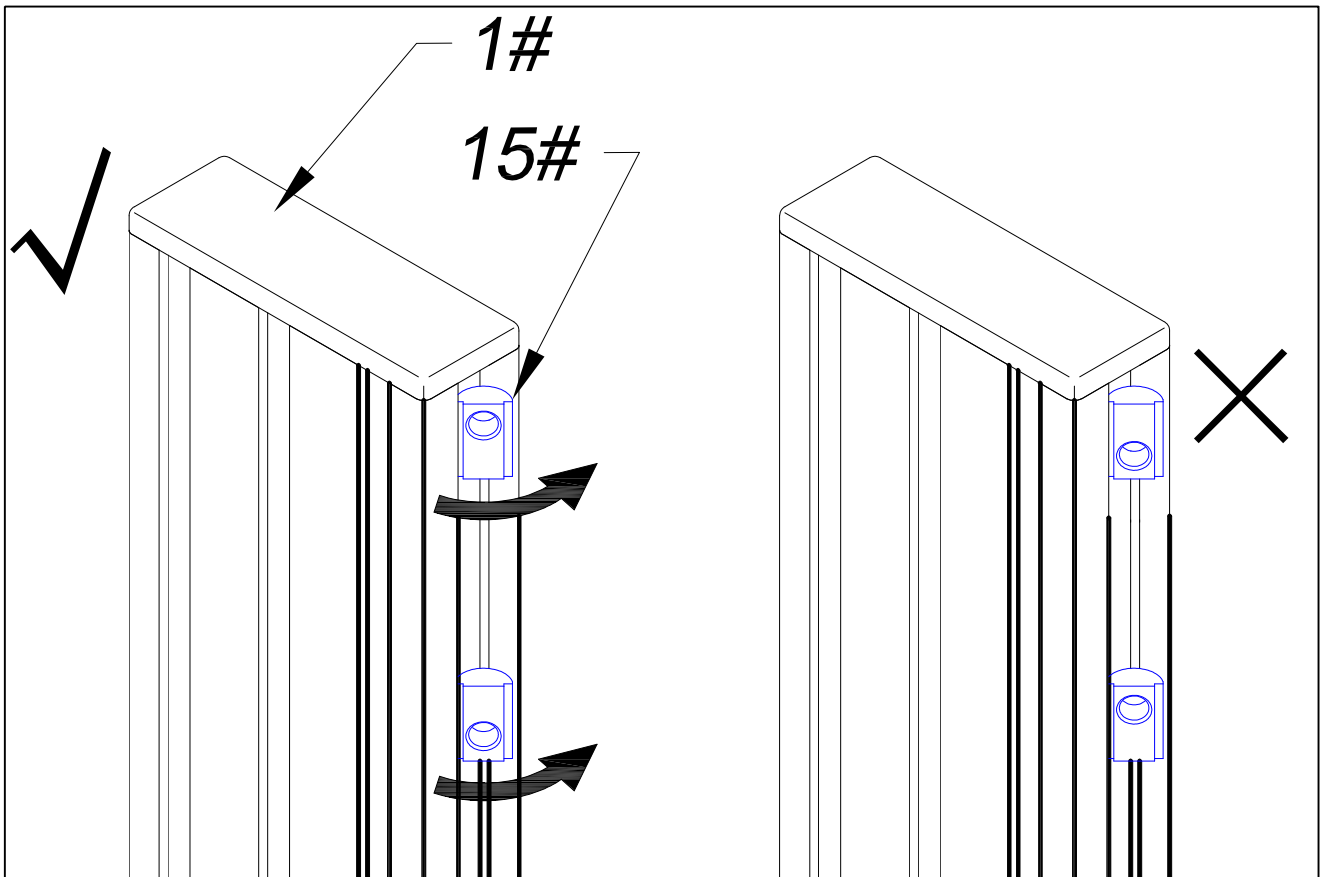

- Insert the profile nut into the profile slot (note the direction of the profile nut).

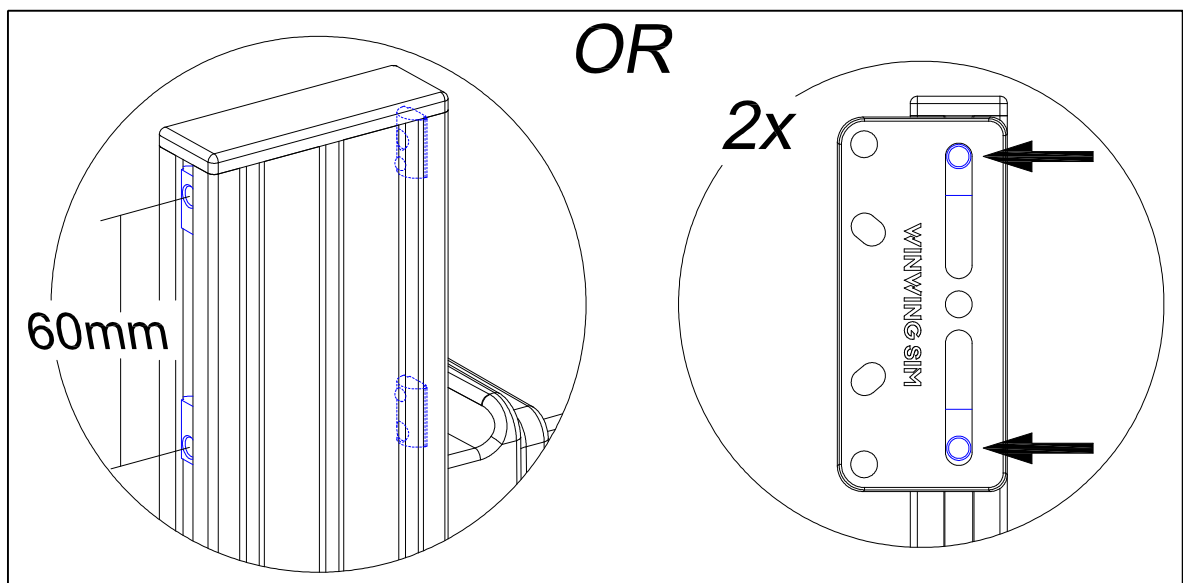
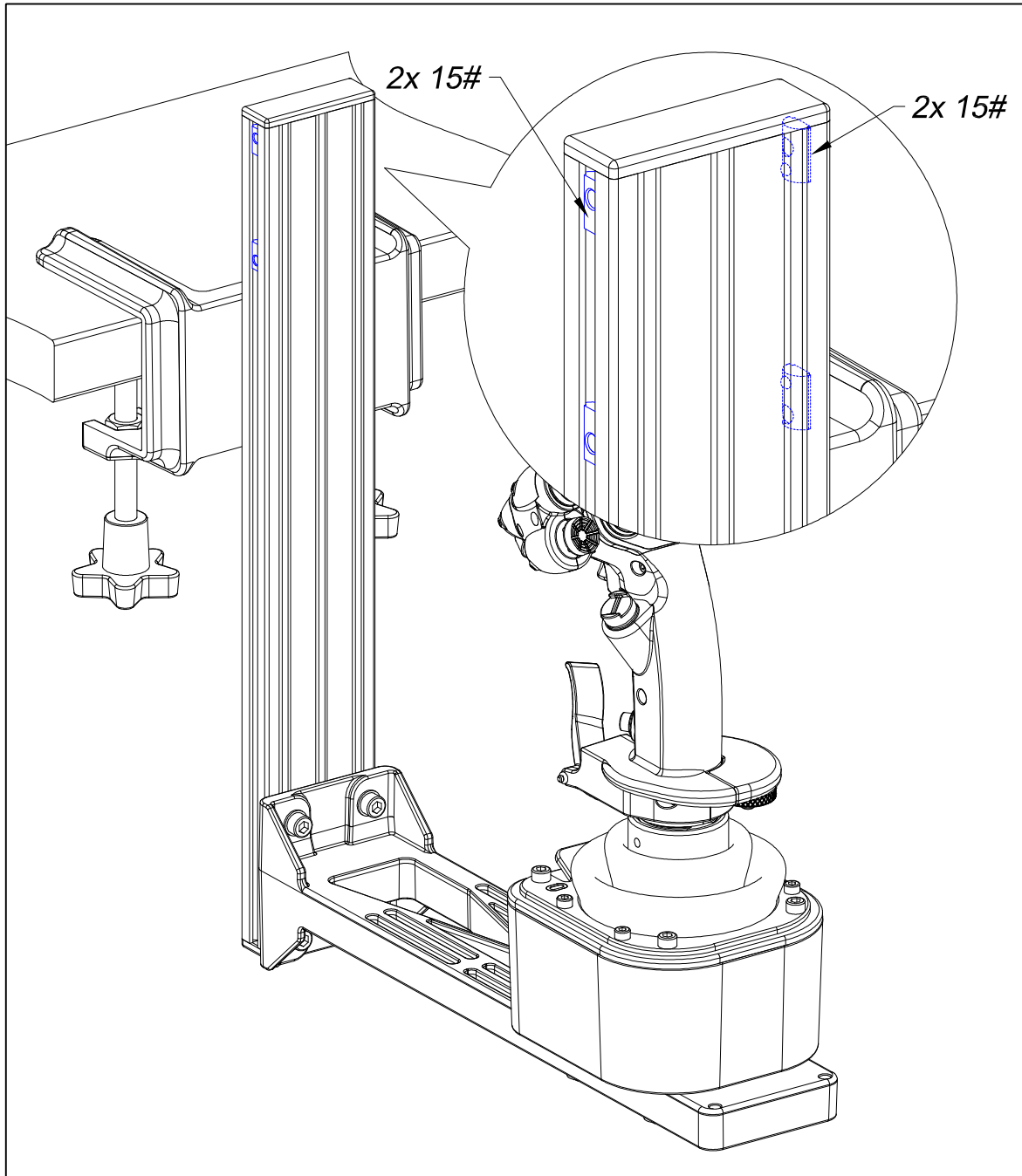

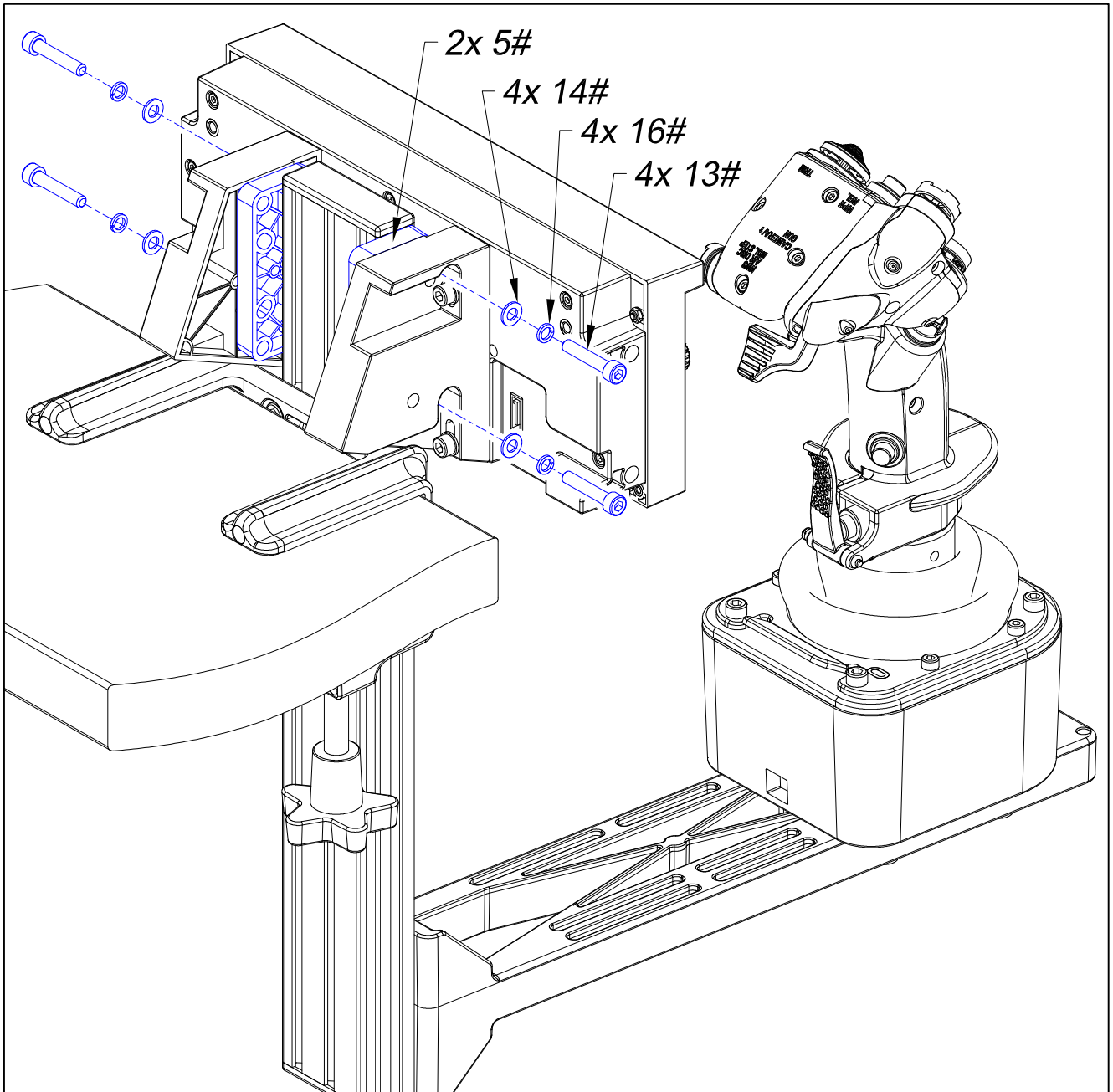

- Place the two bracket pads (5#) between the brackets on both sides of FCU Unit1 and the profile (1#) respectively, and note that the direction of the bracket pads should be consistent with the drawing. Screw in but do not tighten them yet.
- Adjust the position of FCU Unit1 and tighten the screws until there is no wobbling. Over-tightening may cause deformation.

4.6 Installation of NavyAce-UFC unit 1

- Please prepare the accessories according to the specifications described in Section 1.5 “Other Compatibility and Self-Prepared Accessories List” of this manual.
- Install the bracket for the UFC1 according to item 1 in Section 4.1 of the UFC1 User Manual.

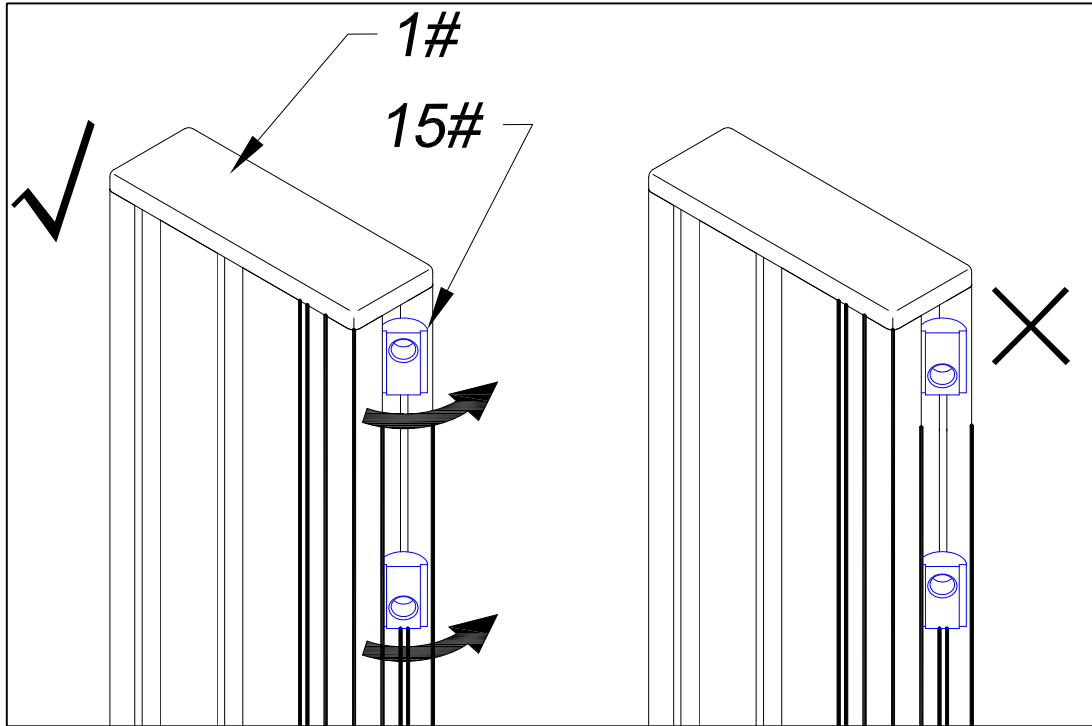

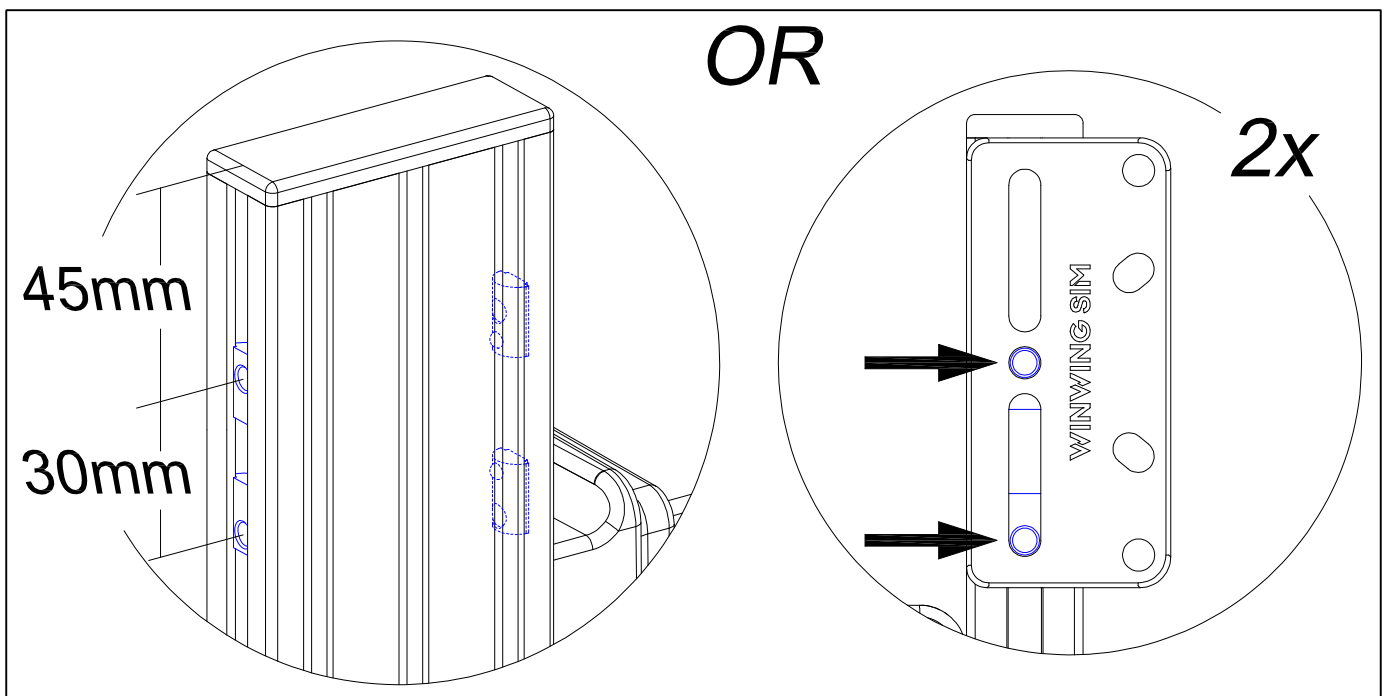
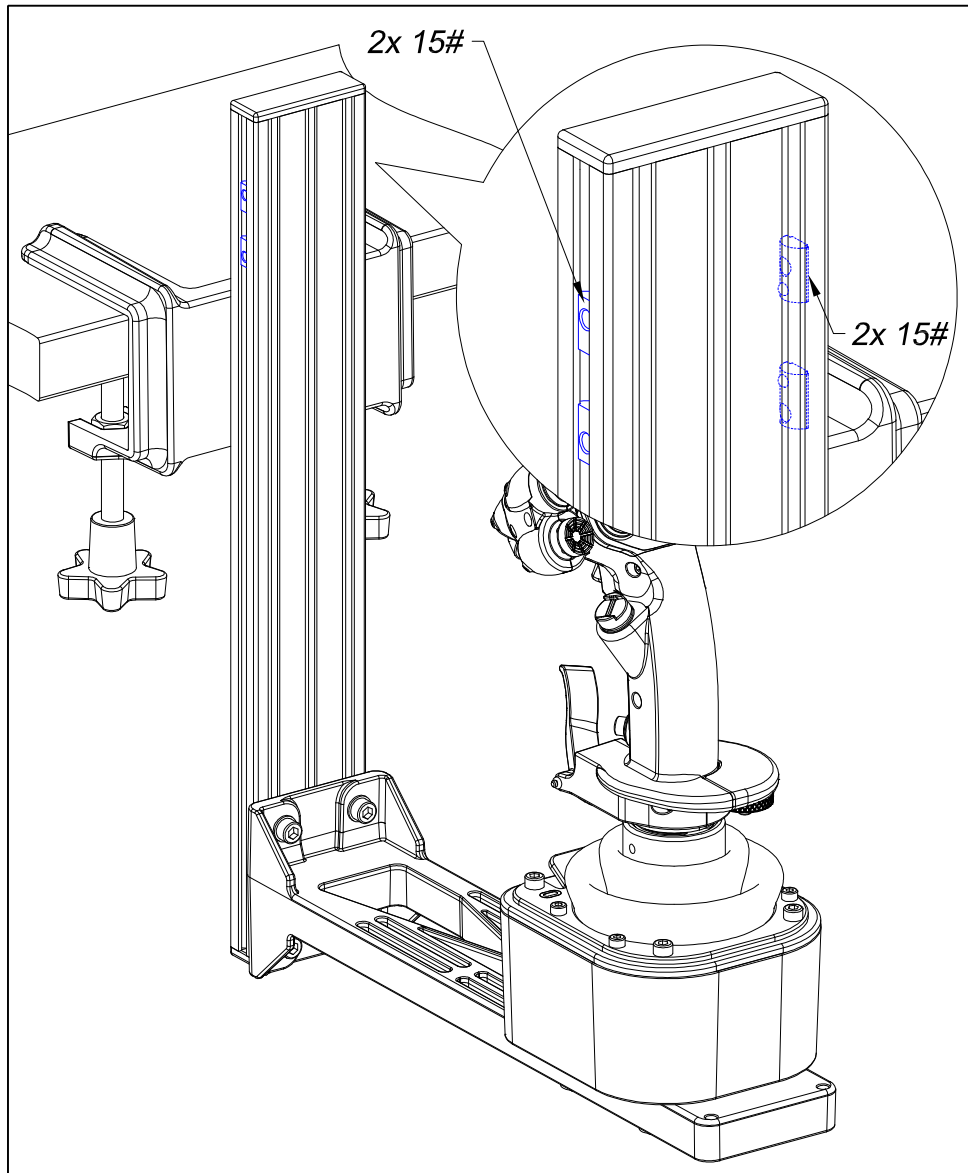

- Insert the profile nuts into the profile slot (ensure direction of the profile nuts is correct).

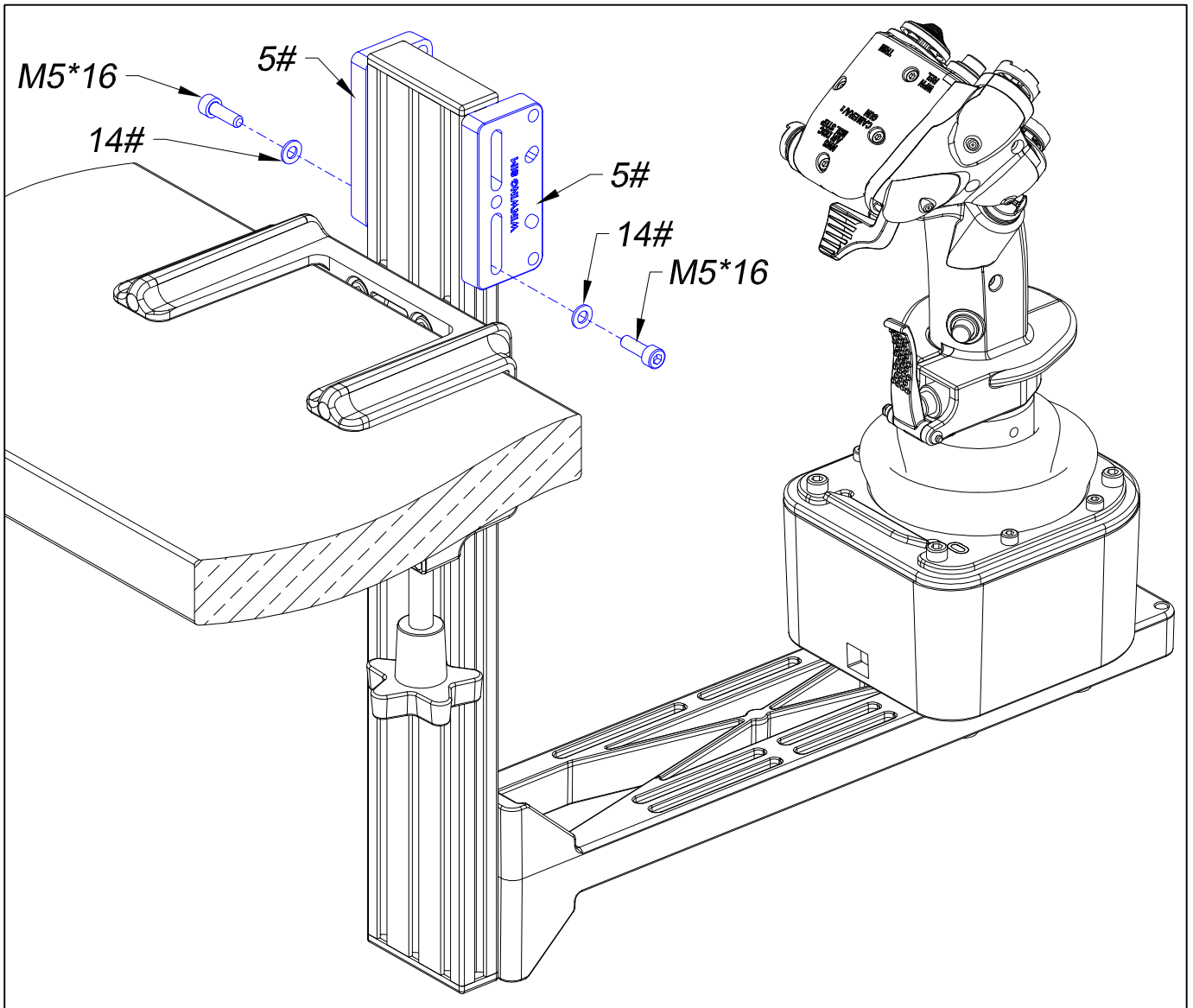

- Install the bracket spacers on both sides of the profile. Make sure the installation direction matches the diagram. Screw in M5*16 bolt, but do not tighten yet.

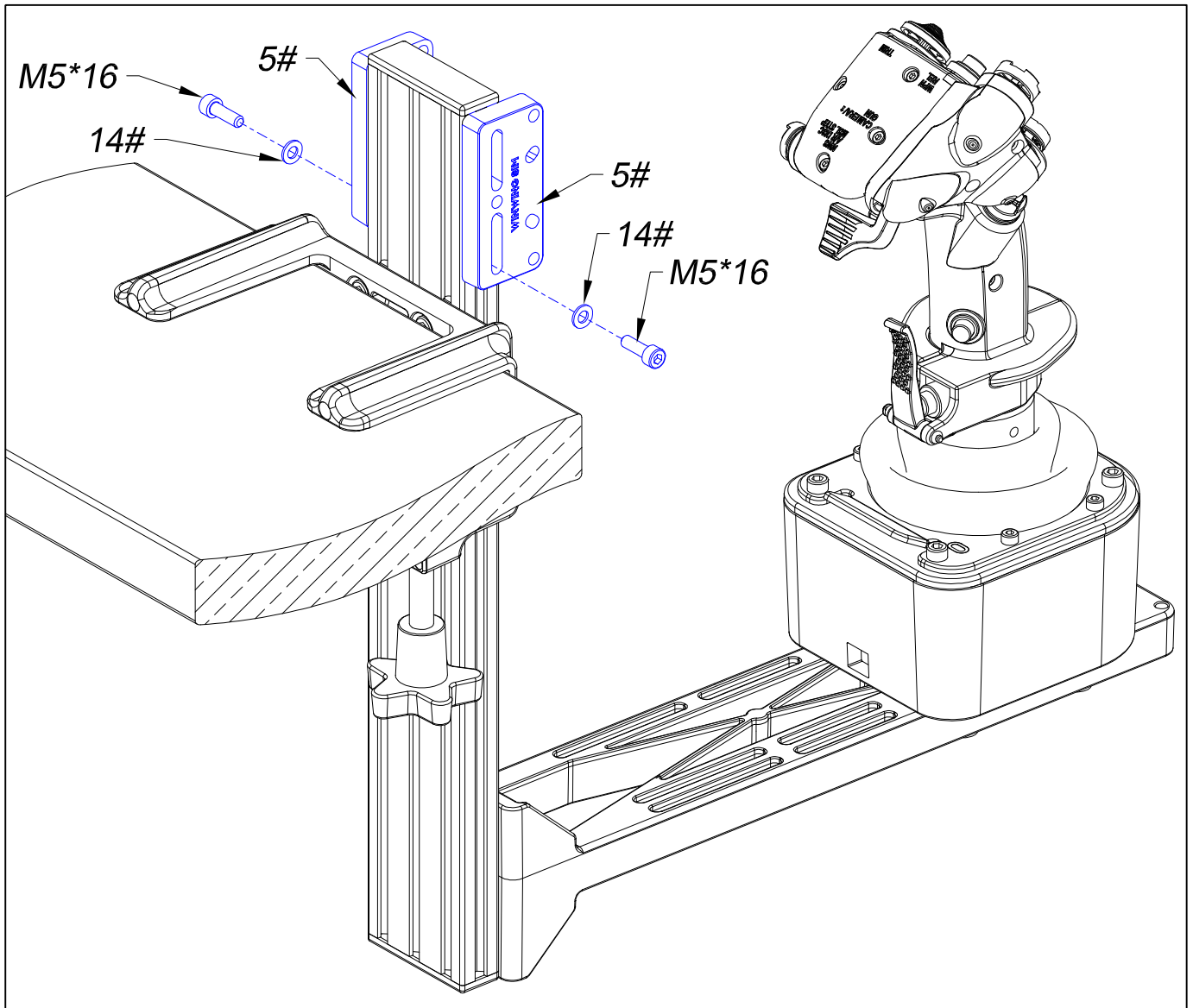

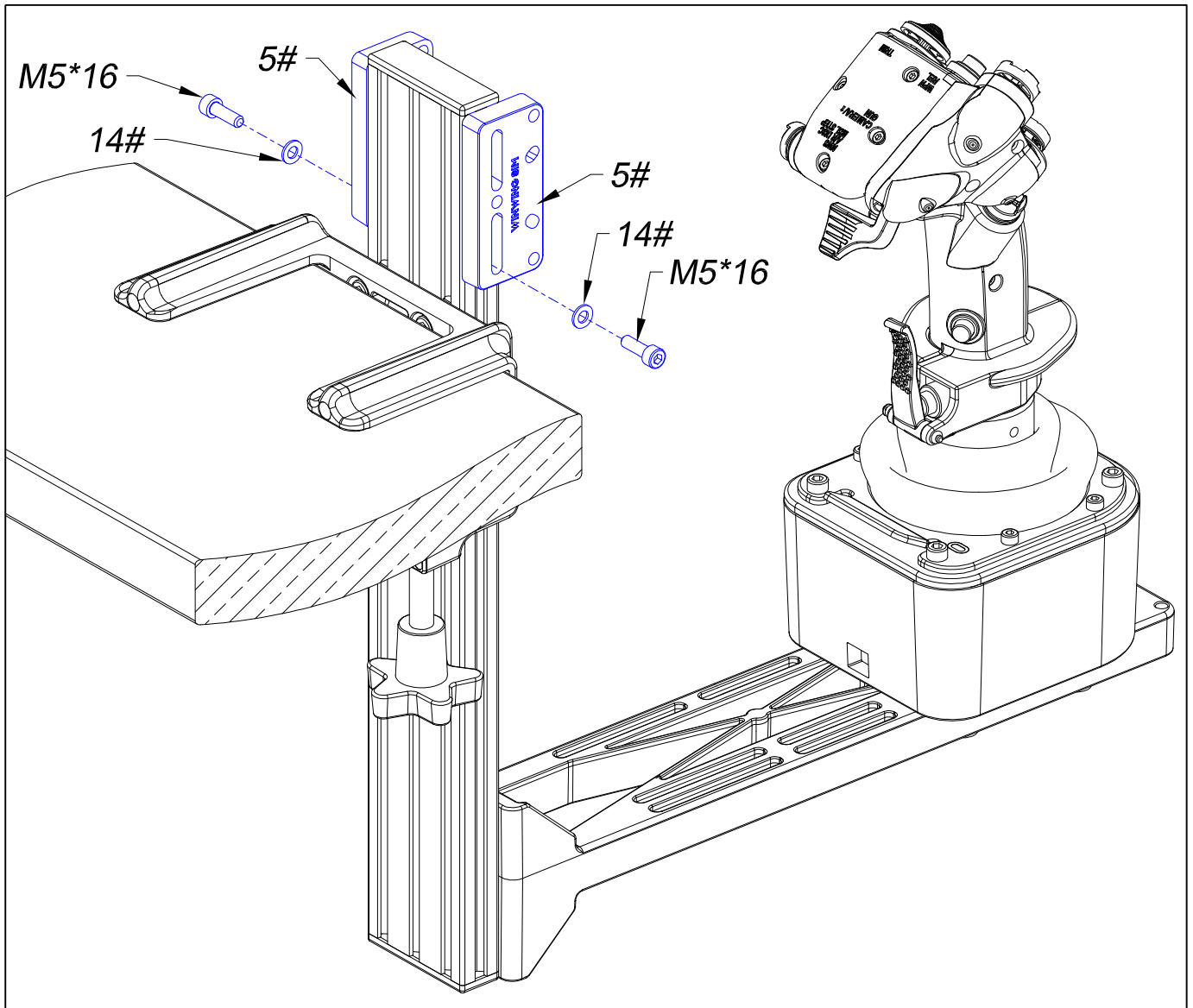

- Align the brackets on both sides of the UFC Unit1 with the bracket spacers on the profile, make sure the holes are properly matched. Insert screws and nuts, but do not fully tighten them yet.
- Adjust the position of UFC Unit1 as needed, then tighten the screws until the UFC Unit1 is secure and does not wobble. Over-tighten may cause damage.

4.7 Installation for NavyAce-UFC unit 1+Navy Ace-HUD unit 1

- Please prepare the accessories according to the specifications described in Section 1.5 “Other Compatibility and Self-Prepared Accessories List” of this manual.

- Cascade UFC Unit 1 with HUD Unit 1 according to steps ① and ② in Section 4.4 of the HUD1 User Manual.

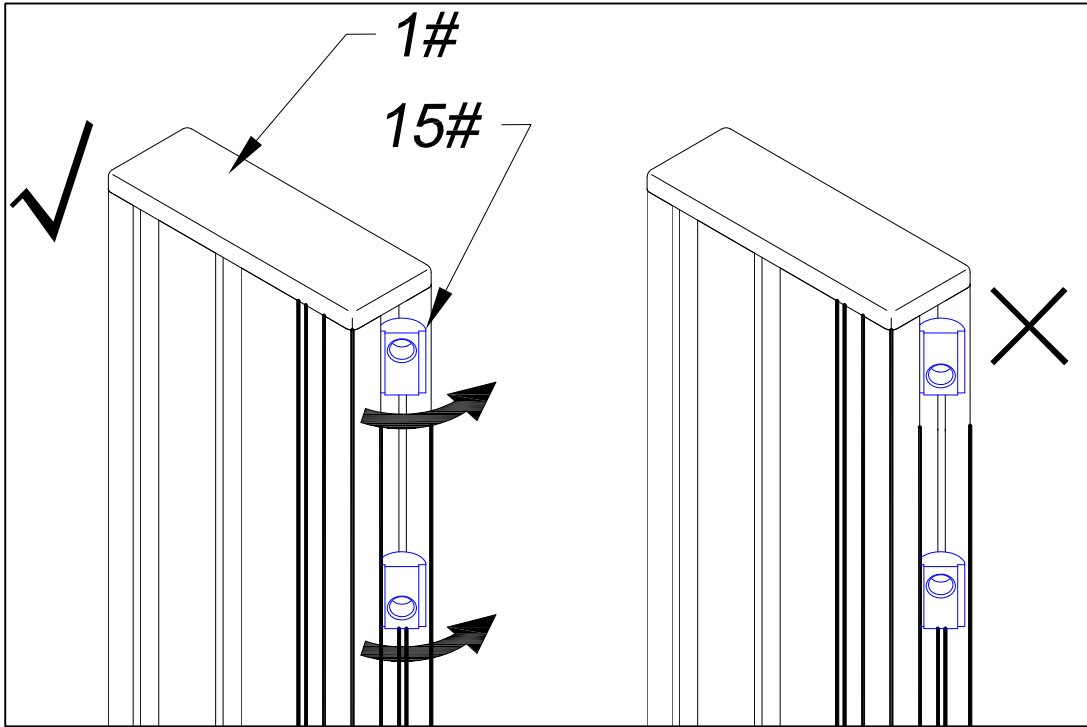

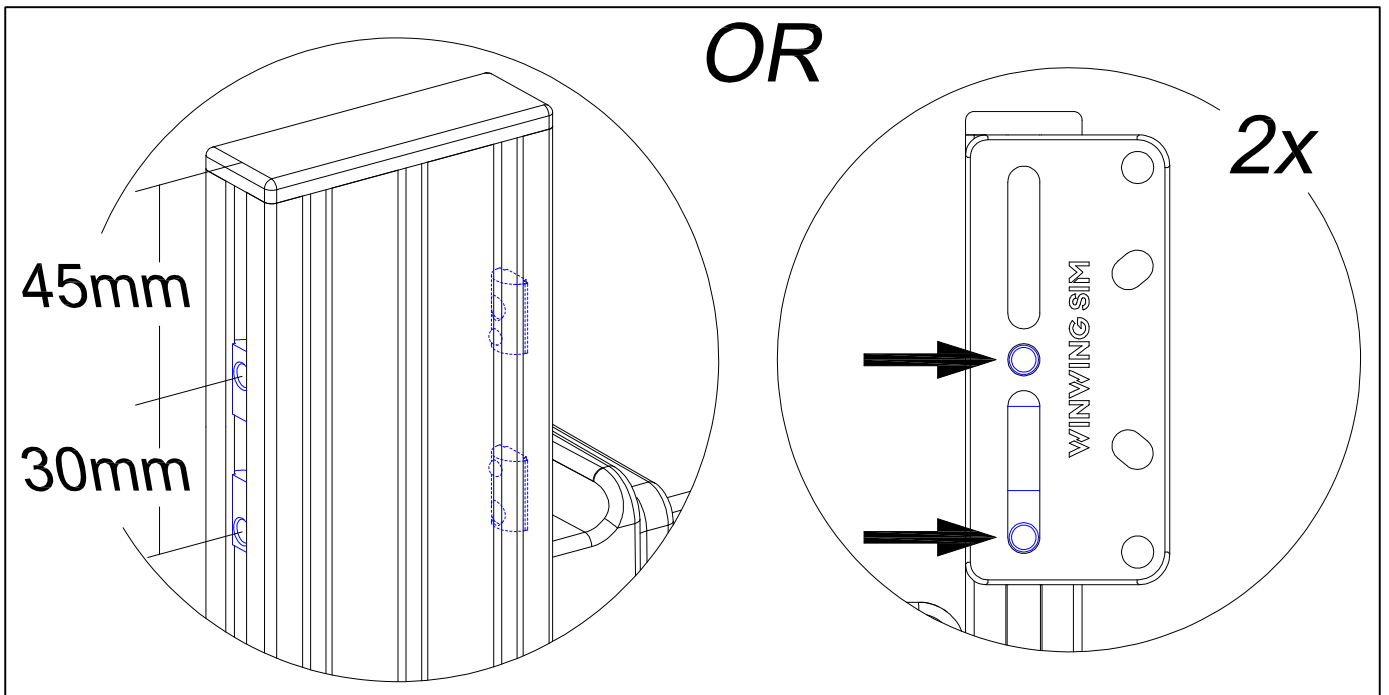
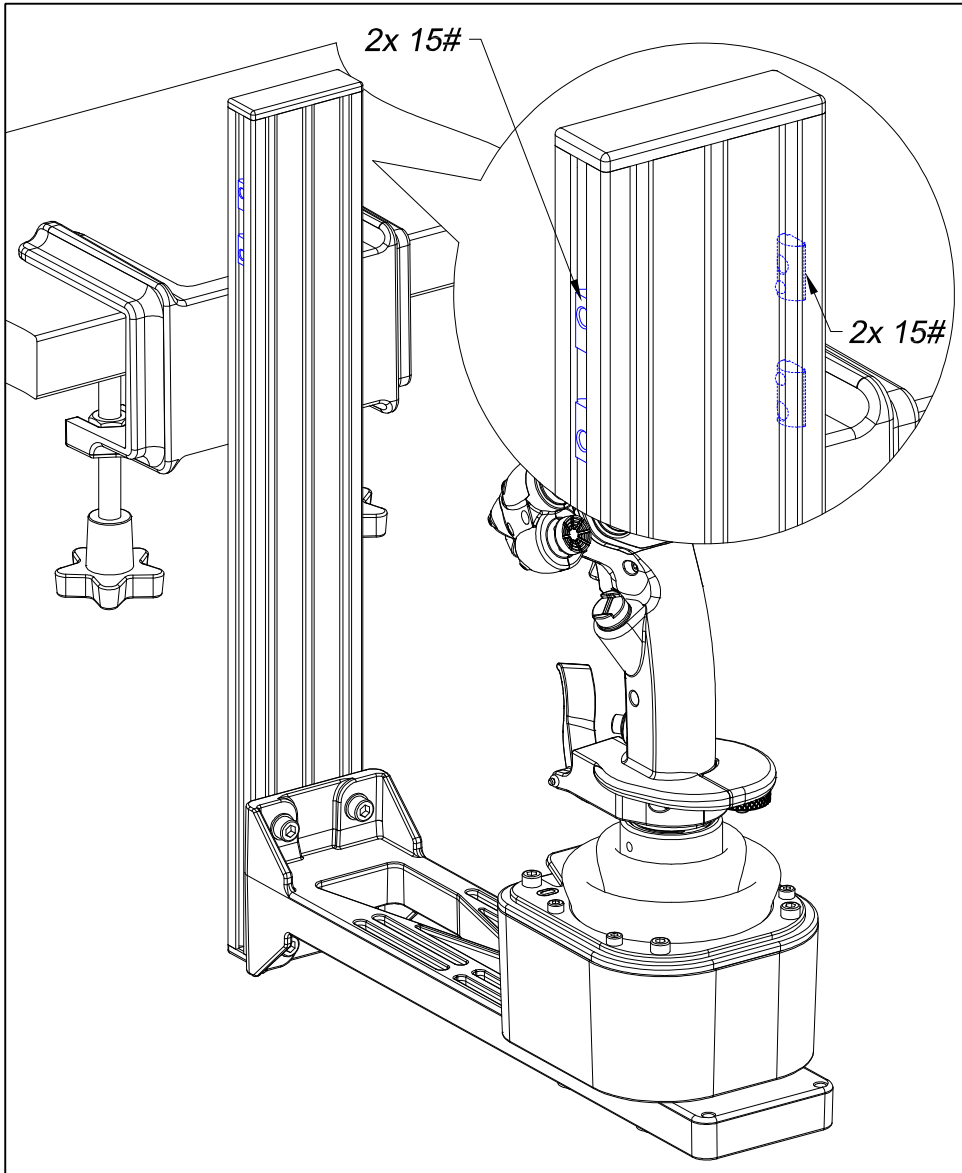

- Insert the profile nuts into the profile slot (ensure the direction of the profile nuts is correct).

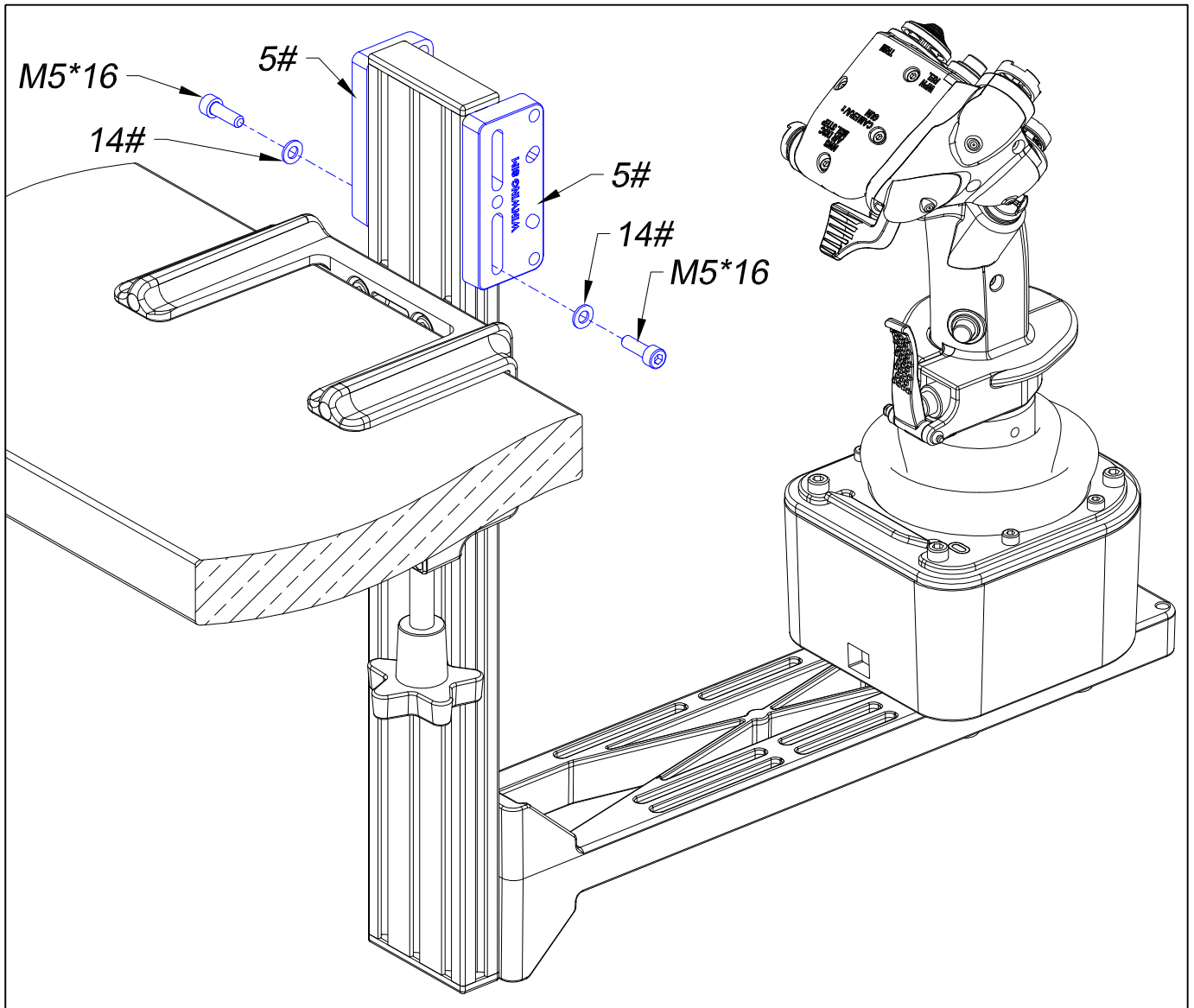

- Install the bracket spacers on both sides of the profile, making sure the installation direction matches the diagram. Screw in M5*16, but do not fully tighten yet.

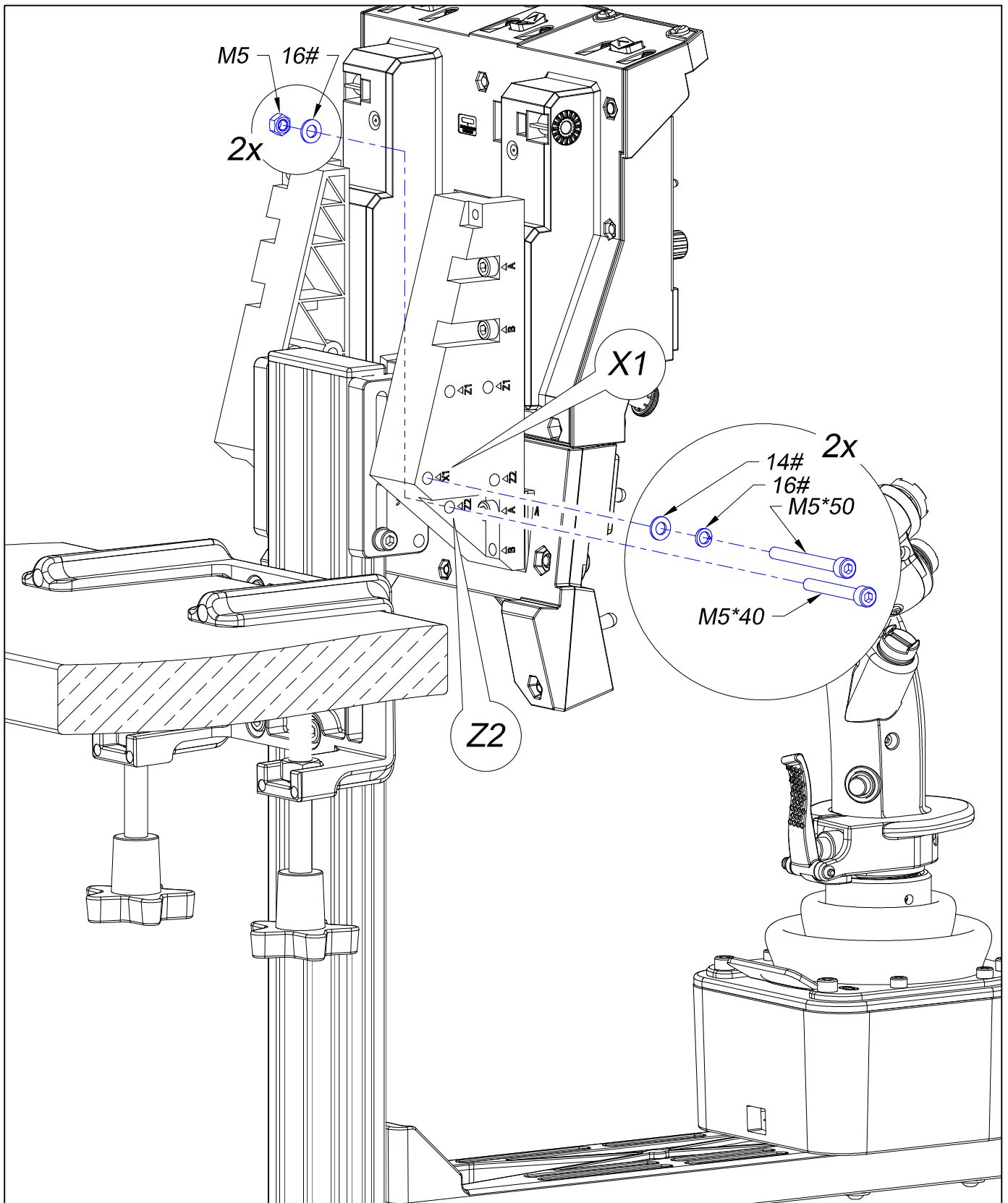

- Align the brackets on both sides of the UFC Unit 1 with the bracket spacers on the profile, ensuring the holes are properly matched. Insert screws and nuts, but do not fully tighten them yet.

- Adjust the position of UFC Unit 1 and HUD Unit 1 as needed, then tighten the screws until the UFC Unit1 and HUD Unit 1 are secured and does not wobble. Over-tighten may cause damage.

4.8 Install Multifunctional MFD1 Unit

- Please prepare the accessories according to the specifications described in Section 1.5 “Other Compatibility Scenarios and Self-Prepared Accessories List” of this manual.
- Install the MFD1 bracket according to Item 2 in Section 4.1 of the MFD1 User Manual. If a D1 unit is present, cascade MFD1 with D1 and complete bracket installation as described in Items 1 and 3 of Section 4.4 in the D1 User Manual.

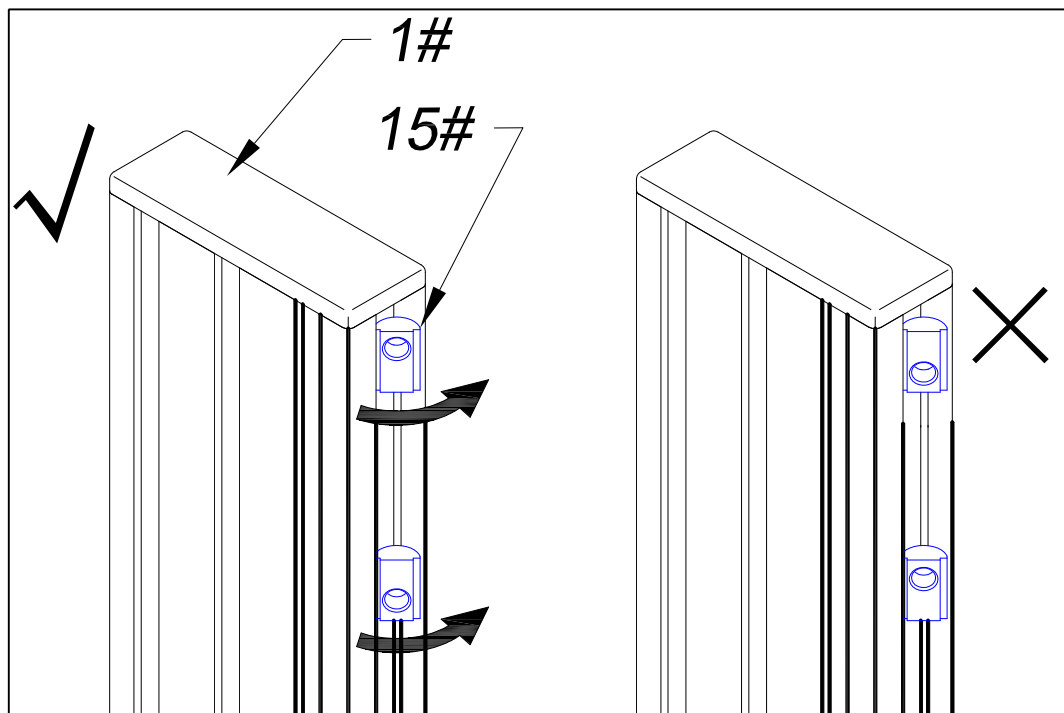

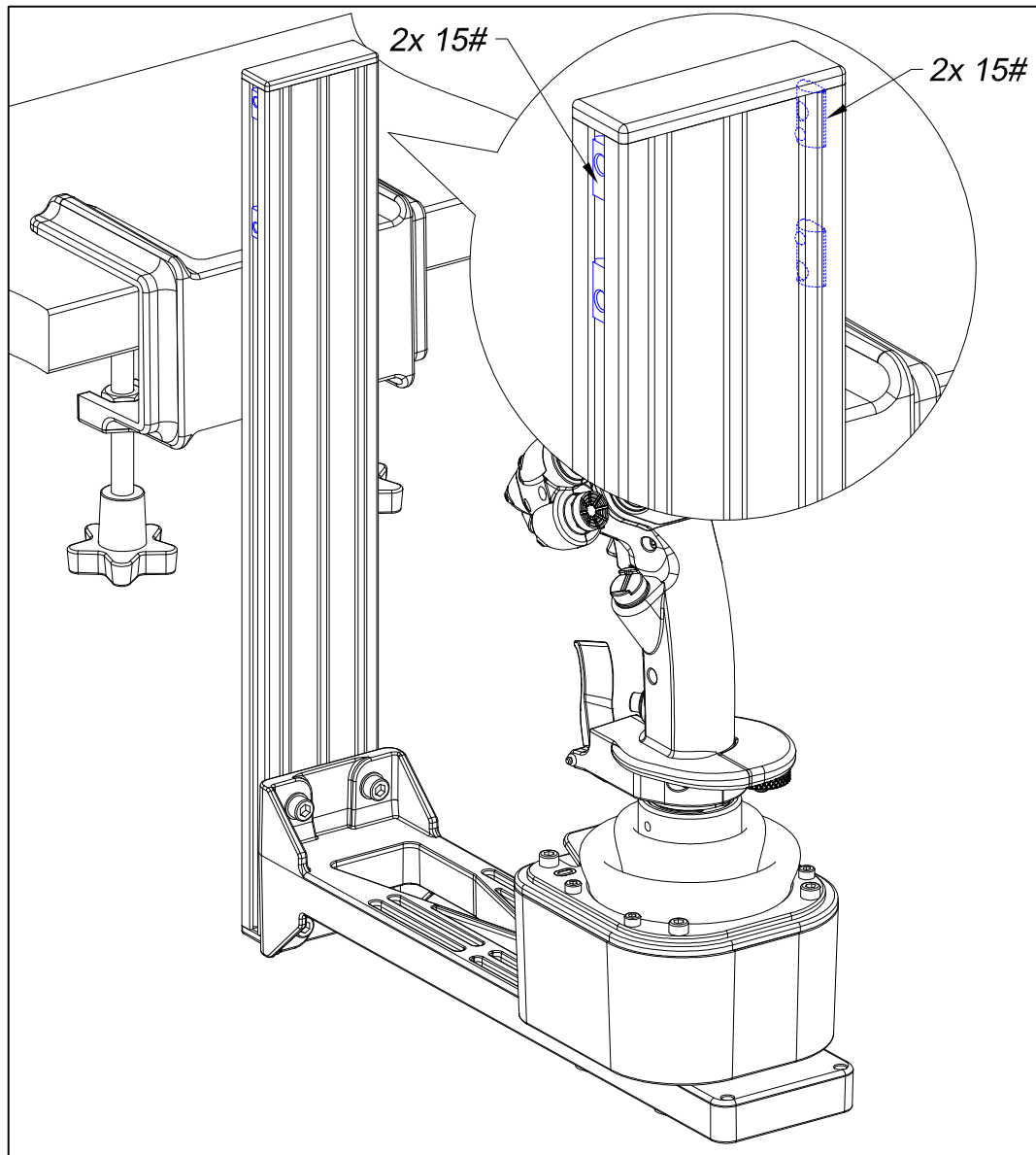

OR

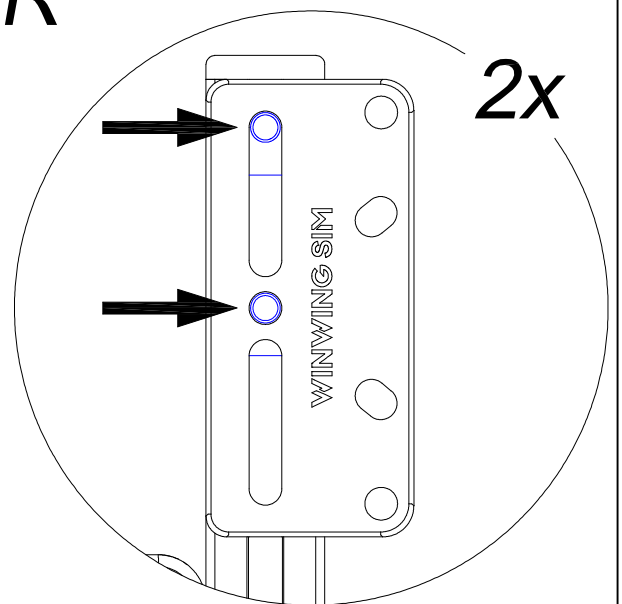
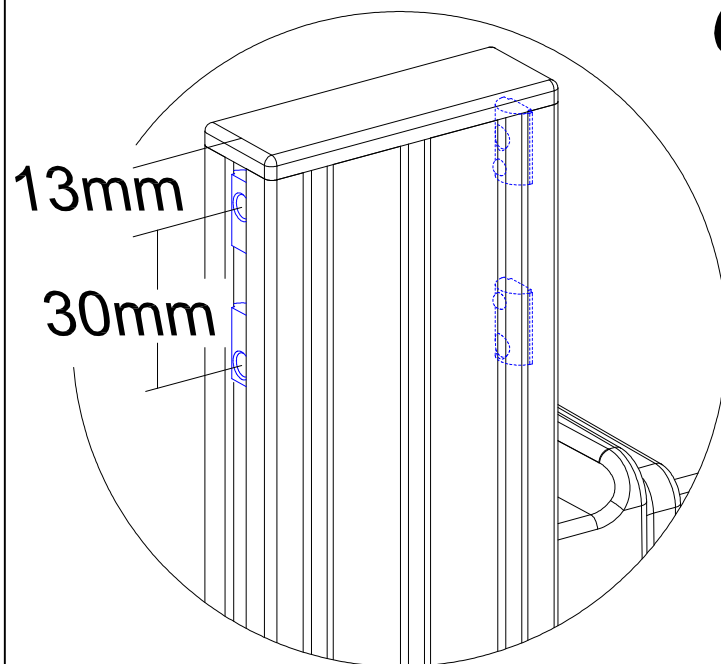

- Insert the profile nuts into the profile slot (ensure the orientation of the profile nuts is correct).

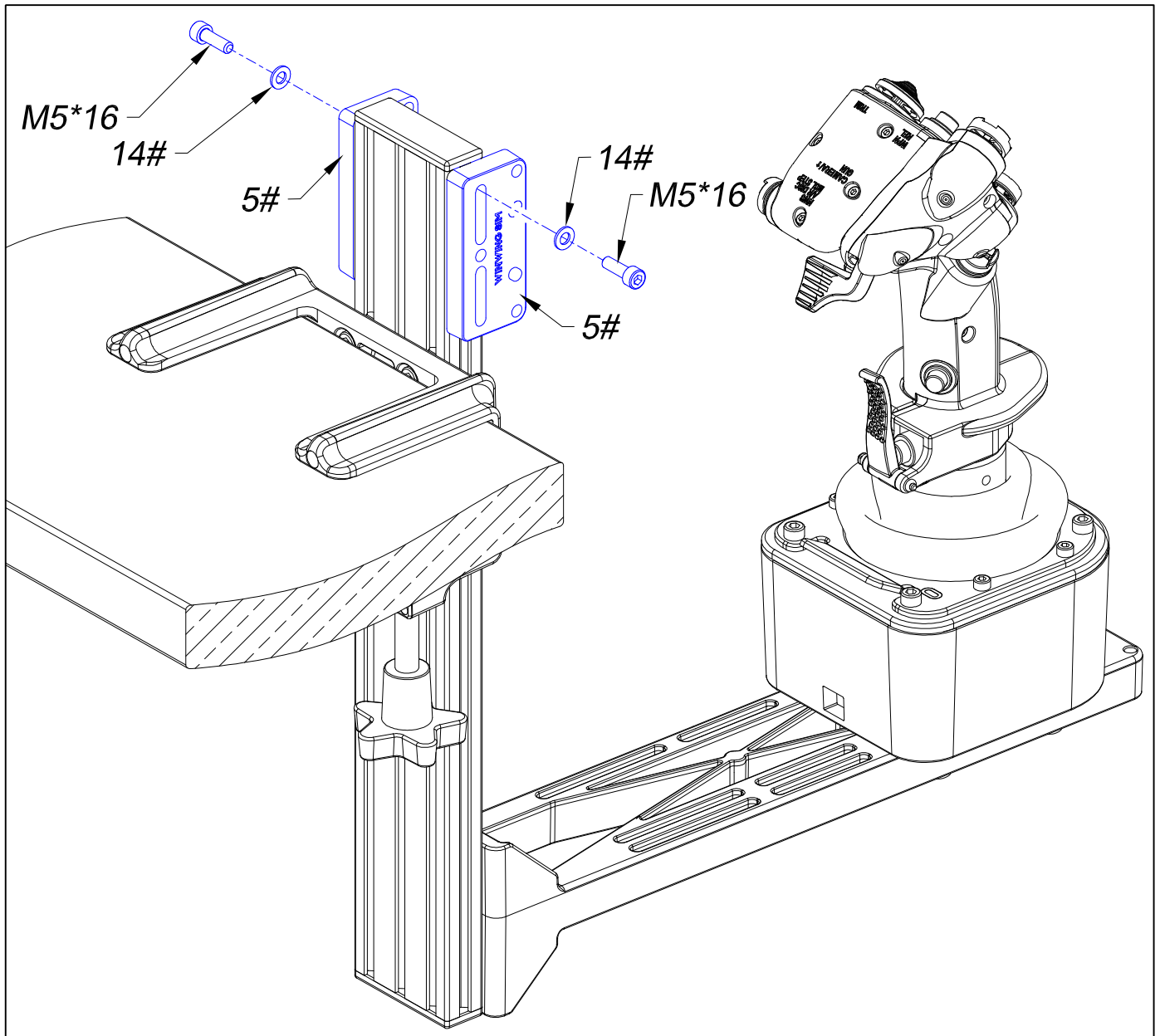

- Install the bracket spacers on both sides of the profile, making sure the installation direction matches the diagram. Use M5*16 screws to secure them, but do not fully tighten yet.

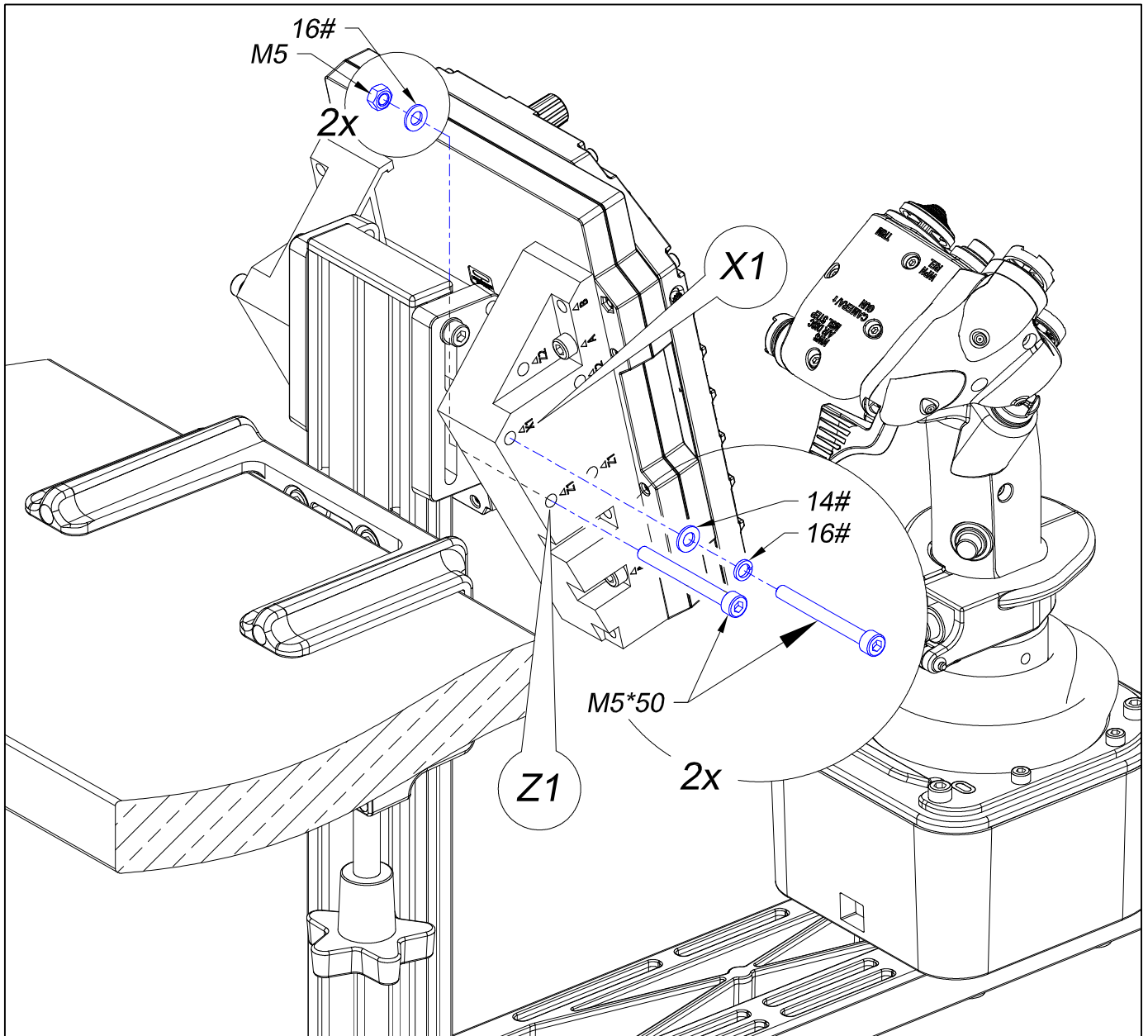

- Align the brackets on both sides of the MFD 1 unit with the bracket spacers on the profile, make sure the holes are properly matched. Insert screws and nuts, but do not fully tighten them yet.
- Adjust the position of MFD1 unit as needed, then tighten the screws until the MFD1 is secure and does not wobble. Over-tighten may cause damage.

4.9 Installation of NavyAce-UFC Unit1+NavyAce-HUD Unit1+Multifunctional MFD1 Unit

- Please prepare the accessories according to the specifications described in Section 1.5
“Other Compatibility and Self-Prepared Accessories List” of this manual.

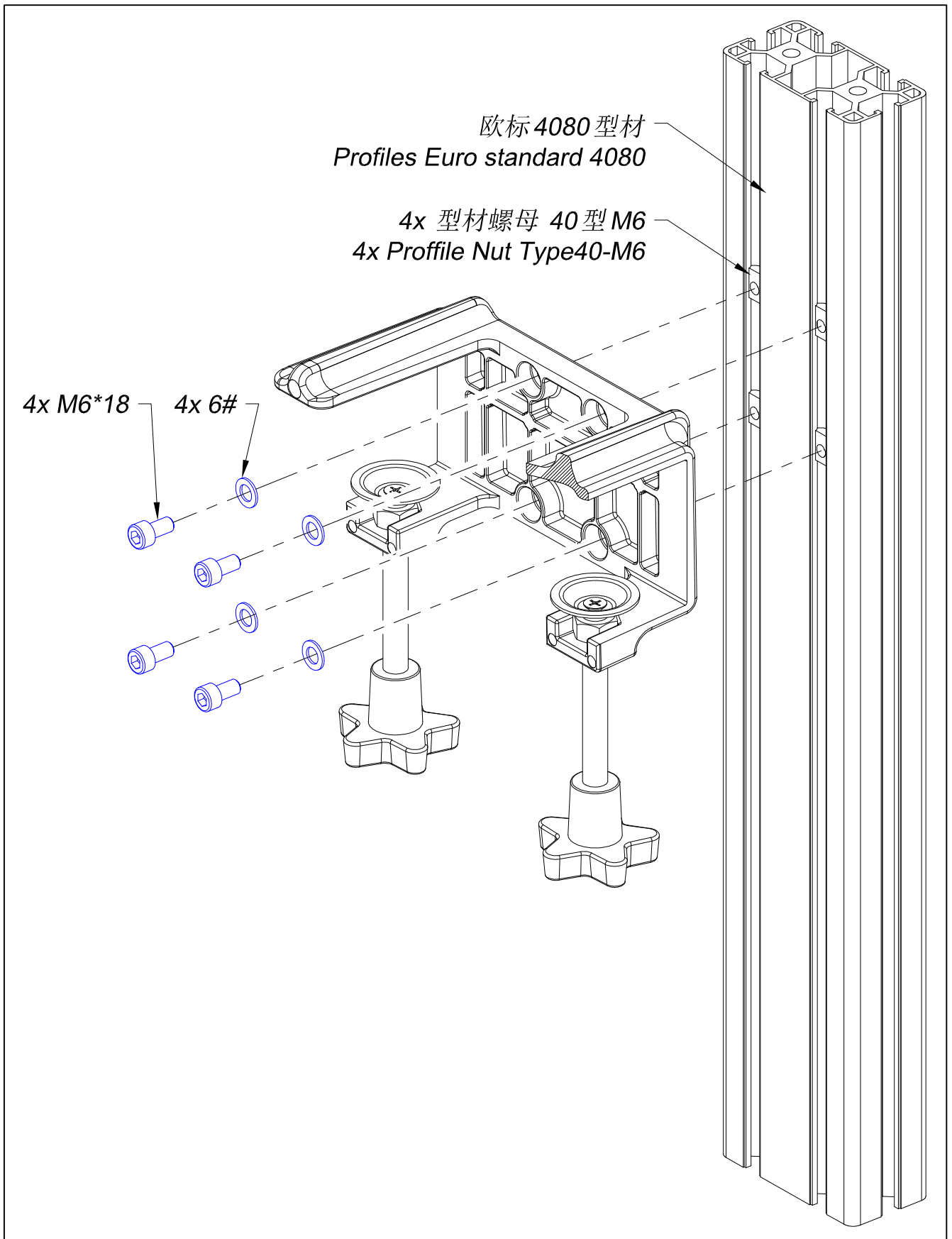

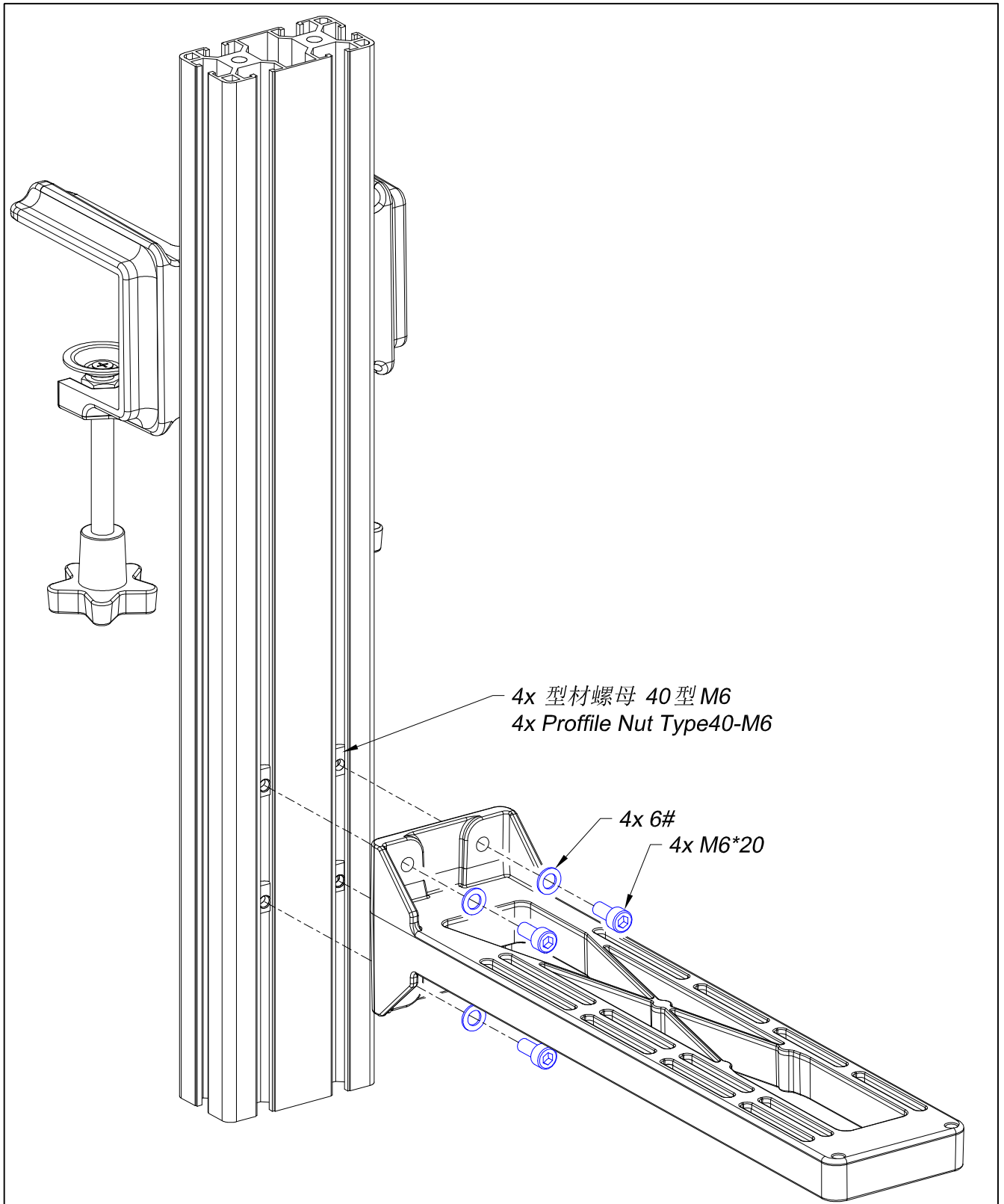

- Assemble the 4080 profile with the bracket; for detailed instructions, please refer to Section 4.1 of this manual.
- Cascade UFC Unit 1 with HUD Unit 1 according to Steps ① and ② in Section 4.4 of the HUD1 User Manual.

- Install the MFD1 bracket according to Item 2 in Section 4.1 of the MFD1 User Manual. If a D1 unit is present, cascade MFD1 with D1 and complete bracket installation as described in Item 1 and Item 3 of Section 4.4 in the D1 User Manual.

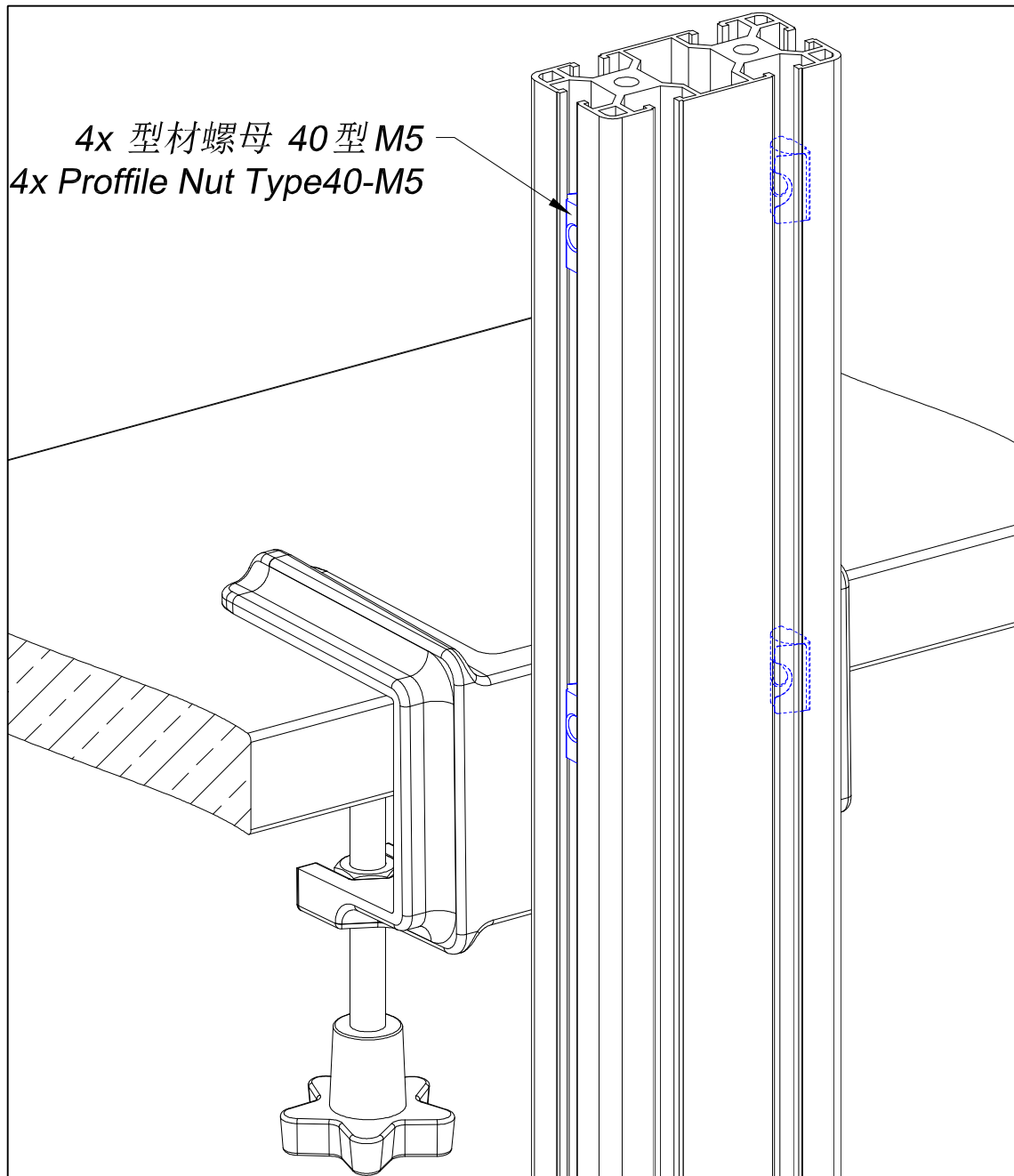

- Insert the profile nut type-40 M5 into the side grooves of the 4080 profile, with 2 nuts on each side.

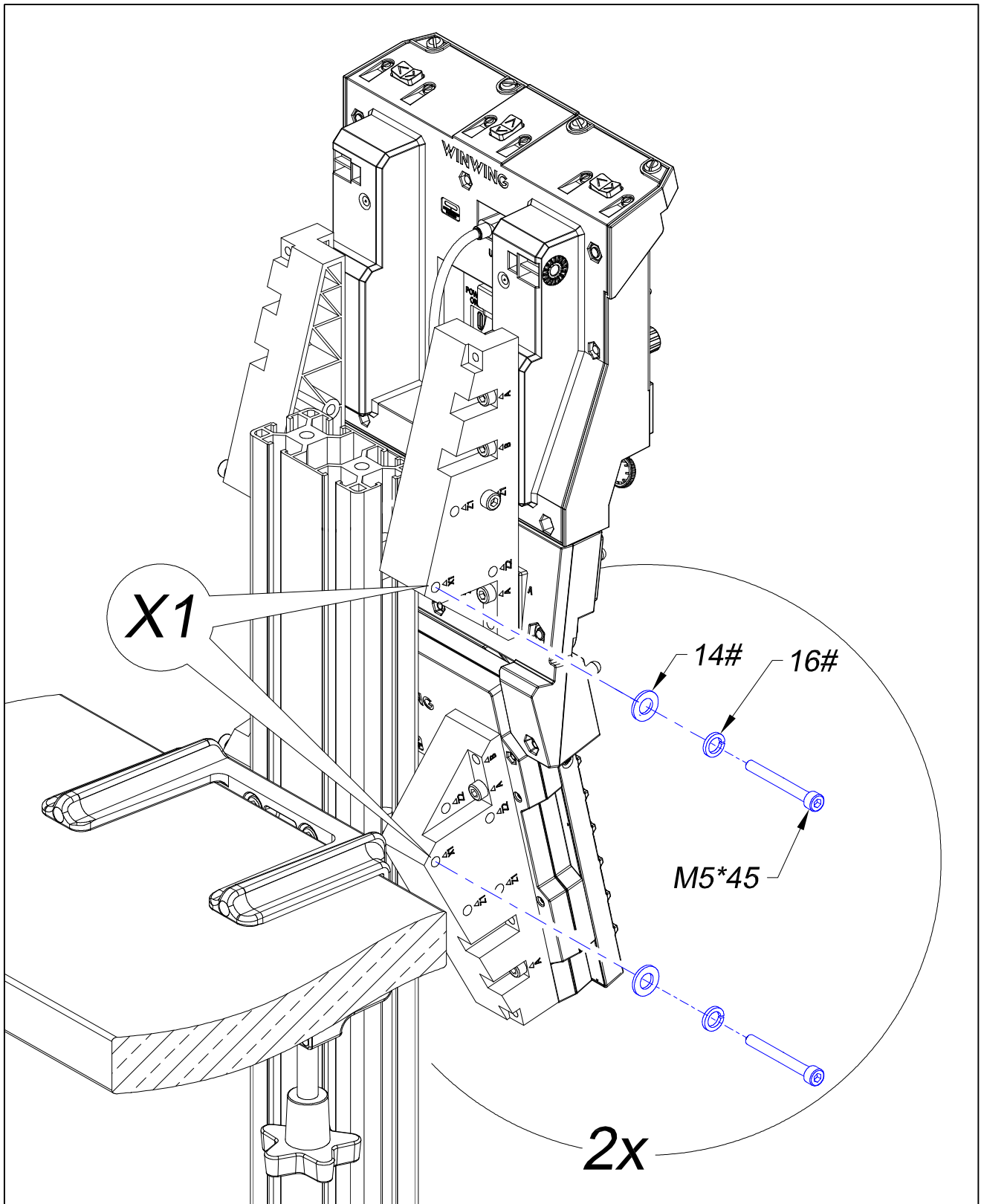

- Install UFC1 and MFD1 on the sides of the profile, screw in but do not tighten them yet.
- After adjusting the position and angle of UFC1 and MFD1, tighten the screws. Tighten the screws until the panel is stable without any wobbling; over-tightening may cause damage.

5 Maintenance

5.1 Firmware upgrade

(Empty)

5.2 Cleaning and maintenance

- Avoid contact with dirt, solvents, salts, acids, alkalis, etc. Keep the product clean.
- It is recommended to clean the product after use. Residues on the product may cause corrosion of the product.
- Do not use this product beyond its limits.
- Do not place this product in areas with excessive heat, such as in a car exposed to direct sunlight. High temperatures may cause the product to malfunction.
- If the product is suddenly moved from a cold place into a warm room, it may cause condensation on the product's surface and its internal parts. To prevent condensation, place the product in a sealed plastic bag first, and then remove it from the bag as the temperature gradually rises.
- Avoid storing the product in places such as chemical laboratories where there are chemicals that can cause rust and corrosion.
- Recommend using original factory parts for maintenance and replacement.

5.3 Frequently asked questions and after-sales service

FAQs:

- When assembling and connecting products and accessories, make sure that the fixing screws are properly tightened and that the components are not loose or over-tightened. Otherwise, it may cause abnormal noise during the use of the product.

6 Safety precautions

Be sure to read these notes for safe use of the product.

Please follow these instructions to prevent damage or injury to the product user or others.

- Keep the product out of the reach of children.
- It is very dangerous to swallow product parts or accompanying items. Seek medical attention immediately if swallowed by accident.
- Do not modify the product.
- Do not subject the product to strong impacts or vibrations; Stand withstands a maximum of 17Kgf, exceeding will cause damage; Products attached to the bracket should follow the terms of use of the product itself.
- Do not clean the product with organic solvents such as alcohol, gasoline or paint thinner.
- Do not wet the product. Do not insert foreign objects or pour liquids into the product.
- Do not use the product in an environment where flammable gas may be present, otherwise it may explode or catch fire due to static electricity.

Disclaimer

Please read carefully and understand the contents of the product user manual. Failure to follow the instructions may result in personal injury or damage to the product.

Please make sure that all people using this product are familiar with and understand the product user manual in order to maximize the value of the product.

。 The user shall not be held responsible for any personal injury, property loss or product damage resulting from the user 's improper operation or failure to follow the user' s manual.

When the user uses the product:

The product should be installed, handled, stored, used, maintained and disposed of in accordance with the instructions of the product guide and the requirements of relevant laws and regulations and safety standards, without violating the requirements of relevant laws and regulations.

Given that the conditions and ways in which the user uses the product are beyond the control of the Company, the consequences of any of the following situations shall be borne by the user personally, and the Company shall not be liable for any of them:

Personal injury, property loss and product damage caused by improper operation of the user, failure to follow the user manual of the product or other uncertain factors.

Changes to the technical specifications and data of the product due to improvements in reliability, functionality, design or other reasons shall be subject to changes in the user manual without further notice.

NO: 20250427-01D-P

WINWING SIM

WINWINGSIM.COM