

# JOYSTICK GRIP OF 16 H.O.T.A.S

## User Manual V2.0 2024.06



## Catalog:

Packing List .....	3
1 Parameters .....	4
1.1 Performance Parameters.....	4
1.2 Applicable Models.....	4
1.3 Dimensions.....	5
2 Functions .....	5
3 Components Assembly and Disassembly .....	7
4 Installation of Connectors .....	8
5 Installation of the Base .....	9
6 Calibration.....	13
6.1 Mini-joystick calibration.....	13
6.2 Rz Calibration .....	14
6.3 Slider Calibration .....	15

# Packing List

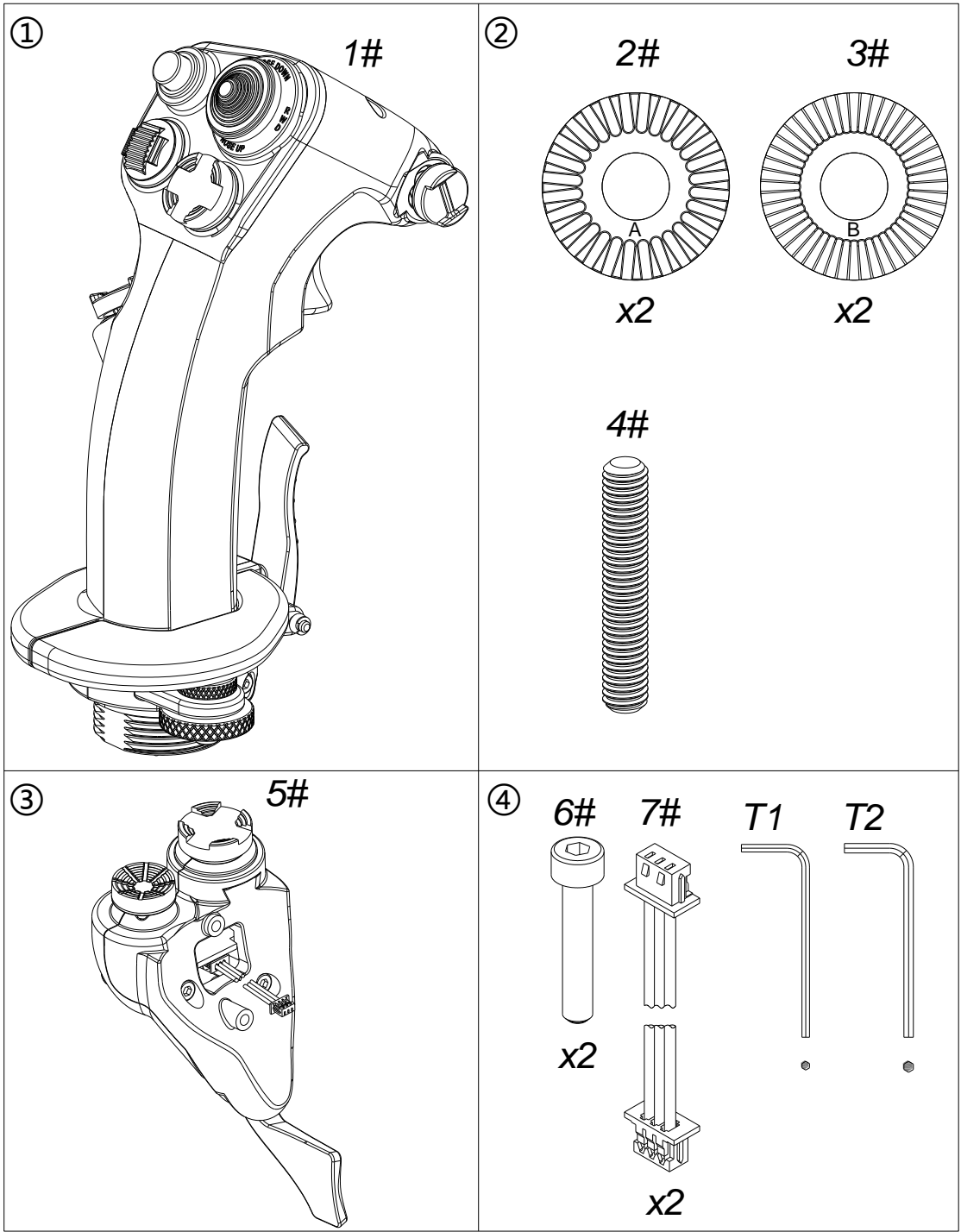

- ①JGRIP OF 16 (1#)1
- ② Accessory Kit (A washer 2#, B washer 3#, bolt 4#)1
- ③ Extension (5#, optional)1
- ④ Accessory Kit and Tool Kit (optional, together with the extension)1

4#	Bolt M6*35
6#	Hex Socket Head Cap Screw M3*30

# 1 Parameters

## 1.1 Performance Parameters

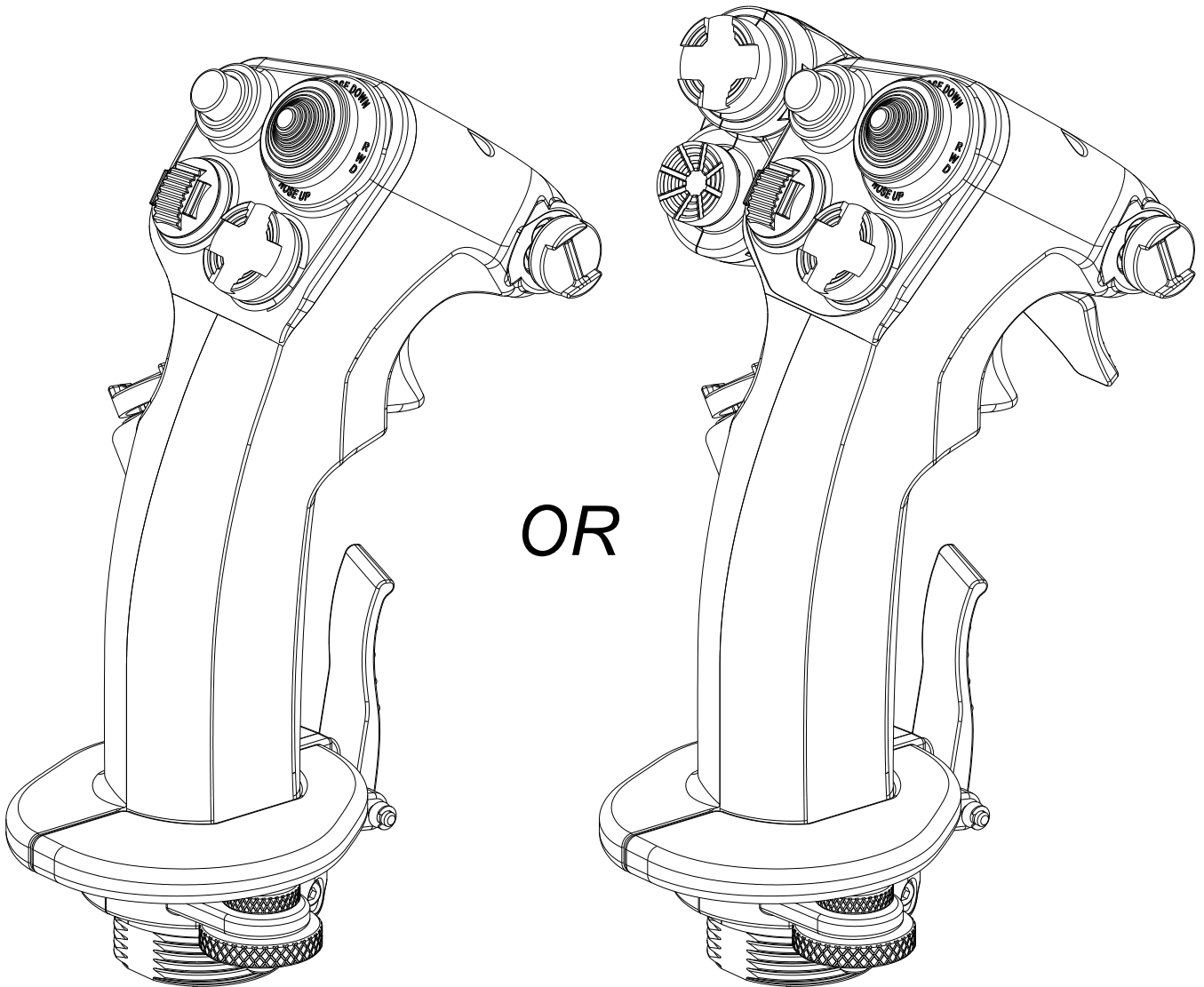

You can use it with the mini-joystick and 5-way switch or without. \*Optional

## 1.2 Applicable Models

- ① Compatible with J1 base;
- ② Compatible with J2 base;
- ③ Compatible with J2-2 base;
- ④ Compatible with Z axis and/or extension rod.

## 1.3 Dimensions

L\*W\*H:

With extension: 133mm\*106mm\*191mm

Without extension: 133mm\*80mm\*191mm

Weight: 0.7Kg=1.55lb

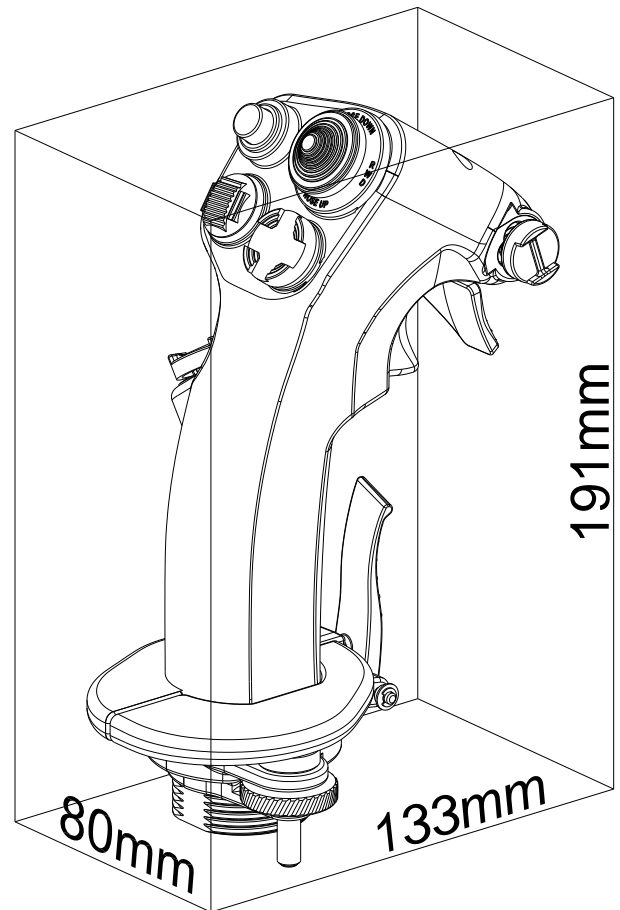
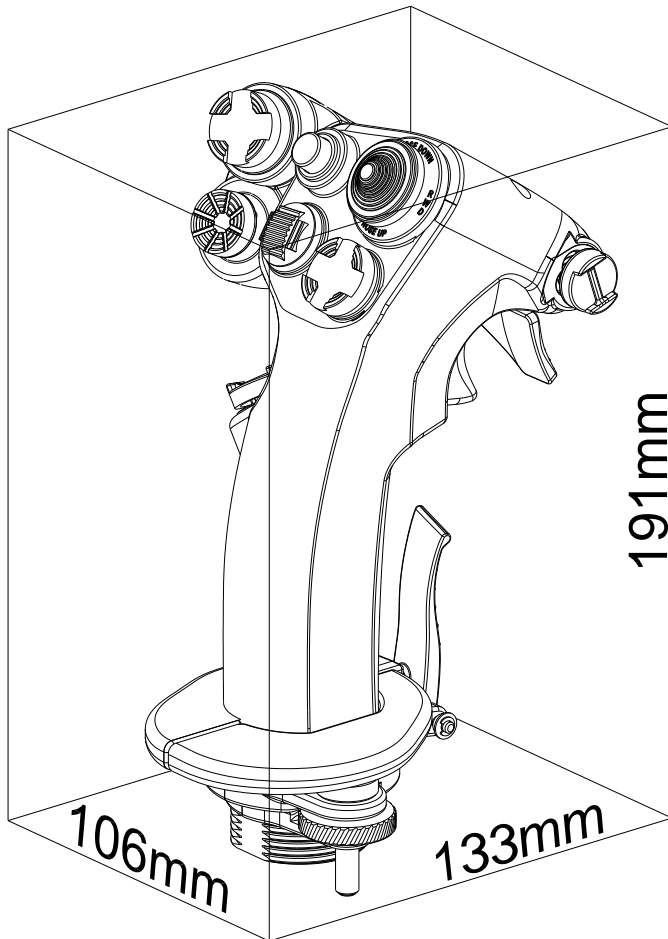

## 2 Functions

### 2.1 Buttons and Functions

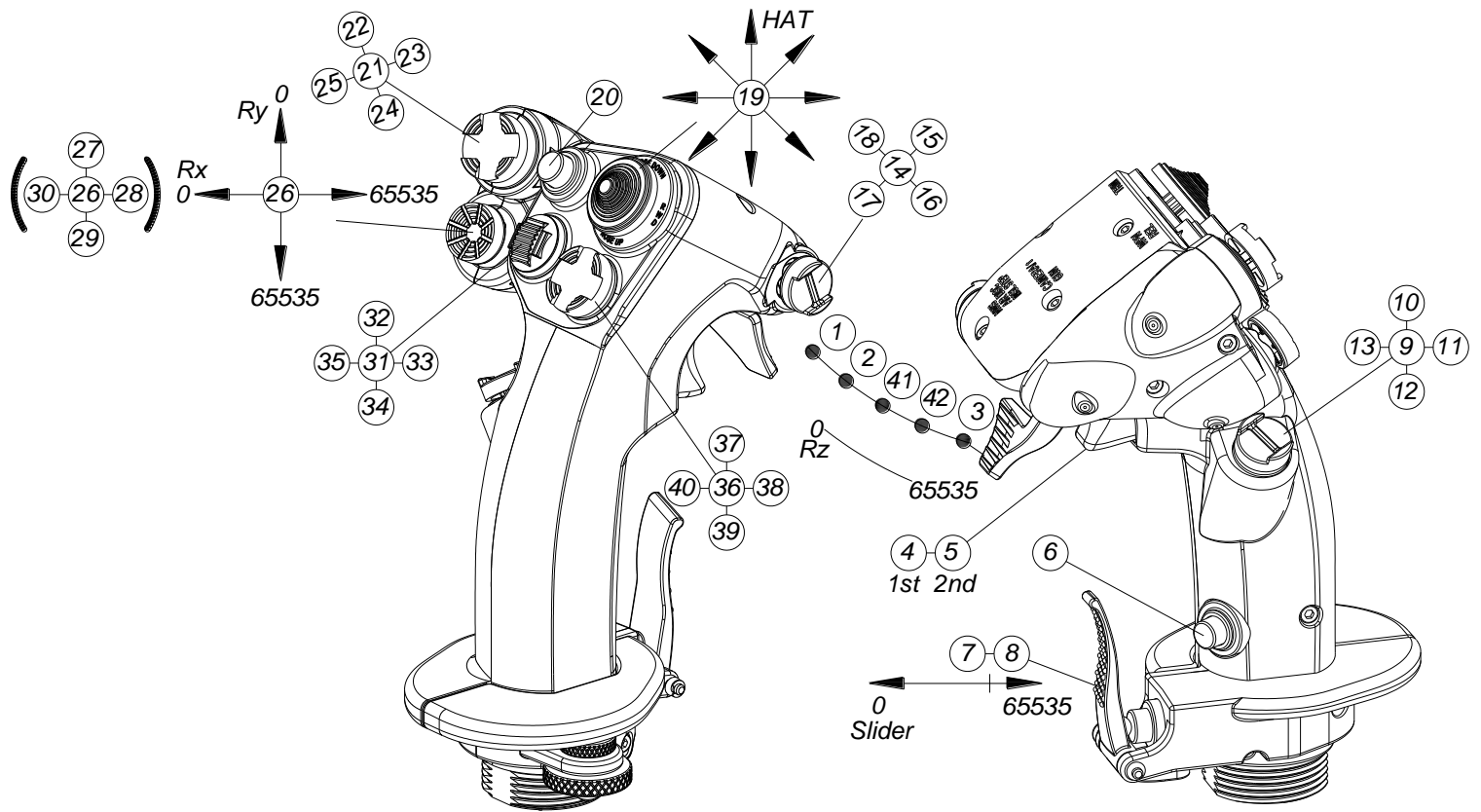

## 2.2 Adjustment Methods

### Adjustment of Hand Rest

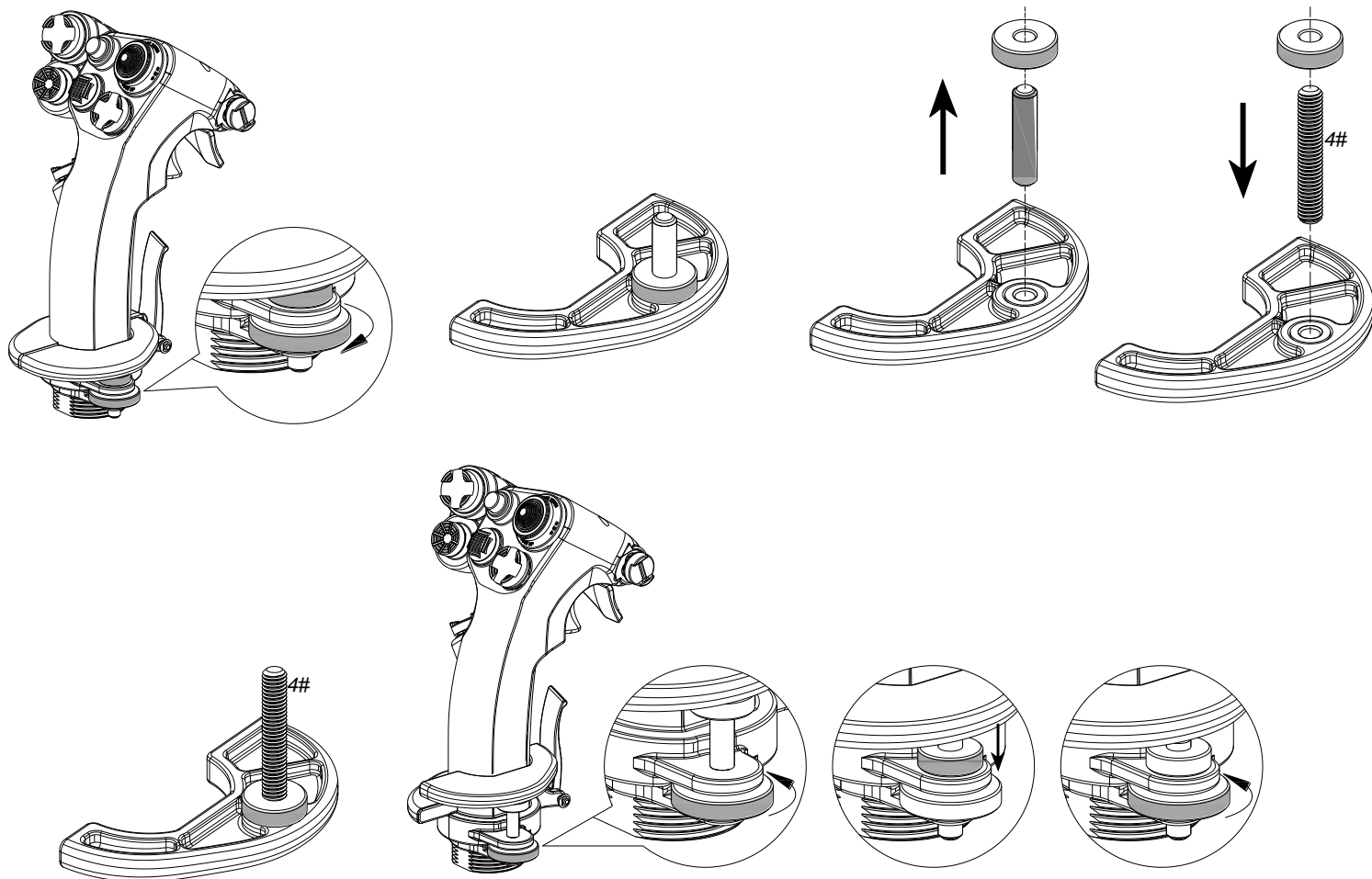

- ① Loosen the large nut.
- ② Remove the hand rest.
- ③ Take off the small nut and the short bolt.
- ④ Screw in the 4# long bolt.
- ⑤ Screw in the small nut.
- ⑥ Install the hand rest and screw in the large nut.
- ⑦ Adjust the hand rest height to a comfortable position by rotating the large nut, then move the small nut to the lowest position, and finally tighten the large nut.

### 3 Components Assembly and Disassembly

#### Installation of the Extension

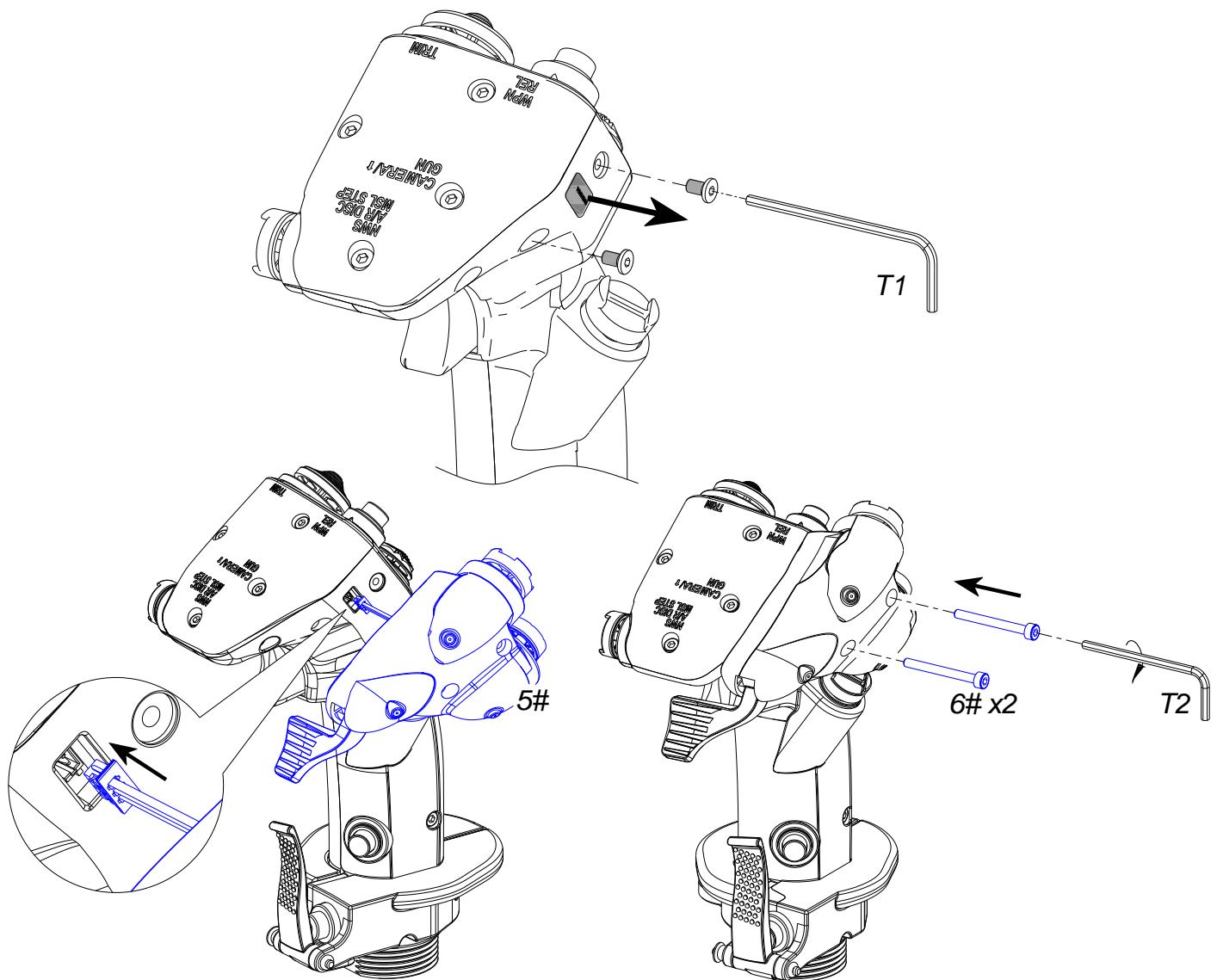

- ① Remove two screws and washers.
- ② Use a plier (or other small tool) to connect the extension plug to the 16 grip.
- ③ Insert two #6 screws, taking care to avoid pinching the wire harness during installation. Tighten the screws just enough to snugly fit (0.1N·m torque), as excessive tightening can permanently deform the plastic shell.

## 4 Installation of Connectors

The installation methods for the grip, Z-axis, and extension rod are all indicated in Chapter 3.2 of the "18 HOTAS USER MANUAL". During installation, please refer to the table below for selecting the appropriate set screws and A/B washers. For instructions on installing the washers, please refer to Chapter 5 of this manual.



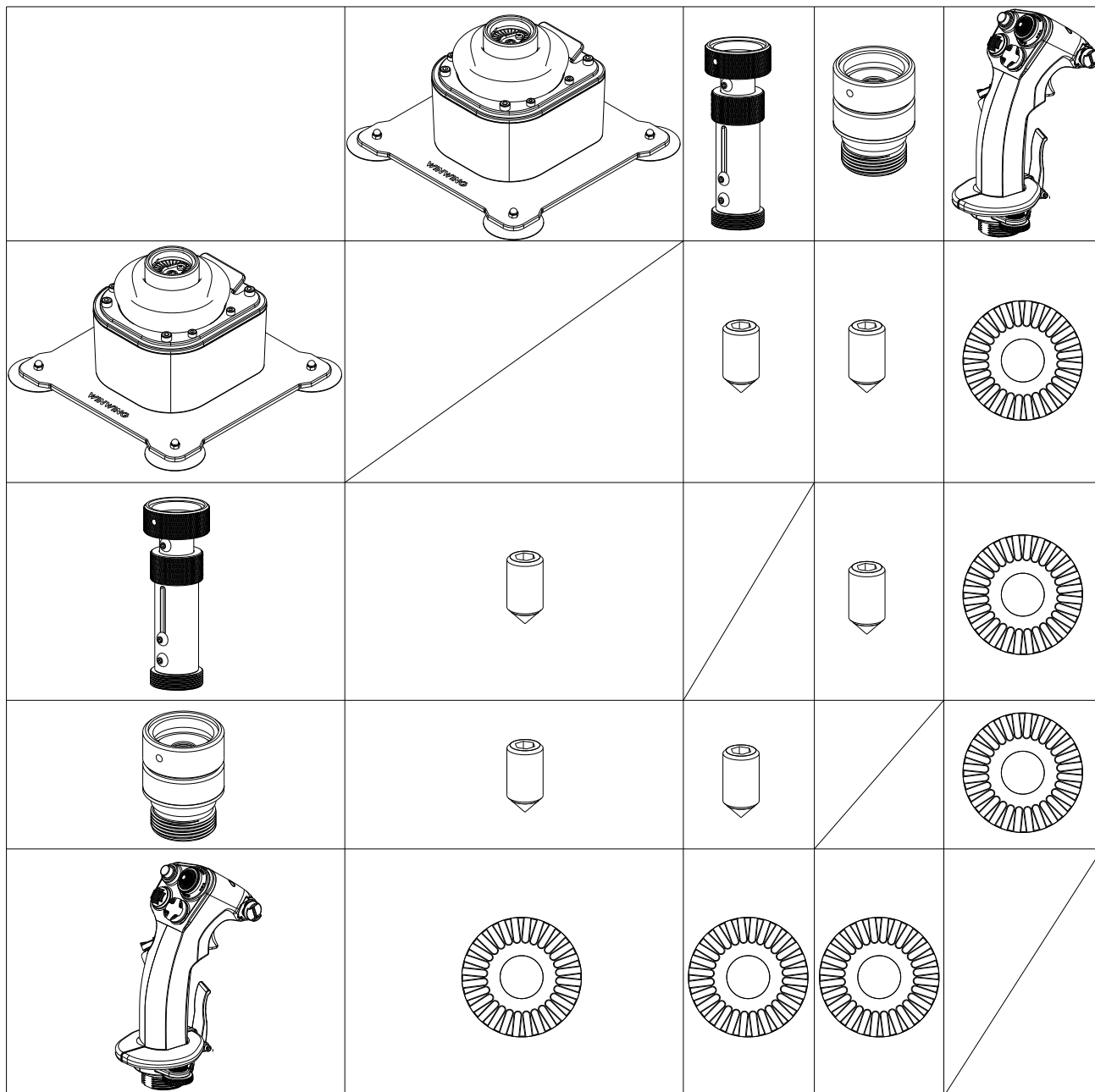

## 5 Installation of the Base

Connection and Installation Methods with the J1/J2/J2-2 Base

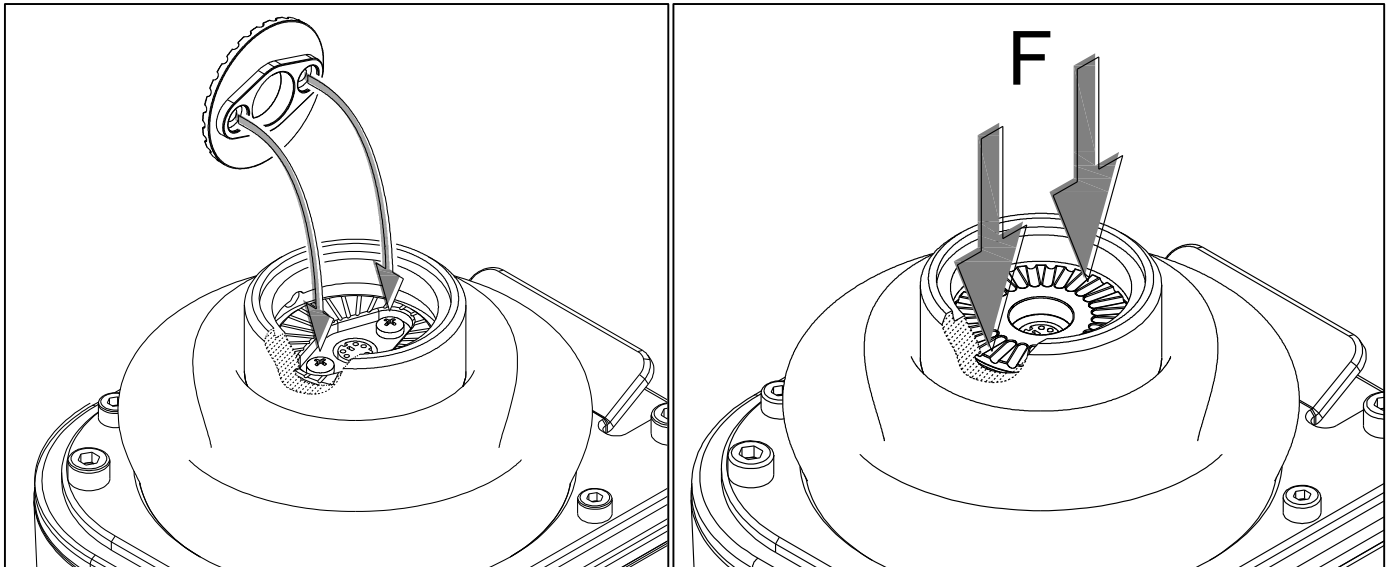
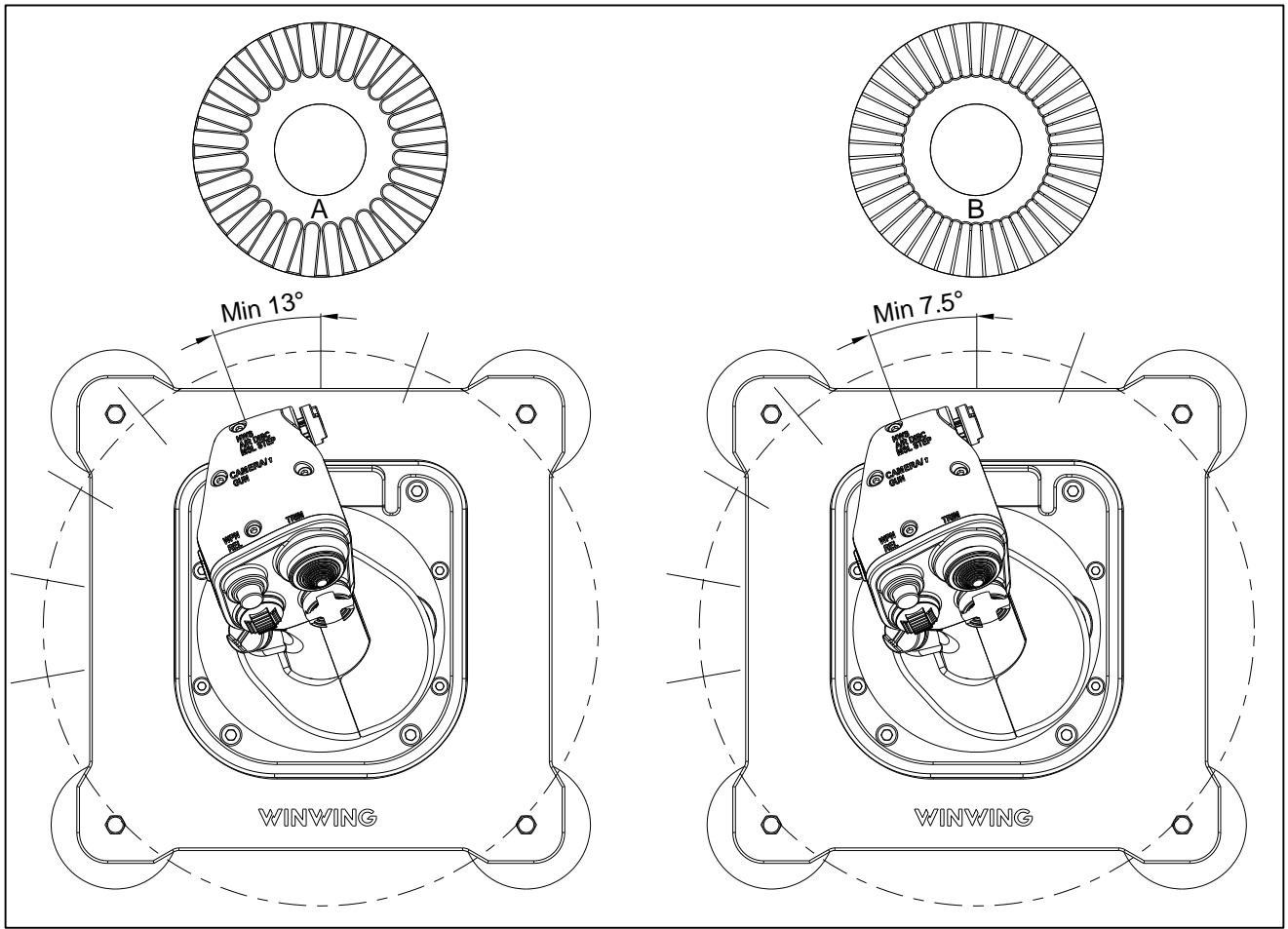

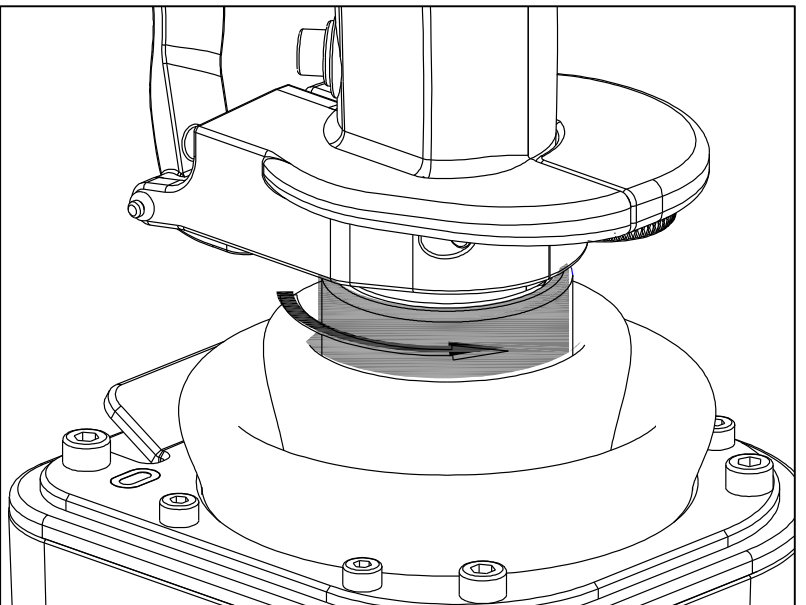
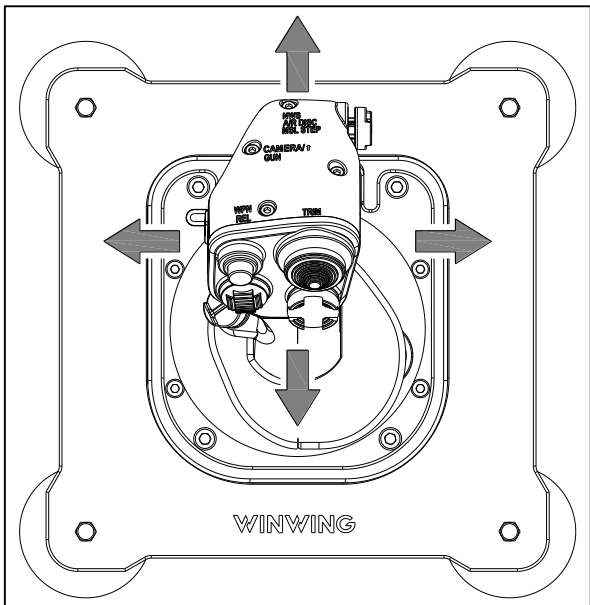
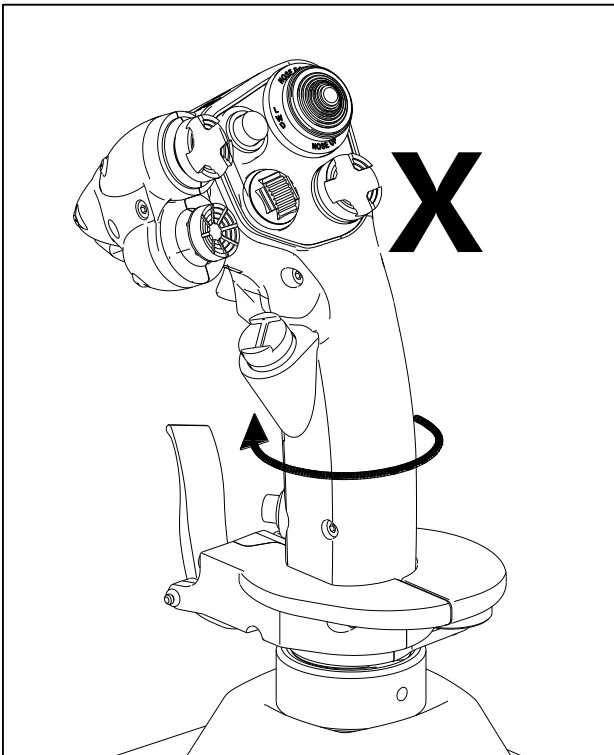
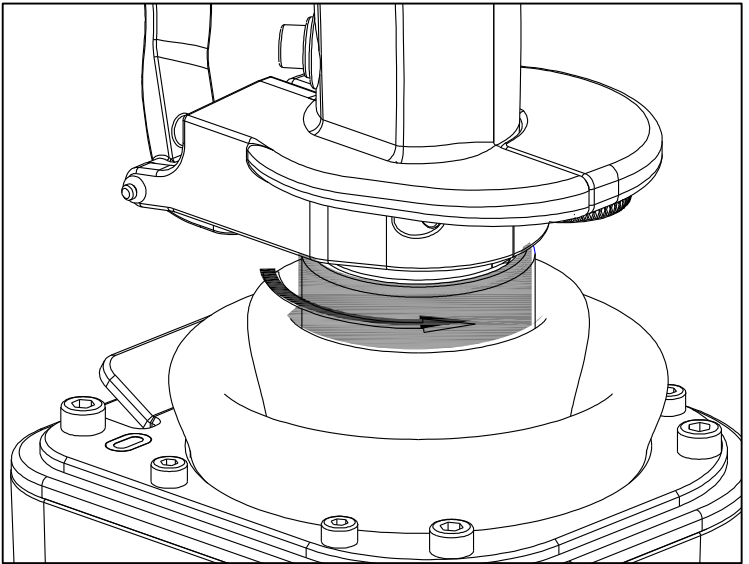
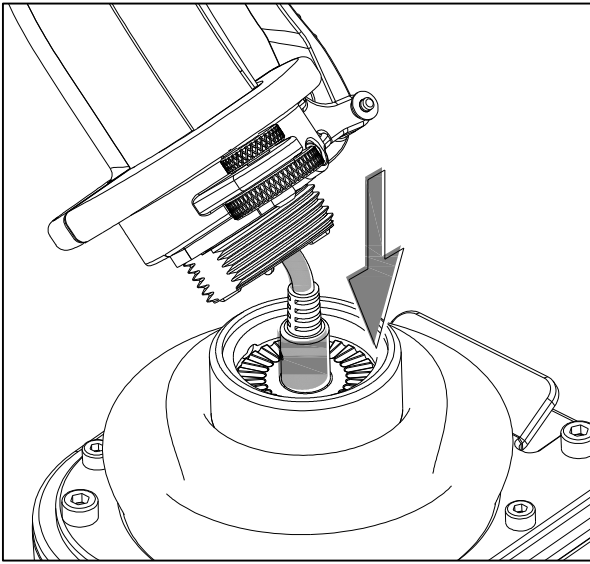

- ① Select a washer, ready for installation: A (more durable) or B (for a smaller angle).
- ② Place the washer on the base, making sure it's oriented correctly.
- ③ Press down to embed the washer into the base securely, ensuring it doesn't rotate freely.
- ④ Connect the grip cable to the base.
- ⑤ With one hand stabilizing the grip to prevent rotation, use the other hand to tighten the clamping cover until fully secured.

Note: Rotate only the clamping cover—never the grip itself.

- ⑥ Randomly swing the grip in all directions.
- ⑦ Tighten again as in step 5. Repeat steps 5 → 6 → 5 until the cover can no longer be tightened further (typically 2-3 repetitions).

\* The grip with A or B washers cannot be installed with the set screws provided with the base configuration.

# 6 Calibration

## 6.1 Mini-joystick calibration

- ① Start sim App pro. Enter the Test page. Click calibration;

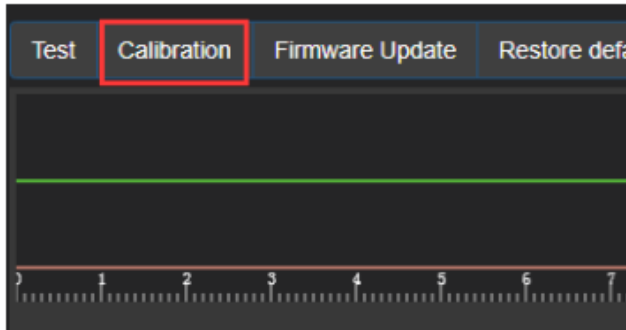

- ② In the calibration page, click the options in red square, move the mini-joystick full range;

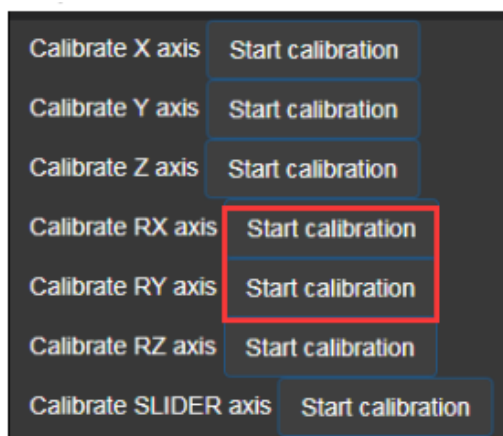

- ③ After the full range movement. Click the options as shown:

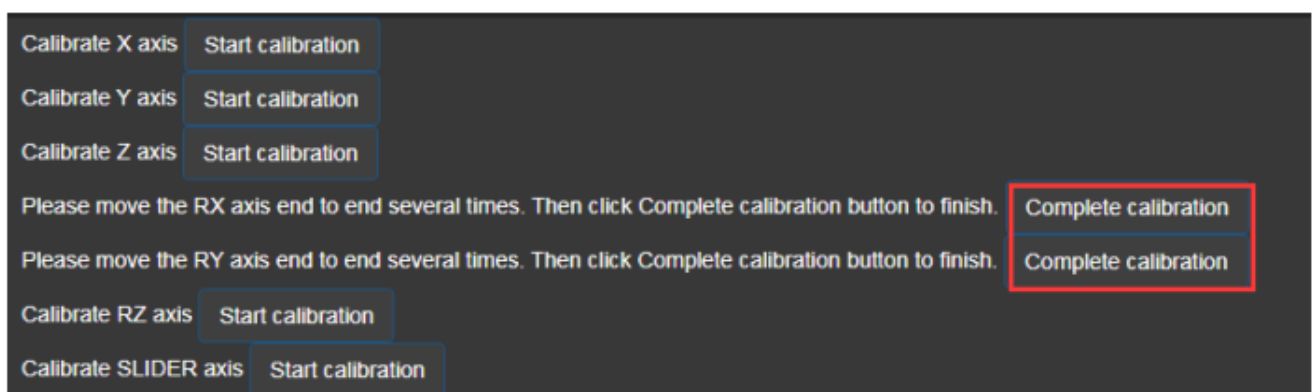

- ④ You have completed the calibration, return to the test page to observe the correct response.

## 6.2 Rz Calibration

- ① Start sim App pro. Enter the Test page. Click calibration;

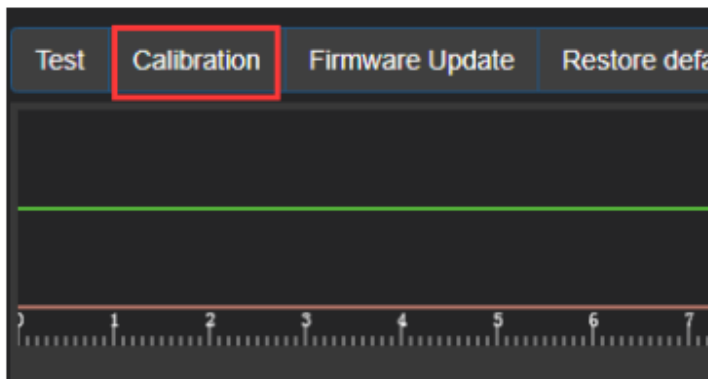

- ② At the test page, click the following button for calibration. Move Rz trigger full range for calibration (Do not move to the top position);

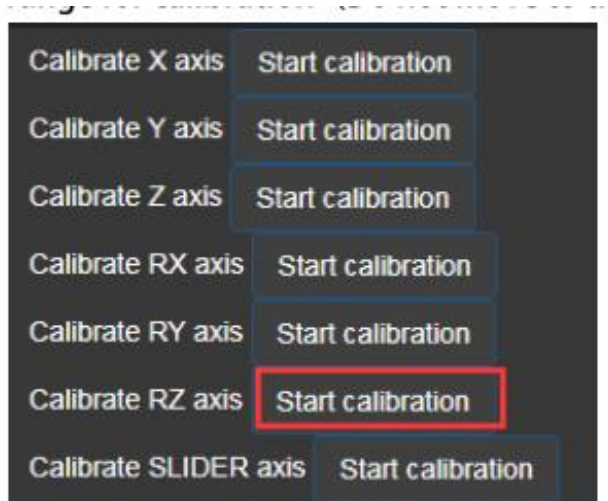

- ③ After the full range movement, release the Rz trigger, and click the following options;

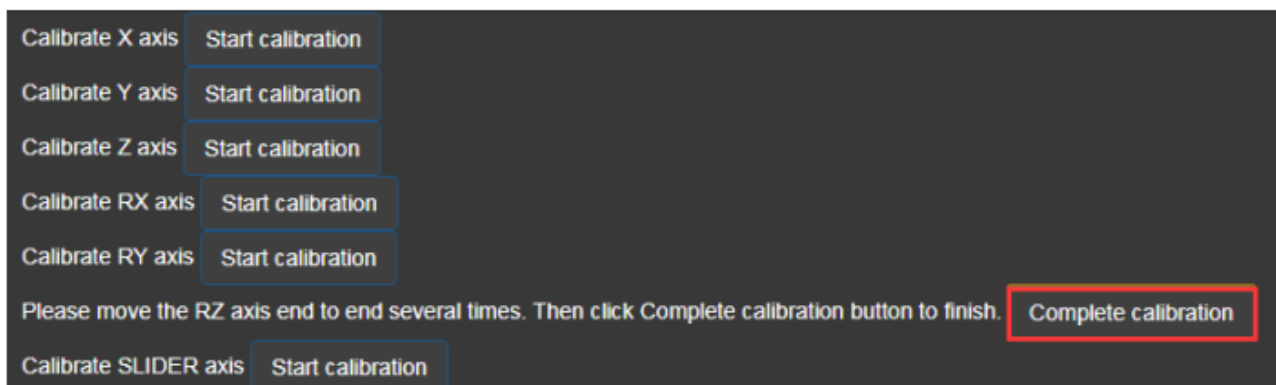

- ④ Return to the Test page, check if the calibration is correct.

### 6.3 Slider Calibration

① Start sim App pro. Enter the Test page. Click calibration;

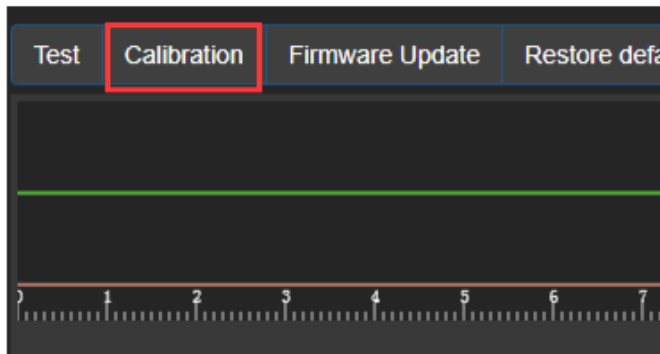

② At the test page, click the following button for calibration. Move slider full range for calibration;

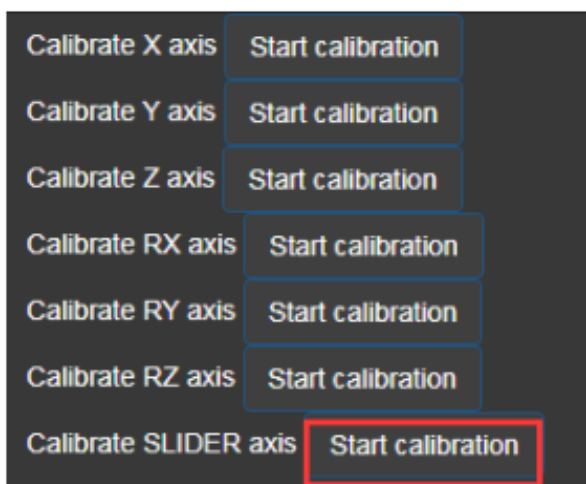

③ After the full range movement, click the following options;

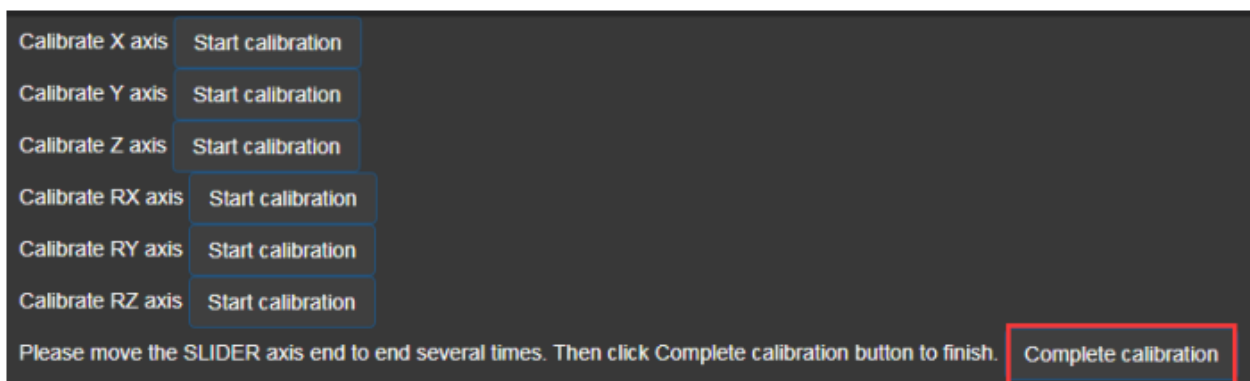

④ Return to the Test page, check if the calibration is correct.

\* Contents are subject to updating without notice.

## 成都翼胜科技有限责任公司

[WWW.WINWING.CN](http://WWW.WINWING.CN)  
[INFO@WINWING.CN](mailto:INFO@WINWING.CN)

High-tech International Enterprise Zone No.19 Building, Changshengqiao Road  
1111#, Pidu District, Chengdu, Sichuan, China 610000